

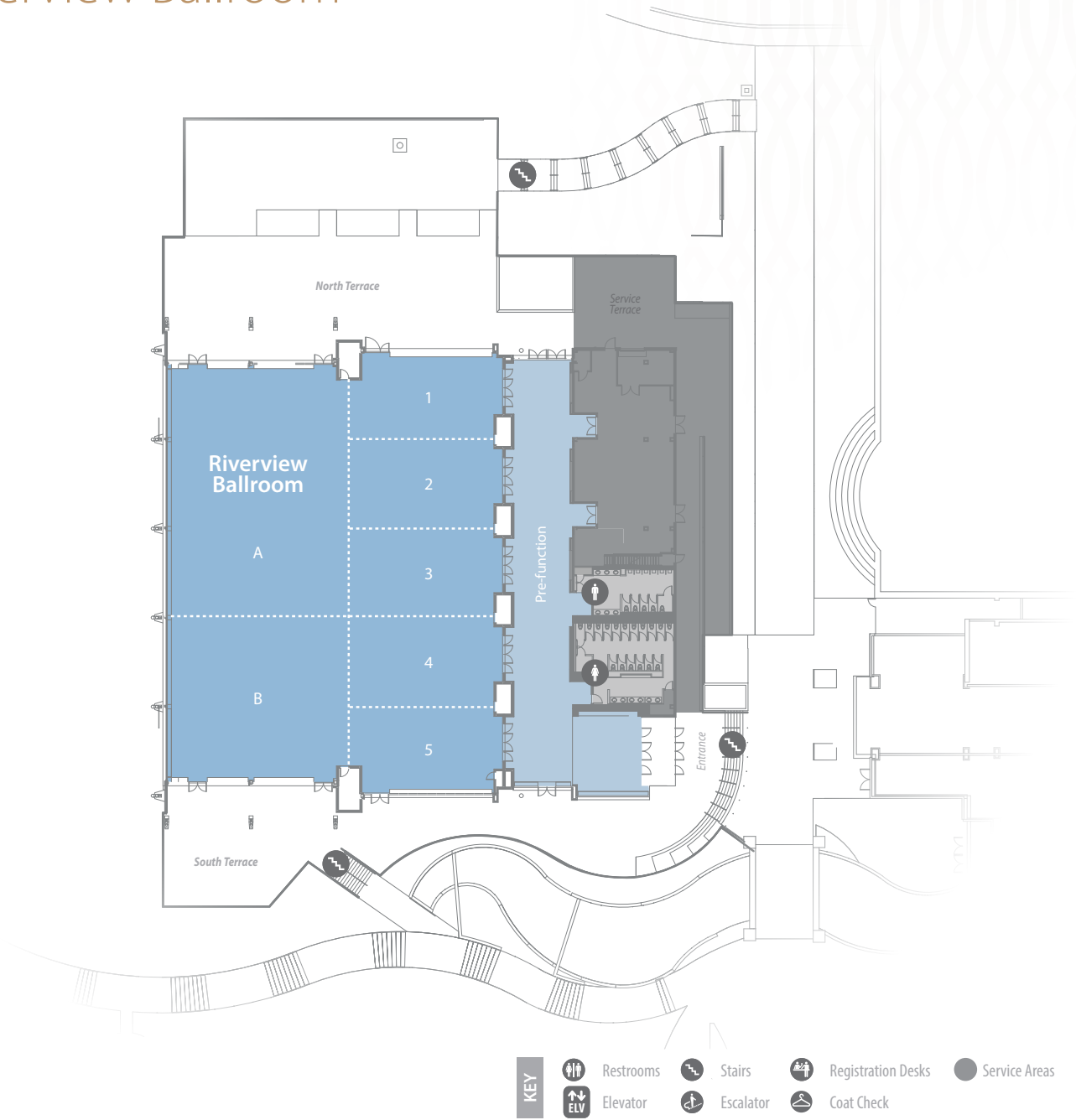

RiverView Ballroom



BALLROOM	L X W X H (FEET)	SQ.FT.	THEATER	CLASSROOM	CONFERENCE	U-SHAPE	ROUNDS (10)	RECEPTION
RIVERVIEW BALLROOM	141x110x(13-20)	16,069	1,800	820			990	1,850
A*	85x62x20	5,270	722	330			350	650
B*	29x48x20	3,416	425	180			200	450
1	29x48x(13-19)	1,449	130	64	42	36	100	190
2	29x48x(13-19)	1,449	130	64	42	36	100	190
3	29x48x(13-19)	1,449	130	64	42	36	100	190
4	29x48x(13-19)	1,449	130	64	42	36	100	190
5	29x48x(13-19)	1,449	130	64	42	36	100	190
Pre-function	145x20	3,330						
North Ballroom Terrace	70x218	7,820						
South Ballroom Terrace	40x58	2,120						

Capacities shown in this book are maximum for each room, with no staging or audio-visual, and should be used for reference only. Room capacities will be diminished based on your staging and audio-visual needs.

* Section must be accessed through adjoining areas.