



JW MARRIOTT

MARCO ISLAND

INSPIRED EVENTS.  
THOUGHTFULLY CRAFTED.

EVENTS by JW

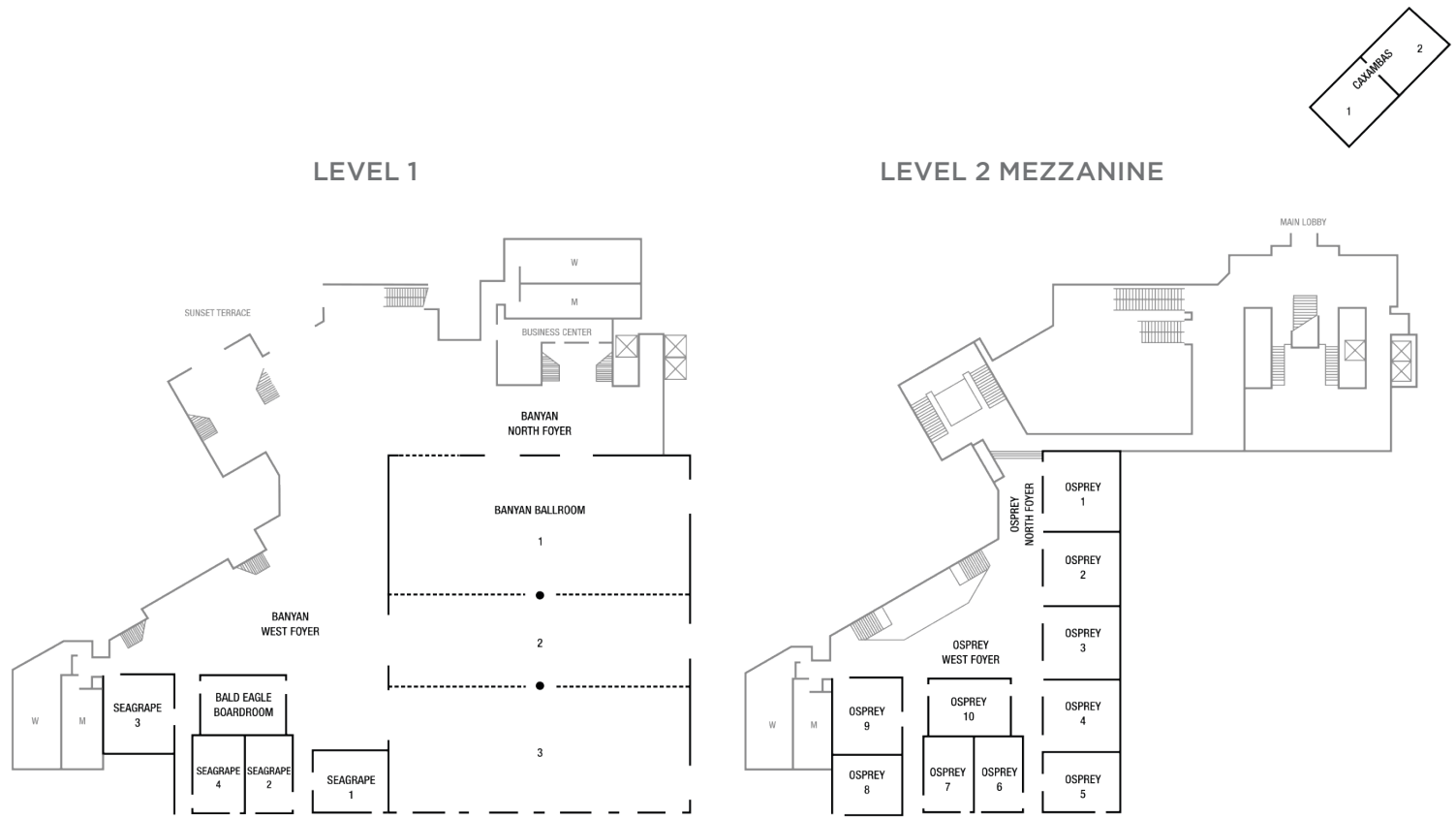

BALD EAGLE BOARDROOM

PARADISE REDEFINED

Discover paradise without a passport at the JW Marriott Marco Island Beach Resort, with three and a half miles of private, white sand beach and authentic experiences to enrich your passions.

Let your surroundings inspire you with over 100,000 square feet of distinctive event space including the brand-new Calusa Ballroom, overlooking the Gulf of Mexico. Enhance your event with group recreation including team-building activities, water sports and excursions. Dine and unwind together with our many culinary offerings highlighting local ingredients and regional flavors.

Every moment of your stay will be choreographed to shape your journey so that you may leave richer than when you arrived.



BANYAN BALLROOM

| MEETING ROOM              | DIMENSIONS    |         | CAPACITY    |            |         |                |                |           |            |             |         |               |
|---------------------------|---------------|---------|-------------|------------|---------|----------------|----------------|-----------|------------|-------------|---------|---------------|
|                           | LxWxH (FT.)   | SQ. FT. | SCHOOL ROOM | CONFERENCE | THEATRE | BANQUET PLATED | BANQUET BUFFET | RECEPTION | 8x10 BOOTH | 10x10 BOOTH | U-SHAPE | HOLLOW SQUARE |
| <b>LEVEL 1</b>            |               |         |             |            |         |                |                |           |            |             |         |               |
| Banyan                    | 142'x120'x21' | 17,040  | 1,035       | -          | 1,800   | 1,100          | 1,050          | 1,700     | 96         | 82          | -       | -             |
| Banyan 1                  | 56'x120'x21'  | 6,720   | 312         | -          | 740     | 320            | 310            | 700       | 34         | 28          | -       | -             |
| Banyan 1 - 2              | 93'x120'x21'  | 11,160  | 560         | -          | 980     | 560            | 550            | 1,150     | 64         | 54          | -       | -             |
| Banyan 2                  | 120'x37'x21'  | 4,440   | 276         | -          | 580     | 220            | 200            | 450       | 22         | 20          | -       | -             |
| Banyan 2 - 3              | 120'x86'x21'  | 10,320  | 528         | -          | 966     | 530            | 520            | 1,000     | 54         | 48          | -       | -             |
| Banyan 3                  | 120'x49'x21'  | 5,880   | 322         | -          | 700     | 280            | 260            | 600       | 24         | 20          | -       | -             |
| Banyan West Foyer         | -             | 7,976   | -           | -          | -       | -              | -              | 800       | 20         | 14          | -       | -             |
| Banyan North Foyer        | -             | 8,163   | -           | -          | -       | -              | -              | 800       | 14         | 10          | -       | -             |
| Seagrape 1                | 29'x23'x9.6'  | 667     | 32          | 18         | 60      | 40             | -              | 68        | -          | -           | 22      | 26            |
| Seagrape 2                | 18'x30'x9.6'  | 540     | 22          | 24         | 42      | 30             | -              | 53        | -          | -           | 20      | 24            |
| Seagrape 3                | 33'x22'x9.6'  | 840     | 32          | 24         | 60      | 40             | -              | 84        | -          | -           | 22      | 32            |
| Seagrape 4                | 19'x30'x9.6'  | 570     | 24          | 24         | 42      | 30             | -              | 58        | -          | -           | 20      | 24            |
| Bald Eagle Boardroom      | 33'x22'x9.6'  | 726     | -           | 18         | -       | -              | -              | -         | -          | -           | -       | -             |
| <b>LEVEL 2</b>            |               |         |             |            |         |                |                |           |            |             |         |               |
| Osprey 1                  | 29'x30'x9.6'  | 870     | 32          | 22         | 60      | 40             | 40             | 80        | -          | -           | 24      | 32            |
| Osprey 2                  | 29'x29'x9.6'  | 841     | 36          | 22         | 60      | 40             | 40             | 80        | -          | -           | 24      | 32            |
| Osprey 3                  | 29'x29'x9.6'  | 841     | 36          | 22         | 60      | 40             | 40             | 80        | -          | -           | 24      | 32            |
| Osprey 4                  | 29'x29'x9.6'  | 841     | 36          | 22         | 60      | 40             | 40             | 80        | -          | -           | 24      | 32            |
| Osprey 5                  | 29'x22'x9.6'  | 638     | 32          | 20         | 50      | 30             | 30             | 60        | -          | -           | 18      | 30            |
| Osprey 6                  | 18'x30'x9.6'  | 540     | 21          | 22         | 40      | 30             | 20             | 50        | -          | -           | 18      | 22            |
| Osprey 7                  | 18'x30'x9.6'  | 540     | 21          | 22         | 40      | 30             | 20             | 50        | -          | -           | 18      | 22            |
| Osprey 8                  | 30'x22'x9.6'  | 660     | 24          | 18         | 48      | 40             | 30             | 68        | -          | -           | 18      | 24            |
| Osprey 9                  | 27'x30'x9.6'  | 810     | 27          | 22         | 60      | 40             | 30             | 70        | -          | -           | 24      | 28            |
| Osprey 10                 | 28'x30'x9.6'  | 830     | 36          | 22         | 60      | 40             | 30             | 80        | -          | -           | 24      | 28            |
| Osprey West Foyer         | -             | 4,623   | -           | -          | -       | -              | -              | 484       | -          | -           | -       | -             |
| Osprey North Foyer        | -             | 4,059   | -           | -          | -       | -              | -              | 400       | -          | -           | -       | -             |
| Caxambas 1 & 2 (Combined) | 33'x69'x9.6'  | 2,311   | 132         | -          | 204     | 140            | 120            | 200       | -          | -           | 60      | 70            |
| Caxambas 1                | 33'x36'x9.6'  | 1,206   | 60          | -          | 112     | 60             | 50             | 100       | -          | -           | 36      | 42            |
| Caxambas 2                | 33'x33'x9.6'  | 1,105   | 48          | -          | 98      | 50             | 40             | 80        | -          | -           | 32      | 38            |

\*Please Note: Use these capacity charts as a guideline only. Freight elevators have a 12,500 pound capacity, 10'x22', doors are 10'x10'.



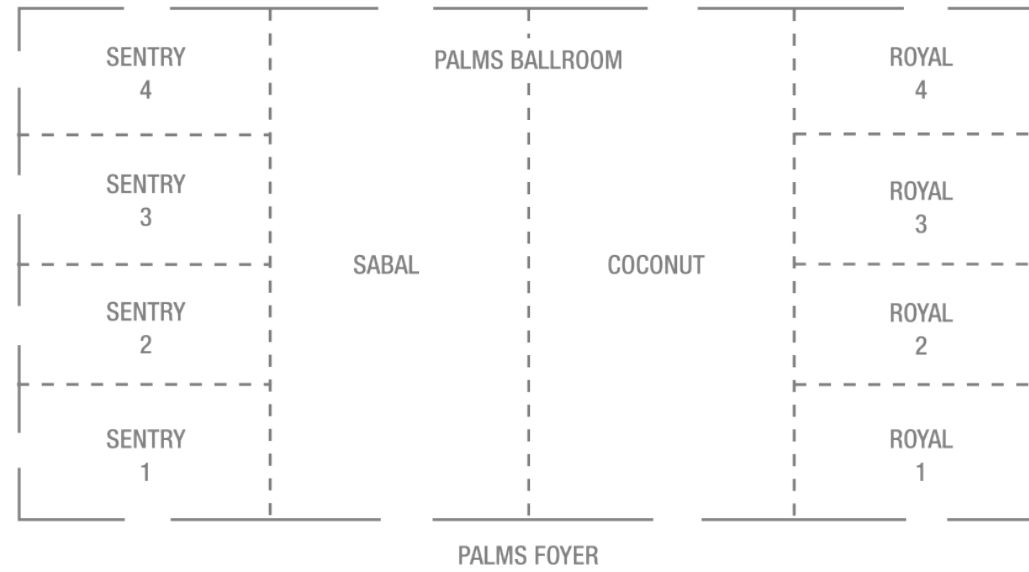

PALMS FOYER

| MEETING ROOM  | DIMENSIONS   |         | CAPACITY    |            |         |                |                |           |            |             |         |               |
|---|--------------|---------|-------------|------------|---------|----------------|----------------|-----------|------------|-------------|---------|---------------|
|   | LxWxH (FT.)  | SQ. FT. | SCHOOL ROOM | CONFERENCE | THEATRE | BANQUET PLATED | BANQUET BUFFET | RECEPTION | 8x10 BOOTH | 10x10 BOOTH | U-SHAPE | HOLLOW SQUARE |
| Palms Ballroom  | 88'x112'x17' | 9,856   | 456         | -          | 836     | 540            | 510            | 900       | 62         | 50          | -       | -             |
| Large Salon<br>Royal, Coconut,<br>Sabal, Sentry         | 88'x28'x17'  | 2,464   | 135         | -          | 205     | 140            | 120            | 246       | -          | -           | 72      | 82            |
| 2 Large Salons<br>(Combined)                            | 88'x56'x17'  | 4,928   | 246         | -          | 411     | 240            | 220            | 493       | -          | -           | 90      | 100           |
| 3 Large Salons<br>(Combined)                            | 88'x84'x17'  | 7,392   | 370         | -          | 616     | 390            | 350            | 739       | -          | -           | 100     | 120           |
| Small Salon<br>Royal 1, 2, 3, 4 or<br>Sentry 1, 2, 3, 4 | 28'x22'x17'  | 616     | 30          | 24         | 51      | 40             | 30             | 35        | -          | -           | 18      | 21            |
| 2 Small Salons<br>(Combined)                            | 28'x44'x17'  | 1,232   | 70          | 32         | 103     | 80             | 60             | 123       | -          | -           | 38      | 46            |
| 3 Small Salons<br>(Combined)                            | 28'x66'x17'  | 1,848   | 92          | 62         | 154     | 100            | 80             | 185       | -          | -           | 56      | 62            |
| Executive Boardroom                                     | 15'x25'x9.9' | 375     | -           | 14         | -       | -              | -              | -         | -          | -           | -       | -             |
| OUTDOOR FUNCTION SPACE                                  |              |         |             |            |         |                |                |           |            |             |         |               |
| Sunset Terrace  | 188'x75'     | 14,100  | -           | -          | -       | -              | 700            | 900       | -          | -           | -       | -             |
| Sunset Terrace S.                                       | 67'x75'      | 5,025   | -           | -          | -       | -              | 350            | 450       | -          | -           | -       | -             |
| Sunset Terrace N.                                       | 67'x75'      | 5,025   | -           | -          | -       | -              | 350            | 450       | -          | -           | -       | -             |
| Tiki Terrace  | 145'x55'     | 7,975   | -           | -          | -       | -              | 350            | 500       | -          | -           | -       | -             |
| Palms Terrace   | -            | 1,100   | -           | -          | -       | -              | 30             | 50        | -          | -           | -       | -             |
| Palms Lawn  | -            | 2,580   | -           | -          | -       | -              | 210            | 300       | -          | -           | -       | -             |
| Gazebo S.   | 12'x12'      | 144     | -           | -          | 10      | -              | -              | -         | -          | -           | -       | -             |
| Gazebo N.   | 12'x12'      | 144     | -           | -          | 10      | -              | -              | -         | -          | -           | -       | -             |
| Barrier Islands Terrace                                 | 160'x25'     | 4,000   | -           | -          | -       | -              | 100            | 125       | -          | -           | -       | -             |
| BEACH FUNCTION SPACE                                    |              |         |             |            |         |                |                |           |            |             |         |               |
| Lanai Beach   | 125'x140'    | 17,500  | -           | -          | -       | -              | 600            | 1,300     | -          | -           | -       | -             |
| Quinn's Pool Beach                                      | 125'x140'    | 17,500  | -           | -          | -       | -              | 600            | 1,300     | -          | -           | -       | -             |
| Tiki Beach  | 160'x140'    | 22,400  | -           | -          | -       | -              | 1,300          | 1,600     | -          | -           | -       | -             |
| Palms Beach   | 110'x140'    | 15,400  | -           | -          | -       | -              | 900            | 1,100     | -          | -           | -       | -             |
| Pazzi's Beach & Tiki Beach                              | 100'x140'    | 14,000  | -           | -          | -       | -              | 600            | 1,000     | -          | -           | -       | -             |
| Resort Beach Total                                      | 620'x140'    | 86,800  | -           | -          | -       | -              | 5,000          | 6,300     | -          | -           | -       | -             |



PALMS BALLROOM



PALMS LAWN & TERRACE



CAPE ROMANO HOSPITALITY SUITE



ARIO



TESORO PATIO



KICE & KEEWAYDIN HOSPITALITY SUITES

## HOSPITALITY & RESTAURANT CAPACITY

| HOSPITALITY SUITES                             | TOTAL CAPACITY |
|--|----------------|
| Fiji Presidential Suite                        | 39             |
| Bali Presidential Suite                        | 39             |
| Kice Hospitality Suite                         | 40             |
| Keewaydin Hospitality Suite                    | 40             |
| Cape Romano Hospitality Suite                  | 40             |
| Keewaydin & Kice Hospitality Suites (Combined) | 80             |
| Two-Bedroom Lanai Suite                        | 30             |
| One-Bedroom Lanai Suite                        | 15             |

| RESTAURANTS                        | TOTAL CAPACITY |
|------------------------------------|----------------|
| Ario                               | 160            |
| Ario Aries Private Dining room     | 20             |
| Ario Scorpio Private Dining Room   | 40             |
| Ario Combined Private Dining Rooms | 60             |
| Ario Patio                         | 56             |
| Maia                               | 170            |
| Maia Private Dining Room           | 30             |
| Maia Patio                         | 60             |
| Korals                             | 102            |
| Kane Tiki Bar & Grill              | 200            |
| Quinn's Patio                      | 156            |
| 400 Pazzi's                        | 160            |
| Café San Marco                     | 66             |
| Tesoro                             | 300            |
| Tesoro   Dining Room               | 60             |
| Tesoro   Indoor Lounge             | 34             |
| Tesoro Bar   Inside & Outside      | 44             |
| Tesoro Patio                       | 70             |
| 10K Alley   Dining & Bar           | 95             |
| 10K Alley   Entertainment          | 450            |
| Hammock Bay Grill                  | 480            |
| Rookery Grill                      | 245            |

# EVENTS BY JW

Through memorable culinary experiences, JW sets the stage for exceptional events. The planning begins with a custom menu thoughtfully crafted to delight the palate with fresh, authentic cuisine that celebrates local tastes and overall well-being. To add some flavor to your meeting, our 'Chef on Show' showcases top culinary talent bringing the art of food to life through demonstrations and storytelling. Let our expert planners create an experience that each and every one of your guests will savor throughout the event and beyond.

## MEETING FACILITIES

- Over 100,000 sq. ft. of technology-integrated event space.
- Lanai Tower facilities including the 30,000 sq. ft. Calusa Ballroom and 17,000 sq. ft. Banyan Ballroom
- Five unique outdoor terraces
- Open-air events on the beach
- Full-service FedEx Business Center
- Event technology services provided by Encore
- Planning help from our meeting experts
- Marriott Red Coat Direct and Event Concierge Service

## AREA ATTRACTIONS

- Marco Island Historical Museum
- Old Marco
- Marco Island Princess Boat Tours
- Charter fishing
- Guided tour of Everglades National Park
- Rookery Bay reserve
- Downtown Naples and 5th Avenue shopping
- Naples Zoo at Caribbean Gardens
- Naples Botanical Garden
- Artis Naples

## RECREATION & LEISURE

- Three and a half miles of private, white sand beach
- Spa by JW with daily wellness class menu
- The Rookery at Marco golf course designed by Peter Jacobsen and Jim Hardy
- Award-winning par 72 Hammock Bay golf course
- Nightly sunset celebration and fire dancer show
- Tiki Tribe kids' activities and day camp
- Team building activities
- Beachfront Chickee Huts, premium beach day beds and poolside cabana rentals
- Sailing and shelling excursions
- Waverunner tours of the Everglades Ten Thousand Islands estuary
- Parasailing
- Water sports rentals
- Adult-exclusive oceanfront pool and private beach with beach service for guests of Sirene, an adult exclusive experience

## GUEST SERVICES

- Individual and group airport transportation options available
- Hertz rental car on site
- 24-hour room service
- Valet dry cleaning
- Virtual concierge
- Concierge desk
- Foreign currency exchange
- Safety deposit boxes
- Resort boutiques featuring sundries and upscale resort shopping

## RESTAURANTS & LOUNGES

- **Ario** – Dry aged steaks and extensive American wine collection
- **Korals Sushi & Cocktail Lobby Bar** – Sushi, trendy appetizers and cocktail bar
- **Maia** – Farm to table breakfast buffet and local favorites
- **Quinn's** – Local seafood, beach front favorites and home of the nightly Sunset Celebration
- **Kane** – Beachfront grill and tiki bar featuring Polynesian street fare and an extensive rum and cigar collection
- **400 Pazzi's** – Italian American fare with homemade pizza, salads and family style options
- **Café San Marco** – Featuring Illy® coffee, fresh pastries, grab and go items
- **Tesoro** – Adult-exclusive, Mediterranean fusion with an international wine program
- **10K Alley** – Gastropub and entertainment zone
- **Hammock Bay Grill** – Golf course favorites at Hammock Bay Golf & Country Club
- **Rookery Grill** – Golf course favorites at The Rookery at Marco

## ACCOMMODATIONS

- Sophisticated design accents
- Spa style bathrooms
- Balconies feature breathtaking views of Marco Island, four pools and the Gulf of Mexico
- Three unique suite collections, including newly renovated Terrace Suites
- Cottage style Lanai Suites
- Sirene, an all new adult exclusive experience

JW MARRIOTT®

MARCO ISLAND BEACH RESORT

400 South Collier Boulevard  
Marco Island, FL 34145

Tel 239.394.2511

[jwmarriottmarcoisland.com](http://jwmarriottmarcoisland.com)