

Overton Circle, Dyce  
Aberdeen AB21 7AZ  
Tel 0870 400 7291  
Fax 0870 400 7391  
AberdeenMarriott.co.uk  
Map ref 13

Ideally located on the northern side of Aberdeen, just 3 miles from the airport. The hotel boasts 7 conference rooms, accommodating up to 400 delegates for buffet receptions. All guest rooms are fully air-conditioned, with an executive level providing complimentary access to the executive lounge and business facilities. Relax in the indoor swimming pool and leisure club, before dining in the choice of two restaurants.

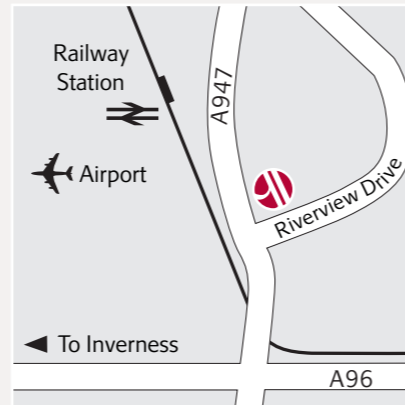

**Directions**  
Follow the A96 Aberdeen – Inverness road to Bucksburn Village, then turn right at the roundabout onto the A947 towards Banff and Oldmeldrum-Dyce. After about 2 miles you will see the hotel at the second roundabout. Aberdeen city centre 4 miles. Aberdeen Airport 2 miles. Courtesy coach to and from Aberdeen Airport subject to availability.



- Accommodation**
- 2 floors
  - 155 bedrooms
  - 80 non smoking bedrooms
  - 2 suites
  - 4 disabled bedrooms
  - The Marriott Bedroom (see page 5)

- Additional features**
- Air conditioning in bedrooms
  - Mini bar in bedrooms
  - 24hr room service
  - Laundry service
  - Safe deposit at reception
  - Safe in all bedrooms
  - Secretarial services
  - At least one WIFI hotspot in public areas
  - Executive lounge
  - Ice machines in public areas
  - Concierge
  - Onsite car parking

- Conference & Event facilities**
- 7 dedicated conference & meeting rooms
  - Max. no. of delegates 400 buffet reception
  - Marriott Communication Solutions

- Restaurants & lounges**
- Clavells Restaurant: Traditional dining with fine food & wine
  - Chats Cafe Bar: A casual cafe bar featuring modern European food

**Leisure facilities**  
Complimentary: Indoor heated swimming pool, spa bath, gymnasium & male and female sauna.  
Supplementary: Solarium.

**Car parking**  
200 free car parking spaces available for guests.

**Additional Marriott Hotels in Scotland include:**

- Marriott Dalmahoy Hotel & Country Club (see page 16)
- Edinburgh Marriott Hotel
- Glasgow Marriott Hotel (see page 22)
- Inverness Marriott Hotel



**The Pitmedden Suite.** A prestigious setting for conferences, exhibitions and gala dinners – with direct loading access. Suitable for up to 400 delegates, it can be easily divided into 3 sound proofed rooms

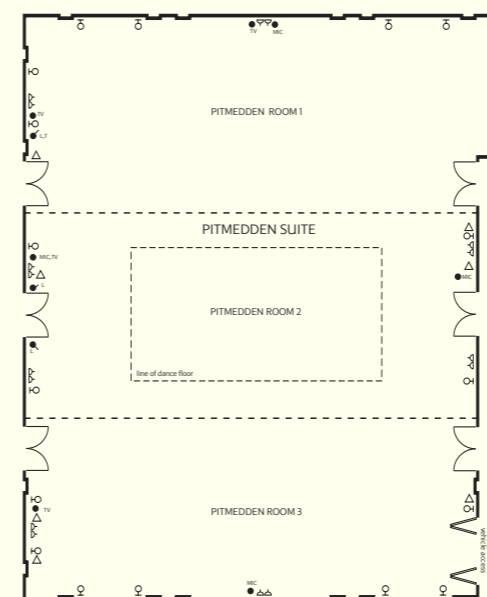

For key to symbols see page 65

	ROOM CAPACITIES (NO. OF DELEGATES)											
	THEATRE STYLE (FRONT PROJECTION)	THEATRE STYLE (BACK PROJECTION)	THEATRE STYLE (NO PROJECTION)	BOARDROOM STYLE	U-SHAPE	CLASSROOM STYLE	CABARET STYLE (NO PROJECTION)	CABARET STYLE (BACK PROJECTION)	CABARET STYLE (FRONT PROJECTION)	BUFFET RECEPTION	DINNER/DANCE	DINNER
Pitmedden Suite (1, 2, & 3)	300	200	300	-	-	150	90	70	90	400	280	320
Pitmedden Room (1)	100	80	100	30	30	40	30	25	30	100	-	60
Pitmedden Room (2)	100	80	100	30	30	40	30	25	30	100	-	60
Pitmedden Room (3)	100	80	100	30	30	40	30	25	30	100	-	60