

# Meeting planner guide

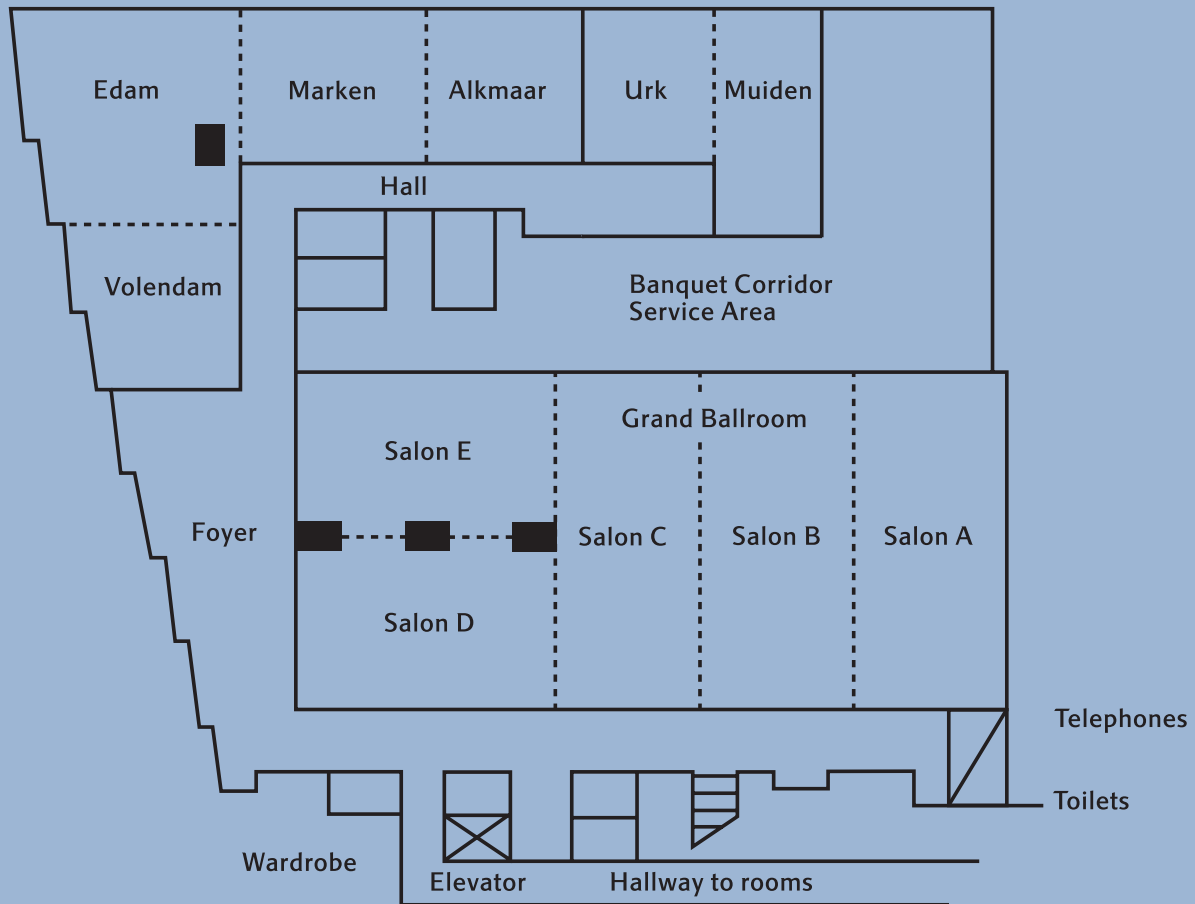

| Conference Rooms               | Dimensions            |                | Theatre | School | Dinner | Reception | Boardroom | U-Shape |
|--------------------------------|-----------------------|----------------|---------|--------|--------|-----------|-----------|---------|
|                                | (LxWxH)               | m <sup>2</sup> |         |        |        |           |           |         |
| Grand Ballroom, A, B, C, D & E | 14.3 x 30.7 x 3.5/2.5 | 439.0          | 450     | 230    | 350    | 600       | -         | -       |
| Salons A, B & C (separate)     | 14.3 x 6.5 x 3.5      | 93.0           | 120     | 54     | 70     | 100       | 58        | 40      |
| Salons D & E (separate)        | 11.2 x 6.5 x 2.5      | 73.0           | 80      | 30     | 50     | 70        | 28        | 30      |
| Salons A, B & C (combined)     | 14.3 x 19.5 x 3.5     | 279.0          | 400     | 200    | 240    | 300       | 65        | 75      |
| Salons D & E (combined)        | 11.2 x 13.0 x 2.5     | 146.0          | -       | 230    | 100    | 150       | -         | -       |
| Edam                           | 8.1 x 6.8 x 2.6       | 58.0           | 36      | 18     | 30     | 50        | 20        | 18      |
| Marken                         | 9.1 x 6.3 x 2.6       | 57.0           | 40      | 18     | 30     | 40        | 24        | 18      |
| Alkmaar                        | 6.4 x 6.3 x 2.6       | 40.0           | 30      | 12     | 30     | 30        | 24        | 12      |
| Urk                            | 3.15 x 6.70 x 2.40    | 21.0           | 20      | 9      | 6      | -         | 6         | -       |
| Muiden                         | 4.80 x 9.70 x 2.40    | 46.50          | 56      | 40     | 30     | 10        | 26        | 20      |
| Volendam                       | 6.7 x 4.5 x 2.6       | 31.0           | 20      | 9      | 20     | 20        | 12        | 8       |
| Volendam & Edam (combined)     | 14.8 x 5.8 x 2.6      | 86.0           | 90      | 33     | 60     | 90        | -         | 32      |