



Extraordinary events. Buckhead elegance.

Welcome to the JW Marriott® Atlanta Buckhead, a sophisticated hotel set in the heart of Atlanta's premier business, shopping and entertainment district. Enjoy events enhanced by personalized service that anticipates the needs of your group. Gather in stylish and flexible spaces. Then give your group a taste to remember. All within steps of the best of Atlanta.



Stylish meetings. Impeccably crafted.

Gather for graceful events large and small. With 21 chic meeting rooms, delicious catering, personalized service and our Event Concierge meeting app—we can help you craft truly memorable events. The highlight meeting space is the Phoenix Ballroom, divisible into six breakout rooms. And groups up to 100 enjoy taking their event to Nox Creek Southern Grill for a private taste of the best the region has to offer.

Grand gatherings. Stylish execution.

Meet in our largest gathering space, the Phoenix Ballroom, with 9,000 square feet and a maximum capacity of 1,200, ideal for making an impression on large groups. Also available is our Charleston room that can be divided into 2 smaller spaces as well as Nox Creek Southern Grill for private events.



Meeting Room	DIMENSIONS			CAPACITY				
	LxWxH	Sq. Ft.	Theater	Schoolroom	Reception	Banquet	Conference	U-Shape
Phoenix Ballroom	96x94x16	9,000	1,300	550	1,200	620	—	—
I - VI (each)	32x47x16	1,500	140	75	140	110	38	40
I & II, III & IV, or V & VI (combined)	32x94x16	3,000	300	150	200	220	—	—
II & IV, IV & VI, I & III, or III & V (combined)	64x47x16	3,000	390	160	200	220	—	—
I, III & V, or II, IV & VI (combined)	96x47x16	4,500	450	280	400	320	—	76
Atlanta	39x27x10	1,050	100	60	90	60	34	32
Charlotte	30x21x10	630	49	20	25	20	16	20
Columbia	40x35x10	1,400	100	50	90	60	34	30
Frankfurt	21x27x10	570	42	20	22	20	15	18
Jackson	19x34x10	650	49	27	40	30	22	22
Montgomery	17x25x8	425	24	18	20	20	14	15
Nashville	21x41x10	860	70	30	60	40	32	28
Raleigh	12x19x10	350	24	18	20	20	14	12
Charleston 1 & 2	—	2,400	115	60	225	170	42	38
Charleston 1	50x22x10	1,100	78	45	125	80	30	30
Charleston 2	48x27x10	1,300	—	—	100	70	22	24

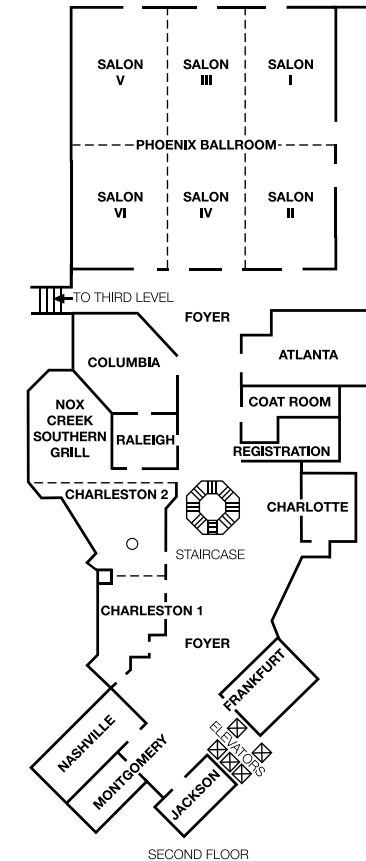

Great spaces. Naturally lit.

Reserve one or all of 5 meeting rooms with windows overlooking the neighborhood.



Meeting Room	DIMENSIONS		CAPACITY					
	LxWxH	Sq. Ft.	Theater	Schoolroom	Reception	Banquet	Conference	U-Shape
Richmond	38x25x10	950	80	42	80	60	30	30
Tallahassee	38x27x10	1,030	90	50	90	60	30	30
Savannah	29x25x10	730	70	42	60	50	22	26
Lexington	23x15x10	523	44	24	40	30	22	20
Augusta	18x21x10	542	40	18	40	30	16	16

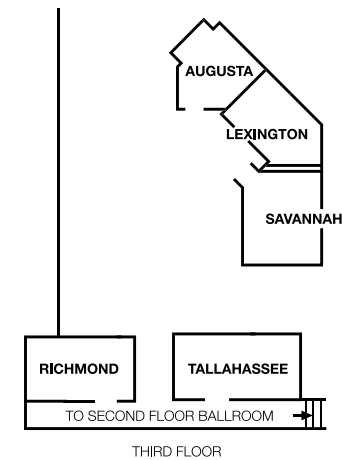

Cutting-edge technology. More successful events.

At JW Marriott Atlanta Buckhead we offer not only some of the most personalized serviced, but a level of attentiveness that anticipates your every need. And with our state-of-the-art technology like our JW Event Concierge, it's never been easier to hold a memorable meeting. We also offer professional in-house AV from American Audio Visual Company and Passkey for meeting planners, making sure you can deliver a world-class experience right from when your guests book all the way to the end of your event.

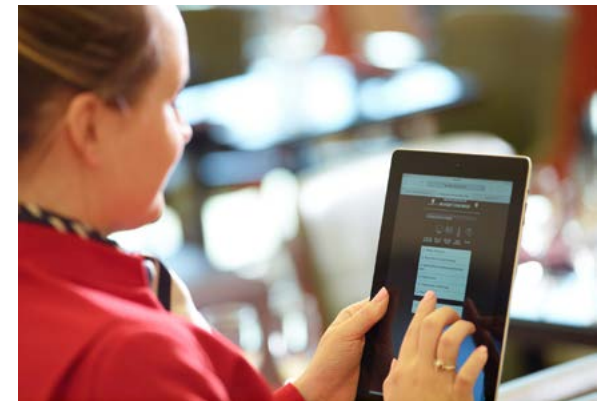



Delectable dishes. Authentically crafted.

We offer a full menu of delicious dining options for you and your guests. From healthy snacks to multi-course dinners, we can cater to any of your needs. You can also delight in locally-sourced, impeccably-created dishes from Nox Creek Southern Grill, where groups up to 100 can hold private catered events.

**FOR MORE INFORMATION ON OUR DELICIOUS CATERING
OPTIONS, SEE OUR [AUTHENTIC EVENTS MENU](#).**



Modern rooms. Elegantly appointed.

Retreat to any of our 367 well-appointed guest rooms with luxury bedding and picturesque views of downtown. All our rooms offer 37" LCD HDTVs, grand marble baths and plush bathrobes, making them the perfect place to relax after a long day. Guests can also upgrade to our sumptuous suites including the Presidential, Lenox, and Terrace Suites.



Detailed service. Intuitive technology.

Our talented staff anticipates and adapts to your needs. We offer mobile check-in, 2-tiered Internet and JW's symphony of service in which all of our property associations strive to be present, open, thoughtful and swift to meet guest needs ensure their stay is one of a kind. And for those in need of transportation during their stay, we also offer a complimentary car services within the Buckhead Business District.



Delicious options. Locally sourced.

We offer three unique dining options sure to capture any sophisticated taste. Nox Creek Southern Grill provides locally-sourced ingredients with artfully crafted dishes for breakfast and a delicious taste of Southern style for you and your group to enjoy. For more casual dining, Nox Creek Lounge offers lunch, dinner and cocktails in a sophisticated lounge setting. And if you're looking to kick start your day with a cup of freshly brewed Starbucks coffee or catch up on work with our free WiFi, Nox Creek Café is the place to visit.



Get fit, relax and unwind.

Splash into our refreshing indoor pool. Stay on track in our fitness center. Indulge in a nearby spa. Or melt the stress away in our relaxing saunas in each of our men's and women's locker rooms.



Numerous options. Right on your doorstep.

Step out of your room and be within easy MARTA access from downtown attractions and shopping. Explore, the Georgia Aquarium, World of Coca Cola and CNN Center. Experience, LEGOLAND®, the Atlanta History Center and Chastain Park. Attend sporting events and concerts at the Georgia Dome and Philips Arena. Or enjoy world-class shopping at the connected Lenox Square and nearby Phipps Plaza.