

ATLANTA MARRIOTT MARQUIS

265 Peachtree Center Avenue
Atlanta, GA 30303
Phone 404.521.0000
Fax 404.586.6299
AtlantaMarquis.com



ACCOMMODATIONS

50 floors • 1,569 rooms • 94 suites •
6 concierge levels

RESTAURANTS & LOUNGES

High Velocity, As one of the largest sports bars in downtown, *High Velocity* is an energetic, classic American restaurant known for its tasty pub fare with twenty-one plasma screens and delectable appetizers • *Sear*, Dining reaches new heights of sophistication with sizzling fire-inspired steaks and succulent seafood • *Sear Bar*, More than a mere side bar, it's the place to indulge in a classic cocktail as a prelude to your meal, or can be a destination all its own, complete with temperature controlled wine vaults • *Pulse*, Discover the art of mixology with a twist, at a classically cool cocktail lounge providing a relaxing atmosphere and an amazing 50-foot color changing sail, representing the heart of the revitalized Marquis • *Starbucks*®, Stop by for your favorite signature coffee drinks, light snacks and pastries • *M:Store*, Shop for gifts and sundries or pick up to-go items for breakfast, lunch and dinner

RECREATION & LEISURE

Outdoor/indoor pool • 24-hour fitness center • The Spa, specializing in express treatments • Nearby bowling and golf

ATTRACTIONS

Georgia Aquarium • World of Coca-Cola • Zoo Atlanta • CNN Center • Fernbank Science Center • High Museum of Art • Martin Luther King, Jr. Center • Turner Field • Georgia Dome • Stone Mountain Park

GUEST SERVICES

High-speed Internet access in guest rooms • Wireless Internet access in public spaces

MEETING FACILITIES

84 meeting rooms • 160,000 square feet of total meeting space • Largest meeting room is the 25,005 square-foot Atrium Ballroom with meeting capacity for up to 2,500 • Maximum of 61 breakout meeting rooms • Exhibition space on-site

LOCATION

Conveniently located in Peachtree Center • Indoor connection to MARTA • Short 15-minute ride to Hartsfield-Jackson Atlanta International Airport

I THINK I'VE REDISCOVERED
THE PERFECT MEETING DESTINATION.

Marriott.
ATLANTA MARQUIS



Step into an exciting mix of business and pleasure at Atlanta Marriott® Marquis. With 160,000 square feet of on-site meeting space, 84 meeting and breakout rooms and the 25,000 sophisticated square feet of space in the Atrium Ballroom, it's the perfect venue for Atlanta events. When happy hour begins, mix it up at *Pulse*, a hip cocktail lounge highlighted by a 50-foot color changing sail, or take dinner to the next level at *High Velocity*, an energetic, American pub. With indoor MARTA access and the Hartsfield-Jackson Atlanta International Airport just 15 minutes away, it's easy to get where you need to go. Conveniently located in downtown Peachtree Center, just steps away from Georgia Aquarium, World of Coca-Cola, Centennial Olympic Park and a few blocks from the Georgia World Congress Center, Philips Arena, and Georgia Dome, it's all at your fingertips.



Marquis Level

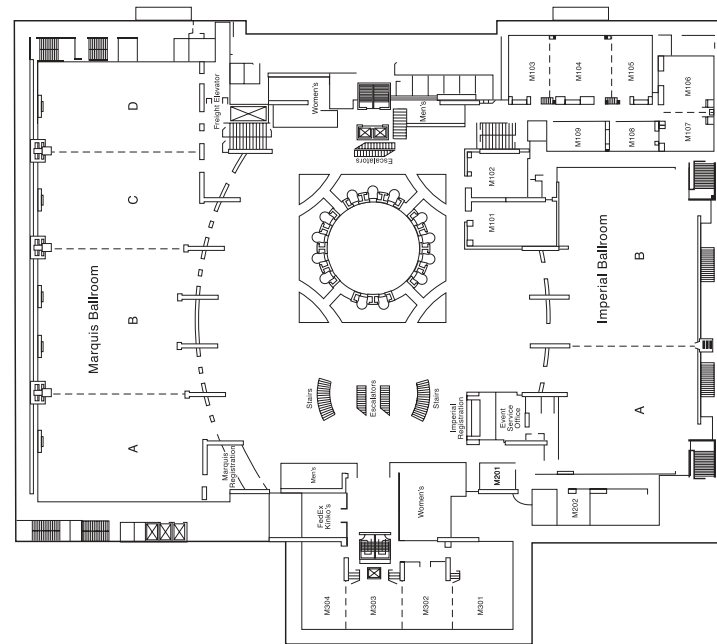

Meeting Room	Dimensions		Capacity					
	W×L×H	Sq. Ft.	Theater	Schoolroom	Conference	U-Shape	Reception	Banquet
Marquis Ballroom	89×247×18	21,983	2,220	1,500	—	—	2,200	1,780
MQ Salon A	89×59×18	5,251	540	350	—	—	500	430
MQ Salon B	86×82×18	7,052	720	460	—	—	700	570
MQ Salon C	89×55×18	4,895	500	300	—	—	480	400
MQ Salon D	89×51×18	4,539	450	300	—	—	450	400
Imperial Ballroom	92×170×18	15,640	1,330	860	—	—	1,300	1,060
Salon A	92×72×18	6,624	550	360	—	—	500	440
Salon B	92×98×18	9,016	770	500	—	—	750	620
M101	25×47×10	1,175	100	70	—	—	90	80
M102	25×31×10	775	75	50	—	—	60	60
M103	34×22×10	748	75	50	—	—	50	50
M104	34×34×10	1,156	100	70	—	—	90	80
M103 & M104 (Combined)	34×56×10	1,904	190	120	—	—	180	130
M105	34×22×10	748	75	50	—	—	50	50
M104 & M105 (Combined)	34×56×10	1,904	190	120	—	—	180	130
M103, M104 & M105 (Combined)	34×78×10	2,652	275	170	—	—	250	180
M106	28×31×10	868	80	54	—	—	70	60
M107	28×22×10	616	55	36	—	—	60	40
M106 & M107 (Combined)	28×53×10	1,484	140	90	—	—	130	100
M108	17×26×10	442	40	28	—	—	30	30
M109	17×33×10	561	55	36	—	—	40	40
M201	20×15×9	300	30	18	—	—	20	10
M202	44×18×10	792	74	52	—	—	70	60
M301	48×35×10	1,680	155	104	—	—	140	110
M302	36×31×10	1,116	96	65	—	—	80	60
M301 & M302 (Combined)	48×121×10	5,808	—	150	—	—	180	150
M303	28×27×10	756	80	56	—	—	70	50
M302 & M303 (Combined)	48×121×10	5,808	—	110	—	—	150	110
M304	48×28×10	1,344	113	78	—	—	100	90
M303 & M304 (Combined)	48×121×10	5,808	—	100	—	—	150	100



Lobby Level

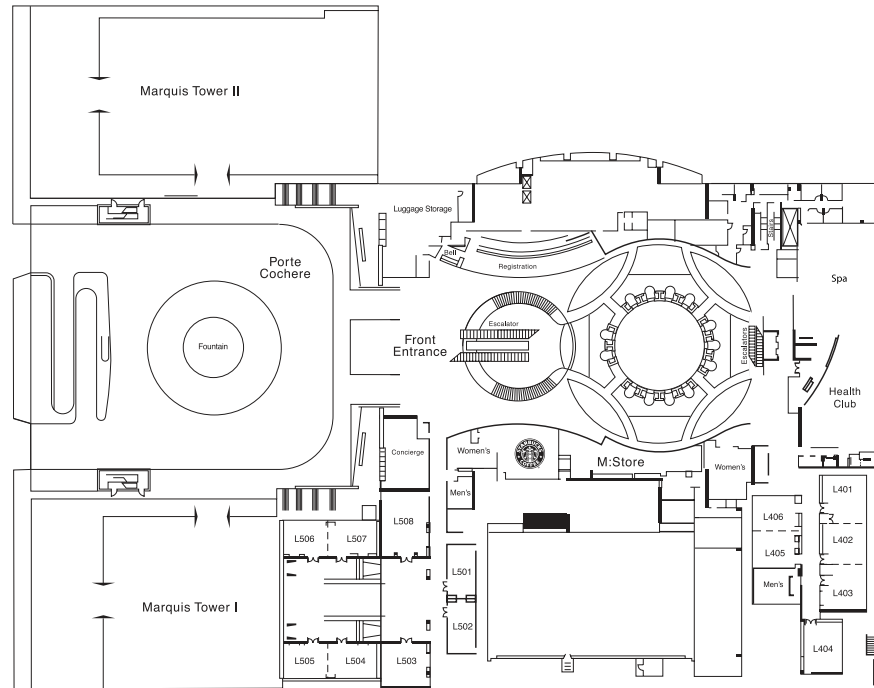

Meeting Room	Dimensions		Capacity					
	WxLxH	Sq. Ft.	Theater	Schoolroom	Conference	U-Shape	Reception	Banquet
L401	26x25x9	650	60	40	—	—	50	40
L402	25x30x9	750	70	46	—	—	80	50
L401 & L402 (Combined)	25x56x9	1,400	130	84	—	—	140	100
L403	24x24x9	576	55	38	—	—	50	40
L402 & L403 (Combined)	25x54x9	1,350	130	84	—	—	140	100
L401, L402 & L403 (Combined)	25x80x9	2,000	190	130	—	—	200	150
L404	22x28x9	616	60	40	—	—	80	40
L405	25x21x9	525	50	34	—	—	40	40
L406	25x21x9	525	50	34	—	—	40	40
L405 & L406 (Combined)	25x54x9	1,350	100	65	—	—	75	80
L501 Boardroom	16x30x9	480	—	—	—	—	—	—
L502 Boardroom	16x30x9	480	—	—	—	—	—	—
L503	26x26x9	676	65	42	—	—	50	40
L504	19x28x11	532	50	32	—	—	50	40
L505	19x27x11	513	50	34	—	—	50	40
L504 & L505 (Combined)	19x55x11	1,045	100	68	—	—	90	80
L506	19x27x11	513	50	34	—	—	50	40
L507	19x27x11	513	50	32	—	—	50	40
L506 & L507 (Combined)	19x54x11	1,026	100	68	—	—	90	80
L508	23x37x9	851	100	70	—	—	90	80



Atrium Level

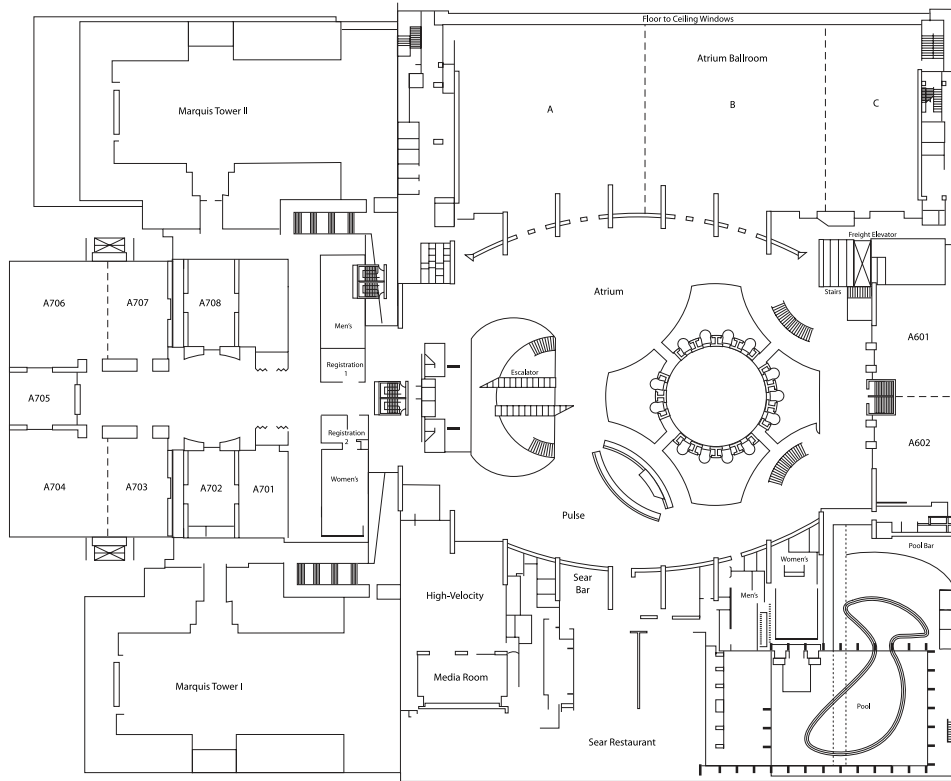

Meeting Room	Dimensions		Capacity					
	W×L×H	Sq. Ft.	Theater	Schoolroom	Conference	U-Shape	Reception	Banquet
Atrium Ballroom	110×238×30	25,005	2,500	1,600	—	—	2,500	2,000
Atrium Ballroom A	105×110×30	11,170	1,110	720	—	—	1,110	880
Atrium Ballroom B	105×110×30	11,385	1,110	720	—	—	1,110	880
Atrium Ballroom C	110×23×30	2,450	240	140	—	—	225	180
A601	45×54×10	2,430	240	156	—	—	250	190
A602	45×54×10	2,430	240	156	—	—	250	190
A601 & A602 (Combined)	45×108×10	4,860	480	310	—	—	500	380
A701	25×45×10	1,125	110	70	—	—	120	70
A702	24×40×10	960	95	62	—	—	100	60
A703	31×51×10	1,581	150	100	—	—	160	120
A704	52×51×10	2,652	260	170	—	—	280	200
A703 & A704 (Combined)	85×52×10	4,420	420	270	—	—	450	320
A705	36×34×10	1,224	120	78	—	—	130	90
A706	52×51×10	2,652	260	170	—	—	250	200
A707	31×51×10	1,581	160	100	—	—	180	120
A706 & A707 (Combined)	83×52×10	4,316	420	270	—	—	450	320
A708	24×45×10	1,080	105	68	—	—	120	80



International Level

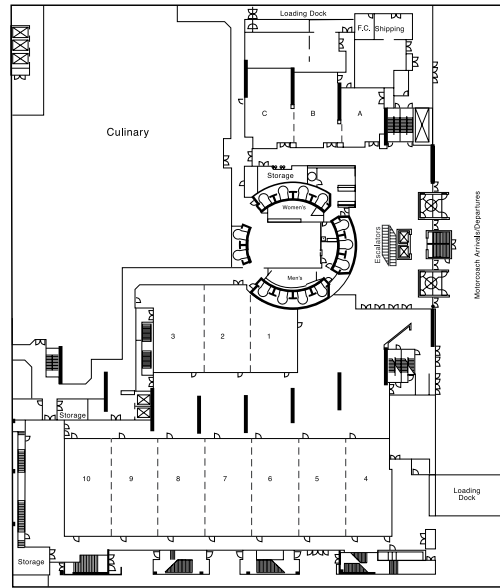

Meeting Room	Dimensions		Capacity					
	WxLxH	Sq. Ft.	Theater	Schoolroom	Conference	U-Shape	Reception	Banquet
International Ballroom 4-10	192x56x10	10,730	990	400	—	—	1,600	650
International 1-10 Pre-function	—	—	—	—	—	—	1,100	191
International Hall	—	—	1,860	522	—	—	4,600	2,200
International 1	28x36x10	996	90	40	—	—	75	40
International 2	28x44x10	1,217	110	60	—	—	100	60
International 3	28x50x10	1,383	130	70	—	—	150	80
International 4	26x56x10	1,459	160	90	—	—	200	100
International 5	28x56x10	1,549	180	110	—	—	200	100
International 6	28x56x10	1,549	180	110	—	—	200	100
International 7	28x56x10	1,549	180	110	—	—	200	100
International 8	28x56x10	1,549	180	110	—	—	200	100
International 9	28x56x10	1,549	180	110	—	—	200	100
International 10	28x56x10	1,549	180	110	—	—	200	100
International A	34x24x10	822	80	36	—	—	50	40
International B	28x44x10	1,217	100	50	—	—	80	60
International C	30x47x10	1,379	20	60	—	—	100	80

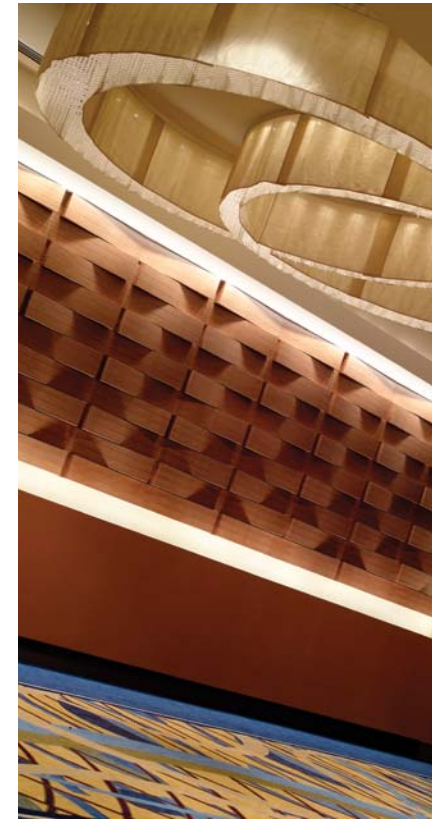

Skyline Level

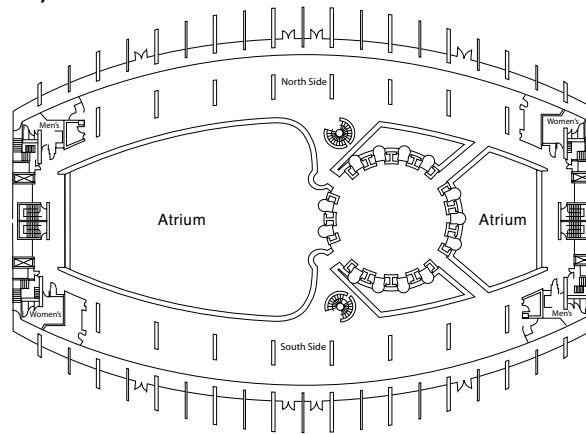

Meeting Room	Dimensions		Capacity					
	W×L×H	Sq. Ft.	Theater	Schoolroom	Conference	U-Shape	Reception	Banquet
Skyline North & South (Combined)	—	—	—	—	—	—	1,100	—