



## REVITALIZE AT ATLANTA'S **RUNWAY** RETREAT.

What do you get when you combine personalized service, extraordinary surroundings and complimentary transportation to the adjacent Hartsfield-Jackson Atlanta International Airport? A superior hotel experience. And you can find it at the Renaissance® Concourse Atlanta Airport Hotel. Witness the illustrious architectural design of a striking 11-story interior atrium. Relax in one of 387 soundproof guest rooms with magnificent airport views, private balconies and deluxe amenities. Whether you're here for business or pleasure, you'll discover 35,000 square feet of incomparable meeting space, with unmatched service to handle every detail. Take a departure from a typical airport hotel—with the sophisticated elegance of the Renaissance Concourse Atlanta Airport Hotel.

RENAISSANCE CONOURSE ATLANTA AIRPORT HOTEL  
One Hartsfield Centre Parkway, Atlanta, GA 30354  
t: 404.209.9999 f: 404.305.2343 • [renaissanceconcourse.com](http://renaissanceconcourse.com)

**R**  
**RENAISSANCE®**  
CONOURSE ATLANTA AIRPORT HOTEL

MEETING ROOM	W x L x H	SQ. FEET	THEATER	SCHOOLROOM	U-SHAPE	RECEPTION	BANQUET
--------------	-----------	----------	---------	------------	---------	-----------	---------

**BANQUET LEVEL**

Concourse Ballroom	125x88x13.5	11,000	1,500	700	—	1,200	770
Concourse Ballrooms A or B	48x44x13.5	2,112	208	126	53	180	160
Concourse Ballrooms C or D	56x44x13.5	2,464	300	150	59	250	200
Concourse Corridor	21x88x13.5	1,848	150	126	—	200	160
Pre-function East		2,975	—	—	—	400	300
Pre-function South		1,700	—	—	—	200	—
da Vinci	38x36x10	1,368	90	70	38	100	100
da Vinci I or II	19x36x10	684	40	36	29	60	50
de Gaulle	39x27x10	1,053	100	50	35	80	70
Dorval	16x27x10	432	35	24	23	30	30
Kai Tak	28x16x10	448	40	24	23	35	30
Narita	38x27x10	1,026	100	45	32	80	70
Hartsfield Boardroom	22x16x10	352		Permanent seating for 12			
Hartsfield Ante Room	16x15x10	240	—	—	—	—	—
Templehof	27x23x10	621	50	30	26	30	40
Heathrow Boardroom	17x22x8	374		Permanent seating for 10			

**ATRIUM LEVEL**

Dublin	24x22x10	528	50	27	20	35	40
Gatwick	22x18x10	396	40	18	18	25	30
Lambert	42x22x10	924	100	50	38	80	50
Shannon I	25x40x10	1,000	100	45	32	80	70
Shannon II	25x29x10	725	75	30	28	60	50
Shannon I & II Combined	25x69x10	1,725	190	88	48	140	140
Candler Private Dining	30x23x10	690	35	18	21	40	30

**THIRD FLOOR**

Dulles	28x19x8	532	50	24	26	40	30
Hobby, Hopkins, Kennedy, LaGuardia, Logan, McCarran, Midway, National, O'Hare	27x19x8	513	50	24	26	40	30
Sea Tac	27x24x8	648	60	36	29	50	40
Veranda			—	—	—	150	100

**LOBBY LEVEL**

Lobby South		2,500	—	—	—	150	150
-------------	--	-------	---	---	---	-----	-----

**BANQUET LEVEL**

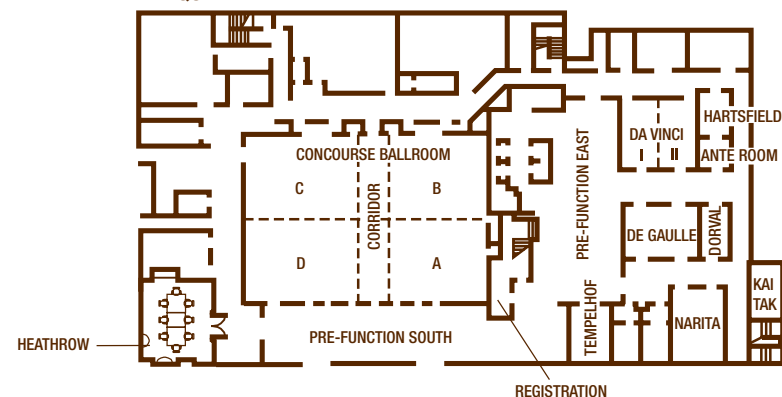

**ATRIUM LEVEL**

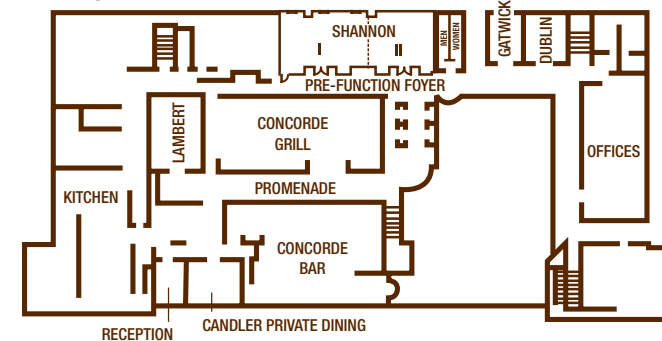

**THIRD FLOOR**

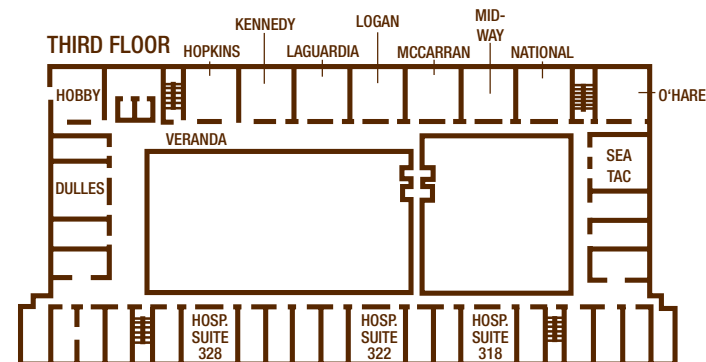

**WE ARE HERE**

Easily accessible from all of Atlanta's major expressways • Situated adjacent to Hartsfield-Jackson Atlanta International Airport offering complimentary airport transportation

**THE DETAILS**

11 floors • 380 rooms • 7 suites • 1 concierge level

**SIP AND SAVOR**

Concorde Grill, Critically acclaimed Atlanta restaurant which features continental cuisine with a Mediterranean twist • Concorde Bar, Top Atlanta restaurant bar which boasts a relaxed atmosphere overlooking the runways

**A LITTLE FUN AND RELAXATION**

Indoor lap pool • Outdoor pool • Whirlpool • 24-hour fitness center • Sauna • Outdoor running course • Plane watching • Nearby golf

**THE EXTRAS**

High-speed Internet access in guest rooms • Wireless Internet access in public spaces and meeting rooms

**LOCAL FINDS**

Georgia International Convention Center • Atlanta Motor Speedway • Spivey Hall • Camp Creek Marketplace • Main Street College Park Shopping • Georgia Aquarium • Turner Field • World of Coca-Cola • Zoo Atlanta • Six Flags® Over Georgia • Martin Luther King Center • Lakewood Amphitheatre • Georgia Dome • CNN Center

**THE PLACE TO MEET**

30 meeting rooms • 35,000 square feet of total meeting space • Largest meeting room is Concourse Ballroom with maximum meeting space of 11,000 square feet and maximum seating capacity of 1,500 • Maximum of 28 breakout meeting rooms • 3 flexible atrium pre-function areas with seating for 100, 150 and 300 or up to 40 trade show exhibits