



ACCOMMODATIONS

9 floors • 262 rooms • 3 suites • Concierge level available • Wired for Business Package includes: wired and wireless high-speed Internet access and local and domestic long distance calls • Telephone with voice mail • Mini-refrigerator • Individual climate control • AM/FM alarm clock radio • Free cable TV with in-room pay movies • In-room coffee service • Smoke-free hotel • Check-in: 4:00 p.m. • Check-out: 12:00 noon

RESTAURANTS & LOUNGES

Champions Sports Bar, featuring a traditional American menu (lunch/dinner) • Currents, featuring an eclectic continental menu and great bistro ambience (breakfast/lunch/dinner) • Currents Bar

RECREATION & LEISURE

Fitness Center • Indoor pool and whirlpool • Biking trail (10 mi) • Horseback riding (10 mi) • Miniature golf (7 mi) • Snow skiing (20 mi) • Tennis (3 mi) • Several golf courses nearby • Ochoa Day Spa (Appointment required) • Spa Europa (Appointment required)

ATTRACTIONS

Basketball Hall of Fame • Six Flags New England • Springfield Symphony • Eastern States Exposition • Yankee Candle Company • Dr. Seuss Museum • City Stage Theatre • Holyoke Mall • Forest Zoo Park • Magic Wings Butterfly Museum • Eric Carle Museum • Smith Wesson Gun Museum

GUEST SERVICES

Concierge desk • Full-service business center • Safe deposit boxes (front desk) • Onsite parking • Local restaurant dinner delivery

MEETING FACILITIES

Over 11,000 square feet of indoor banquet space • 6,000 square foot Grand Ballroom, divisible into 4 sections • Flexible function space offers a variety of settings for smaller gatherings • Over 10,000 square feet of landscaped outdoor space for tented receptions and creative parties • Catering services include everything from customized menus to theme parties • Professional events team to oversee every detail

MAKE YOUR EVENT A SLAM DUNK SUCCESS.

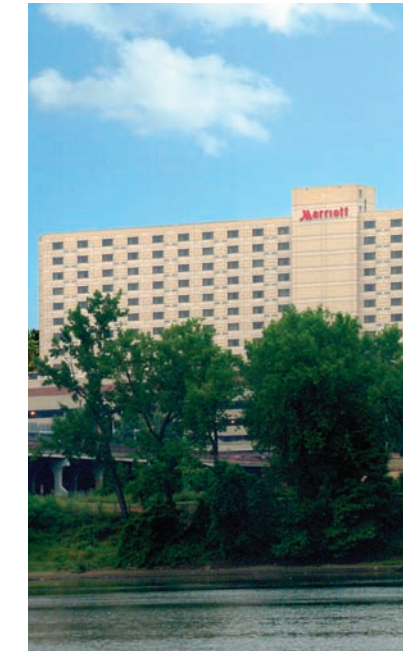

SPRINGFIELD MARRIOTT

2 Boland Way
Springfield, Massachusetts 01115
Phone: 413-781-7111
Fax: 413-731-8932
SpringfieldMarriottMA.com

Bring your event to Springfield, home of the Basketball Hall of Fame, and the gateway to all the attractions of Western Massachusetts and the Berkshires. With 11,000 square feet of event space, we're ready to tackle anything you can throw at us: meetings, conferences or events of any size. You also have more than 10,000 square feet of landscaped outdoor space for tented receptions and creative parties. For great events in the heart of downtown Springfield, indoors and out, you'll score some serious points here. The feeling is stylish. The service is top-notch. And we're just twenty minutes from Bradley International Airport.

SPRINGFIELD MARRIOTT

2 Boland Way
Springfield, Massachusetts 01115
Phone: 413-781-7111
Fax: 413-731-8932
SpringfieldMarriottMA.com

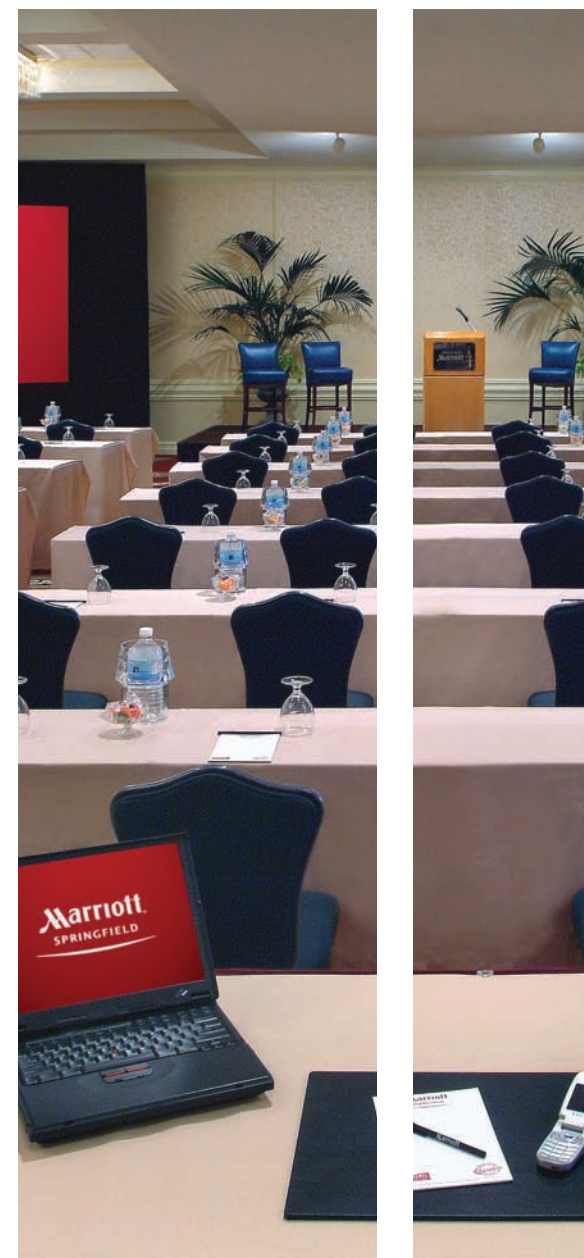
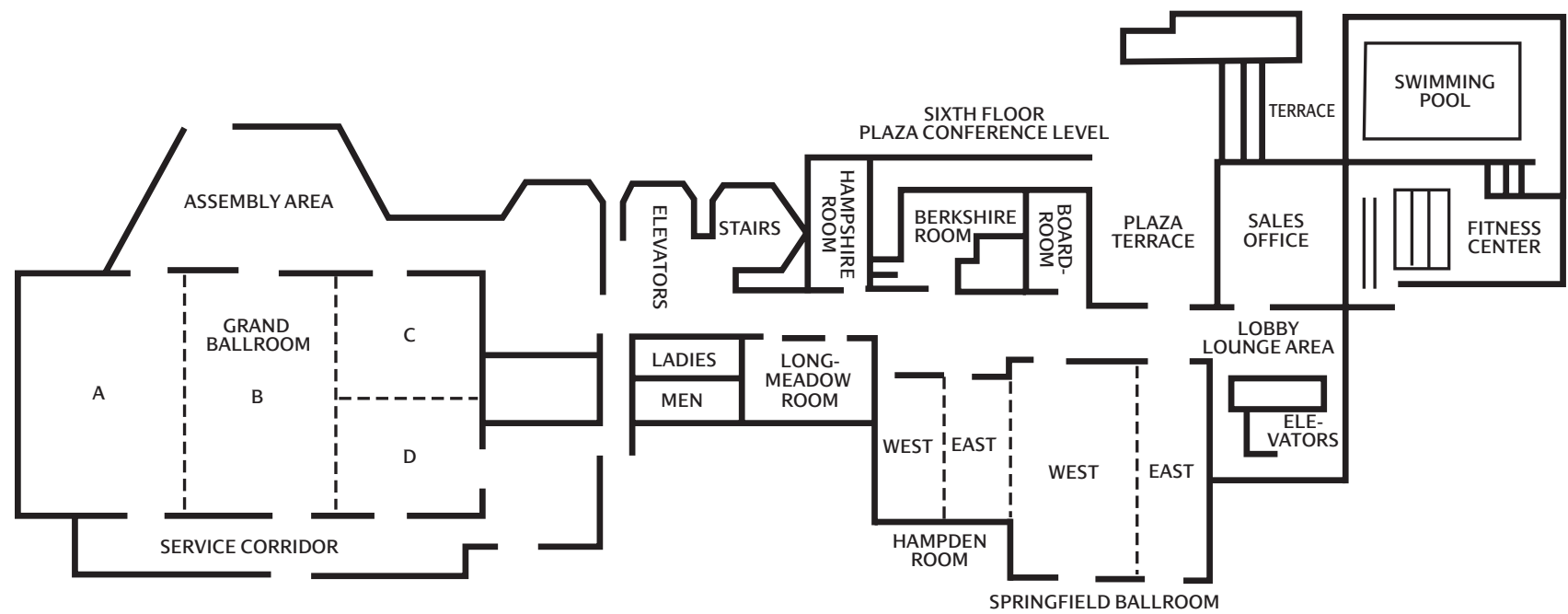

Meeting Room	Dimensions		Capacity					
	WxLxH	Sq. Ft.	Theater	Schoolroom	Conference	U-Shape	Reception	Banquet
Grand Ballroom	110x55x12	6,050	900	600	–	–	900	560
Salon A	36x55x12	2,007	200	135	–	50	200	150
Salon B	36x55x12	2,007	200	135	–	50	200	150
Salon C	36x30x12	1,113	100	55	30	35	100	80
Salon D	36x24x12	894	70	40	30	35	70	60
Assembly Area		3,700	–	–	–	–	450	–
Springfield Ballroom		3,650	300	170	–	–	300	300
Springfield East	22x46x12	1,012	90	60	30	35	90	80
Springfield West	38x46x12	1,748	175	90	30	45	175	140
Hampden Room	16x30x10	980	70	50	30	30	70	80
East	15x30x10	450	30	15	20	–	30	30
West	15x30x10	450	30	15	20	–	30	30
Longmeadow Room	11x9x6	99	–	–	–	–	–	–
Hampshire	15x28x7	420	25	15	20	–	25	30
Boardroom (1)	31x20x8	620	–	–	14	–	–	–
707 (not shown)	15x31x10	465	–	–	12	–	20	–
708 (not shown)	15x31x10	465	–	–	12	–	20	–
Berkshire	31x16x7	495	50	25	20	20	50	50
Outdoor Plaza		10,000	–	–	–	–	–	–