

**JUST BEYOND BOSTON.
FAR BEYOND ACCOMMODATING.**

Marriott
BOSTON BURLINGTON



MEET LIKE YOU MEAN BUSINESS.

With 18 flexible meeting rooms, 13,000 square feet of total meeting space, a Grand Ballroom that can seat up to 1,000 people theater style, and a state-of-the-art Executive Boardroom, we've got the space you need for your next meeting no matter the size. Accommodate your attendees in our 415 well-appointed guest rooms, impress them with a unique dining experience in our restaurant, Summer Winter, by award-winning chefs Mark Gaier and Clark Fraiser, and let them relax in our indoor and outdoor pools and fitness center. And now that we have the prestigious ENERGY STAR® label from the E.P.A., your meeting at our hotel will also be green. It all makes for a high-impact conference with a low environmental impact.

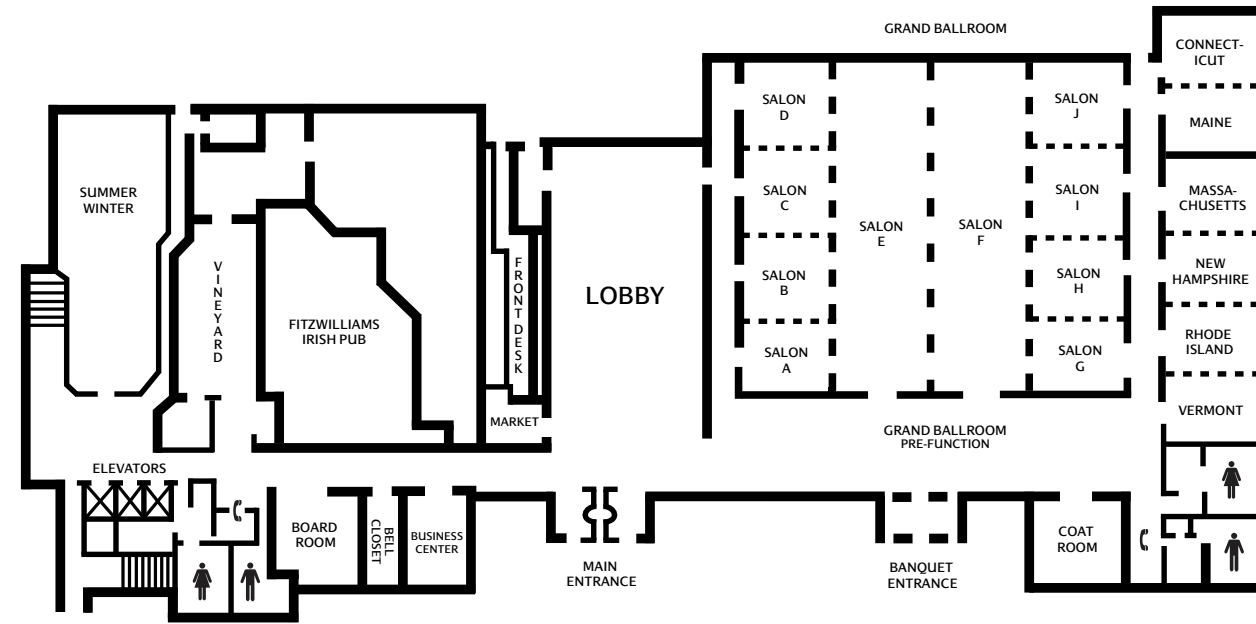

Meeting Room	Dimensions		Capacity					
	W×L×H	Sq. Ft.	Theater	Schoolroom	Conference	U-Shape	Reception	Banquet
Grand Ballroom	75×120×13	9,000	1,000	500	–	–	1,000	650
Salons A-E or F-J	75×60×16	4,500	600	250	–	–	460	300
Salons A, B, C, D, G, H, I or J	18×26×13	488	50	25	18	15	40	30
Salons E or F	34×75×16	2,550	300	150	50	50	300	180
Connecticut	18×27×12	495	50	25	18	15	40	30
Maine	18×27×12	495	50	25	18	15	40	30
Massachusetts	18×27×12	495	50	25	18	15	40	30
New Hampshire	18×27×12	495	50	25	18	15	40	30
Rhode Island	18×27×12	495	50	25	18	15	40	30
Vermont	18×27×12	495	50	25	18	15	40	30
Vineyard	18×27×13	600	50	25	22	15	40	30
Boardroom	15×25×10	375	–	–	14	–	–	–

BOSTON MARRIOTT BURLINGTON

One Burlington Mall Road
Burlington, Massachusetts 01803
Phone: 781-229-6565
Fax: 781-229-7973
BurlingtonMarriott.com



ACCOMMODATIONS

415 guest rooms • 4 suites • Wired and wireless high-speed Internet access • Ultra-compatible Plug-in Panel to connect MP3, digital camera and gaming system • Concierge lounge and level with upgraded amenities • ADA accessible rooms • Individual climate control • 37" flat screen TVs • Cable TV with movie channels and in room pay movies • AM/FM alarm clock radio • Complimentary in-room coffee and tea service • Smoke-free hotel policy

RESTAURANTS & LOUNGES

Summer Winter featuring fresh food for every season using locally and greenhouse grown ingredients (breakfast/lunch/dinner) • Summer Winter menu inspired by James Beard Award Winning Chefs Mark Gaier and Clark Frasier • Fitzwilliams Irish Pub serving traditional Irish favorites • The Coffee Bar featuring Starbucks® coffees, cappuccino and freshly baked breakfast pastries and bagels daily

RECREATION & LEISURE

Indoor and outdoor pool • 24-hour fitness center with separate cardio and weight rooms • Individual TVs on all cardio equipment • Whirlpool • Sauna • Golf (nearby) • Tennis (nearby)

ATTRACTIONS

Burlington Mall • Lahey Clinic • Lexington and Concord • Hanscom AFB • Historic Boston • Boston colleges and universities • Historic North Shore towns • Minuteman National Park • Walden Pond • Wayside Commons

GUEST SERVICES

Complimentary parking • Concierge services • Wireless Internet access available in all public space • Complimentary guest laundry • Valet laundry service • Safe-deposit boxes • Notary public • Lobby Shop/market • ATM • Self-service business center • Soda, ice and snack machines • Hertz car rental available • Complimentary shuttle service to Lahey Clinic, Burlington Mall, Wayside Commons and local offices

MEETING FACILITIES

A total of 18 meeting rooms with 13,000 sq. ft. of flexible meeting and banquet space all located on one level • 9,000 sq. ft. Grand Ballroom, divisible into 10 sections, accommodates up to 1,000 for receptions and 650 for banquets. • Seven meeting rooms of 500 sq. ft. each • State-of-the-art Executive Boardroom • Outdoor reception area for up to 100 people • A variety of creative menus and theme parties • Indian cuisine available • In-house audio-visual department • High-speed Internet access in all meeting rooms • Dedicated Event Manager to oversee all details • Red Coat service team to provide prompt attention to every request • Videoconferencing and teleconferencing capabilities