

we are here

Situated 26 miles from downtown Chicago | Conveniently located near Woodfield Mall, offering world-class shopping and upscale dining

essentials

16 floors | 474 rooms | 26 suites | 2 concierge levels

house flavor

Gather | Sam & Harry's Steakhouse, famed for USDA Prime steaks and fresh seafood, 50 wines available by the glass | Wintergarden Cafe, where we proudly brew Starbucks® coffee, and offer light fare, gifts and sundries

at your leisure

Fitness center | Indoor pool (mineral-based filtration) | Whirlpool | Hiking | Jogging/fitness trail | Nature preserve trail | Squash | Tennis | Snow skiing at Raging Buffalo Snowboard Park and Villa Olivia | Golf at Schaumburg Park District Golf, Indian Lakes Golf Resort, Arlington Lakes Golf Course and Fox Run Golf Links

the royal treatment

Wired and wireless Internet access in guest rooms | Wireless Internet access in public spaces | Full-service business center

local treasures

Arlington Park Race Track | Woodfield Mall | Lynfred Winery | Streets of Woodfield Entertainment Complex | IKEA | Long Grove Historical Village | Sears Centre | Schaumburg Flyers Baseball | Medieval Times

the place to meet

30 meeting rooms | 148,624 square feet of total meeting space | Largest meeting room is Schaumburg Convention Center with maximum meeting space of 97,200 square feet and maximum seating capacity of 6,300 | Maximum of 30 breakout meeting rooms | Exhibition space on-site



RENAISSANCE
SCHAUMBURG
HOTEL & CONVENTION CENTER

Renaissance Schaumburg Hotel & Convention Center

1551 North Thoreau Drive | Schaumburg, Illinois 60173 | t: 847 303 4115 | f: 847 303 4149 | RenaissanceSchaumburg.com | 1 800 Hotels 1 | SchaumburgConventionCenter.com

CHRS © 2008 Renaissance Hotel Holdings, Inc.



Plan something provocative.



RENAISSANCE
SCHAUMBURG
HOTEL & CONVENTION CENTER

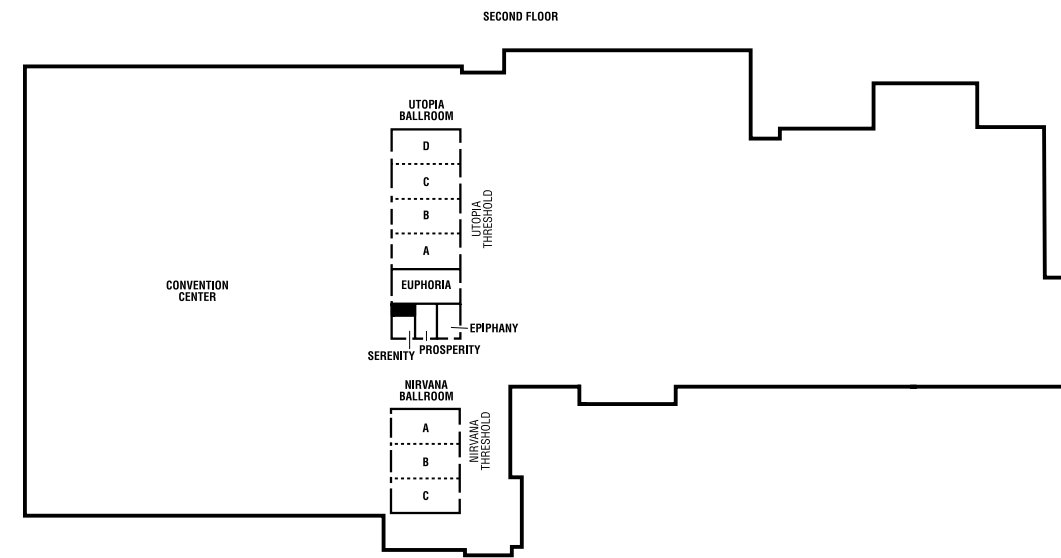
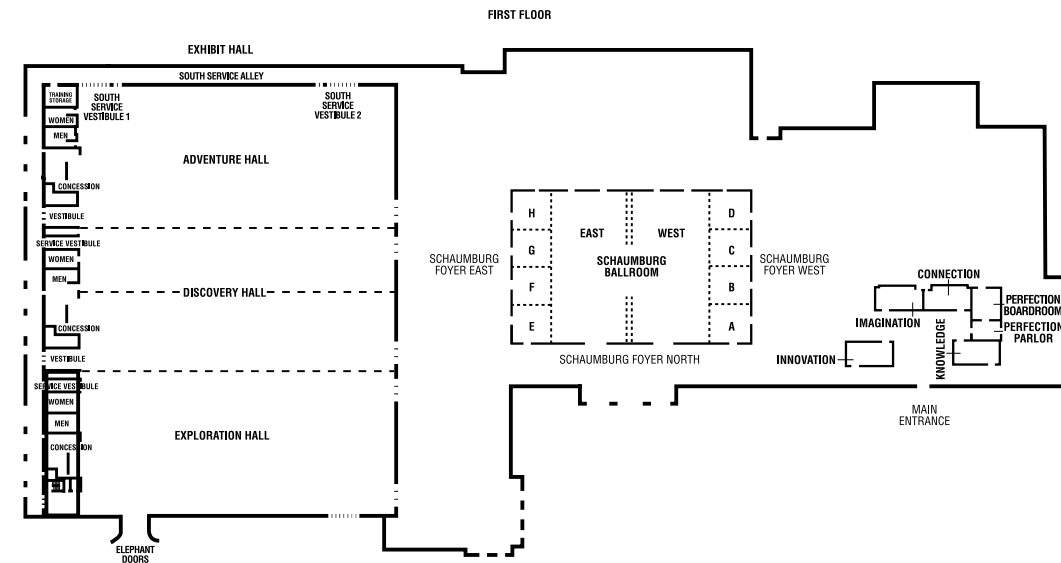

Meeting Room	L	W	H	Sq. Ft.	Theater	Schoolroom	Conference	U-Shape	Reception	Banquet
Schaumburg Convention Center	360'	270'	30'	97,200	6,300	4,800	—	—	6,300	5,100
Exploration Hall	119'	270'	30'	32,130	2,100	1,600	—	—	2,100	1,700
Discovery Hall	120'	270'	30'	32,400	2,100	1,600	—	—	2,100	1,750
Adventure Hall	121'	270'	30'	32,670	2,100	1,600	—	—	2,100	1,700
Exploration + Discovery	239'	270'	30'	50,000	4,387	1,930	—	—	3,270	3,075
Adventure + Discovery	241'	270'	30'	50,000	4,387	1,946	—	—	3,300	3,075
Show Offices - each (10, not shown)	12'	13'	11'	156	—	—	—	—	—	—
Convention Center Pre-function Area	—	—	—	19,000	—	—	—	—	3,000	—
Schaumburg Ballroom	208'	13'	22'	27,502	2,400	1,080	—	—	3,800	1,700
Schaumburg Foyer West	158'	20'	11'	3,621	—	—	—	—	517	—
Schaumburg Foyer North	211'	39'	11'	8,178	—	—	—	—	1,168	—
Schaumburg West + East	130'	140'	22'	17,680	1,700	900	—	—	2,500	1,200
Schaumburg Center East	130'	68'	22'	8,840	800	450	—	—	1,250	600
Schaumburg Center West	130'	68'	22'	8,840	800	450	—	—	1,250	600
Schaumburg A	34'	34'	22'	1,156	100	60	28	32	150	80
Schaumburg B	34'	34'	22'	1,088	100	60	28	32	150	80
Schaumburg C	34'	34'	22'	1,088	100	60	28	32	150	80
Schaumburg D	34'	34'	22'	1,156	100	60	28	32	150	80
Schaumburg E	34'	34'	22'	1,156	100	60	28	32	150	80
Schaumburg F	34'	34'	22'	1,088	100	60	28	32	150	80
Schaumburg G	34'	34'	22'	1,088	100	60	28	32	150	80
Schaumburg H	34'	34'	22'	1,156	100	60	28	32	150	80
Utopia Ballroom	119'	59'	15'	7,021	760	420	—	—	900	480
Utopia A	30'	59'	15'	1,770	190	100	46	47	225	120
Utopia B	30'	59'	15'	1,770	190	100	46	47	225	120
Utopia C	30'	59'	15'	1,770	190	100	46	47	225	120
Utopia D	30'	59'	15'	1,770	190	100	46	47	225	120
Utopia Threshold	75'	28'	15'	2,100	—	—	—	—	550	—
Euphoria	30'	59'	15'	1,770	190	100	46	47	225	120
Epiphany	29'	19'	11'	551	48	100	24	21	60	40
Prosperity	30'	19'	11'	570	48	30	24	21	60	40
Serenity	18'	23'	11'	414	32	24	16	15	50	24
Nirvana Ballroom	90'	59'	15'	5,310	570	320	—	—	750	360
Nirvana A	30'	59'	15'	1,770	190	100	46	47	225	120
Nirvana B	30'	59'	15'	1,770	190	100	46	47	225	120
Nirvana C	30'	59'	15'	1,770	190	100	46	47	225	120
Nirvana Threshold	60'	28'	15'	1,680	—	—	—	—	400	—
Perfection Parlor	17'	26'	12'	442	—	—	—	—	20	—
Perfection Boardroom	26'	23'	11'	598	—	—	12	—	—	—
Knowledge	20'	39'	11'	780	64	28	34	29	100	60
Connection	20'	42'	11'	840	65	36	34	29	100	60
Imagination	20'	41'	11'	820	70	36	34	29	100	60
Innovation	20'	40'	11'	800	64	28	34	29	100	60
Journey	15'	21'	11'	315	—	—	10	—	—	—
Creation	12'	21'	11'	252	—	—	8	—	—	—



Only 26 miles from Chicago and 13 miles from Chicago O'Hare International Airport, the Renaissance® Schaumburg Hotel & Convention Center is at the center of it all. Featuring the latest technology in a sleek, fully integrated space, our 100,000 square-foot exhibitor-friendly convention center makes organizing trade shows hassle-free. Plus, with an additional 48,000 square feet of

attached meeting space and 500 luxurious guest rooms, there's plenty more opportunity to make a big impression. Urban style in a convenient, contemporary suburban venue. Evocative architecture. An accessible location. Come discover more. Plan something provocative.