

Conference Level

| ROOM# | DIMENSIONS | SQUARE FEET | THEATER STYLE | CLASS ROOM | BANQUET ROUNDS |
|-------|------------|-------------|---------------|------------|----------------|
| 1 | 29' X 44' | 1276 | 110 | 60 | 50 |
| 2 | 30' X 44' | 1320 | 110 | 60 | 50 |
| 3 | 29' X 44' | 1276 | 110 | 60 | 50 |
| 1,2,3 | 88' X 44' | 3872 | 330 | 180 | 170 |
| 4 | 31' X 44' | 1364 | 110 | 60 | 50 |
| 5 | 31' X 44' | 1364 | 110 | 60 | 50 |
| 4-5 | 62' X 44' | 2728 | 235 | 120 | 110 |
| 6 | 30' X 44' | 1320 | 110 | 60 | 50 |
| 7 | 30' X 44' | 1320 | 110 | 60 | 50 |
| 8 | 30' X 44' | 1320 | 110 | 60 | 50 |
| 6,7,8 | 90' X 44' | 3960 | 330 | 180 | 170 |
| 9 | 31' X 44' | 1364 | 110 | 60 | 50 |
| 10 | 31' X 44' | 1364 | 110 | 60 | 50 |
| 9,10 | 62' X 44' | 2728 | 235 | 120 | 110 |

Lobby/Pre-Function Space: Madison - 6,000 sq. ft., RiverCenter - 5,000 sq. ft.

Paul E. Patton Ballroom/Conference Level

- Four meeting rooms totaling 13,288 sq. ft. can be divided into 10 breakouts
- All rooms fully carpeted and beautifully appointed
- 22,800 sq. ft. ballroom can be divided into 5 separate spaces

Technical Information

- The ballroom has a 25 ft. ceiling height
- Pre-function area is 11,000 square feet with 25' ceilings
- 100 lbs. per sq. ft. load capacity
- Doors into public space are 7'10" high; two doors from service corridor and adjacent freight elevators are 7'3" wide, six are 4' wide
- Freight elevator from loading dock at street level is 20' x 14'5" with a 12' door opening
- Sound and dimmable lighting are controlled separately for each room division
- High-tech audio-visual capability, with fiber optic cable ISDN internet access

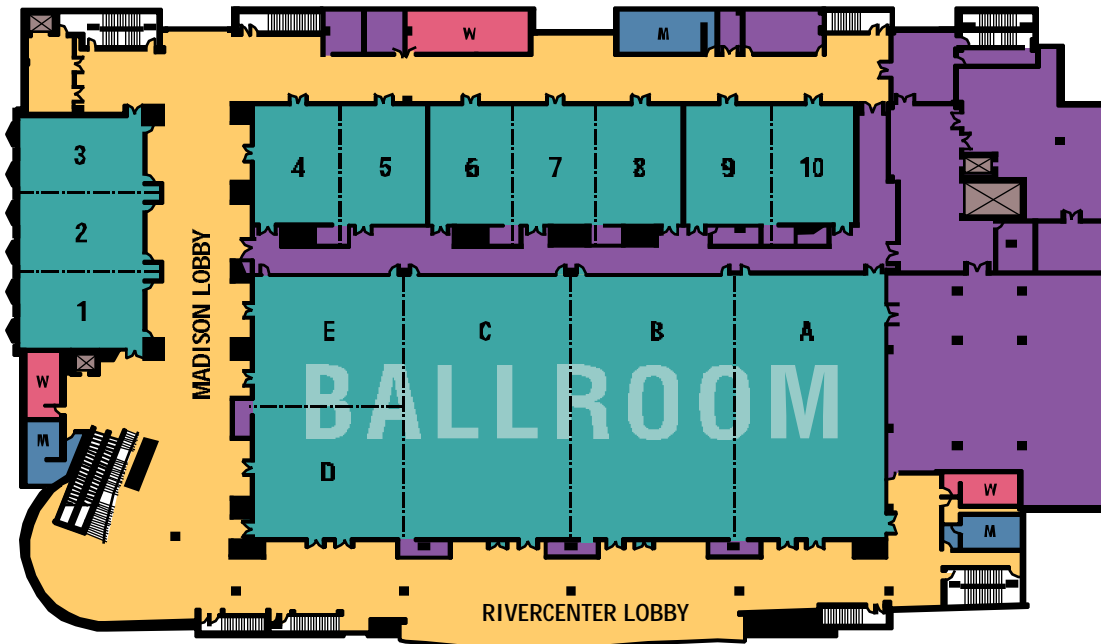

BALLROOM

| ROOM# | DIMENSIONS | SQUARE FEET | EXHIBITS 10 x 10 | THEATER STYLE | CLASS ROOM | BANQUET 6' ROUNDS |
|--------------|-------------|-------------|------------------|---------------|------------|-------------------|
| A | 53' X 100' | 5300 | 26 | 500 | 260 | 340 |
| B | 60' X 100' | 6000 | 30 | 550 | 280 | 400 |
| C | 60' X 100' | 6000 | 30 | 550 | 280 | 400 |
| D | 55' X 50' | 2750 | 15 | 250 | 140 | 160 |
| E | 55' X 50' | 2750 | 15 | 250 | 140 | 160 |
| COMBINED A-E | 228' X 100' | 22,800 | 116 | 2100 | 1100 | 1420 |

■ MEETING SPACE
 ■ BACK OF HOUSE
 ■ LOBBY / PUBLIC SPACE
 ■ RESTROOMS



**NORTHERN
KENTUCKY
CONVENTION
CENTER**

One West RiverCenter Blvd.
Covington, KY 41011
859-261-1500
859-292-2578 Fax
www.nkycc.com
e-mail: info@nkycc.com

Northern Kentucky Convention Center

The Northern Kentucky Convention Center is located at Covington Landing along the banks of the Ohio River. It is situated at the heart of a rapidly expanding business and entertainment district just across a picturesque 19th Century suspension bridge from downtown Cincinnati.

This 204,000 total square foot multi-purpose facility has 110,000 sq. ft. of meetings, exhibition and social function space. The center is designed to make it as convenient and efficient as possible for meeting, conference and exhibition planners.

Situated at the convergence of three major interstates, Northern Kentucky is a transportation center. The Cincinnati/Northern Kentucky International Airport, Delta's second largest hub, offers over 500 daily departures to over 100 cities non-stop. Northern Kentucky offers a blend of cosmopolitan sophistication and Southern hospitality, and this is reflected in the staff customer service focus. We will do our best to ensure a most successful event.

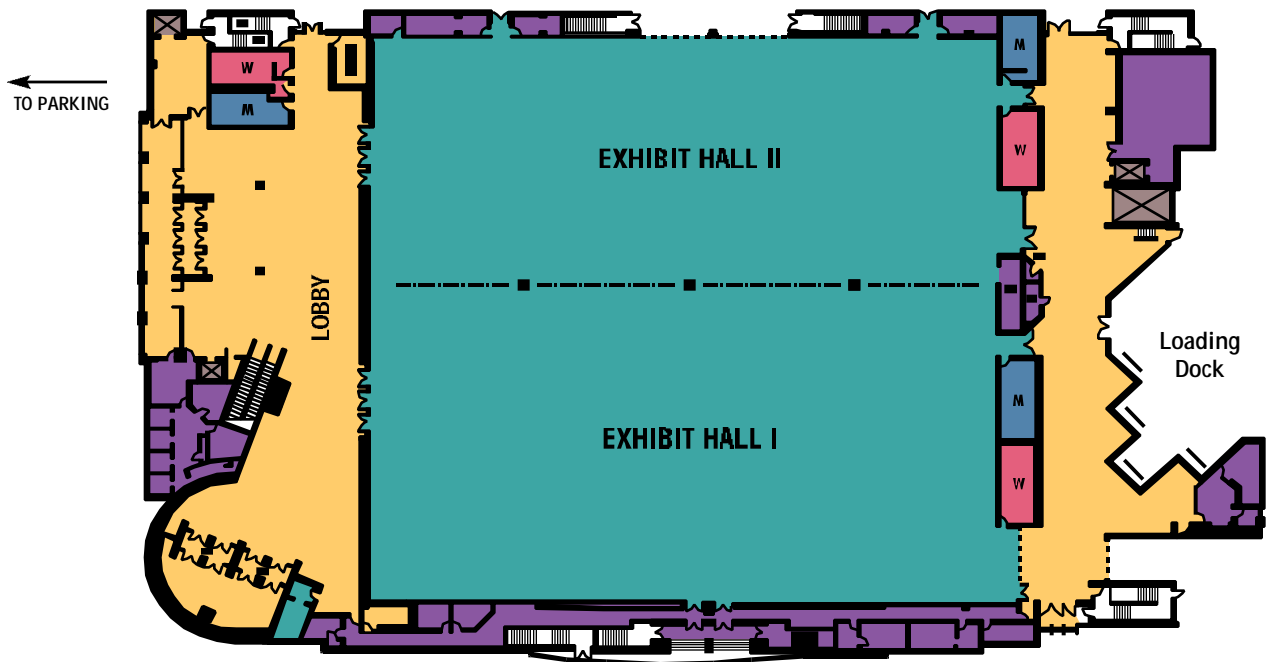

EXHIBITION LEVEL

| ROOM | DIMENSIONS | SQUARE FEET | EXHIBITS 10 X 10 | THEATER STYLE | CLASSROOM | BANQUET 6' ROUNDS |
|-----------------|-------------|-------------|---------------------|------------------|-----------|----------------------|
| Exhibit Hall I | 122' x 220' | 26,840 | 134 | 2,400 | 1,150 | 1,900 |
| Exhibit Hall II | 87' x 220' | 19,140 | 101 | 1,700 | 850 | 1,300 |
| Combined | 210' x 220' | 46,200 | 235 | 4,100 | 2,000 | 3,200 |

Main Lobby

- 8,000 square ft of public space equipped for registration, exhibits and receptions
- Dramatic staircases, escalators and elevator to second floor Conference Level
- Two-story in height with terrazzo and carpeted flooring

Freight Access

- Freight access to each hall at ground level with drive-in ramp
- Four covered loading docks complete with load levelers
- Freight Doors:
Hall I — 14' w by 14' h
Hall II — 12' w by 10' h

Brereton C. Jones Exhibition Center

- Exhibit hall offers 46,200 sq. ft. of space for 235 10' x 10' booths
- Receptions for up to 3,000 people and concerts and meetings for up to 3,500 can be accommodated
- 29 foot ceiling height
- 100 lbs. per sq. ft. floor load capacity
- Permanent concession stands are located in each hall

Technical Information

- Utilities are distributed from points on the ceiling located at 30' centers and along the perimeter walls.
- Three columns (2' x 4') along the airwall
- Utility boxes provide 110/208 single and three phase electrical service
- Category 5 voice/data line and fiber optic cable service
- Water and compressed air service
- Versatile lighting system with incandescent metal halide and high-pressure sodium lamps
- Hanging points (29') in place for rigging banners, theatrical lighting truss and sets

ADDITIONAL INFORMATION AVAILABLE ON FACT SHEET