

Set in the historic city of Edinburgh  
**The perfect location**  
For a successful conference or event

**Marriott**  
EDINBURGH



# A warm, friendly welcome

With a standard of service to match





## We're here to take care of everything...

Just minutes away from Edinburgh International Airport, four miles from the historic city centre and linked to all the major access routes, the Edinburgh Marriott Hotel is the perfect base for your conference or event. And, from the moment you get in touch, you won't have to worry about any of the little details. We'll provide the best possible service to make your event a complete success from start to finish.

To ensure everything goes smoothly, we'll provide you with your own experienced Event Organiser who will be available throughout your stay to help with planning and supervising your event. Our team will be on hand to offer a warm, friendly welcome and make sure all you need to think about is the day's business. In fact, we'll take care of every last detail, from providing fresh coffee on arrival, to helping with technology or any last minute preparations. With our experienced team at your side, you'll find doing business at the Edinburgh Marriott Hotel a genuine pleasure.

### *Contents*

- 1 Introduction to the hotel*
- 2-3 Getting down to business*
- 4-5 Meeting rooms*
- 6-7 Your Marriott Bedroom*
- 8-9 Restaurants, Bars, Leisure*
- 10-15 Planning your event*

the perfect environment and the  
**ideal atmosphere**  
for events of every kind





The Pentland Room

## Getting down to business...

Step inside the Edinburgh Marriott Hotel and you'll find an extensive range of business facilities and a choice of 10 conference rooms. From small, intimate boardroom meetings to lively, spectacular exhibitions, we have a space that's suited to every kind of occasion. For large events, the Pentland Room is the natural choice. Stylish, spacious, and equipped with all those essential modern facilities, it can accommodate up to 250 guests. The Pentland Room is also the perfect choice for those all-important events with its own private bar, air-conditioning and natural daylight.

At Marriott, we also take care of all those other important little touches. Your room will be ready and waiting when you arrive, perfectly prepared for you to get started. Then, throughout your day, we offer a selection of snacks to keep you going at times that suit the structure of your day – a mixture of classic and innovative, sweet and savoury cuisine, freshly prepared every day.



The Dee Room

Everything you need  
to create  
a perfect event

## A venue that's tailor-made for your event

Set apart from the distractions of the office and conveniently located just outside the city centre, the Edinburgh Marriott Hotel is the ideal environment for business. But the benefits go well beyond the location. In our quiet, peaceful meeting rooms you'll find the time, space and support you need to fully focus on the job in hand.

Whatever the occasion, the advanced technical facilities of Marriott Communication Solutions are available. Developed to be quick and easy to set-up, these all-inclusive packages can include fast, continuous web access, internet cafés for emailing and general updates, video conferencing and webcasting. For more information, contact the Marriott Communication Solutions team on 0845 300 5100 or email [communications@marriotthotels.co.uk](mailto:communications@marriotthotels.co.uk).

*The Dee Room, situated on the ground floor, benefits from natural light and a built-in presentation unit.*

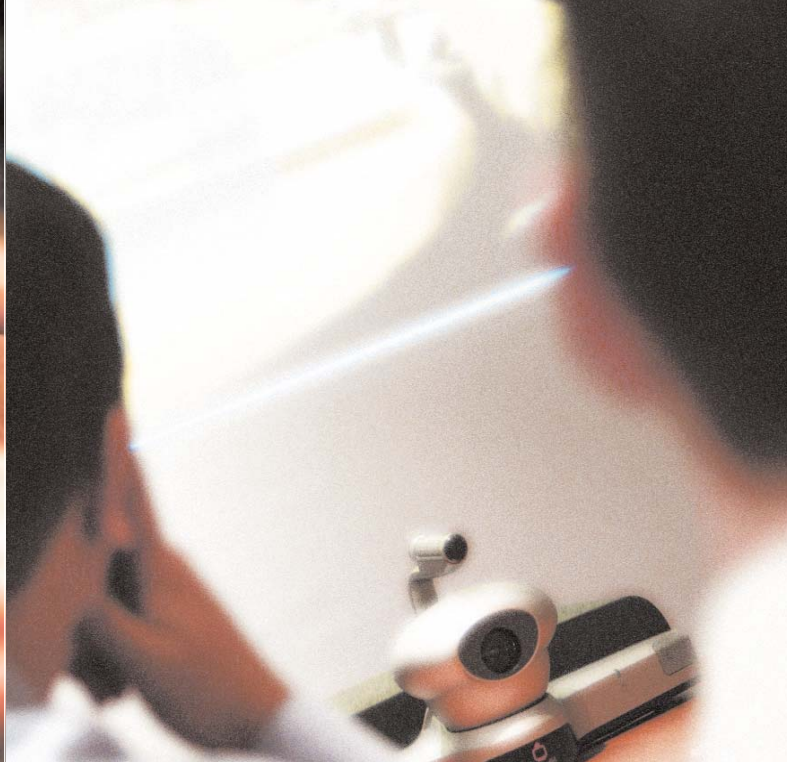

The Pentland Room





After a busy day, retreat to  
the comfort and space of your  
**luxury room**

## Classic comfort with a modern touch

After the rigours of your day, lie back and relax in the peaceful surroundings of your comfortable room. Every one of the 245 air-conditioned bedrooms has been carefully designed, combining tasteful décor with all the modern facilities to make you feel at home. Each room has a dedicated workspace, complete with direct dial telephone, voicemail and a fax/modem link to keep you connected. If you want to leave work behind, unwind with the latest show on satellite TV, or watch one of our pay-per-view movies. And if you need anything at all, just call room service - available 24 hours a day.

*Each room includes an en-suite bathroom, mini bar, iron, ironing board and trouser press, hair dryer and tea & coffee making facilities.*





Mediterrano Restaurant

Leave the day's work behind and

# Relax and recharge

With fine wine and mouth-watering food



Chats Cafe Bar



## Treat yourself to a little time-out

At the Edinburgh Marriott we believe that good business isn't just about work; it's also about enjoying good company and the finer things in life. So after a busy day, why not try the freshest local produce and contemporary Mediterranean cuisine in our Mediterraneo Restaurant. To complement your choice, make sure you sample the restaurant's extensive wine list which features exquisite reds, whites and roses from around the world. If you fancy something a little lighter or simply a refreshing drink head for the buzzing Chats Cafe Bar – the perfect place to unwind and catch-up with colleagues and clients.

For refreshment of an altogether more energetic kind, head for our fully equipped Leisure Club with its indoor pool, steam room and gym. Anyone attending a meeting or event at the Edinburgh Marriott Hotel receives complimentary use of our excellent Leisure Club facilities.

**The Pentland Room** is a large, airy room with natural daylight, complemented by a private bar, its own cloakroom and toilets. Fitted with Marriott Communication Solutions, the Pentland Room is ideal for conferences, exhibitions and dinners.

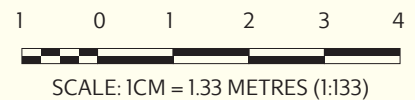
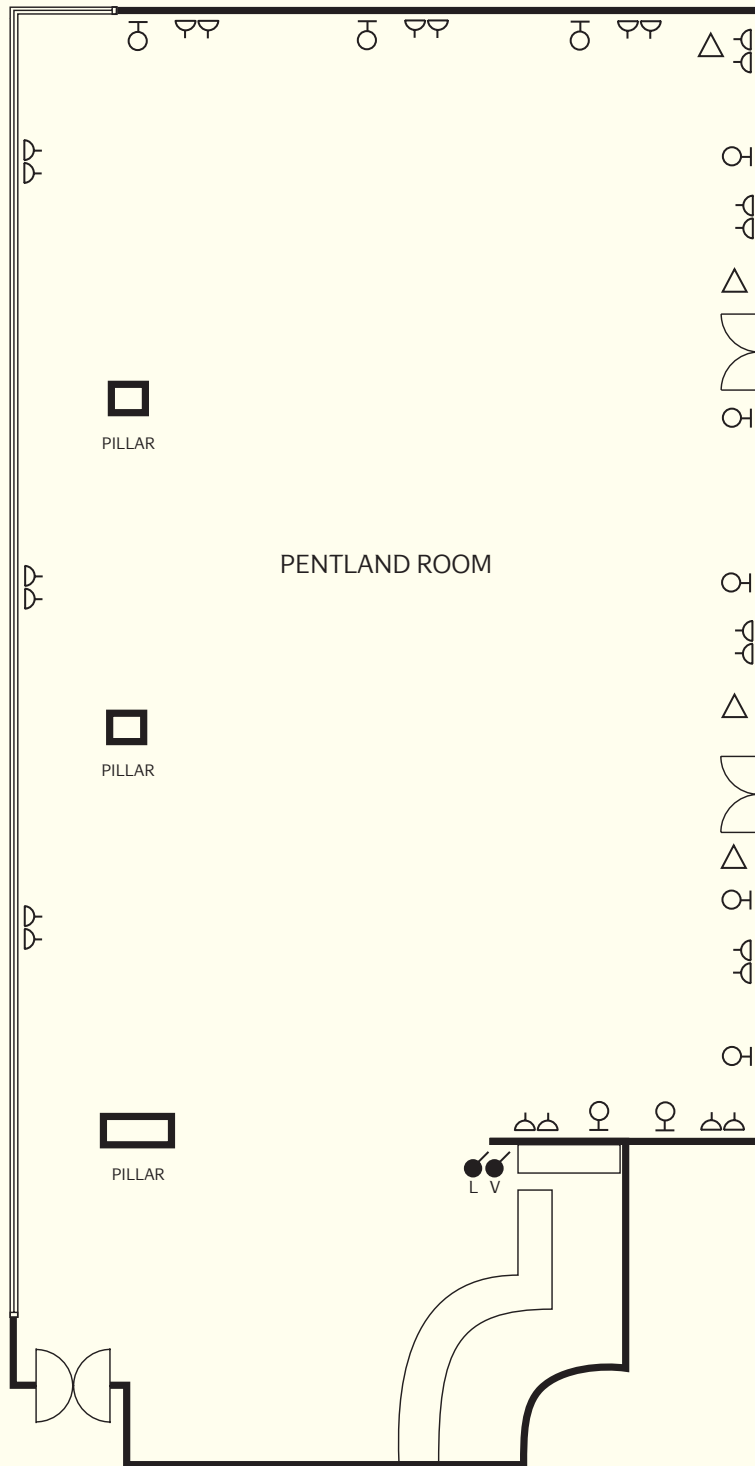

**The Findhorn Room** is the largest room on the mezzanine floor with natural daylight, a small balcony area, built-in presentation unit and fitted with Marriott Communication Solutions. It also connects to the Leven Room.

**The Leven Room** is one of four boardrooms situated on the mezzanine floor surrounding the Rivers Foyer and Bar. Offering natural light and a built-in presentation unit, the Leven Room is connected to the Findhorn Room.

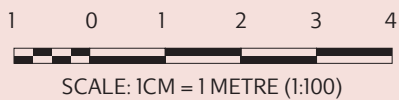
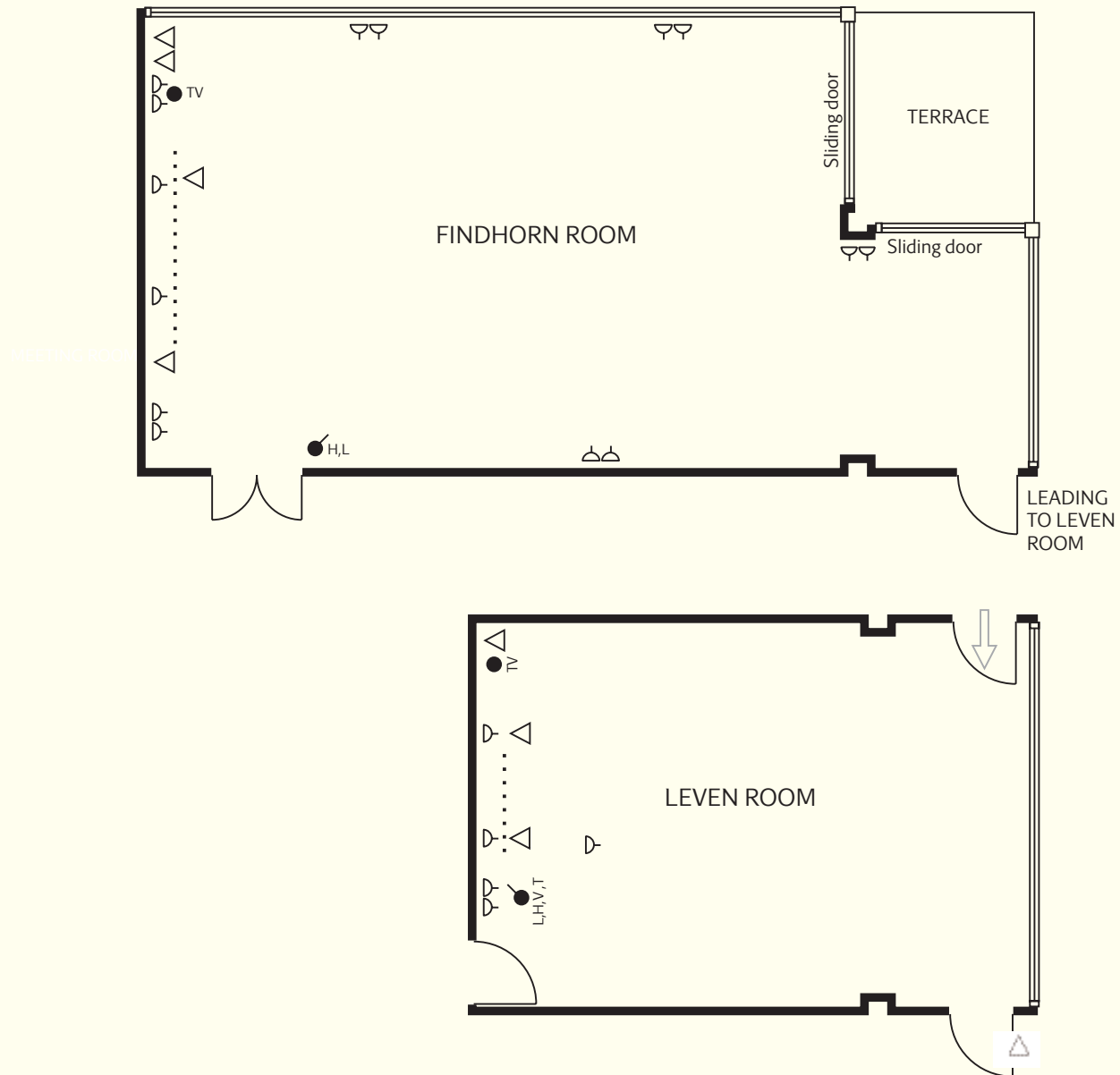

- |  |                      |  |                         |
|--|----------------------|--|-------------------------|
|  | LIGHTING             |  | TELEPHONE/FAX POINT     |
|  | VENTILATION          |  | VENTILATION             |
|  | HEATING              |  | WINDOW OR GLAZED SCREEN |
|  | POWER POINT - 13 AMP |  | PROJECTION SCREEN       |
|  | TV POINT             |  | PILLAR                  |
|  | WALL LIGHT           |  |                         |

**The Moray Room** is one of four boardrooms situated on the mezzanine floor surrounding the Rivers Foyer. It offers natural light and a built-in presentation unit.

**The Teviot Room** is one of four rooms surrounding the Rivers Foyer and situated on the mezzanine floor. Offering natural light it has a built-in presentation unit.

**The Don Room** is an ideal mid-sized boardroom, situated on the ground floor and offering natural light and a built-in presentation unit. Both the Don and Dee Rooms have their own welcome coffee area and toilets.

**The Dee Room** is the larger of the two rooms, also with natural light and a built-in presentation unit. It is situated next to the Don Room on the ground floor.

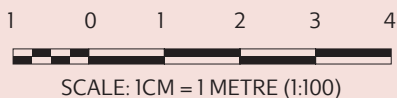
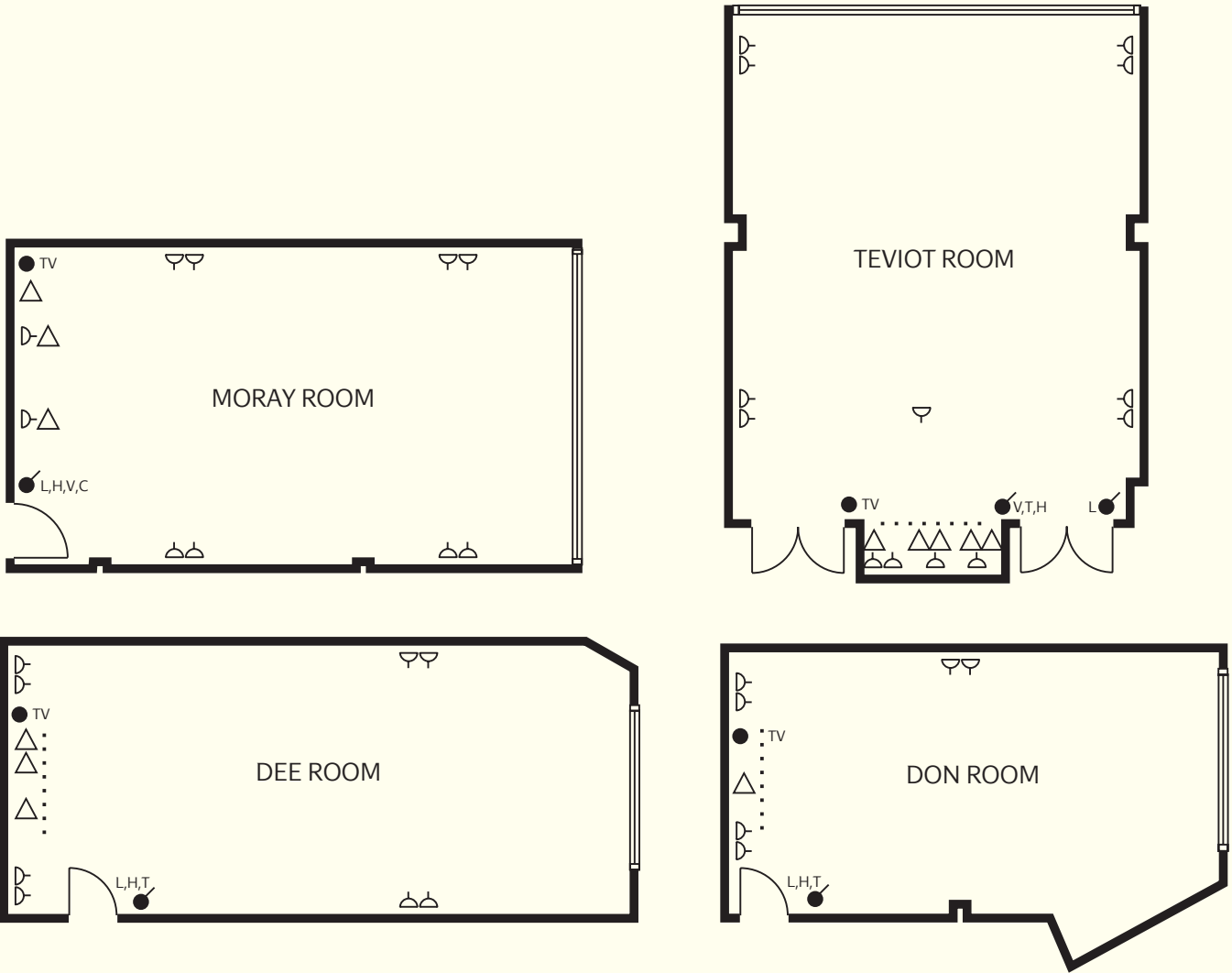

- |  |                      |  |                         |
|--|----------------------|--|-------------------------|
|  | LIGHTING             |  | TELEPHONE/FAX POINT     |
|  | VENTILATION          |  | VENTILATION             |
|  | HEATING              |  | WINDOW OR GLAZED SCREEN |
|  | POWER POINT - 13 AMP |  | PROJECTION SCREEN       |
|  | TV POINT             |  | PILLAR                  |
|  | WALL LIGHT           |  |                         |

The Tay and Tweed Rooms are situated on the 3rd floor and both offer natural daylight and built-in presentation units.

The Esk Room is a small boardroom ideal for interviews and one to one meetings. Situated on the 3rd floor.

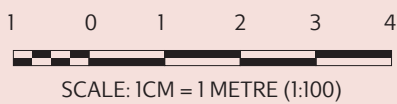
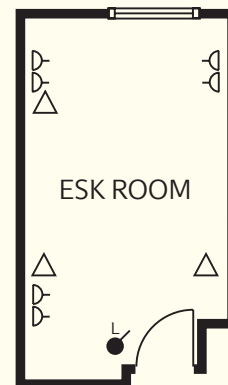
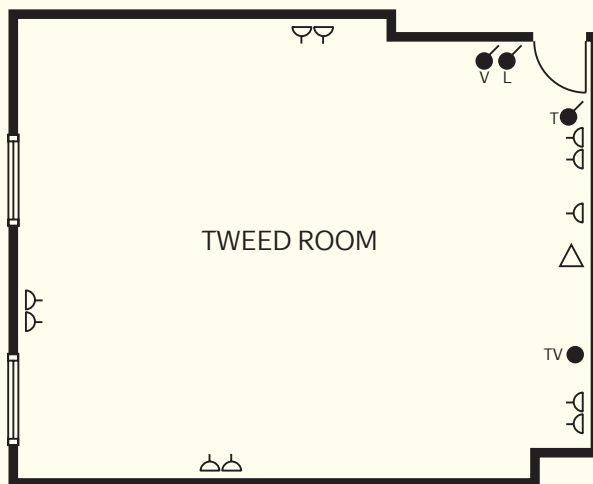
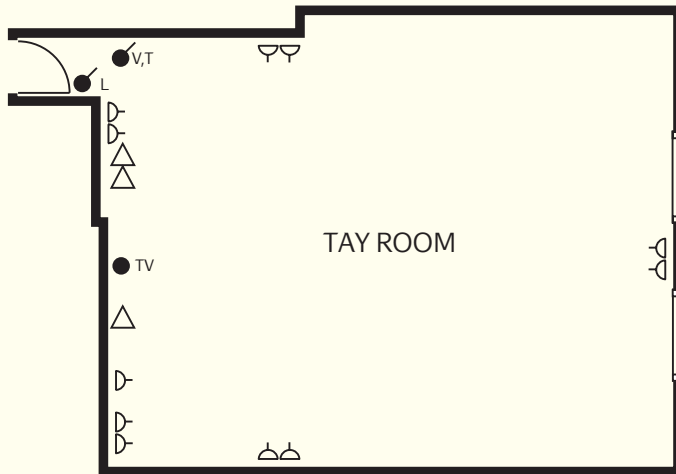

- |  |                      |  |                         |
|--|----------------------|--|-------------------------|
|  | LIGHTING             |  | TELEPHONE/FAX POINT     |
|  | VENTILATION          |  | VENTILATION             |
|  | HEATING              |  | WINDOW OR GLAZED SCREEN |
|  | POWER POINT - 13 AMP |  | PROJECTION SCREEN       |
|  | TV POINT             |  | PILLAR                  |
|  | WALL LIGHT           |  |                         |

# Planning your Event with us at the Edinburgh Marriott



This quick reference guide is designed to make planning your business event at the Edinburgh Marriott as easy as possible. If you have any questions or would simply like some advice, please get in touch, we're here to help. You can either call us direct on 0870 400 7293 or email: [events.edinburgh@marriott-hotels.co.uk](mailto:events.edinburgh@marriott-hotels.co.uk). For online information and to download printable floorplans, visit [Marriott.co.uk/meetingsandevents](http://Marriott.co.uk/meetingsandevents). While you're there, you can also browse through over 70 other Marriott properties across the UK and Ireland.

	NATURAL DAYLIGHT	AIR COOLING	WHEELCHAIR ACCESS	DIMENSIONS(METRES)			MAXIMUM NUMBER OF DELEGATES							
				L	W	H	THEATRE STYLE	BOARDROOM STYLE	U-SHAPE	CLASSROOM STYLE	CABARET	BUFFET RECEPTION	DINNER/ DANCE	DINNER
PENTLAND ROOM	✓	✓	✓	20	13	2.7	250	50	50	84	90	250	190	220
FINDHORN ROOM	✓	✓	✓	9.5	7.3	3.3	80	26	30	30	30	70	-	50
TEVIOT ROOM	✓	✓	✓	6.6	8.2	3.3	60	22	20	26	24	40	-	30
MORAY ROOM	✓	✓	✓	8.1	4.3	3.3	30	18	18	16	12	20	-	20
LEVEN ROOM	✓	✓	✓	8.1	6.6	3.3	60	22	20	26	24	40	-	30
DEE ROOM	✓	✓	✓	9.1	4	3	36	20	18	12	12	20	-	-
DON ROOM	✓	✓	✓	7.3	4	3	30	14	12	10	-	20	-	-
TAY ROOM	✓	✓	✓	7.3	6.1	2.5	50	20	20	26	24	40	-	-
TWEED ROOM	✓	✓	✓	7.3	6.1	2.5	50	20	20	26	24	40	-	-
ESK ROOM	✓	✓	✓	4.7	2.7	2.4	6	2	-	-	-	-	-	-

## QUICK REFERENCE GUIDE

NO. OF FLOORS	TOTAL NO. OF BEDROOMS	NON SMOKING BEDROOMS	SUITES	DISABLED BEDROOMS	MARRIOTT COMMUNICATION SOLUTIONS AT THIS HOTEL	THE MARRIOTT BEDROOM (REFER TO HOTEL BROCHURE)	AIR COOLING IN BEDROOM	INTERNET ACCESS IN BEDROOM	MINI BAR IN BEDROOM	IN ROOM SAFE	24 HR ROOM SERVICE	LAUNDRY SERVICE	SAFE DEPOSIT AT RECEPTION	SECRETARIAL SERVICES	BUSINESS CENTRE	EXECUTIVE LOUNGE	GIFT SHOP	SHOE SHINE IN PUBLIC AREAS	VENDING MACHINES IN PUBLIC AREAS	ICE MACHINES IN PUBLIC AREAS	VALET PARKING	CONCIERGE	ONSITE CAR PARKING	FREE CAR PARKING	NUMBER OF PARKING SPACES
4	245	193	4	6	✓	✓	✓	✓	✓	✓	✓	✓	✓	✓	✓	✓	✓	✓	✓	✓	✓	✓	✓	✓	300

RESTAURANTS & LOUNGES	MARRIOTT LEISURE CLUB	PLACES TO SEE / THINGS TO DO	SPECIAL ACTIVITIES
<ul style="list-style-type: none"> <li>Mediterrano Restaurant: A cosmopolitan restaurant offering mediterranean style cuisine.</li> <li>Chats Cafe Bar: A casual cafe bar featuring modern European food.</li> </ul>	<p>Complimentary: Pool, spa bath, gym, sauna &amp; steam room.</p> <p>Supplementary: Solarium and treatment room.</p>	<ul style="list-style-type: none"> <li>Edinburgh Castle</li> <li>Palace of Holyrood house</li> <li>Royal Yacht Britannia</li> <li>Our Dynamic Earth</li> <li>Whisky Heritage Centre</li> <li>Edinburgh Zoo</li> </ul>	<ul style="list-style-type: none"> <li>Edinburgh Festival &amp; Fringe</li> <li>Military Tattoo</li> <li>New Years Eve Street Party</li> <li>Team building on-site</li> </ul>

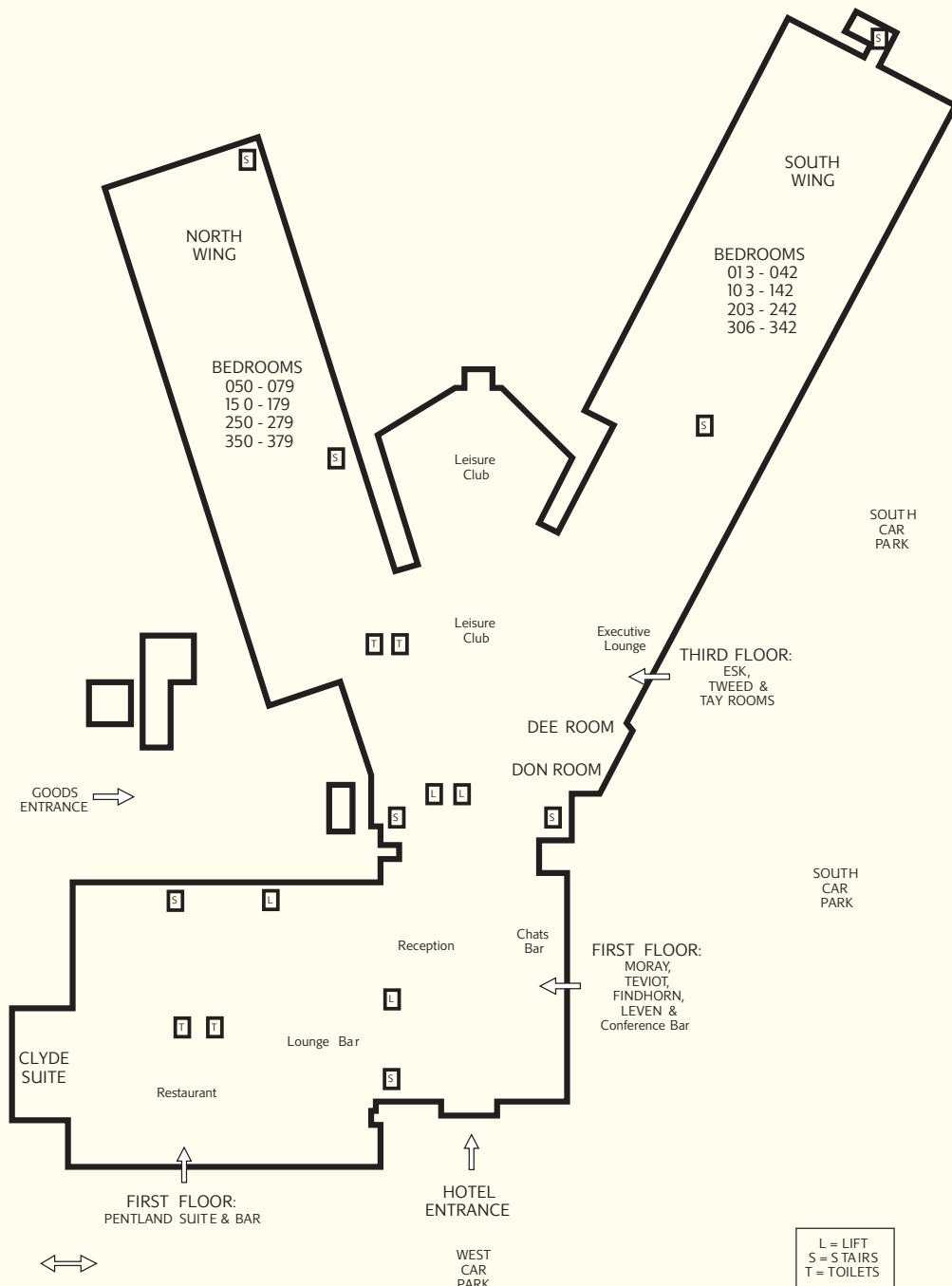

## HOW TO FIND THE HOTEL

### By road

From the North: Past the Forth Bridge, follow signs for Edinburgh City Centre on dual carriageway until you get to a large junction at the Barnton Interchange. Take a right following signs for Airport and Glasgow. Go straight over the next roundabout continuing on until you approach the next set of traffic lights where there is a garage on your left (yellow Shell garage). Turn left here and the hotel is situated on your immediate right. From the South and East (A1, A74, A701 & A702): Join city bypass (A720) following signs for Glasgow and Edinburgh Airport. Follow the dual carriageway to its end at Gogar roundabout (junction with the A8). Turn right at roundabout and follow signs for Edinburgh City Centre. Move into the right hand lane and the hotel is situated on the right hand side just through the next set of traffic lights. From the West: Join the city bypass (A720) from Junction 1 off the M8 (city bypass north). Follow the dual carriageway to its end at Gogar roundabout (junction with A8) turn right at the roundabout following signs for Edinburgh City Centre. Move into the right hand lane and the hotel is situated on the right hand side just through the next set of traffic lights.

### By rail

Waverley station 4 miles – exit station on Princes Street. Travel west, out of town on A8. Hotel is on your left 3 miles out of town on A8. Haymarket Station 3 miles – travel west on A8 as above. For information on train times, please call the National Railway Enquiry Service on 08457 484950.

### By air

Fly to Edinburgh International Airport – the hotel is 2 miles towards the city centre on A8. Transfers provided with prior arrangement.

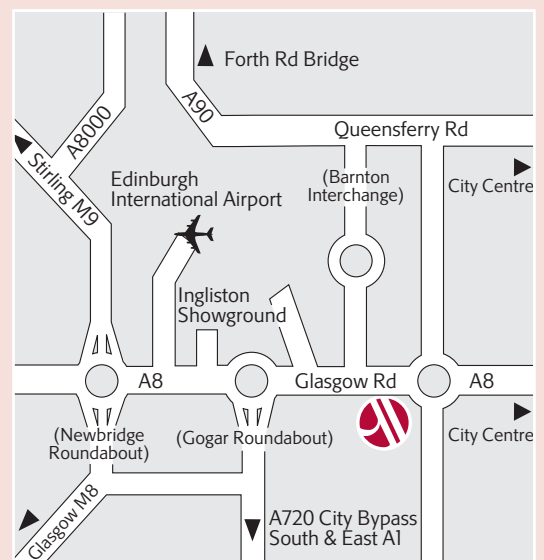

Additional Marriott hotels  
in Scotland include:

- 1 Aberdeen Marriott Hotel – Tel 0870 400 7291
- 2 Marriott Dalmahoy Hotel & Country Club – Tel 0870 400 7299
- 3 Glasgow Marriott Hotel – Tel 0870 400 7230
- 4 Inverness Marriott Hotel – Tel 0870 400 7292



**Marriott**  
EDINBURGH

111 Glasgow Road, Edinburgh EH12 8NF

Tel 0870 400 7293 Guest Fax 0870 400 7393

Conference/Sales Fax 44 (0) 131 316 4507

web: [Marriott.co.uk/EDIEB](http://Marriott.co.uk/EDIEB) email: [events.edinburgh@marriotthotels.co.uk](mailto:events.edinburgh@marriotthotels.co.uk)