

**Directions**  
Dalmahoy can be found approximately 7 miles west of Edinburgh on the A71. Edinburgh Airport is 3 miles away.



Originally a Scottish baronial manor, the Marriott Dalmahoy is an outstanding hotel & country club, set in 1,000 acres of wooded parkland with some of the best golf in Scotland, offering the internationally renowned East Course and the challenging West Course. The Marriott Dalmahoy is ideally located for exploring the surrounding Scottish countryside, as well as the many attractions within Edinburgh city. The hotel also offers excellent conference facilities, golf days and superb incentive packages.

**Accommodation**

- 3 floors
- 215 bedrooms
- 133 non smoking bedrooms
- 7 suites
- 6 disabled bedrooms
- The Marriott Bedroom (see page 5)

**Additional features**

- Mini bar in bedrooms
- 24hr room service
- Laundry service
- Safe deposit at reception
- Secretarial facilities
- At least one WIFI hotspot in public areas
- Shoe shine in public areas
- Concierge
- Onsite car parking

**Conference & Event facilities**

- 9 dedicated conference & meeting rooms
- Max. no. of delegates 360, dinner
- Marriott Communication Solutions

**Restaurants & lounges**

- Pentland Restaurant: Traditional dining with fine food & wine
- The Long Weekend Cafe Bar: All day cafe bar with a design theme of yesterday's sporting heroes

**Leisure facilities**

Complimentary: Indoor heated swimming pool, sauna, steam room, spa bath, cardiovascular theatre, resistance gym, dance studio, tennis courts, jogging trail.  
Supplementary: Beauty Salon, solarium and personal training.

**Golf facilities**

- 2 x 18 hole courses (including Championship East Course).
- Putting green
  - Automated floodlit driving range with covered bays
  - Golf shop
  - Trolley & buggy hire
  - Club hire
  - Shoe hire
  - Tuition & video facilities
  - Short game practice area
  - Golf clubhouse & bar

**Car parking**

350 free car parking spaces available for guests.

**Additional Marriott Hotels in Scotland include:**

- Aberdeen Marriott Hotel (see page 6)
- Edinburgh Marriott Hotel
- Glasgow Marriott Hotel (see page 22)
- Inverness Marriott Hotel



The Dalmahoy Suite comprises of the East and West Rooms and can be used as one complete suite when required for up to 360 delegates for a buffet reception. Typical uses include conferences, product launches, large receptions, dinners and dinner dances.

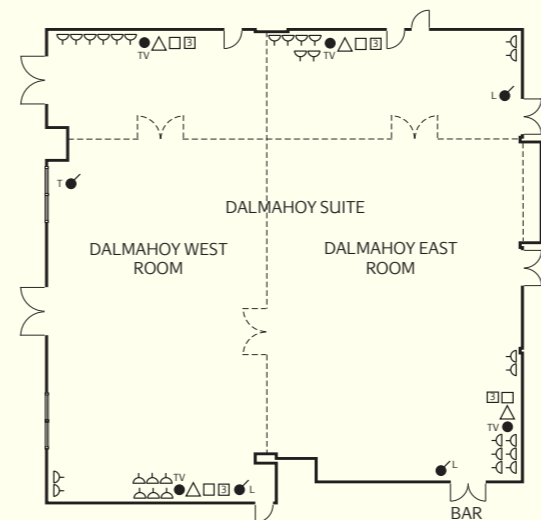

	ROOM CAPACITIES (NO. OF DELEGATES)											
	THEATRE STYLE (NO PROJECTION)	THEATRE STYLE (BACK PROJECTION)	THEATRE STYLE (FRONT PROJECTION)	BOARDROOM STYLE	U-SHAPE	CLASSROOM STYLE	CABARET STYLE (NO PROJECTION)	CABARET STYLE (BACK PROJECTION)	CABARET STYLE (FRONT PROJECTION)	BUFFET RECEPTION	DINNER/DANCE	DINNER
Dalmahoy Suite (1 & 2)	300	250	300	120	90	200	180	160	180	360	280	360
Dalmahoy East Room (1)	80	60	80	40	40	50	70	60	70	100	60	100
Dalmahoy West Room (2)	120	100	120	60	50	60	70	60	70	150	-	120

For key to symbols see page 65