

## Courtyard by Marriott Phuket at Kamala Beach

Located just 30 minutes from the Phuket International Airport, Courtyard by Marriott Phuket at Kamala Beach offers 180 splendid suites, each with a separate bedroom, living room and private balcony on a breathtaking section of the island, where life moves at your own pace. Guests can rejuvenate in one of the spa treatment rooms, indulge in the chef's daily specials, head to a nearby attraction or simply relax by the mountain-view pool.



Hotel Exterior



Hotel Lobby



Hotel Lobby - Seating Area

**Opening:** January 24, 2009

**Location:** 100/10 Moo 3, Kamala Beach, Kathu, Phuket 83150 Thailand

**Telephone:** +66 7630 3000

**Fax:** +66 7630 3003

**Reservation:** +66 7630 3300

**Reservation Fax:** +66 7630 3362

**Email:** [courtyardresort.reservation@courtyard.com](mailto:courtyardresort.reservation@courtyard.com)

**Website:** [courtyardmarriottkamala.com](http://courtyardmarriottkamala.com)

**Management:** Marriott International

**General Manager:** Mr. Theera Kanjana

**Cluster Director of Sales:** Mr. Prawate Khumchart

**Architect:** RMJM

**Interior design:** DWP Co., Ltd.

**Landscape Architects:** Green Architect

**Attractions:**

- Phuket FantaSea
- Jungceylon Shopping Mall
- Promptheep Cape-sunset viewpoint
- Phang Nga Bay
- Adventure treks
- Wat Chalong

**Directions:**  
For the 25-kilometre drive southwest from the Phuket International Airport to the resort, take Highway 402 towards Phuket Town and turn right onto Highway 4025. A one-way taxi fare from Phuket International Airport is about THB700.



**One-Bedroom Deluxe Suite**

**Accommodations:**

Perfect for family holidays or honeymoons, Courtyard by Marriott Phuket at Kamala Beach offers 180 elegantly-appointed, one- to three-bedroom suites in five categories, each with a separate living room and private balcony. The suites' spacious rooms combine comfort with functionality and feature beds with luxury linens, work desks with high-speed internet access, kitchenettes (in two- and three-bedroom suites), flat-screen TVs, and DVD players.

**One-Bedroom Deluxe Suites**

Perfect for guests seeking privacy along with spacious living areas, these 34-square-metre suites offer private bedrooms with balconies. (90 rooms)

**One-Bedroom Deluxe Pool Terrace Suites**

These 34-square-metre suites open to private balconies located on the ground floor, present private bedrooms with king-size beds and separate living rooms overlooking to the pool. (18 rooms)

**Two-Bedroom Deluxe Suites**

Families of four can check-in to these 60-64-square-metre suites offering separate bedrooms and living areas that include kitchenettes and dining tables. (52 rooms)

**Two-Bedroom Pool Terrace Suites**

Presenting private balcony views of the pool and garden, these 60-64-square-metre suites offer living rooms, kitchenettes and dining areas located on the ground floor. (12 rooms)

**Three-Bedroom Deluxe Suites**

These 95-square-metre, balcony-trimmed suites offer plenty of privacy plus a modern room with a kitchenette, dining table and living room. (8 rooms)



**Living Room with Kitchenette**



**Garden Area and Pool Bar**



Swimming Pool



Kids World



MoMo Café

## Highlights of Courtyard by Marriott Phuket at Kamala Beach

### Guestroom Amenities:

- King-size or double beds
- Safe
- Refrigerator
- Iron and ironing board
- Individual temperature control
- Tea and coffee making facilities
- High-speed internet access
- Satellite TV
- DVD player
- Alarm clock
- Hairdryer
- Slippers
- Bottled water
- Working desk
- Kitchenette in 2-bedroom and 3-bedroom suite

### Facilities and Services:

- Siam Adventure Club tour desk
- Newspapers
- Wireless internet in public areas
- Swimming pool with water slide
- 24-hour security
- Fitness Centre
- In-room dining
- Limousine service
- Spa treatment rooms
- Business Lounge

### Kids World:

The resort's onsite Kids World offers an amusement and entertainment play zone for children over four years of age:

- Internet corner
- Sony PlayStation® area
- Cushioned ball-house
- Baby crib
- Science Lab
- Arts and crafts corner
- Dress up area
- Movie theatre

Opening hours: 09:00 - 17:00 and 18:00 - 20:00



MoMo Café

**Siam Adventure Club:**

The Siam Adventure Club Rangers can organise amazing and unforgettable Phuket experiences and indoor activities to enhance guests' stays.

**Dining Options:**

**MoMo Café**

Enjoy fresh international tastes for breakfast, lunch, and dinner in a casual atmosphere, and be sure to start the day with the café's sumptuous breakfast buffet. Opening hours: 06:30 - 23:00



MoMo 2 Go

**MoMo 2 Go**

Savour freshly baked pastries, desserts and a wide selection of teas and coffees at the bakery or take away your choice of treats. Opening hours: 07:00 - 21:00

**MoMo 2 You**

Enjoy in-room delivery from both MoMo outlets. Opening hours: 06:30 - 23:00

**Pool Bar**

Relax in the pool while sipping your favourite drink. Opening hours: 09:00- 19:00

**Fitness Centre:**

The Fitness Centre offers state-of-the-art exercise machines and strength-building equipment. Opening hours: 24 hours a day



Araya Spa

**Araya Spa:**

Unwind with a selection of massages and treatments from our therapists in one of three treatment rooms equipped with Jacuzzis and saunas. Opening hours: 10:00 - 19:00

### Meeting Room Specification:

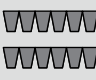
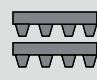
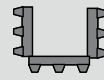
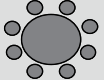
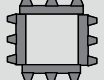
Meeting Rooms	Lx Wx H (Meter)	Total area (Sq.m.)	CAPACITY				
			 Theater	 Classroom	 U-shape	 Banquet	 Board room
Talang I	5.5 x 10.0 x 2.35	55	42	36	22	32	22
Talang II	3.6 x 5.6 x 2.35	20					10(fixed)
Talang III	3.6 x 6.3 x 2.35	22					10(fixed)
Talang IV	4.6 x 9.0 x 2.35	41	36	32	16	32	16
Talang V	4.7 x 9.0 x 2.35	42					10(fixed)
Pre-function area	9.8 x 5.0 x 3.3	48					
Kamala (I,II,III)	25.0 x 11.5 x 3.3	288	150	108		132	
Kamala I	8.3 x 12.0 x 3.3	100	70	45	24	40	
Kamala II	8.4 x 10.5 x 3.3	88	60	36	24	40	
Kamala III	8.3 x 12.0 x 3.3	100	70	45	24	40	
Kamala Terrace	14.0 x 8.0	112					
<b>Total Meeting Area</b>		<b>468</b>					

Note: A variety of outdoor spaces is also available.  
 All set up capacities without stage.  
 The total meeting area is not inclusive of pre-function and terrace areas.

### Meeting Room Floor Plan:

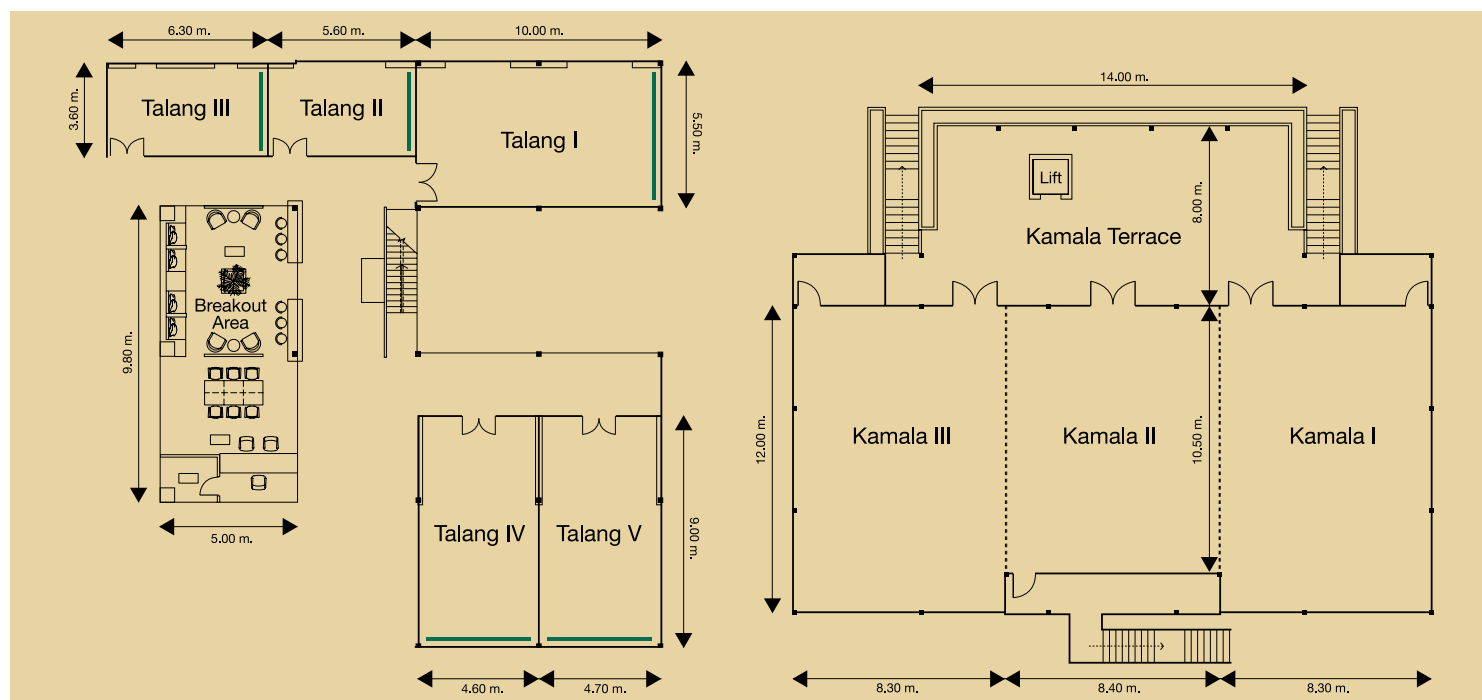



**Meeting Facilities**

**Meeting Facilities:**

Courtyard by Marriott Phuket at Kamala Beach offers 8 function rooms, and a pre-function area, that can be configured to accommodate 10-150 guests. It is fully equipped to host corporate meetings, weddings and gala events.

**Visas to Thailand:**

Visitors to Thailand must possess a passport valid for at least six months upon arrival and proof of onward passage. Visa requirements are determined by nationality. Nationals of the United Kingdom, Australia, New Zealand, USA, Canada, Singapore, Japan and Malaysia do not require visas for stays of up to 30 days. Visitors from other countries should consult their local Thai consulate for visa requirements.

**Contact Information:**

**Name:** Mr. Prawate Khumchart  
**Position:** Cluster Director of Sales  
**E-Mail:** prawate.k@courtyard.com  
**Address:** Piya Place Langsuan Building, 15th Floor,  
 29/1 Soi Langsuan, Ploenchit Road, Lumpini, Pathumwan, Bangkok 10330 Thailand  
**Telephone:** +66 2652 0902  
**Fax:** +66 2652 0903  
**Mobile:** +66 8180 33900

Hotel map:

