

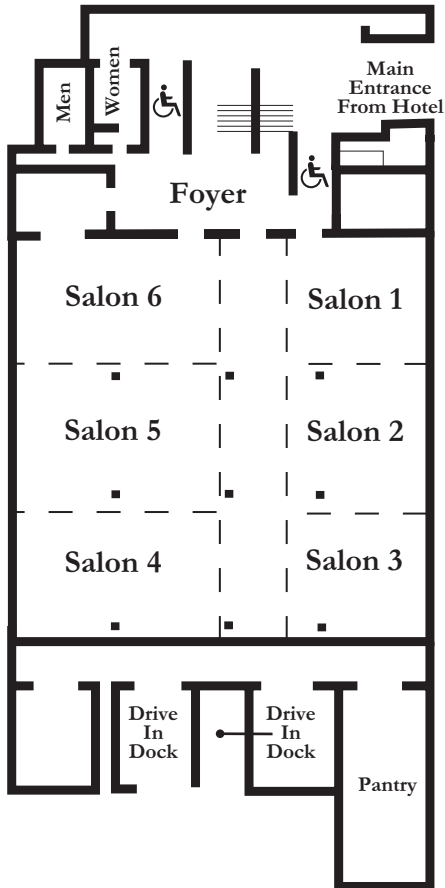

JW MARRIOTT HOUSTON

Liberty Hall



First Floor

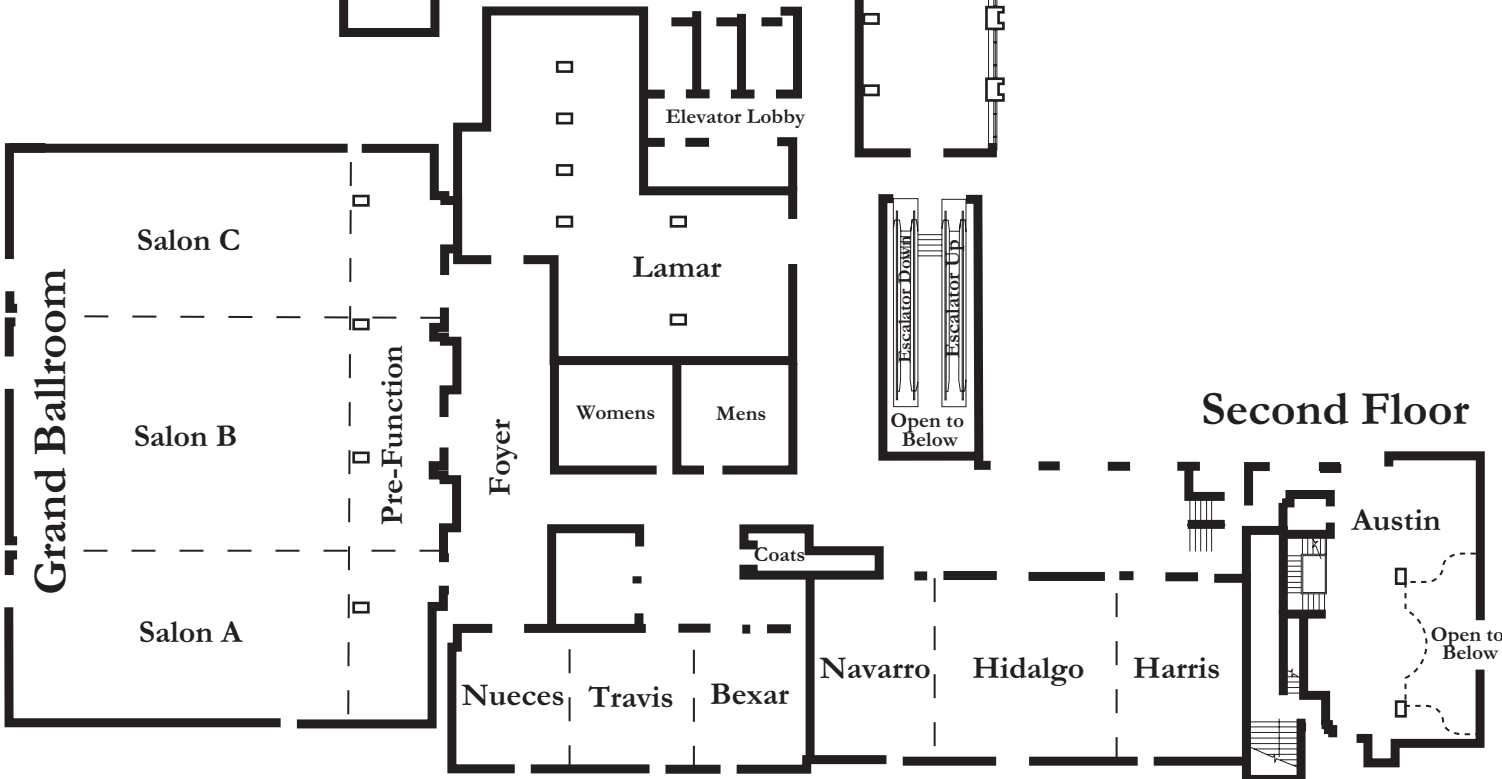
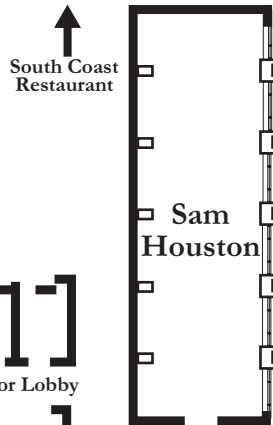
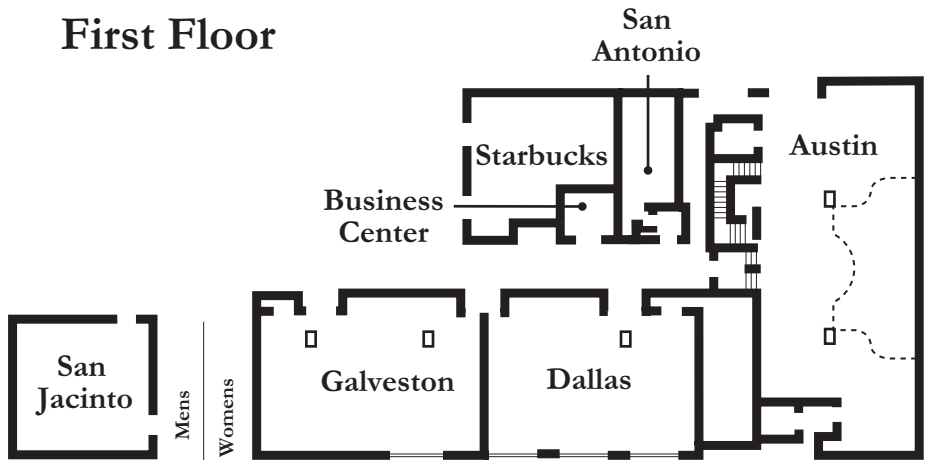



JW MARRIOTT® HOUSTON

		Meeting Room Names	L x W x H	Sq. Ft	Theatre	School	Conference	U-Shape	Reception	Banquet
2 N D F L O O R		Grand Ballroom	107x95x18	10,000	900	500	-	-	900	720
		Pre-function	107x17x10	1,819	-	-	-	-	200	-
		Salon A	33x78x18	2,574	250	150	60	50	250	210
		Salon B	41x78x18	3,198	420	220	65	60	350	280
		Salon C	33x78x18	2,574	250	130	50	50	250	180
		Salon A/B or B/C	74x78x18	5,772	720	420	-	-	650	470
		Ballroom Foyer	62x11x13	-	-	-	-	-	100	-
		Harris	26x37x13	962	70	30	28	24	50	50
		Hidalgo	34x37x13	1,258	100	60	32	30	100	80
		Navarro	24x37x13	888	70	30	28	24	50	40
		Harris/Hidalgo	60x37x13	2,220	170	90	48	50	150	120
		Hidalgo/Navarro	58x37x13	2,146	170	90	48	50	150	120
		Harris/Hidalgo/Navarro	84x37x13	3,108	240	160	50	50	250	200
		HHN Foyer	84x14x13	1,176	-	-	-	-	125	-
		Bexar	21x28x13	588	50	20	20	18	40	30
		Travis	24x28x14	672	60	30	24	20	50	40
		Nueces	21x28x15	588	50	20	20	18	40	30
		Bexar/Travis	45x28x13	1,260	110	50	36	38	90	70
		Travis/Nueces	45x28x13	1,260	110	50	36	38	90	70
		Bexar/Travis/Nueces	66x28x13	1,848	160	80	50	50	130	120
	Sam Houston	21x63x13	1,323	120	70	30	30	100	80	
	Lamar	-	2,480	-	-	28	24	150	120	
	Austin (Upper)	-	1,058	30	-	20	-	80	70	
1 S T F L O O R		Austin (Lower)	28x46x9	1,288	60	48	28	24	90	80
		Austin	-	2,346	-	-	-	-	170	150
		Dallas	28x39x9	1,288	70	44	30	26	75	50
		Galveston	28x42x9	1,176	70	44	30	26	75	50
		San Jacinto	26x26x9	676	40	24	20	16	55	40
		San Antonio	18x24x9	432	20	16	18	-	-	18
		Liberty Hall	115 x 113 x 16	13,000	1,150	700	-	-	1,300	950
		Salon 1	40 x 33 x 16	1,320	130	66	36	40	125	80
		Salon 2	40 x 43 x 16	1,720	170	84	43	45	150	100
		Salon 3	40 x 37 x 16	1,480	148	72	38	40	140	90
		Salon 4	55 x 37 x 16	2,035	200	96	52	50	200	140
		Salon 5	55 x 43 x 16	2,365	240	112	60	55	230	150
		Salon 6	55 x 33 x 16	1,815	170	87	46	50	175	130
		Salons 1 & 2	40 x 76 x 16	3,040	280	150	-	-	300	200
		Salons 2 & 3	40 x 80 x 16	3,200	300	170	-	-	320	210
		Salons 1 & 2 & 3	40 x 113 x 16	4,520	410	240	-	-	430	290
		Salons 4 & 5	55 x 80 x 16	4,400	410	200	-	-	445	330
		Salons 5 & 6	55 x 76 x 16	4,180	390	180	-	-	425	320
		Salons 4 & 5 & 6	55 x 113 x 16	6,215	600	300	-	-	625	500
		Salons 1 & 6	115 x 33 x 16	3,795	320	-	-	-	400	290
	Salons 2, 3, 4, 5	115 x 80 x 16	9,200	800	500	-	-	900	680	
	Liberty Corridor	20 x 113 x 16	2,260	-	-	-	-	-	-	
	Liberty Hall Foyer	-	3,430	-	-	-	-	350	-	