

LEEDS MARRIOTT HOTEL

4 Trevelyan Square,
Boar Lane LS1 6ET
tel: +44 (0) 113 236 6366
fax: +44 (0) 113 236 6367
LeedsMarriott.co.uk

ADDITIONAL MARRIOTT HOTELS IN THE AREA

Marriott Hollins Hall Hotel & Country Club
tel: 01274 530 053
York Marriott Hotel
tel: 01904 701 000

The Thorpe Suite is ideal for smaller meetings, seminars and boardroom style meetings and presentations and can be divided into two sections.

THE THORPE SUITE & BAKEWELL ROOM

The Robinson & Bakewell Rooms are ideal for small meetings and interviews.

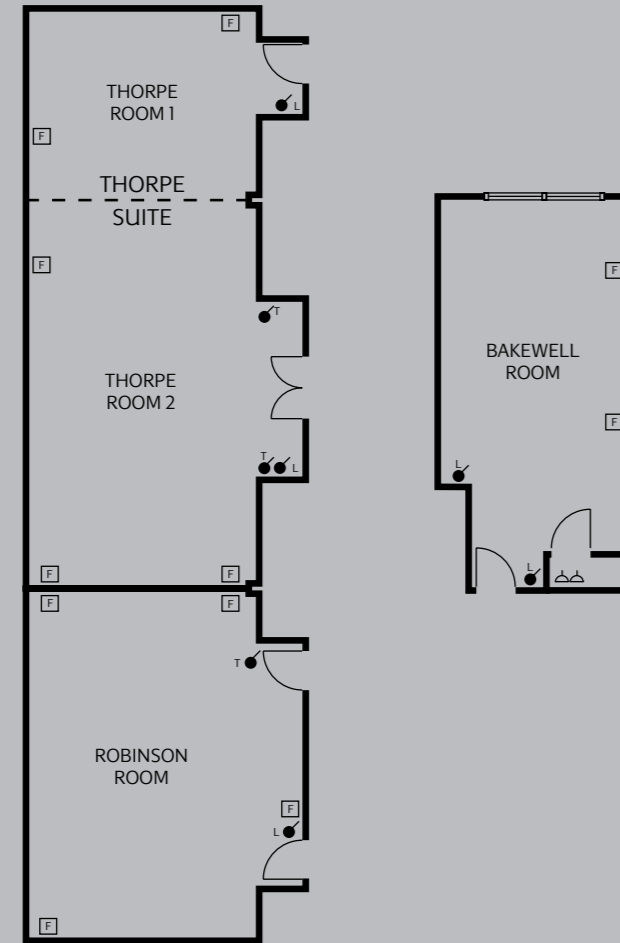

A WARM WELCOME TO THE PERFECT BUSINESS



ACCOMMODATION

244 air-conditioned bedrooms of which 200 are non smoking, 8 suites and 8 disabled. Ensuite bathroom, TV, Air conditioning in bedrooms, high-speed WIFI internet access, mini bar, In room safe, free Sky channels, hairdryer, telephone, tea and coffee making facilities, trouser press and iron and ironing board. Executive rooms available.

RESTAURANTS & LOUNGES

John T's Bar and Restaurant, Georgetown Malaysian Restaurant, Lobby Coffee Lounge

LEISURE FACILITIES

Complimentary: indoor heated swimming pool, spa bath, sauna, steam room, and fully equipped gymnasium. Supplementary: Solaria.

ATTRACTIONS

Royal Armouries Museum, Thackray Medical Museum, Stately Homes including Harewood House and Temple Newsam. Exciting shopping with over 1000 retail outlets including Harvey Nichols and many other designer names.

GUEST SERVICES

24hr room service, laundry service, safe deposit at reception, executive lounge, gift shop, ice machines in public areas, valet parking, concierge, car parking available in the NCP car park adjacent to the hotel. NCP charges apply.

MEETING FACILITIES

18 conference rooms accommodating up to 300 delegates. Marriott Communication Solutions.

DIRECTIONS

From South & West: Exit M621 at J3 follow signs for city centre (A653). With the Energis building on left, turn right at the lights. Pass Asda Head Office on left and turn left at the traffic lights. Follow the road over the bridge. Straight on at the traffic lights onto Lower Briggate, turn left at the next traffic lights (McDonalds is straight ahead). After 20 yds turn left into Trevelyan Square between Toni & Guy and Fast Signs.

From North & East: Follow the city centre loop and exit at J16 onto Lower Briggate and follow as above.

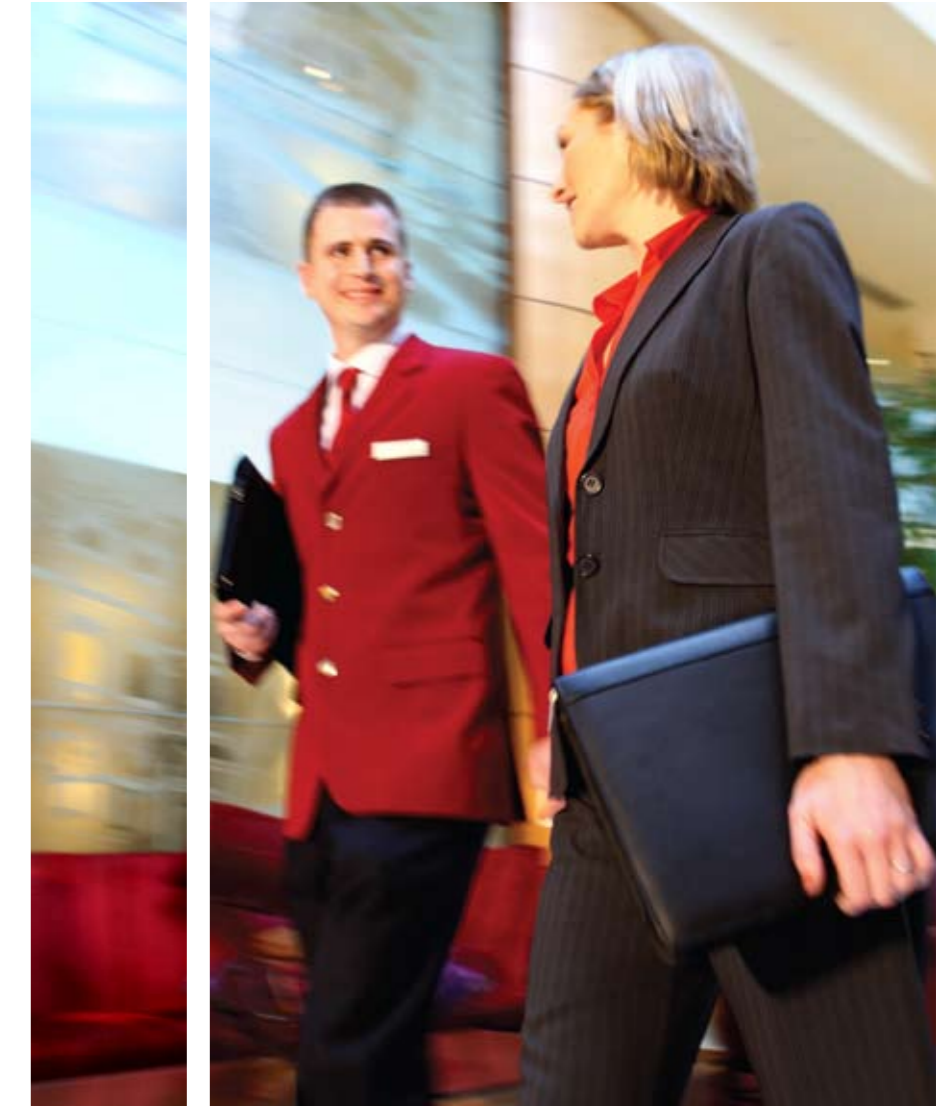

THE PERFECT ENVIRONMENT

Conveniently located close to the major travel networks you are just minutes away from where you need to be. Nip into town or relax in peaceful surroundings. Inside, the décor is stylish and our dedicated service will ensure your event's success. With every detail of your event in hand for whatever you are planning, every amenity has been engineered to help you perform at your best.

CONTENTS

- 2-3 Perfect Place for the perfect day
- 4-5 Challenge minds, inspire action
- 6-7 Cooking with flair
- 8-9 Revive your senses
- 10-11 Feel ready for anything
- 12-15 Planning your event



**DEDICATED TO
BUSINESS**

Accommodating up to 300 guests theatre-style, 260 for a gala dinner or for providing smaller rooms for between 5 and 40, Leeds Marriott can handle any event, meeting, conference or dinner with ease.



**FLEXIBLE SPACE AND
CONNECTIVITY**

It's our goal to make your occasion perfect, in every way. From day one you'll be given a dedicated Event Organiser to help with all the planning. Our adaptable rooms provide space for you to focus on the job in hand, fuelled by tempting refreshments.



Marriott Communications Solutions provide fast, continuous web access plus internet cafés for e-mailing and other internet access. With video conferencing and web casting available, we are up for every possible technical challenge.

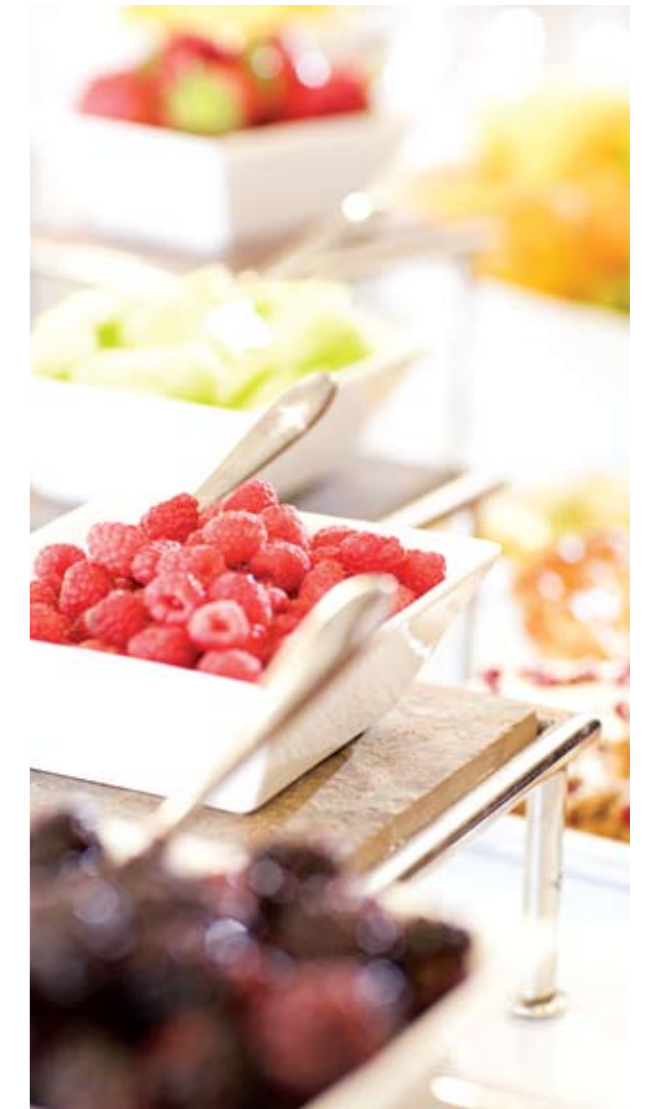

After business take time to relax. Enjoy world cuisine under one roof at the elegant Georgetown Restaurant. Gather with friends and colleagues at John T's Restaurant or grab a light meal or snack in our coffee lounge or bar.

TIME FOR TIME-OUT

Perfect for guests on the move.



Wake up ready to take on the day after spending the night in one of our 244 air-conditioned bedrooms. From our desk space complete with high speed WIFI internet access, to our choice of 24 hour room service and satellite TV, every amenity has the comfort of our guests in mind.

RELAX AND RECHARGE



**FEEL READY
FOR ANYTHING**

The fully equipped Leisure Club provides every facility for recreation and relaxation. Grab a swim or take on a workout to revitalise yourself for the day to come.

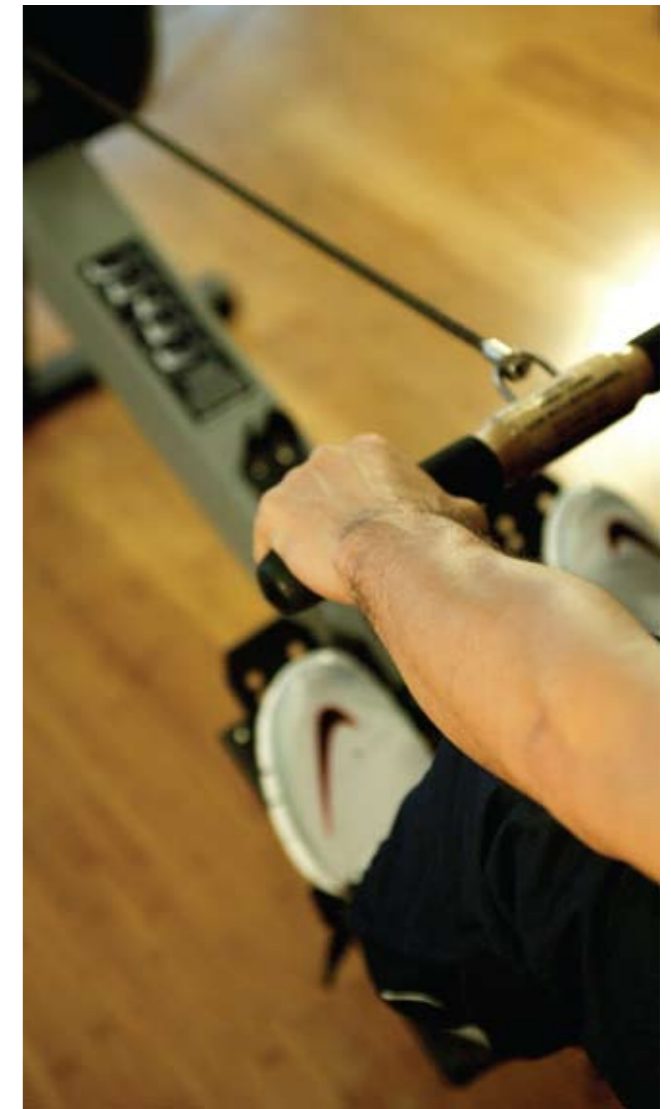

THOMAS AMBLER SUITE

Accommodating up to 300 guests, complete with private reception, integrated sound system and optional wooden dance floor this room can also be divided into three smaller rooms.

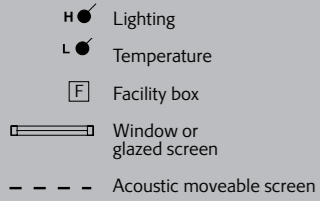
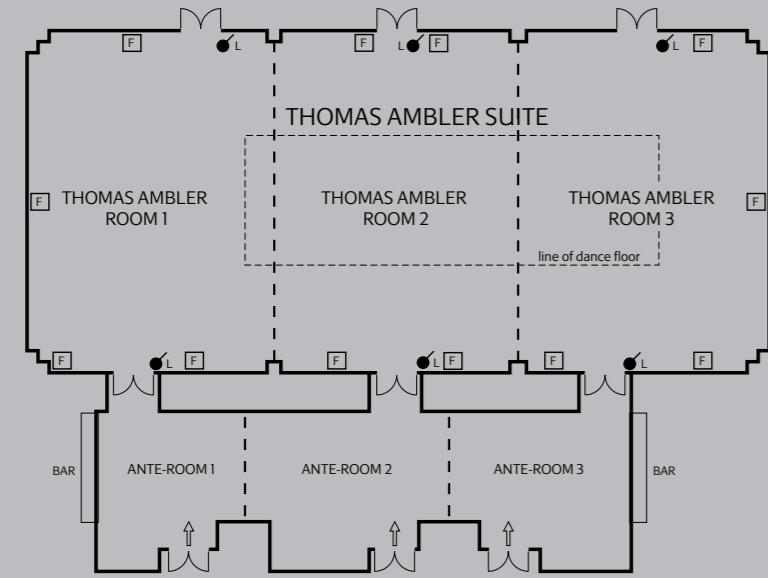

MATCHAM, BRODRICK & BARRY SUITES. SCOTT/CORSON SUITE & THE BOARDROOM.

The Matcham, Brodrick and Barry Suites are ideal for smaller meetings, seminars and breakout rooms. Spacious and versatile, these rooms have plenty of natural daylight and can be divided into two equal sections.

The Scott and Corson Suites can also be divided into two sections and look out over the tranquil square at the front of the hotel. They are bright and comfortable and ideal for meetings, presentations and training.

The Boardroom furnished with classic wood panelled walls and executive leather chairs is perfect for private dining and important meetings.

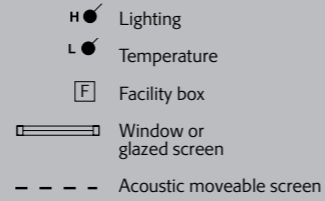
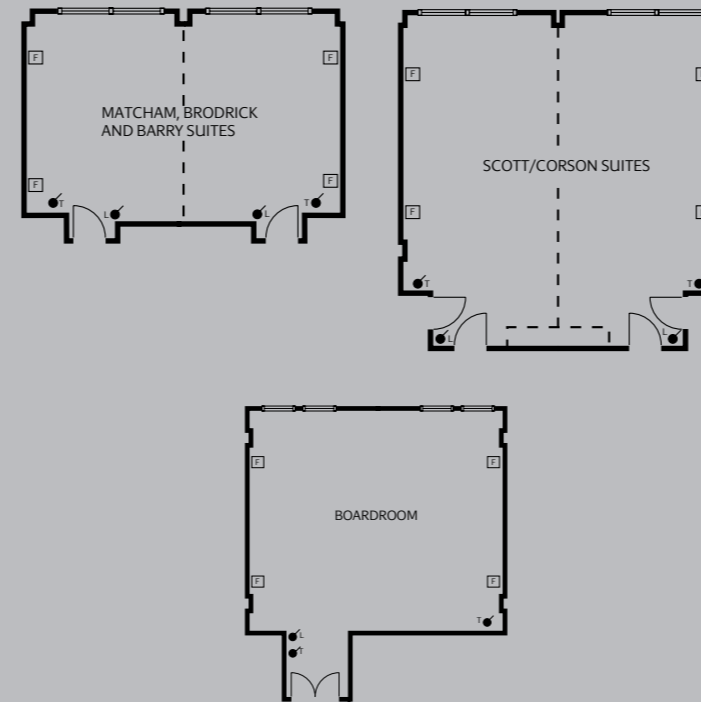

SPACE AS AMBITIOUS AS YOUR ITINERARY.

This quick reference guide is designed to make planning your business event as easy as possible. If you have any questions or would simply like some advice, please get in touch we are here to help. You can either call us direct on +44 (0) 113 236 6366 or email: mangs.salesoffice.northwest@marriotthotels.com. For online information and to download printable floorplans, visit MarriottEvents.co.uk. While you are there, you can also browse through our other great destinations across the UK and Ireland.

Meeting Room	Natural Daylight	Air Conditioning	Wheelchair Access	Dimensions LxWxH	Capacity												
					Theatre Style (No Projection)	Theatre Style (Back Projection)	Theatre Style (Front Projection)	Boardroom Style	U-Shape	Classroom Style	Cabaret Style (No Projection)	Cabaret Style (Back Projection)	Cabaret Style (Front Projection)	Buffet Reception	Dinner/Dance	Dinner	
Thomas Ambler Suite (1, 2 & 3)	✓	✓	✓	26.3x12.4x4.46	300	250	300	80	70	120	180	120	180	270	260	280	
Thomas Ambler Room (1, 2 or 3)	✓	✓	✓	12.4x8.2x4.46	100	60	100	26	35	40	42	-	42	80	60	80	
Barry Suite (1 & 2)	✓	✓	✓	7.5x5.3x2.27	30	-	30	14	12	18	21	-	21	16	-	20	
Barry Room (1 or 2)	✓	✓	✓	3.7x5.3x2.27	15	-	15	8	6	5	-	-	-	-	-	-	
Brodrick Suite (1 & 2)	✓	✓	✓	7.5x5.3x2.27	30	-	30	14	12	18	21	-	21	16	-	20	
Brodrick Room (1 or 2)	✓	✓	✓	3.7x5.3x2.27	15	-	15	8	6	5	-	-	-	-	-	-	
Matcham Suite (1 & 2)	✓	✓	✓	7.5x5.3x2.27	30	-	30	14	12	18	21	-	21	16	-	20	
Matcham Room (1 or 2)	✓	✓	✓	3.7x5.3x2.27	15	-	15	8	6	5	-	-	-	-	-	-	
Boardroom	✓	✓		7.5x7.45x2.27	-	-	-	14	-	-	-	-	-	-	-	14	
Bakewell Room	✓	✓		6.9x3.61x2.27	-	-	-	10	-	-	-	-	-	-	-	-	
Corson Suite (1 & 2)	✓	✓		7.2x6.9x2.27	40	-	40	20	24	20	30	-	30	30	-	30	
Corson Room (1 or 2)	✓	✓		3.6x6.9x2.27	15	-	15	10	8	8	-	-	-	-	-	-	
Scott Suite (1 & 2)	✓	✓		7.2x6.9x2.27	40	-	40	20	20	20	30	-	30	30	-	30	
Scott Room (1 or 2)	✓	✓		3.6x6.9x2.27	15	-	15	10	8	8	-	-	-	-	-	-	
Thorpe Suite (1 & 2)	✓			11.1x4.6x2.27	30	-	30	20	18	20	18	-	18	30	-	30	
Thorpe Room (1)	✓			4.6x3.6x2.27	10	-	10	8	-	-	-	-	-	-	-	-	
Thorpe Room (2)	✓			7.5x4.6x2.27	20	-	20	15	12	12	-	-	-	-	-	-	
Robinson Room	✓			4.6x6.5x2.27	25	-	25	10	12	12	15	-	15	20	-	20	