

you've arrived
meeting and events

Marriott
LONDON MARBLE ARCH



A tradition of warm and caring service



The Hotel's central location, superior amenities and friendly service attract savvy travellers. Whether you are planning a conference, a business meeting, seminar or a private event our aim is to exceed your expectations.

The Hotel welcomes you into its casually elegant setting, where spacious guest rooms are perfectly appointed for a comfortable and productive stay. Every room is equipped with high-speed wireless Internet access, a spacious work desk, air conditioning, minibar, satellite TV and the new Marriott Revive bedding.

The London Marriott Hotel Marble Arch, the perfect combination of comfort and superior amenities.





Down to

business!

The London Marriott Hotel Marble Arch has five meeting rooms accommodating from 5 to 150 delegates. 264 square metres of total meeting space including a 171 square metre pillar-free conference room with natural daylight.

Whether your event is a conference, business meeting, product launch or a private event, our meeting team will approach it with a dedicated focus – providing you with the comfort level and the successful outcome you deserve.





Westmacott Suite 1 & 2

Located on the private mezzanine level, the Westmacott Suite is suitable for conferences, meetings, private functions and dinners and can accommodate up to 150 guests theatre style and 120 for a private dinner. With a sound-proof division, this pillar-free suite can be split into Westmacott 1 and 2, which can each host up to 45 delegates classroom style and 60 guests for a private dinner. The Suite benefits from natural daylight with controllable temperature and lighting.

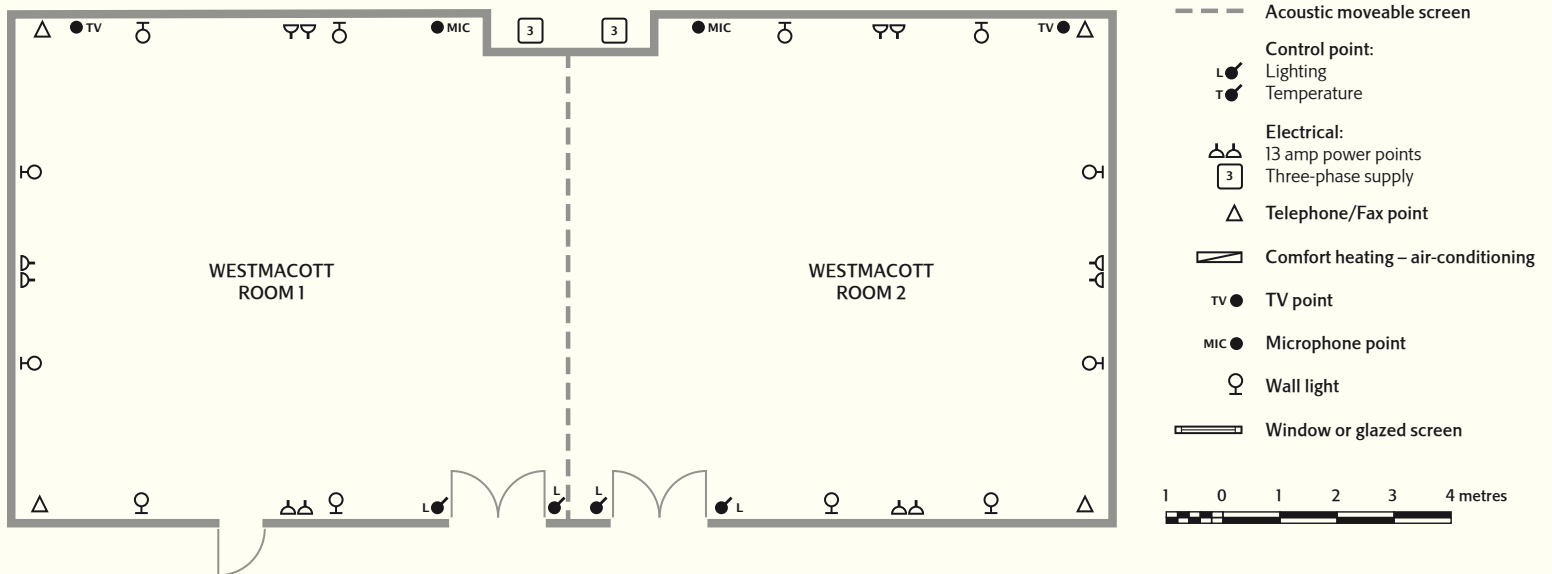

ROOM CAPACITIES (NUMBER OF DELEGATES)

	Dimension L x W x H (metres)	Theatre Style	Boardroom Style	U-Shape	Classroom Style	Buffet Reception	Dinner Dance	Dinner	Cabaret
Westmacott Suite (1 & 2)	19.4 x 8.82 x 2.72	150	60	60	100	200	120	120	80
Westmacott Room (1)	9.7 x 8.82 x 2.72	75	30	32	54	80	-	60	30
Westmacott Room (2)	9.7 x 8.82 x 2.72	75	30	32	48	80	-	60	30



Thomas Moore Suite 1

Boasting its own break-out room and registration area, the versatile and self-contained Thomas Moore Suite 1 can accommodate up to 16 delegates U-shape format, and 25 delegates theatre style.

Thomas Moore Suite 2

A relaxing and informal environment, ideal for one to one interviews and small meetings. This room can interconnect with Thomas Moore Suite 1 for an additional syndicate working area.

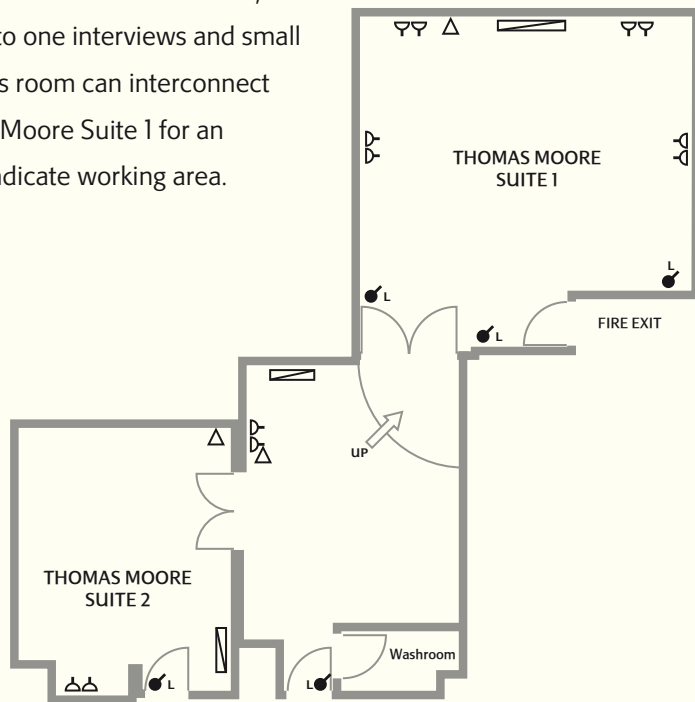

Nightingale Room & Seacole Room

Each accommodating up to 12 delegates, these boardrooms offer natural daylight and dark-wood features, providing the perfect venues for executive meetings or private dining.

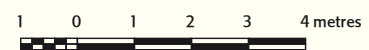
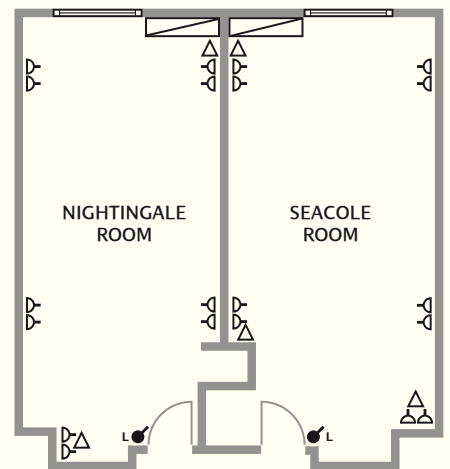

ROOM CAPACITIES (NUMBER OF DELEGATES)

	Dimension L x W x H (metres)	Theatre Style	Boardroom Style	U-Shape	Classroom Style	Buffet Reception	Dinner Dance	Dinner	Cabaret
Seacole Room	7.76 x 3.56 x 2.34	-	12	-	-	-	-	10	-
Nightingale Room	7.76 x 3.56 x 2.34	-	12	-	-	-	-	10	-
Thomas Moore Suite 1	5.3 x 5.2 x 2.6	25	12	16	16	25	-	20	10
Thomas Moore Suite 2	4.5 x 3.7 x 2.6	-	6	-	-	-	-	6	-

Relax

and unwind



If you want to get away from business for a little while during your stay, to rest and relax you'll find everything your need at The London Marriott Marble Arch.

Enjoy full use of our leisure facilities, including indoor heated swimming pool, sauna, spa bath, gym and solarium.

Unwind in Chats Café Bar over afternoon tea, or indulge in freshly prepared dishes with a Mediterranean twist in the new Mediterraneo Restaurant.





P Secure underground parking available at the hotel. Charges apply.

BY ROAD

From M4 Motorway automatically join the A4 towards Central London and continue until Hyde Park Corner. Leave the A4 and join Park Lane up to Marble Arch (the A4202). Go straight on at Marble Arch following signs for A5/A1. Once on Edgware Road, turn right into George Street (5th turning on your right) and the hotel is situated on the left.

BY UNDERGROUND

Marble Arch (Central line), approximately 5 minutes walk.

Edgware Road – (Bakerloo, Circle, District, Hammersmith & City lines), approximately 5 minutes walk.

BY RAIL

Paddington Station: take a left onto Praed Street. Take the second turning on the right into Edgware Road and then the third turning on the left into George Street. The hotel is situated on the left (6 minutes).

BY AIR

Heathrow Airport by train: Heathrow – Paddington Express rail link runs every 15 minutes. Paddington Station: take a left onto Praed Street. Take the second turning on the right into Edgware Road and then take the third turning on the left into George Street. The hotel is situated on the left (6 minutes walk).

Gatwick Airport by train: Gatwick – Victoria Express rail link runs every 15 minutes. A taxi can be taken from the taxi stand outside the station.



Marriott
LONDON MARBLE ARCH

London Marriott Hotel Marble Arch
134 George Street, London W1H 5DN
Tel: +44 (0)20 7723 1277 • Fax: +44 (0)20 7402 0666
LondonMarriottMarbleArch.com