

Room Dimensions Somerleyton & Sandringham

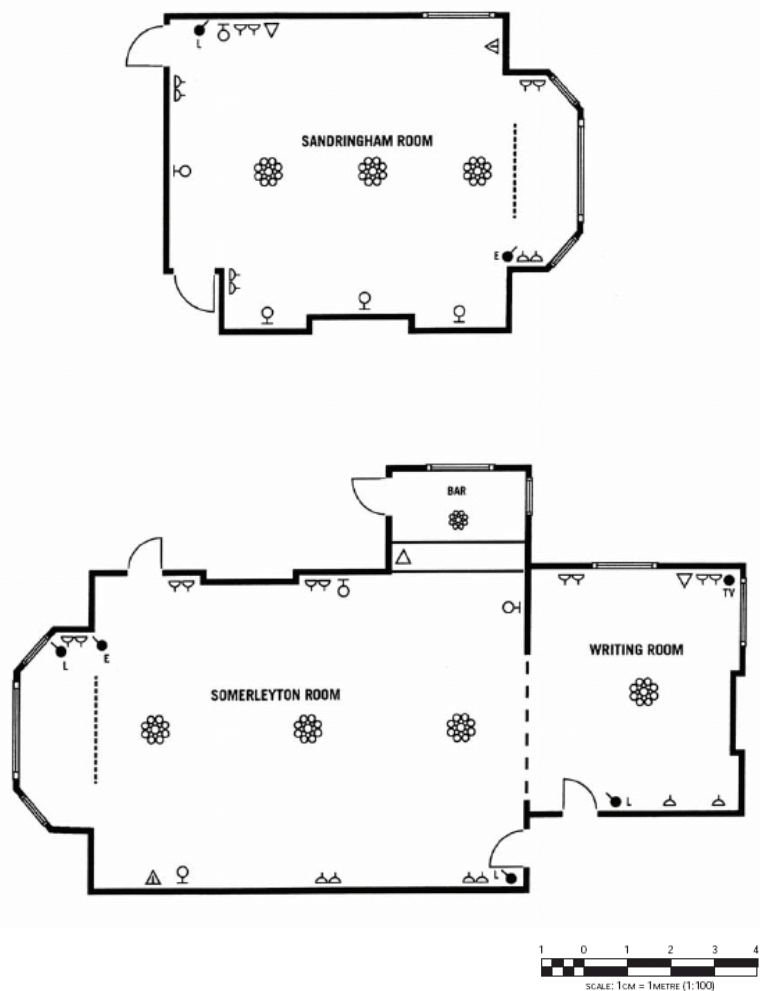

The Somerleyton and Sandringham Rooms are generously proportioned and are ideal for a range of receptions and business functions. While the Sandringham Room lends itself to theatre-style conferences or banquets, the Somerleyton Room is best suited to smaller conferences, receptions and private dinners, having the added facility of its own private bar.

Somerleyton Room
L x W x H (M) 10.9 x 6.7 x 4
Sandringham Room
L x W x H (M) 8.8 x 6.5 x 3.56
Writing Room
L x W x H (M) 5.2 x 4.4 x 4

ROOM CAPACITIES (NO. OF DELEGATES)								
	THEATRE STYLE	BOARDROOM STYLE	U-SHAPE	CLASSROOM STYLE	BULLET RECEPTION	DINNER DANCE	DINNER	CONF BKT
SOMERLEYTON ROOM	60	24	24	30	75	50	50	30
SANDRINGHAM ROOM	50	24	20	20	60	-	30	24
WRITING ROOM	-	8	-	-	-	-	10	-

E	ELECTRIC SCREEN	□ □ □	WALL LIGHT
L	LIGHTING	□	FEATURE LIGHT
⚡	POWER POINTS - 13AMP	□	TELEPHONE/FAX POINT
TV	TV POINT	□	WINDOW OR GLAZED SCREEN
3	THREE PHASE SUPPLY	- - -	ACOUSTIC MOVEABLE SCREEN
□	PROJECTION SCREEN	△	ISDN CONNECTION
MIC	MICROPHONE POINT		

