



Residence Inn by Marriott – Pleasanton

11920 Dublin Canyon Road

Pleasanton, CA 94588

(925) 227-0500

(925) 828 – 1199 Fax

800 321-3131 -- Reservations

www.marriott.com/OAKRI



Services and Amenities:

- 135 fully equipped & furnished studio, one & two bedroom suites
- Spacious living room with twin-size pull out couch & separate sleeping area with queen size bed
- Fully equipped kitchenettes with cookware
- Complimentary High-Speed Internet Access
- Complimentary, daily "Home Touch" hot breakfast
- Complimentary Hospitality Hour featuring a light dinner (M-TH)
- Complimentary Grocery Shopping Service
- Complimentary Shuttle Service with 5-mile radius
- Pets welcome (fee)
- Guest Laundry & Valet Service
- Fitness center, sports court and outdoor heated pool & spa
- All new Fitness Center with Life fitness Equipment - 3 treadmills with iPod docking stations, 2 stationary bikes, & elliptical cycles, free weights & HDTV
- 1800+ sq. feet of meeting space

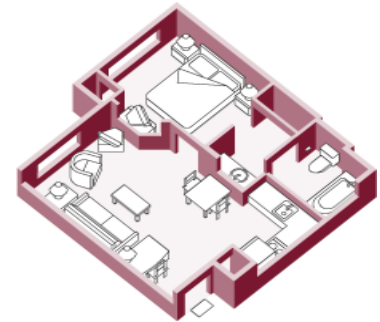

Local Distances:

- Alameda County Fairground (6 mi)
- Downtown Pleasanton (6 mi)
- Sunol & Livermore Valley Wineries (10 mi)
- San Francisco (52 mi)
- Stoneridge Mall (0.3 mi)
- Hacienda Business Park (2.5 mi)



Residence Inn by Marriott Pleasanton hotel welcomes you to the Tri-Valley area of San Ramon, Livermore and Dublin, California. Adjacent to I-580 & I-680 junction the hotel is conveniently located close to Stoneridge Shopping Center, BART, restaurants and area attractions. The modern **Residence Inn, Pleasanton** is unique for the Tri-Valley area, blending stylish luxuries like granite countertops & 37 inch HD plasma TVs with the comfort you expect from the hotel that perfected the extended stay.

Our Pet friendly hotel features **all-suites**, many with fireplaces, kitchens with microwave, refrigerator, stovetops (some with ovens), complete cookware & **complimentary high-speed internet**. Start the day with a complimentary hot breakfast. Our evening social hour (Mon-Thu) & weekly summer BBQ offer a light dinner meal & beverage. Our fitness room, outdoor pool, heated spa & Sport Court are available to relax and unwind. Corporate meetings will enjoy our 1,800+ sq ft of banquet space wired for High-Speed & Wi-Fi wireless connections. Safety, comfort, cutting-edge technology and unsurpassed service have earned us AAA 3 Diamonds.

In addition Marriott Rewards offers exclusive privileges to its participants. As a Member of the Marriott Rewards program, you can earn points toward free hotel stays, airline miles and much more every time you stay at any one of Marriott's hotels worldwide.



With the Marriott Rewards program, you get to choose. Earn "points" toward free stays, merchandise and services, or earn frequent flyer miles on your favorite airline. Frequent travelers also enjoy "elite level" benefits - upgrades, special bonuses, gifts and other exclusive privileges.

The benefits of Marriott Rewards go far beyond points and miles. Take a look at all that is in store when you join the best rewards program available by visiting www.marriottrewards.com.

Directions to 11920 Dublin Canyon Rd., Pleasanton, CA 94588

From Oakland -OAK

Take 880 South to 580 East; exit at Foothill Blvd., Turn right at Dublin Canyon Road; hotel is on right.

From San Francisco -SFO

Take 101 South to San Mateo Bridge (Hwy 92 East); to 880 North to 238 East to 580 East; exit Foothill Blvd.; turn right at Dublin Canyon Road; hotel is on right.

From San Jose - SJO

Take I-880N merge onto Mission Blvd to I-680 N exit off I-680 at Stoneridge Drive. Turn left on Stoneridge Drive then right on Foothill Rd. to Dublin Canyon Road then turn left. Hotel is on the right

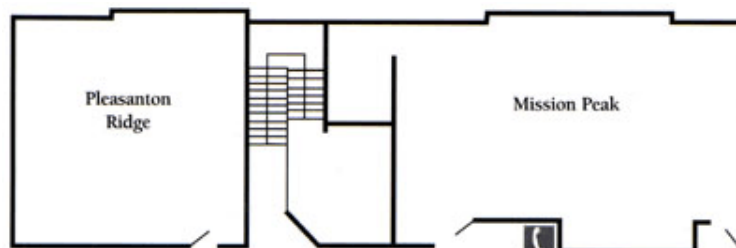
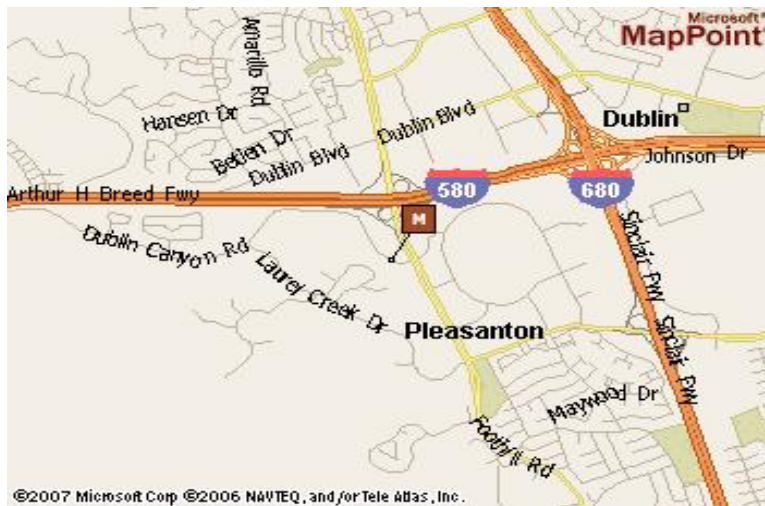

Complete Audio Visual & catering available



**Detailed, Flexible & Responsive
Let us plan your next meeting!**

Two meeting rooms to accommodate small to medium groups & dedicated Boardroom. Total 1,806 sq ft

| Meeting Room | Dimensions | Square Footage | Ceiling Height | Dining | Theater | Classroom 3 person per 6ft | Hollow Square | U-Shape | Conference |
|------------------|------------|----------------|----------------|--------|---------|-------------------------------|---------------|---------|------------|
| Mission Peak | 45' x 22' | 990 | 8' 6" | 60 | 70 | 60 | 30 | 25 | 25 |
| Board Room | 18' x 12' | 216 | 7' 8" | - | - | - | - | - | 8 |
| Pleasanton Ridge | 20' x 30' | 600 | 8' 6" | 40 | 45 | 45 | 20 | 16 | 16 |