



**IDEAL LOCATION. UNRIVALED SERVICE. TOP-NOTCH
TECHNOLOGY. TAKING MEETINGS TO NEW HEIGHTS.**



| Meeting Room | Dimensions | | Capacity | | | | | |
|------------------------------------|------------|---------|----------|------------|------------|---------|-----------|---------|
| | W×L×H | Sq. Ft. | Theater | Schoolroom | Conference | U-Shape | Reception | Banquet |
| Grand Ballroom | 61×126×12 | 7,686 | 840 | 520 | – | – | 1,100 | 600 |
| Salons I, II, III or IV | 32×61×12 | 1,952 | 200 | 100 | – | – | 250 | 150 |
| Salons I & II or III & IV | 64×60×12 | 3,840 | 420 | 224 | – | – | 500 | 300 |
| Freedom | 37×28×10 | 1,036 | 100 | 60 | 35 | 46 | 60 | 80 |
| Weatherly | 39×27×8 | 1,053 | 100 | 60 | 35 | 40 | 75 | 80 |
| Columbia | 29×23×8 | 667 | 65 | 35 | 25 | 25 | 50 | 50 |
| Courageous | 29×22×8 | 638 | 65 | 35 | 25 | 25 | 50 | 50 |
| Enterprise | 29×22×8 | 638 | 65 | 35 | 25 | 25 | 50 | 50 |
| Boardroom | 27×18×8 | 486 | – | – | 16 | – | – | – |
| Stars and Stripes | 24×45×9 | 1,080 | 95 | 50 | 30 | 30 | 110 | 80 |
| Atrium | 81×109×50 | 8,829 | – | – | – | – | 800 | 440 |
| Jamestown Suite | 21×20×10 | 420 | 30 | 18 | 14 | 12 | 30 | 18 |
| Bristol Suite | 21×19×10 | 399 | 30 | 18 | 8 | 12 | 30 | 10 |
| Newport Suite | 29×25×10 | 725 | 65 | 35 | 25 | 25 | 70 | 50 |
| Middletown Suite | 29×24×10 | 696 | 60 | 32 | 20 | 20 | 50 | 40 |
| Portsmouth Suite | 28×20×10 | 560 | 40 | 24 | 18 | 16 | 40 | 30 |
| Narragansett Suites Reception Area | 30×30×9* | 900 | – | – | – | – | 50 | 40 |
| Intrepid | 21×15×8 | 315 | – | – | 12 | – | – | – |

* Irregular shape



OUR HARBORFRONT LOCATION SETS THE STAGE FOR A SUPERB MEETING.

With 319 rooms and 24,800 square feet of event space, a stunning waterfront location, and easy access to the city's legendary attractions including the Cliff Walk and the famed Newport Mansions, we're ready to accommodate any meeting or conference you have. Our Grand Ballroom is 7,686 square feet and can accommodate 1,100 for a reception or 600 for a banquet. The setting is sophisticated and stylish. The service is top-notch. And we're easily accessible on the East Coast.

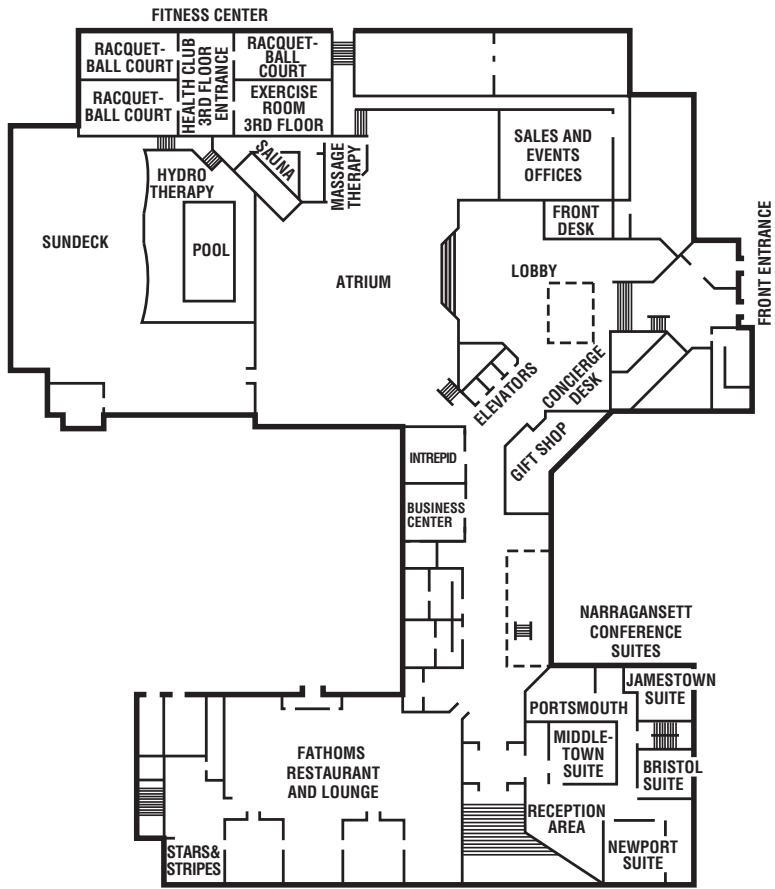

SECOND FLOOR LEVEL

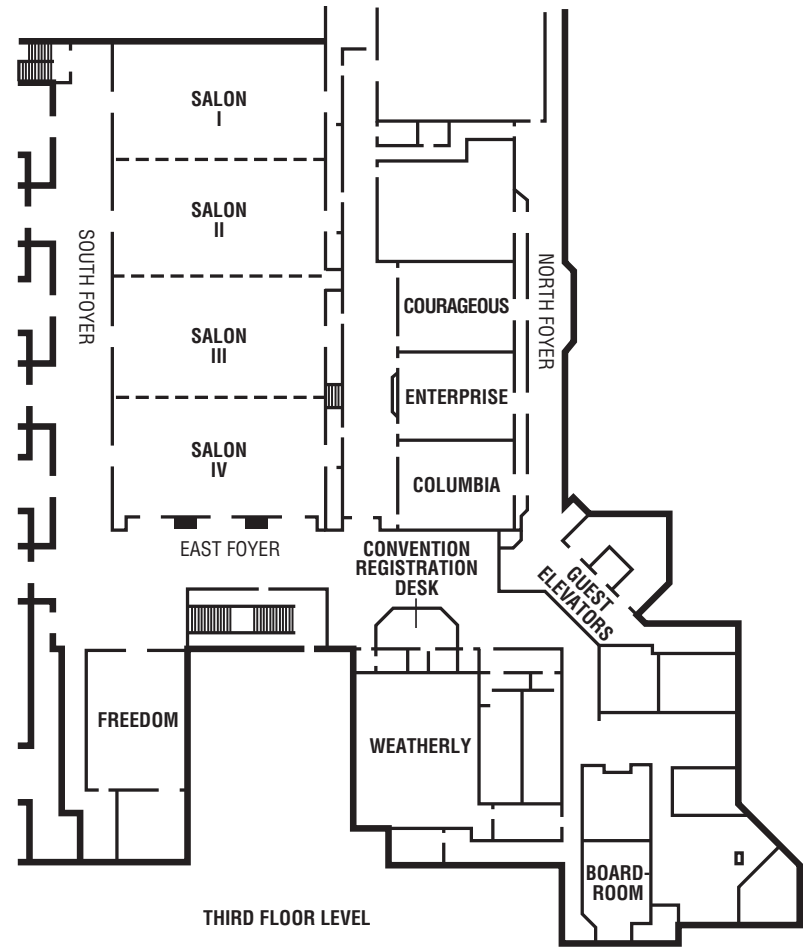

THIRD FLOOR LEVEL



ACCOMMODATIONS

7 floors • 319 rooms • 7 suites • Executive Concierge Level • Concierge Lounge with harbor views • Wired and wireless high-speed Internet access • Marriott Revive® bed • 32" HDTV • Ultra-compatible Plug-in Panel to connect MP3, digital camera, and gaming system • Laptop safe • Mini-refrigerator • Smoke-free hotel policy • Check-in: 4:00 p.m. • Check-out: 11:00 a.m.

RESTAURANTS & LOUNGES

Fathoms Restaurant featuring local, fresh seafood and New England specialties (breakfast/lunch/dinner) • Fathoms Bar • Room Service • Starbucks® Café

RECREATION & LEISURE

The Spa at Newport Marriott, featuring massage services, facials, hair care, make up consultation and nail care • Indoor pool • Whirlpool • Sauna • Fitness Center • Racquetball courts • Sun deck • Jogging (nearby) • Golf (nearby) • Tennis (nearby) • Beach (nearby) • Sailing (nearby)

ATTRACTIONS

Newport Mansions • International Tennis Hall of Fame • Cliff Walk • Fort Adams State Park • Museum of Newport History • Newport Art Museum • Museum of Yachting • Brick Market Place • Thames Street shopping, restaurants and nightlife • Green Animals Topiary Garden • Norman Bird Sanctuary • Touro Synagogue • Naval War College Museum • Scenic Harbor Tours • Sailing on 12 meter boats

GUEST SERVICES

24 hour Business Center • Valet and onsite laundry • Chandlery Gift Shop/market • Concierge services • Valet and self parking • Commercial airport transportation to Logan Airport in Boston and T.F. Green Airport in Providence

MEETING FACILITIES

17 meeting rooms • 24,800 sq. ft. of event space • 7,686 sq. ft. Grand Ballroom divisible into 4 sections • Grand Ballroom seats up to 840 guests • 8,829 sq. ft. Atrium seats 440 for banquets • Outdoor terrace available for seasonal events • Wireless high-speed Internet access • Dedicated event professionals to handle all of your meeting and special event needs • A selection of creative custom menu options

LOCATION

Harborside location in the heart of historic Newport, Rhode Island • Short drive to Newport Mansions • Easy walk to Thames Street, Bannister's Wharf and Bowen's Wharf • 27 miles from Providence, RI • 65 miles from downtown Boston

NEWPORT MARRIOTT

25 America's Cup Avenue
Newport, RI 02840
Phone 401.849.1000
Fax 401.849.6775
NewportMarriott.com