



**THE MOST DISTINCTIVE EVENTS
IN NEWPORT BEGIN HERE.**

Marriott.
NEWPORT

Meeting Room	Dimensions		Capacity	
	W×L×H	Sq. Ft.	Reception	Banquet
Grand Ballroom	61×126×12	7,686	1,100	600
Salons I, II, III or IV	32×61×12	1,952	250	150
Salons I & II or III & IV	64×60×12	3,840	500	300
Freedom	37×28×10	1,036	60	80
Weatherly	39×27×8	1,053	75	80
Columbia	29×23×8	667	50	50
Courageous	29×22×8	638	50	50
Enterprise	29×22×8	638	50	50
Stars and Stripes	24×45×9	1,080	110	80
Atrium	81×109×50	8,829	800	440
Jamestown Suite	21×20×10	420	30	18
Bristol Suite	21×19×10	399	30	10
Newport Suite	29×25×10	725	70	50
Middletown Suite	29×24×10	696	50	40
Portsmouth Suite	28×20×10	560	40	30
Narragansett Suites Reception Area	30×30×9*	900	50	40

* Irregular shape



MAKE IT AN EVENT TO REMEMBER.

With a spectacular waterfront location in historic Newport, Rhode Island, and 24,800 square feet of function space – including a stunning Atrium – our resort is the perfect setting for weddings, charity events, bar and bat mitzvahs, anniversary and birthday parties, and so much more. Our Grand Ballroom is 7,686 square feet and can accommodate 1,100 for a reception or 600 for a banquet. The setting is sophisticated and stylish. The service is top-notch. And your guests will love our Newport location near the Cliff Walk, famed Newport Mansions, and so much more.

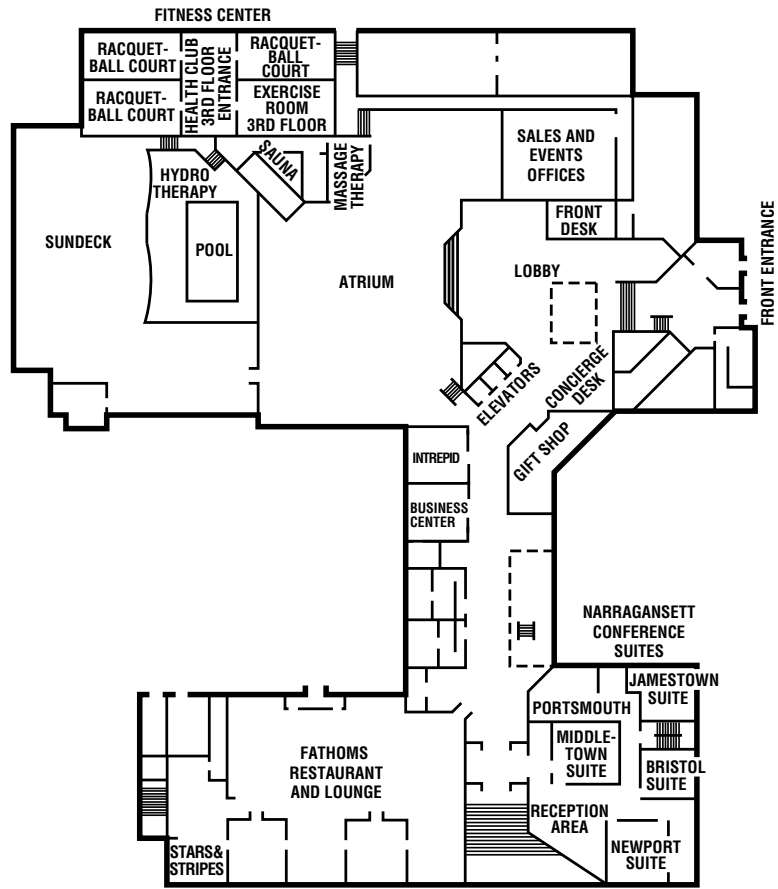

SECOND FLOOR LEVEL

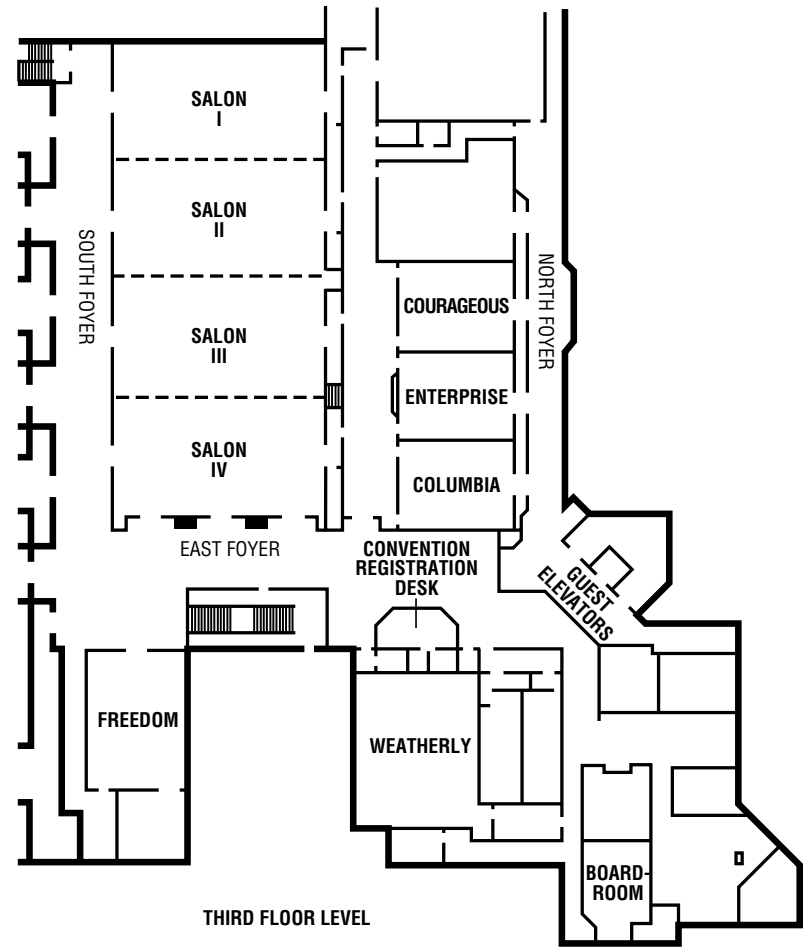

THIRD FLOOR LEVEL



ACCOMMODATIONS

7 floors • 319 rooms • 7 suites • Executive Concierge Level • Concierge Lounge with harbor views • Wired and wireless high-speed Internet access • Marriott Revive® bed • 32" HDTV • Ultra-compatible Plug-in Panel to connect MP3, digital camera, and gaming system • Laptop safe • Mini-refrigerator • Smoke-free hotel policy • Check-in: 4:00 p.m. • Check-out: 11:00 a.m.

RESTAURANTS & LOUNGES

Fathoms Restaurant featuring local, fresh seafood and New England specialties (breakfast/lunch/dinner) • Fathoms Bar • Room Service • Starbucks® Café

RECREATION & LEISURE

The Spa at Newport Marriott • Indoor pool • Whirlpool • Sauna • Fitness Center • Racquetball courts • Sun deck • Jogging (nearby) • Golf (nearby) • Tennis (nearby) • Beach (nearby) • Sailing (nearby)

SPA

Perfect for hosting bridal parties • Relaxing rejuvenation lounge • Licensed and trained professionals • Massages • Body treatments • Facials • Manicures • Pedicures • Hair salon

ATTRACTIONS

Newport Mansions • International Tennis Hall of Fame • Cliff Walk • Fort Adams State Park • Museum of Newport History • Newport Art Museum • Museum of Yachting • Brick Market Place • Thames Street shopping, restaurants and nightlife • Green Animals Topiary Garden • Norman Bird Sanctuary • Touro Synagogue • Naval War College Museum • Scenic Harbor Tours • Sailing on 12 meter boats

GUEST SERVICES

24 hour Business Center • Valet and onsite laundry • Chandlery Gift Shop/market • Concierge services • Valet and self parking • Commercial airport transportation to Logan Airport in Boston and T.F. Green Airport in Providence

EVENT FACILITIES

17 banquet rooms • 24,800 sq. ft. of event space • 7,686 sq. ft. Grand Ballroom divisible into 4 sections and is perfect for weddings up to 600 seated • Grand Ballroom accommodates up to 1,100 for receptions • 8,829 sq. ft. Atrium seats 440 for special events • Outdoor terrace available for seasonal events • Wireless high-speed Internet access • Dedicated event professionals to handle all of your special event needs • A selection of custom wedding menus and creative theme parties

LOCATION

Harborside location in the heart of historic Newport, Rhode Island • A short drive to Newport Mansions • A quick walk to Thames Street shops, restaurants and nightlife • 27 miles from Providence, RI • 65 miles from downtown Boston

NEWPORT MARRIOTT

25 America's Cup Avenue
Newport, RI 02840
Phone 401.849.1000
Fax 401.849.6755
NewportMarriott.com