

TEXAS-SIZED INSPIRATION IN SAN ANTONIO.

Marriott.
SAN ANTONIO
RIVERCENTER



Meeting Room	Dimensions		Capacity					
	LxWxH	Sq. Feet	Theater	Schoolroom	Conference	U-Shape	Reception	Banquet
Grand Ballroom	260x160x25	41,600	4,400	—	—	—	6,400	3,080
Salon A	35x46x25	1,610	180	80	38	38	285	120
Salon D	35x50x25	1,750	180	80	38	42	285	120
Salon B & C	40x32x25	1,280	126	70	30	34	185	90
Salon E	83x81x25	6,723	720	480	—	—	1,050	490
Salon F	83x75x25	6,225	720	480	—	—	1,050	490
Salon G	86x46x25	3,956	440	250	—	—	645	320
Salon H	86x64x25	5,504	640	420	—	—	910	480
Salon I	86x50x25	4,300	480	270	—	—	660	320
Salon J	35x50x25	1,750	180	90	38	42	285	120
Salon M	35x46x25	1,610	180	80	38	38	285	120
Salon K	40x32x25	1,280	114	70	30	34	185	90
Salon L	40x32x25	1,280	114	70	30	34	185	90
Conference Room 1	29x21x9	609	70	40	26	28	106	50
Conference Room 2	29x22x9	638	70	40	26	28	106	50
Conference Room 3	29x22x9	638	70	40	26	28	106	50
Conference Room 4	29x22x9	638	70	40	26	28	106	50
Conference Rooms (combined)	30x88x9	2,640	294	154	—	—	425	200
Conference Room 5 & 6	31x20x9	620	73	38	26	28	90	40
Conference Room 7	29x27x9	783	88	50	26	28	150	50
Conference Room 8	30x27x9	810	88	50	26	28	125	50
Conference Room 9	32x19x9	608	64	48	28	28	85	40
Conference Room 10	32x18x9	576	64	48	28	28	80	40
Conference Room 11	30x26x9	780	80	50	26	28	125	50
Conference Room 12	31x32x9	992	100	64	28	30	160	60
Conference Room 13	25x20x9	500	60	24	24	24	85	40
Conference Rooms 13 & 14 (combined)	29x42x9	1,218	135	56	44	44	180	80
Conference Room 14	32x20x9	640	60	24	24	24	85	40
Conference Room 15	35x18x9	630	68	27	32	32	95	40
Conference Room 16	21x28x9	588	70	40	28	28	140	60
Conference Rooms 17 & 18 (combined)	28x60x9	1,680	223	140	50	50	280	120
Conference Room 17	29x30x9	870	97	50	26	28	140	60
Conference Room 18	29x30x9	870	97	50	26	28	140	60
Conference Room 19	22x19x9	418	40	24	18	17	55	30

The San Antonio Marriott® Rivercenter hotel rises 38 stories over the San Antonio River Walk. Deep in the heart of beautiful downtown San Antonio, the hotel is one of the most high-tech hotels on the River Walk with Marriott Plug-In Technology, LCD TVs, premium cable, and high-speed Internet in each guest room. Enjoy meetings and events in 36 meeting rooms offering 60,000 square feet of space. Our Grand Ballroom boasts 41,600 square feet and can comfortably seat 4,400. When it's time for a break, enjoy a superb meal in our sizzling restaurant, *Sazo's Latin Grill*, where guests will enjoy a tantalizing fusion of Latin and Spanish flavors in both the menu and the ambience. With its close proximity to the San Antonio Henry B. Gonzalez Convention Center and its tradition of service excellence, the hotel is an excellent place to host your next meeting or social event.



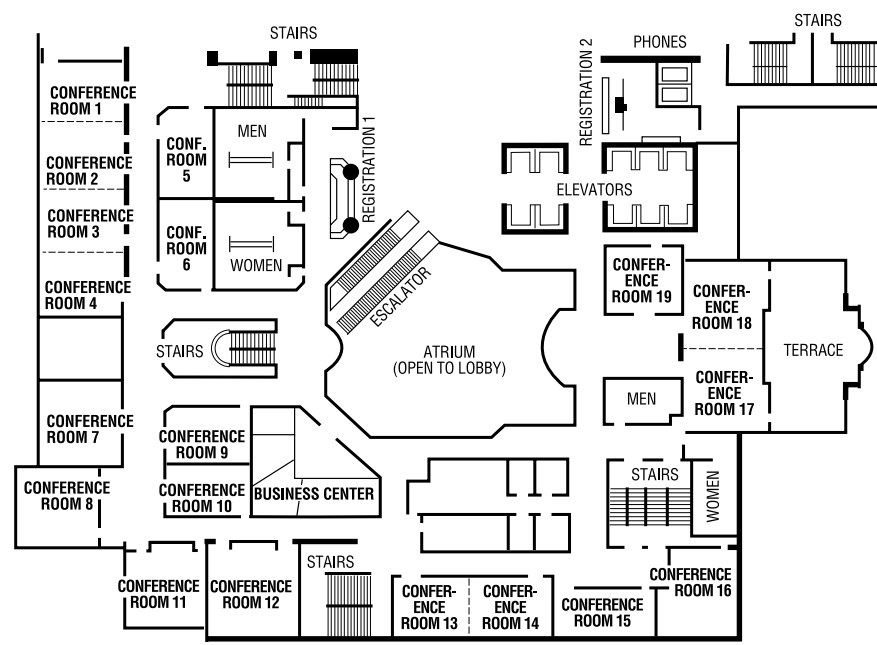
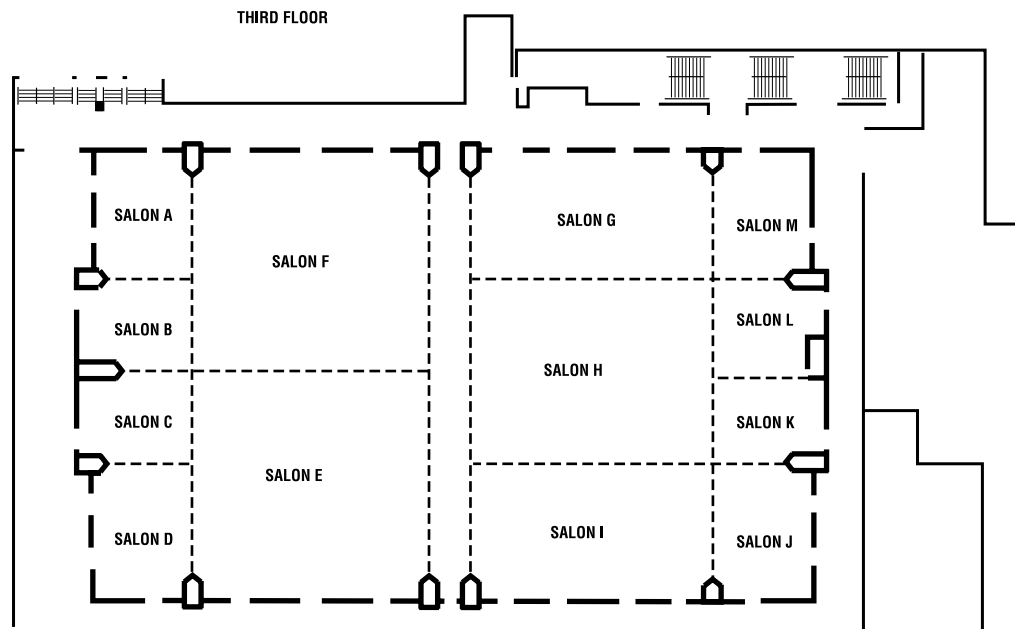

SAN ANTONIO MARRIOTT® RIVERCENTER

101 Bowie Street
San Antonio, Texas 78205
Phone: 210.223.1000
Fax: 210.223.6239
Marriott.com/satrc



ACCOMMODATIONS

38 floors • 915 guest rooms and 86 suites • 1 Concierge Level • High-speed Internet access

RESTAURANTS & LOUNGES

Sazo's Latin Grill • Lobby Bar • The Bar • Starbucks®

RECREATION & LEISURE

Health club • Indoor/outdoor connecting pool • Sauna • River Cruise Tours • Whirlpool • 4 golf courses within a 10-mile radius • Bowling and miniature golf nearby

ATTRACTIONS

Alamo • Buckhorn Hall of Horns • El Mercado/Market Square • IMAX Theatre @ Rivercenter Mall • La Villita • Mission Trail • The River Walk (Paseo del Rio) • San Antonio Zoological Gardens and Aquarium • SeaWorld® of Texas • Six Flags® Fiesta Texas Theme Park

GUEST SERVICES

Committed to a smoke-free environment • Babysitting • Concierge desk • Evening turndown service • Full-service business center • Foreign exchange • Giftshop/Newsstand • Newspaper delivered to room • Room service, 6:00 am - midnight • Safe-deposit boxes at front desk • Shoeshine • *USA Today* in lobby • Valet dry-cleaning • Vending machine

MEETING FACILITIES

36 meeting rooms • 60,000 square feet of total meeting space; maximum seating capacity for 4,400 guests • Catering and audiovisual equipment available • Decorator, electrician, locksmith, photographer and security guard available • Videoconferencing • Wireless high-speed Internet access

DIRECTIONS

From San Antonio International Airport (SAT): Take 281 South to Commerce St. exit. Make a right at the light (Commerce) and continue down 1 block; hotel is on the right-hand side, at the corner of Bowie and Commerce.