

## AMENITIES

### ACCOMMODATIONS

- 6 floors, 517 guest rooms, and 22 suites
- Concierge Level rooms and lounge
- Internet browser/Web TV
- Dual-line phone with voice mail and data port
- High speed Internet access
- 37" flat screen TV with remote control
- Cable/satellite TV
- Movies/videos, pay per view
- Iron and ironing board
- Hair dryer
- Coffee maker/tea service
- Cribs available
- Individual climate control
- AM/FM alarm clock

### GUEST SERVICES

- On-site and valet parking available
- Concierge desk
- In-room dining
- Laundry/dry cleaning
- Safe deposit boxes at front desk
- Soda, ice machines
- Business center
- Video review billing/video checkout

### RESTAURANTS

- Einstein's Bagels, featuring delicious bagels, sandwiches, salads and gourmet coffee
- Station Grille, featuring classic and innovative American cuisine for breakfast, lunch and dinner
- Grand Hall, featuring fine wines, liquors, espressos and appetizers

### MEETING FACILITIES

- A total of 35,000 square feet of flexible meeting space
- 16,200-square-foot Grand Ballroom
- 8,100-square-foot Regency Ballroom
- 24-hour Business Center with computer, printers and fax machines
- Concierge level guest rooms with private lounge
- 5,000 square feet of pre-function space
- Exhibit space totaling 30,500 square feet
- 25 flexible meeting and banquet rooms on the first two floors
- All meeting rooms offer individual or master controls for heat/AC, telephones, multiple electrical/microphone outlets and 110V/220V single-phase electricity and T1 Internet access
- T3 (20mb) Internet access with additional bandwidth available
- Gigabit Internet connection in every meeting room

### RECREATION & LEISURE

- 24 hour Fitness Center
- Seasonal outdoor pool
- Jogging and fitness trail nearby
- Tennis nearby
- Golf nearby

### DISTINCTIONS

- Historic Hotel of America
- AAA Four Diamond



### PLACES TO SEE / THINGS TO DO

- America's Center
- Anheuser-Busch Brewery
- Busch Stadium
- City Museum
- Edward Jones Dome
- Fabulous Fox Theatre
- Forest Park
- Gateway Arch
- Laclede's Landing
- Magic House/St. Louis Children's Museum
- Missouri Botanical Garden
- Missouri History Museum
- Old Courthouse
- Riverboat casinos
- Scottrade Center
- St. Louis Art Museum
- St. Louis Science Center
- St. Louis Zoo
- Union Station
- Washington University

**Marriott**  
ST. LOUIS UNION STATION



**RICH TRADITION.  
MAGNIFICENT MEETINGS.**

## MEETING SPACES

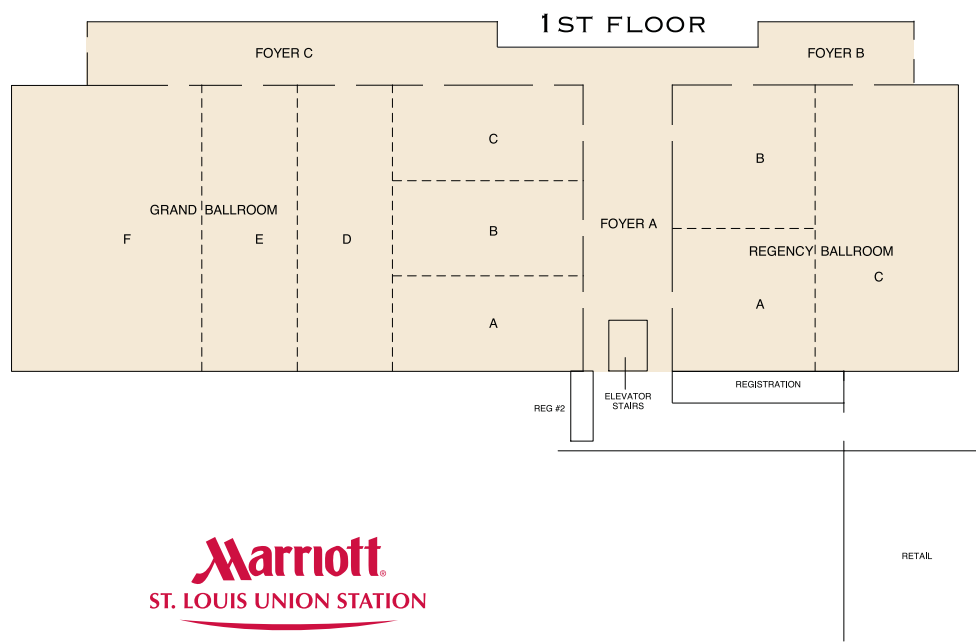

One St. Louis Union Station St. Louis, Missouri 63103  
 T: 314-621-5262 F: 314-621-5267  
 Toll Free: 1.800.410.9914  
 www.unionstationmarriott.com



### LOCATION

Located at the St. Louis Union Station, a National Historic Landmark, in downtown. Union Station offers great shopping, delicious dining and fabulous entertainment. Conveniently located minutes from the Gateway Arch, America's Convention Center, and other downtown attractions, businesses, and restaurants. 15 miles from Lambert International Airport.

### DIRECTIONS:

From Lambert Int'l Airport (STL)/East:  
 Take 70 East. Exit Memorial Drive East. Turn right at 3rd light (Market). Stay on Market until 18th Street. Hotel on left.

From Airport/West:  
 Take 70 East to 170 South to 40 East. Exit at 20th at Chestnut. Turn right at the light (20th). Turn left at the next light (Market). Hotel on right.

From North: Exit Truman Parkway, follow to Market St. Make Left at Market. Hotel on left.

## 2ND FLOOR CONFERENCE CENTER

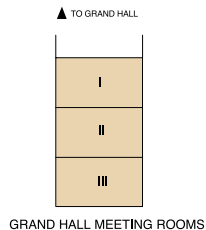
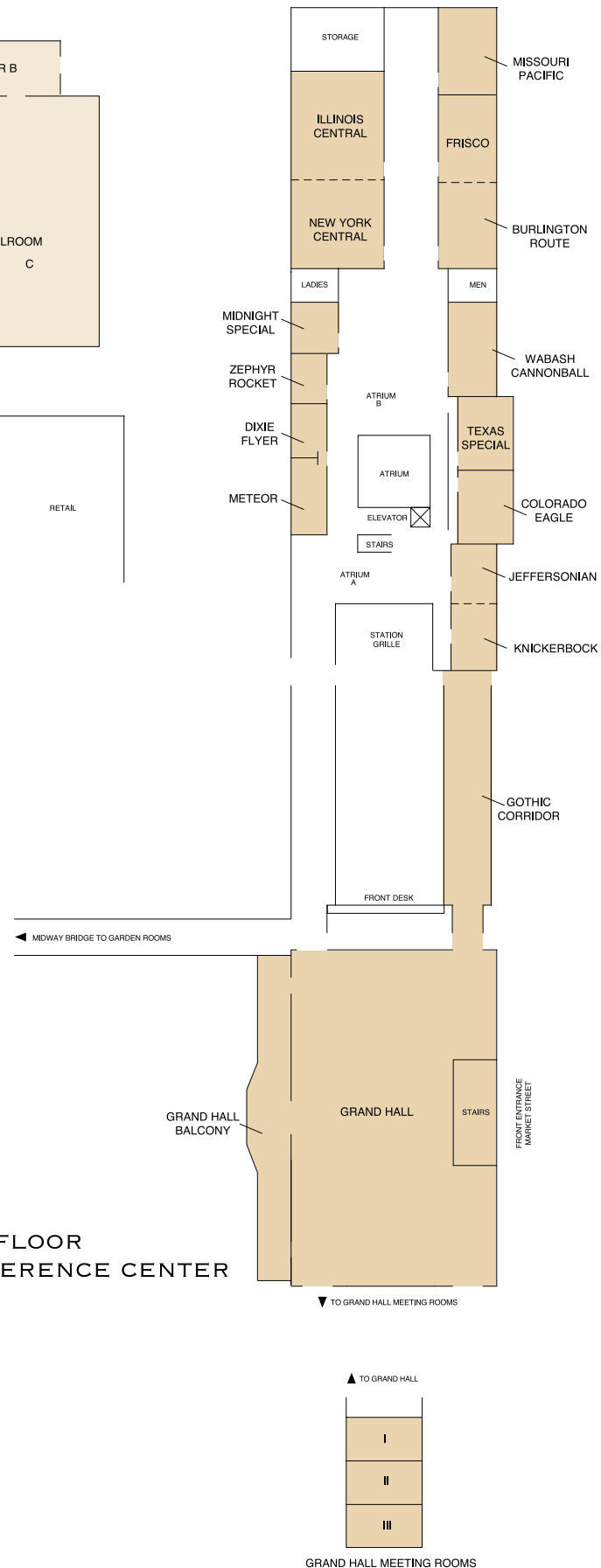

## CAPACITY CHART

ROOM NAME	ROOM DIMENSIONS LENGTH X WIDTH X HEIGHT	SQUARE FEET	BANQUET	RECEPTION	THEATER	CLASSROOM	BOARDROOM	U-SHAPE	HOLLOW SQUARE	EXHIBIT
-----------	--	----------------	---------	-----------	---------	-----------	-----------	---------	------------------	---------

### FIRST FLOOR GARDEN SECTION

GRAND BALLROOM	180' x 90' x 20'	16,200	1,350	1,800	1,871	1,152	-	-	-	104
F	60' x 90' x 20'	5,400	450	600	600	360	-	-	-	35
E or D	30' x 90' x 20'	2,700	220	300	300	174	72	-	88	17
A, B, or C	60' x 30' x 20'	1,800	140	200	238	132	54	-	64	11
E & F or A-D	90' x 90' x 20'	8,100	670	900	800	540	-	-	-	52
E & D or A, B & C	60' x 90' x 20'	5,400	450	600	600	360	-	-	-	34
A & B	60' x 60' x 20'	3,600	270	400	434	264	52	-	96	22
D, E & F	120' x 90' x 20'	10,800	930	1,200	1,242	756	-	-	-	70
REGENCY BALLROOM	90' x 90' x 18'	8,100	670	1,000	948	540	-	-	-	51
C	45' x 90' x 18'	4,000	320	450	440	288	-	90	108	25
A or B	45' x 45' x 18'	2,000	160	225	212	123	36	48	66	12
BALLROOM foyer A	78' x 28' x 18'	2,184	-1	75	-	-	-	-	-	8
BALLROOM foyer B	76' x 19' x 13'	1,444	-	150	-	-	-	-	-	4
BALLROOM foyer C	136' x 19' x 13'	2,584	-	275	-	-	-	-	-	13
REGISTRATION / OFFICE	44' x 26' 6" x 8'	418	-	-	-	-	-	-	-	-

### SECOND FLOOR CONFERENCE CENTER

WABASH CANNONBALL	17' 6" x 34' x 15'	595	40	60	50	35	26	26	30	-
TEXAS SPECIAL	20' x 26' 6" x 15'	530	20	40	46	28	22	-	-	-
COLORADO EAGLE	20' x 26' 6" x 15'	530	20	40	46	28	22	-	-	-
JEFFERSONIAN	16' 6" x 21' 6" x 15'	355	20	40	36	21	16	-	16	-
KNICKERBOCKER	16' 6" x 24' x 15'	396	20	50	45	21	20	-	16	-
MIDNIGHT SPECIAL	18' 6" x 17' x 15'	315	-	-	-	-	12	12	18	-
ZEPHYR ROCKET	13' x 18' x 15'	234	-	-	-	-	12	-	-	-
DIXIE FLYER	13' x 19' 6" x 15'	254	-	-	-	-	10	-	-	-
METEOR	13' x 27' 6" x 15'	358	-	-	-	-	16	-	-	-
NEW YORK CENTRAL	33' 6" x 31' 9" x 15'	1,064	70	100	126	60	30	35	40	-
ILLINOIS CENTRAL	33' 6" x 38' 8" x 15'	1,298	90	120	153	72	30	35	40	-
MISSOURI PACIFIC	21' x 31' 11" x 15'	672	40	100	77	45	30	24	32	-
FRISCO	21' x 31' x 15'	651	50	100	77	45	30	24	32	-
BURLINGTON ROUTE	21' x 31' x 15'	651	50	100	77	45	30	24	32	-
JEFFERSONIAN / KNICKERBOCKER	16' 6" x 45' 6" x 15'	751	40	90	99	48	25	-	-	-
NEW YORK / ILLINOIS CENTRAL	33' 6" x 70' 6" x 15'	2,362	170	250	272	156	60	63	72	-
FRISCO / BURLINGTON	21' x 62' x 15'	1,302	100	200	154	85	54	40	60	-
GOthic CORRIDOR	79' x 16' 6" x 15' 6"	1,303	70	90	152	-	-	-	-	-
GRAND HALL	121' x 74' x 60'	8,954	400	600	-	-	-	-	-	-
GRAND HALL BALCONY	82' x 18' x 60'	1,476	50	50	-	-	-	-	-	-
LINK ROOM	26' x 17' x 16'	442	18	-	-	-	18	-	-	-
GRAND HALL MEETING ROOM I	33' x 18'	594	40	60	62	35	26	25	28	-
GRAND HALL MEETING ROOM II	33' x 18'	594	40	60	62	35	26	23	26	-
GRAND HALL MEETING ROOM III	33' x 18'	594	40	60	62	35	26	23	26	-