

TUDOR PARK, A MARRIOTT HOTEL & COUNTRY CLUB

Ashford Road, Bearsted, Maidstone, Kent ME14 4NQ

Phone 01622 734 334 Fax 01622 735 360

Tudor Park, A Marriott Hotel & Country Club is a welcoming retreat set in 220 acres of ancient deer park in Kent, the glorious Garden of England. Yet despite its relaxing and secluded atmosphere, it's only minutes from the M20 and an hour from London.

| Meeting Room | Natural Daylight | Air Conditioning | Wheelchair Access | Dimensions LxWxH (Metres) | Capacity | | | | | | | | | | | |
|----------------|------------------|------------------|-------------------|---------------------------|-------------------------------|---------------------------------|----------------------------------|-----------------|---------|-----------------|-------------------------------|---------------------------------|----------------------------------|------------------|--------------|--------|
| | | | | | Theatre Style (No Projection) | Theatre Style (Back Projection) | Theatre Style (Front Projection) | Boardroom Style | U-Shape | Classroom Style | Cabaret Style (No Projection) | Cabaret Style (Back Projection) | Cabaret Style (Front Projection) | Buffet Reception | Dinner/Dance | Dinner |
| Langley | ✓ | ✓ | ✓ | 8 x 4 x 3 | - | - | - | 16 | - | - | - | - | - | - | - | - |
| Stockbury | ✓ | ✓ | ✓ | 8 x 4 x 3 | - | - | - | 16 | - | - | - | - | - | - | - | - |
| Syndicate 1 | - | ✓ | ✓ | 5 x 4 x 3 | - | - | - | 8 | - | - | - | - | - | - | - | - |
| Syndicate 2 | - | ✓ | ✓ | 5 x 4 x 3 | - | - | - | 8 | - | - | - | - | - | - | - | - |
| Syndicate 3 | - | ✓ | ✓ | 5 x 4 x 3 | - | - | - | 8 | - | - | - | - | - | - | - | - |
| Syndicate 4 | - | ✓ | ✓ | 5 x 4 x 3 | - | - | - | 8 | - | - | - | - | - | - | - | - |
| Thurnham Suite | ✓ | ✓ | ✓ | 33 x 9 x 3 | 250 | 200 | 250 | 60 | 70 | 100 | 84 | 67 | 84 | 250 | 160 | 180 |
| Thurnham | ✓ | ✓ | ✓ | 11 x 9 x 3 | 80 | 64 | 80 | 30 | 30 | 40 | 35 | 28 | 35 | 60 | - | 60 |
| Lenham | ✓ | ✓ | ✓ | 11 x 9 x 3 | 80 | 64 | 80 | 30 | 30 | 40 | 35 | 28 | 35 | 60 | - | 60 |
| Charlotte | ✓ | ✓ | ✓ | 11 x 9 x 3 | 80 | 64 | 80 | 30 | 30 | 40 | 35 | 28 | 35 | 60 | - | 60 |
| Leeds | ✓ | ✓ | ✓ | 12 x 9 x 2 | 80 | 64 | 80 | 30 | 30 | 40 | 30 | 24 | 30 | 60 | 48 | 60 |
| Bearsted | ✓ | ✓ | ✓ | 12 x 9 x 2 | 80 | 64 | 80 | 30 | 30 | 40 | 40 | 24 | 30 | 70 | 48 | 60 |
| Marquee | ✓ | ✓ | ✓ | 12.50 x 10 x 4.47 | - | - | - | - | - | - | - | - | - | 120 | 80 | 108 |

ACCOMMODATION

120 bedrooms, all with ensuite bathroom, TV, free SKY channels, in room safe, hairdryer, direct-dial telephone, voice mail, wi-fi access, tea and coffee making facilities, mini-bar, trouser press and iron and ironing board.

RESTAURANTS & LOUNGES

Conical Grill, Zest Bar & Eatery and Mezzanine Bar. Wi-fi access available in the Mezzanine Bar.

Recreation & Leisure Complimentary: Indoor heated swimming pool, spa bath, sauna, steam room, aerobics studio, two gyms and tennis courts.

Supplementary: Health & Beauty Salon.

GOLF FACILITIES

Championship 18 hole golf course, practice range, putting green and a professional golf shop. Expert tuition available. Host venue of PGA Euro Pro Tour.

ATTRACTIONS

Located in the Garden of England with many historic castles nearby such as Leeds, Dover and Hever. Other local places of interest include Sissinghurst Gardens, Chartwell House, Kent Hop Farm and Bluewater Shopping Centre.

MEETING FACILITIES

7 conference rooms and 4 syndicate rooms accommodating up to 250 delegates.

DIRECTIONS

Leave the M20 at junction 8 and take the Lenham exit at the first roundabout. At the second roundabout take right-hand exit signposted Bearsted and Maidstone. Tudor Park can be found approximately 1.5 miles on the left. Gatwick Airport 45 miles. Free parking for 250 cars.

RESERVATIONS AND PAYMENT

Reservations are held for guest arrival until 4pm. You can guarantee your booking by simply advising us of your credit card number when you book. American Express, Diners Club, Mastercard and Visa are accepted, as are Connect debit cards. Cheques are also accepted when supported by a current cheque card issued by a major UK bank.

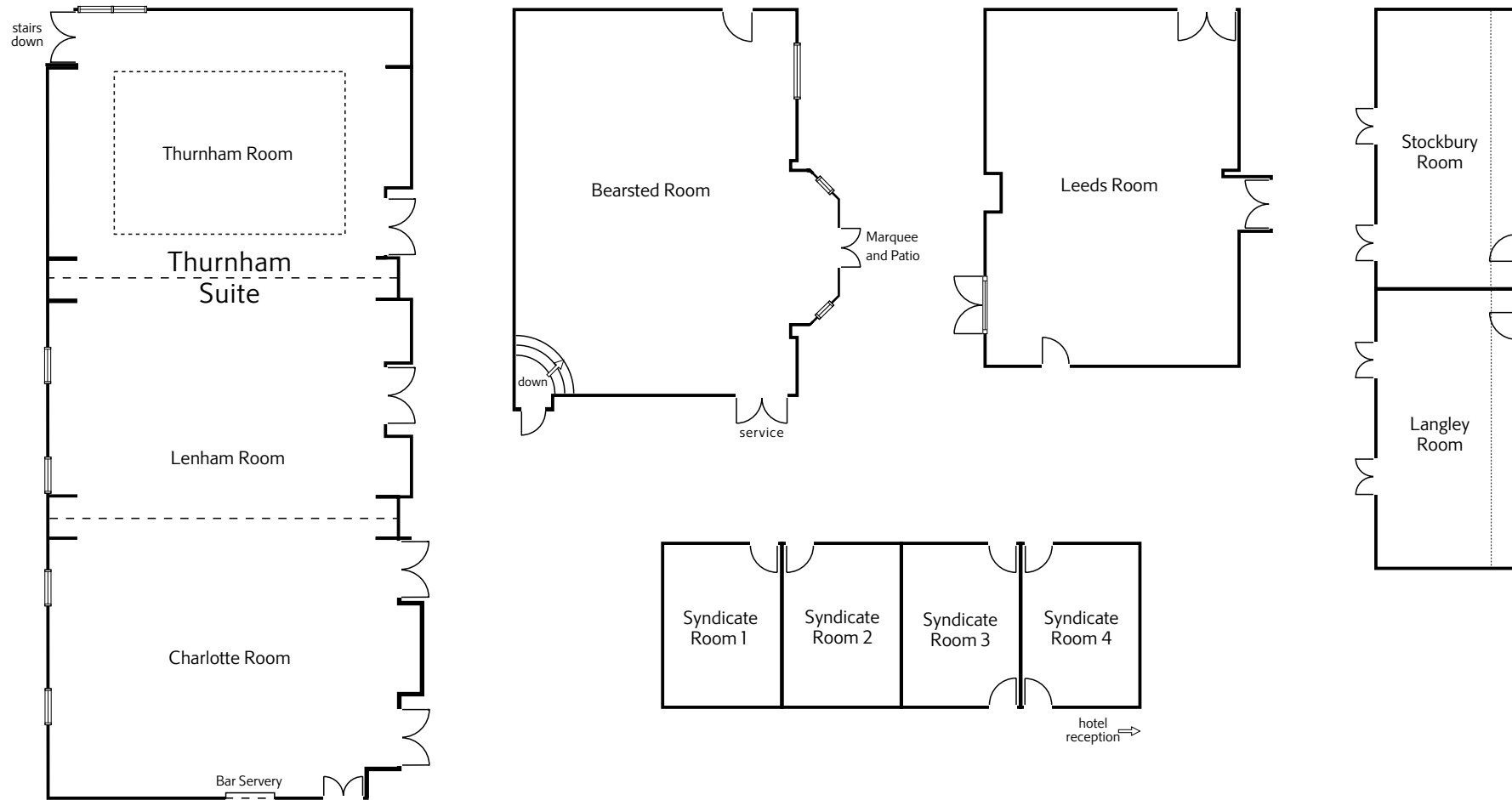

Scale: 1cm = 2 metres

Tudor Park, A Marriott Hotel & Country Club is a tranquil retreat nestled among the charming villages and historic castles of Kent. Set amid 220 acres of rolling countryside, and benefiting from a modernisation programme, you will feel relaxed from the moment you arrive. Under an hour from London and minutes to Kent International Airport, Ashford International Station, Gatwick Airport, and major rail and motorway links, you are at the heart of all that's important.

State of the art conference rooms, excellent leisure facilities – including championship golf, The Park Health and Beauty Salon – plus a superb choice of dining options makes Tudor Park, A Marriott Hotel & Country Club the natural choice for business and leisure travellers. Make your social occasion or special event a success at the most beautiful venue in Kent, the Garden of England.