

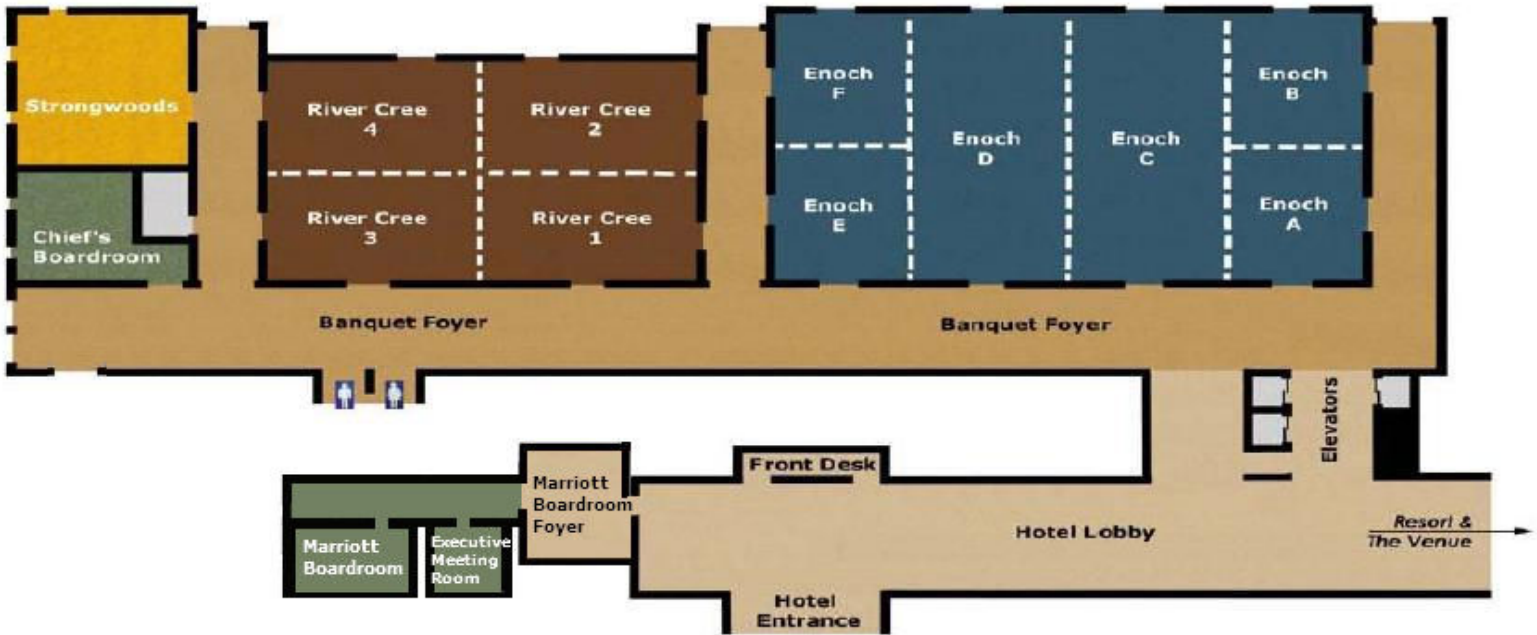

Marriott.
EDMONTON
AT RIVER CREE RESORT

Sales Department: 780-930-2622
Toll Free: 1-800-960-4913
www.edmontonmarriott.com



Meeting Room	Sq. Ft.	Dimensions H x W x L(ft)	TS	SR	H. Square	U-Shape	CO	R 6	R 8	R 10	R 12 w/ Dance	Reception
Enoch Grand Ballroom	7296	13x64x114	800	404	-	-	-	300	400	500	400	800
Enoch A	864	13x32 x27	85	35	25	30	25	36	48	60	48	90
Enoch B	864	13x32 x27	85	35	25	30	25	36	48	60	48	90
Enoch C	1920	13x64x30	200	95	50	55	52	90	120	150	132	200
Enoch D	1920	13x64x30	200	95	50	55	52	90	120	150	132	200
Enoch E	864	13x32x27	85	35	25	30	25	36	48	60	48	90
Enoch F	864	13x32x27	85	35	25	30	25	36	48	60	48	90
Enoch AB	1728	13x64x27	190	85	50	60	50	72	96	120	84	180
Enoch ABC	3648	13x64x57	350	180	90	105	-	246	328	260	200	400
Enoch ABCD	5568	13x64x87	578	275	-	-	-	-	-	410	320	640
River Cree Ballroom	4368	13x52x84	450	218	-	-	-	216	288	360	290	485
River Cree 1	1092	13x26x42	110	45	30	35	35	48	64	80	48	100
River Cree 2	1092	13x26x42	100	45	30	35	30	48	64	80	48	100
River Cree 3	1092	13x26x42	100	45	30	35	35	48	64	80	48	100
River Cree 4	1092	13x26x42	100	45	30	35	30	48	64	80	48	100
Strongwoods	1188	9x36x33	110	50	36	45	35	54	72	90	72	100
Chief's Boardroom	621	9x27x23	-	-	-	-	12	-	-	-	-	-
Marriott Boardroom	300	9x13x23	-	-	-	-	12	-	-	-	-	-
Executive Meeting Room	127	9x10x12	-	-	-	-	-	6	-	-	-	-
The Venue (with stage)	21850	Hx115x190	1600	1100	-	-	-	-	-	1000	-	2800

TS – Theatre Style (Chairs only), SR – Schoolroom Style (2' per person), CO – Conference/Boardroom, R – Round Tables
**Please note that Audio Visual set up will affect room capacity.