

Floorplans Meeting Space



Marriott

VANCOUVER PINNACLE DOWNTOWN

1128 West Hastings Street
Vancouver, British Columbia, Canada - V6E 4R5

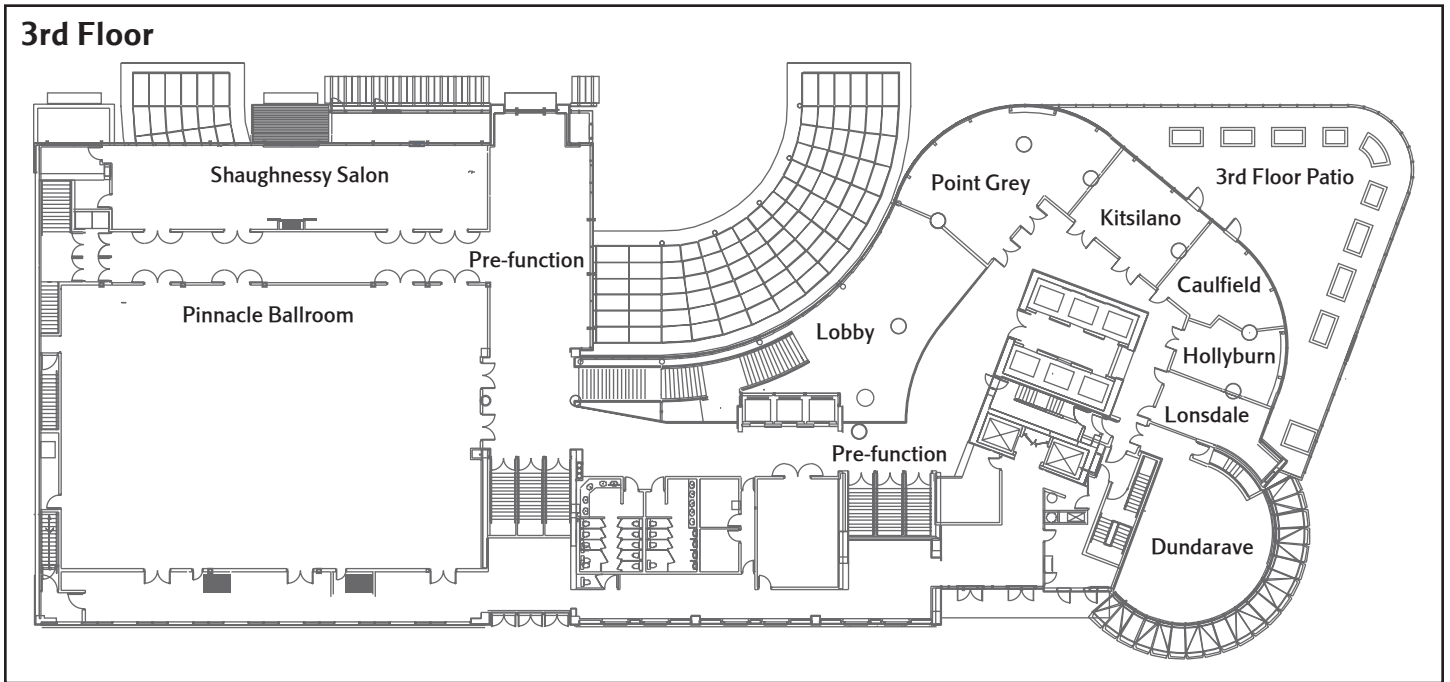
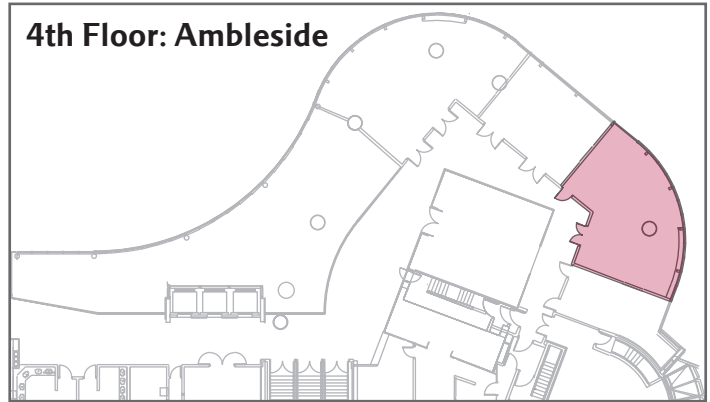

	Dimensions	Sqft	Theatre	Class	Hollow	U-shp	Board	1/2 Rnds of 6	Rnds of 8	Rnds of 10	Reception
Pinnacle Ballroom	99'3" x 66'8"	6632	600	324	108	90	72	252	336	450	600
Pinnacle I	32' x 66'8"	2154	176	120	52	46	44	84	112	140	200
Pinnacle II	33'7" x 66'8"	2236	176	120	52	46	44	84	112	150	200
Pinnacle III	33'1" x 66'8"	2203	176	120	52	46	44	84	112	150	200
Pre-function		1840	-	-	-	-	-	-	-	-	-
Shaughnessy Salon	89'2" x 19'9"	1741	170	96	50	46	52	60	80	100	150
Shaughnessy I	46'5" x 19'9"	904	80	48	28	28	28	30	40	40	80
Shaughnessy II	42'5" x 19'9"	837	70	42	24	22	24	30	40	40	60
Pre-function		1074	-	-	-	-	-	-	-	-	-
Point Grey	27'10" x 27'1"	823	60	30	20	18	22	30	40	50	75
Kitsilano	20'5" x 26'6"	530	30	18	14	12	14	24	32	30	30
Caulfield	20'5" x 25'8"	427	24	15	-	-	12	12	16	20	20
Hollyburn	13'6" x 24'7"	333	16	-	-	-	12	12	16	10	16
Lonsdale	12'6" x 25'9"	357	-	-	-	-	14	-	-	-	-
Dunderave	32' x 35'2"	1002	60	33	-	16	20	30	40	40	60
Ambleside	34'6" x 49'11"	1238	65	36	24	26	24	36	48	50	100
3rd Floor Patio		1400	-	-	-	-	-	36	48	60	100
5th Floor Patio		2400	-	-	-	-	-	78	104	120	200

MEETING ROOM DESCRIPTIONS



PINNACLE BALLROOM

The Pinnacle Ballroom is the largest of the 12 meeting rooms and it is situated on the 3rd floor of the hotel. This unobstructed function space has 16 foot ceilings, contemporary dome shaped chandeliers and a soothing light wall texture with floral designs. This multi-functional space can be separated into 3 sections or maximized to accommodate a stand up reception of 600 people or for a sit down extravagant theme dinner up to 450. The Pinnacle Foyer outside of this room is ideal for wedding receptions, registration or buffet set ups.



SHAUGHNESSY SALON

The Shaughnessy Salon is adjacent to our large ballroom and is the second largest of the 12 meeting rooms, situated on the 3rd floor of the hotel. With 25 foot ceilings and floor to ceiling windows, adding plenty of natural lighting, this room is ideal for indoor wedding ceremonies, intimate stand up receptions and breakout rooms for conferences.



POINT GREY ROOM

The Point Grey room has 25 foot ceilings and floor to ceiling curved windows that provide warmth and natural lighting. It is ideal for an intimate sit down dinner up to 50 people, stand up reception for 75 or a breakout room for conferences. For presentation purposes, 1 pillar in the room should be taken into consideration.



KITSILANO ROOM

The Kitsilano room is great for small meetings, dinner parties or a breakout room. This room has natural light, high ceilings and access to our outdoor patio which is a great area for coffee breaks.



CAULFEILD ROOM

The Caulfeild room is great for small meetings, presentations, dinner parties or a breakout room. This room has natural light, high ceilings and access to our outdoor patio which is a great area for coffee breaks.



HOLLYBURN ROOM

The Hollyburn room is great for small meetings, presentations, dinner parties or a breakout room. This room has natural light, high ceilings and access to our outdoor patio which is a great area for coffee breaks.



LONSDALE ROOM

The Lonsdale room is known as the 'Executive Meeting Room' designed with a permanent boardroom table for a maximum of 14 people and is set with black leather Executive boardroom chairs. High ceilings and natural light make this room an excellent place to conduct a small board meeting or have an executive presentation.



DUNDARAVE ROOM

The Dundarave room has floor to ceiling curved windows that provide warmth and natural lighting. It is ideal for intimate sit down dinners up to 50 people, stand up receptions for 60 or a breakout rooms for conferences. For presentation purposes, 2 pillars in the room should be taken into consideration.



AMBLESIDE ROOM

The Ambleside room is situated on the 4th floor of the hotel. This room has floor to ceiling curved windows that provide warmth and natural lighting. It is ideal for an intimate sit down dinner up to 70 people, stand up reception for 100 or a breakout room for conferences. For presentation purposes, 2 pillars in the room should be taken into consideration.



PATIO

The 3rd floor patio is a perfect location to host an outdoor lunch or early evening cocktail reception. The patio overlooks the corner of West Hastings and Thurlow Street with views of beautiful Coal Harbour. A gorgeous roof top garden and flower baskets line the patio adding to this wonderful outdoor space. Please note that we are required to book a back up room for events held on the patio should the weather not permit holding the event outside.



PRE-FUNCTION

The Pre-Function area runs around the perimeter of the meeting rooms on the 3rd Floor and sits above the main lobby of the hotel. It serves as a versatile area that can be used for registration tables, buffet setups, and for wedding or cocktail receptions. The Pre-Function area is well lit with plenty of warm natural lighting through the amazing 60 foot floor to ceiling windows of the hotel's main lobby and 25 foot floor to ceiling windows of the Pinnacle Ballroom Foyer.