

A close-up photograph of a hand with light pink manicured nails reaching towards a plate of cherry tomatoes and fresh herbs. The plate is white with a gold rim. In the background, a red gift box wrapped in pink ribbon is visible on a light-colored, patterned tablecloth. The overall scene is festive and elegant.

# WINTER WONDERS AWAIT AT RENAISSANCE BRUSSELS

---

**WINTER SEASON BROCHURE**



# THE MAGIC OF WINTER AT RENAISSANCE BRUSSELS

At Renaissance Brussels, we believe that winter is more than just a season; it is a time of magical moments that warm the soul.

Nestled in the heart of Brussels, our venue offers a unique fusion of seasonal charm and unique event services, providing the perfect backdrop for your winter occasions and team outings.

Whether you're planning an intimate celebration, a festive corporate event, or a bigger event, our team is dedicated to creating experiences that are as unforgettable as the season itself.

Let us help you craft a winter experience that will leave a lasting impression. The beauty of the season begins here, and we are excited to share in these special moments with you.







## TEAM OUTINGS



Winter Season Brochure

## DINING OPTIONS



## HOTEL INFORMATION



# TEAM OUTING COCKTAIL WORKSHOPS

Step into the world of mixology and literature with a poetry inspired Cocktail Workshop! Ideal for team events, celebrations or a unique evening with friends, you can **customize the experience** by **selecting your preferred poet** and enjoy a bespoke mixology session with a literary twist.

## PACKAGE DETAILS

- 1 Welcome Drink
- Amuse-bouche
- Mix 2 Cocktails
- Private Room rental
- Duration: 2 hours

FROM 10 TO 25 GUESTS

€90,- PER PERSON





## VIRGINIE T. CHAMPAGNE MASTERCLASS

Sparkle your event with a **tailored champagne experience** at The Poet. In **collaboration with Virginie T. Champagne**, our Chef Jérôme Ragon offers a selection of tapas perfectly paired with the champagne.

Let the bubbles take over your celebration.

### PACKAGE DETAILS

- Tasting of 4 Champagne
- Explanations during masterclass
- Amuse-bouche
- Private Room rental
- Duration: 1h30

**FROM 8 TO 12 GUESTS**

**€106,- PER PERSON**



# SHARING MENU

€65,00 PER PERSON

MINIMUM 20 GUESTS

## TO BEGIN

- Salmon gravlax, lime cream & rye bread
- Our grey shrimp croquette & wasabi dip
- Curried roasted butternut, quinoa & herb salad \*

## TO CONTINUE

- Corn-fed chicken, portobello, foie gras jus
- Cod fish, romanesco cauliflower, passion fruit beurre blanc, black lemon
- Tartufata and wild mushroom potato gratin \*
- Gourmet roasted winter root vegetable and chestnut \*

## TO END

- Chocolate & hazelnut
- Creamy caramel & hazelnut, mandarin ice cream, crispy hazelnut

AVAILABLE FROM END OF NOVEMBER UNTIL END OF JANUARY

*The menu is specially crafted to be shared, in 3 different servings.*

(\*) Vegetarian





## BUFFET MENU

€105,00 PER PERSON

MINIMUM 50 GUESTS

### ASSORTIMENT OF STARTERS

- Oyster Bar "Fine de Zélande"
- Beef Carpaccio / Truffle / parmesan / peppery rucola
- Prosciutto ham / Onion jam
- Foie gras / Fig chutney / spiced crumble
- Grapefruit cured salmon gravlax / horseradish / toast
- Quinoa / beetroots / goat cheese / nuts \*
- Romain Salad / shrimps / avocado / chili
- Honey- Roasted Pumpkin / coriander / feta / pistachio \*

### ASSORTIMENT OF MAIN COURSES

- Cod fish / leek / mussels / champagne
- Roasted Winter roots \*
- Stew / hippocras / chocolate / parsnip / cranberries
- Truffle / wild mushroom / potato gratin \*
- Pumpkin risotto / blue cheese / hazelnut \*
- Quinoa / beetroots / goat cheese / nuts \*

### ASSORTIMENT OF DESSERTS

- Chocolate feuillantine
- Profiteroles
- Macarons
- Tropézienne mini mousseline
- Royal truffle
- Speculoos croustillant

*The menu includes a glass of Prosecco.*

(\*) Vegetarian





## GROUP DINING AT THE POET

### EVERY SIP A STORY

Soak into the lively atmosphere at The Poet over local food paired with our high-end selection of cocktails. Share your story with city neighbors over a meal or kick back at the bar amidst our theatrical design, matching the colorful neighborhoods of the city.

At The Poet, every plate is a canvas, and every cocktail a poem, crafted with the same fervor that Brussels' residences pour into its streets. We bring the spirit of the city right to your table, with a menu that's as diverse and dynamic as the capital itself. Join us, where the essence of Brussels is not just served, but celebrated.

### NEVER A DOLL MOMENT AT THE POET

In the evenings, The Poet transforms into an any-occasion destination, fueled by signature crafted cocktails, live music, and cultural events. City poets gather here, creating unforgettable moments. From unique painting and handcrafting workshops to poetry-inspired cocktail workshops, guests can immerse themselves in the vibrant energy of the city and craft their own stories.





[VISIT THE POET WEBSITE](#)





# ABOUT RENAISSANCE BRUSSELS

## HOTEL FACTS

-  262 bedrooms (24 suites)
-  9 Meeting venues (daylight)
-  The Poet Restaurant
-  Indoor swimming pool & fitness
-  190 underground parking spots



## ABOUT RENAISSANCE® HOTELS

At Renaissance Hotels we believe you should get everything you expect from business travel, in a slightly less expected way. It's why, at each of our 160 hotels worldwide, you'll find something unconventional to help you discover genuine local experiences. The kind that doesn't just create stories, but feeds the curiosity of guests who see business as only a part of their trip.

Renaissance Hotels is a member of the Marriott Bonvoy loyalty program.

## ABOUT THE LOCATION

Our hotel is located in the heart of the European Quarter, just steps from the European Parliament and the iconic Place du Luxembourg. We're also within walking distance of the vibrant Ixelles (Elsene) neighborhood, known for its lively atmosphere and attractions.

-  20 mins drive from Brussels National Airport
-  2 mins walk from Brussels Luxembourg station

## OUR MEETING FACILITIES

Our nine versatile meeting spaces are bathed in natural light, providing a bright and welcoming atmosphere for your guests. Whether you're hosting a conference, workshop, or gala dinner, our experienced team will work with you every step of the way to ensure a flawless and unforgettable event.

The biggest meeting space can accommodate up to 300 guests in theatre style. Ask your contact for more seating options.

BACK TO  
OVERVIEW

	AREA	M²	F²	MEETING CAPACITY						
	L x W x H			THEATER	SCHOOL	CABARET	U-SHAPE	COCKTAIL	BANQUET	
The Club	14.5x6.80	98.60								
The Studio										
Brussels Ballroom 1/2	18x8x3.8	144		130		56		180		
Brussels Ballroom 1+2	18x16x3.8									
Luxembourg	8x6x3.2									
The Hague	7x6x3.2									
Luxembourg + The Hague	15x6x3.2									
Copenhagen	8x4x2.8									
Essen	7x 4x2.8									
Warsaw	8x4.5x2.8			25	14	6	14	20	20	
Copenhagen + Essen + Warsaw				100	56	35	32	80		
Lisbon	12x13x2.8	156	1679.17	70	50	30	30	80	50	-
Lisbon + Madrid	24x26x2.8	624	6716.67	140	100	60	60	160	100	RENAISSANCE



[BACK TO  
OVERVIEW](#)

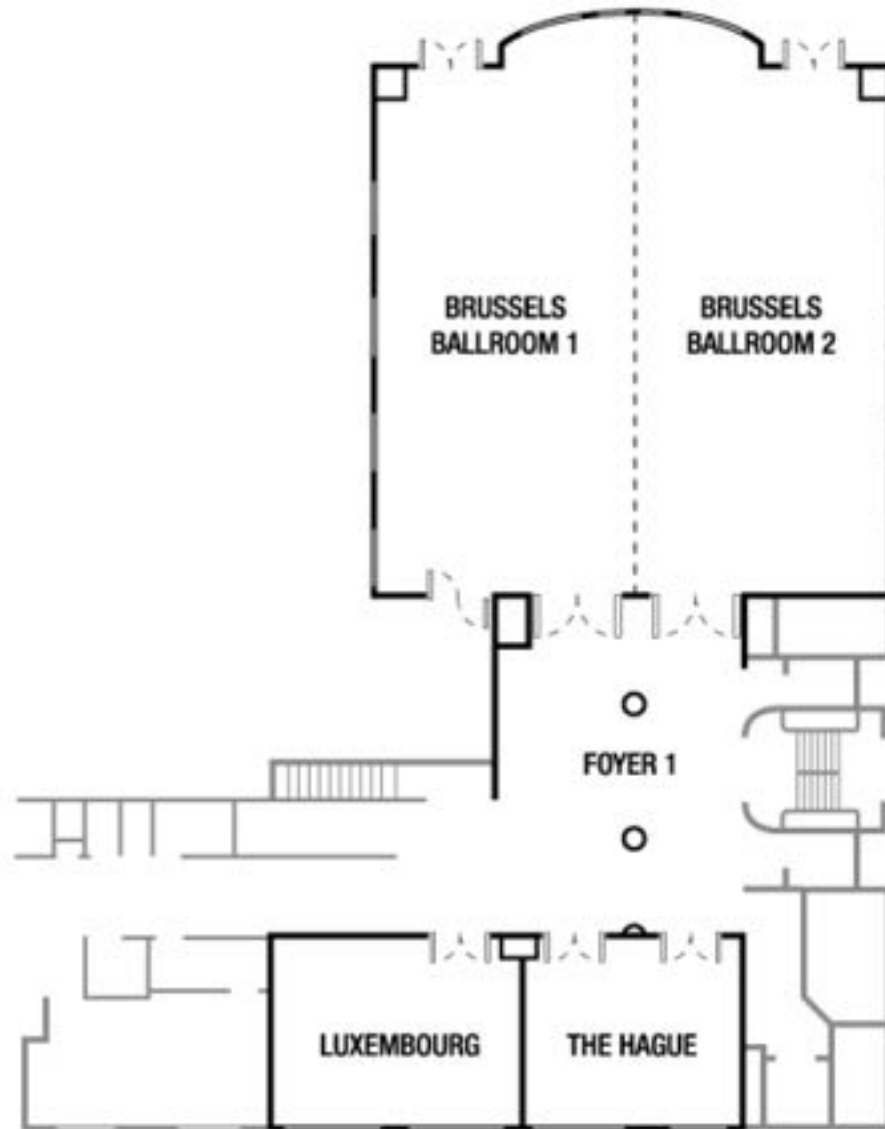



R  
RENAISSANCE®  
BRUSSELS HOTEL

LET US CRAFT  
YOUR WINTER  
WONDERS AT  
RENAISSANCE!

## CONTACT US

Contact our events team for more  
information and reservations:

Event Booking Center  
[brussels.salesoffice@marriott.com](mailto:brussels.salesoffice@marriott.com)  
T: +32 2 505 2000

Renaissance Brussels Hotel  
19 Rue de Parnasse, 1050 Bruxelles  
+32 (0) 02 505 29 29