



COURTYARD[®]

BY MARRIOTT

COURTYARD SANTA BARBARA DOWNTOWN

1601 State Street, Santa Barbara, California 93101
805.975.0660

Marriott.com/SBACS SaintRemySB.com

GDS CODES: Amadeus: SBACSC | Apollo/Galileo: 78454
Sabre: 135243 | Worldspan: SBACS

Santa Barbara's newest Marriott hotel places you in the heart of everything the "American Riviera" has to offer. From Mediterranean coastal cuisine at Saint Remy to a lush outdoor pool and sundeck, the Courtyard Downtown is ideal for your uniquely Santa Barbara business or leisure getaway.

HOTEL FEATURES

- Saint Remy restaurant offers Mediterranean inspired vibrant, ingredient driven coastal fare featuring the freshest locally-sourced ingredients
- Accommodating sun deck, pool, whirlpool and firepits
- Lobby experience that offers engaging technology and inviting, flexible spaces to work and relax
- Rooftop deck with sweeping views of the Pacific and Santa Ynez Mountains
- Al fresco and indoor dining at Saint Remy
- Secure gated underground parking
- State-of-the-Art Fitness Center

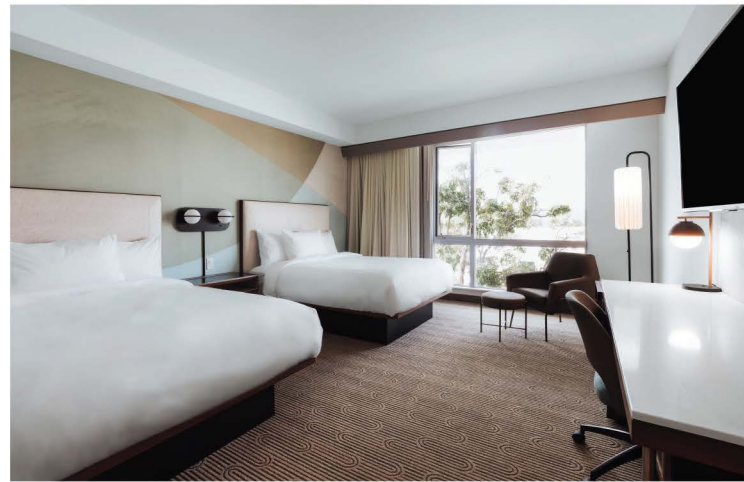

GUEST ROOM FEATURES

- Spacious room combines comfort and functionality, with mini-fridge, coffeemakers, high-speed Internet access and flat screen TV
- Balconies with views of the Santa Ynez Mountain and Pacific (select rooms)
- Well appointed two-room suites with wet bar and conference table
- Direct access guest rooms overlooking pool and sundeck (select rooms)
- Spacious guest baths featuring walk in shower and large vanity
- Large desk with conveniently placed lighting and outlets, with an ergonomic chair for comfort

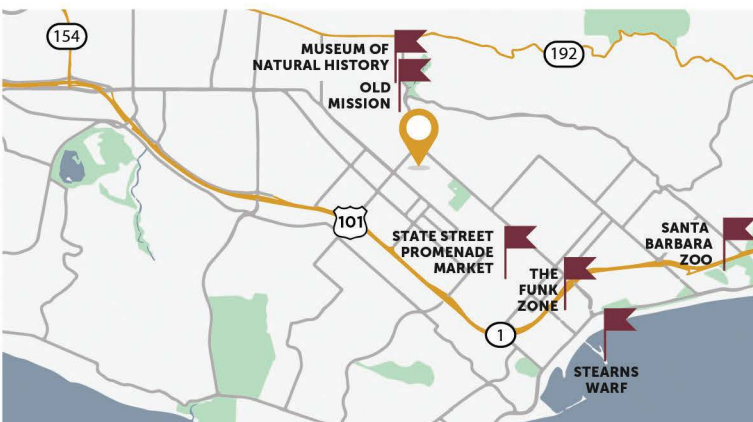

LOCAL AREA

- Santa Barbara Downtown: walk to dozens of shops, theater, music, museums, tasting rooms and local attractions. Beaches 10 minutes away!
- Rose Garden Park - 1 mi
- Old Mission - 1.1 mi
- State Street Promenade Market - 1.1 mi
- Museum of Natural History - 1.4 mi
- Amtrak Train Station - 2.2 mi
- Santa Barbara Harbor - 2.4 mi
- The Funk Zone - 2.6 mi
- Sterns Wharf - 3.1 mi
- Santa Barbara Zoo - 3.8 mi
- Santa Barbara Airport (SBA) - 8.8 mi
- University of California Santa Barbara - 9 mi

Operated by Azul Hospitality Group under license from Marriott International, Inc. or one of its affiliates.



EVENT SPACE CAPACITY CHART

EVENT SPACE	DIMENSIONS (LxWxH)	SQ. FT.	BANQUET	RECEPTION	THEATER	CLASSROOM	U-SHAPE	CONFERENCE
Pacific Deck	-	750	-	40	-	-	-	-
Chapala Room	30' x 30' x 9	455	30	30	31	30	10	15
Palm Court	30' x 30'	575	40	40	-	-	-	-
Mission Terrace	-	733	-	49	-	-	-	-
Saint Remy Restaurant	-	1,428	75	98	-	-	-	-
Pool Deck	66' x 56'	3,097	-	125	-	-	-	-

EVENT SPACE

- Mission Terrace featuring mountain views and flexible seating and tabletop options
- Casual meeting space, complimentary standard WiFi and Saint Remy combine to provide a broad experience for guests
- Refreshing, healthy, locally sourced event menus exactly right for you
- Restrooms and parking easily accessible from meeting space

GROUND FLOOR

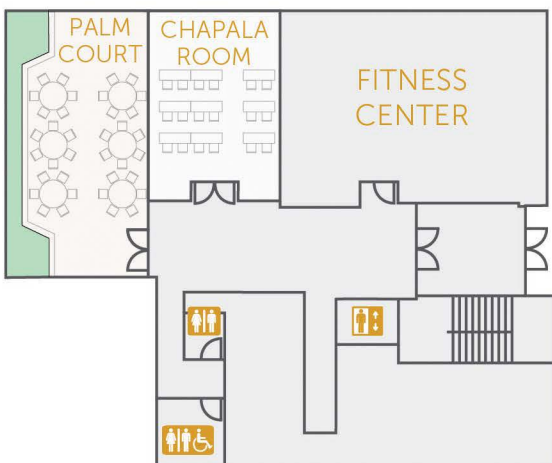

MISSION TERRACE

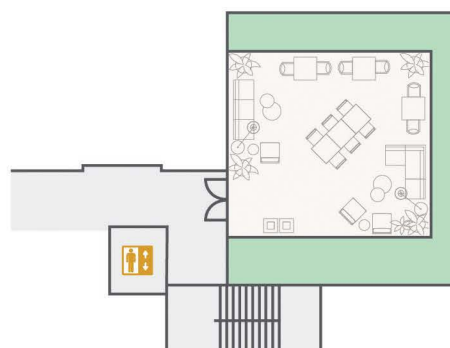

PACIFIC DECK

