

Conference Floor

The conference floor offers a range of spaces suited to a wide range of events.

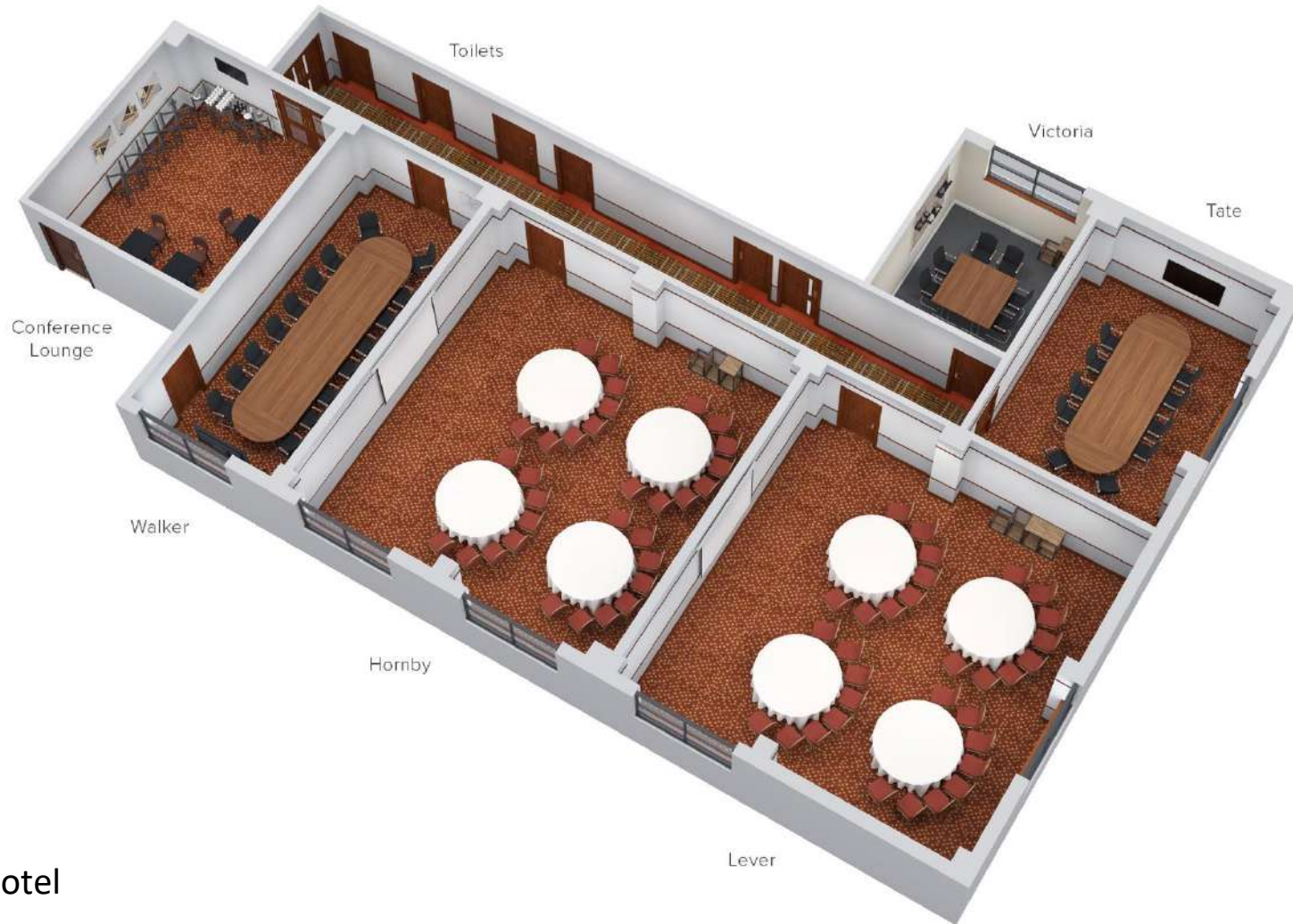

Liverpool Marriott Hotel
One Queen Square
Liverpool
L1 1RH
0151 476 8000

The 1st floor includes Olivier's Restaurant & Bar and the Merchant Suite.

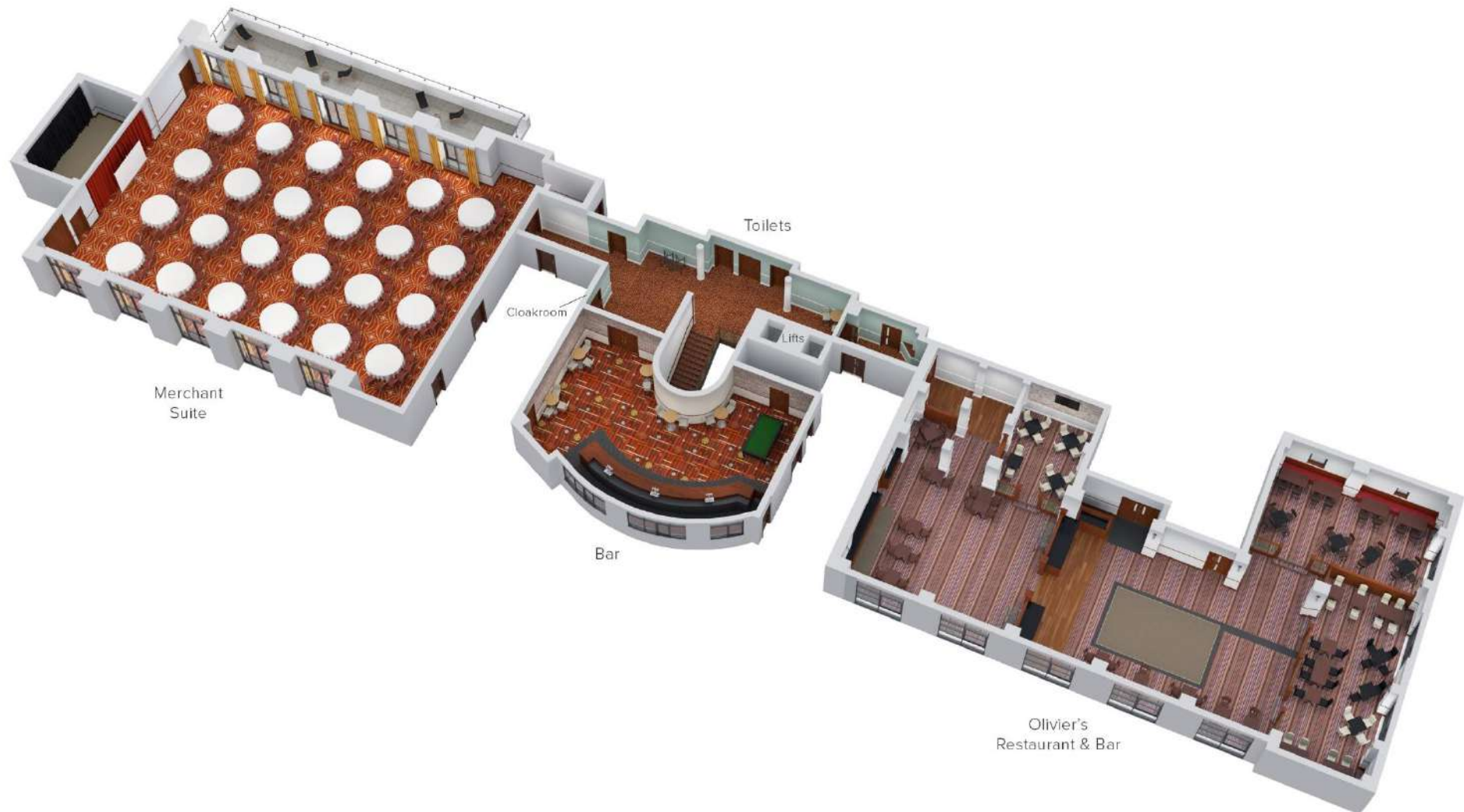

Conference Lounge

REFRESHMENTS

The conference lounge offers a pre-function space to serve tea/coffee and refreshments for meetings across the rest of the conference floor



The Hornby Room is one of the larger spaces on the conference floor together with the Lever Room. It benefits from extensive natural light

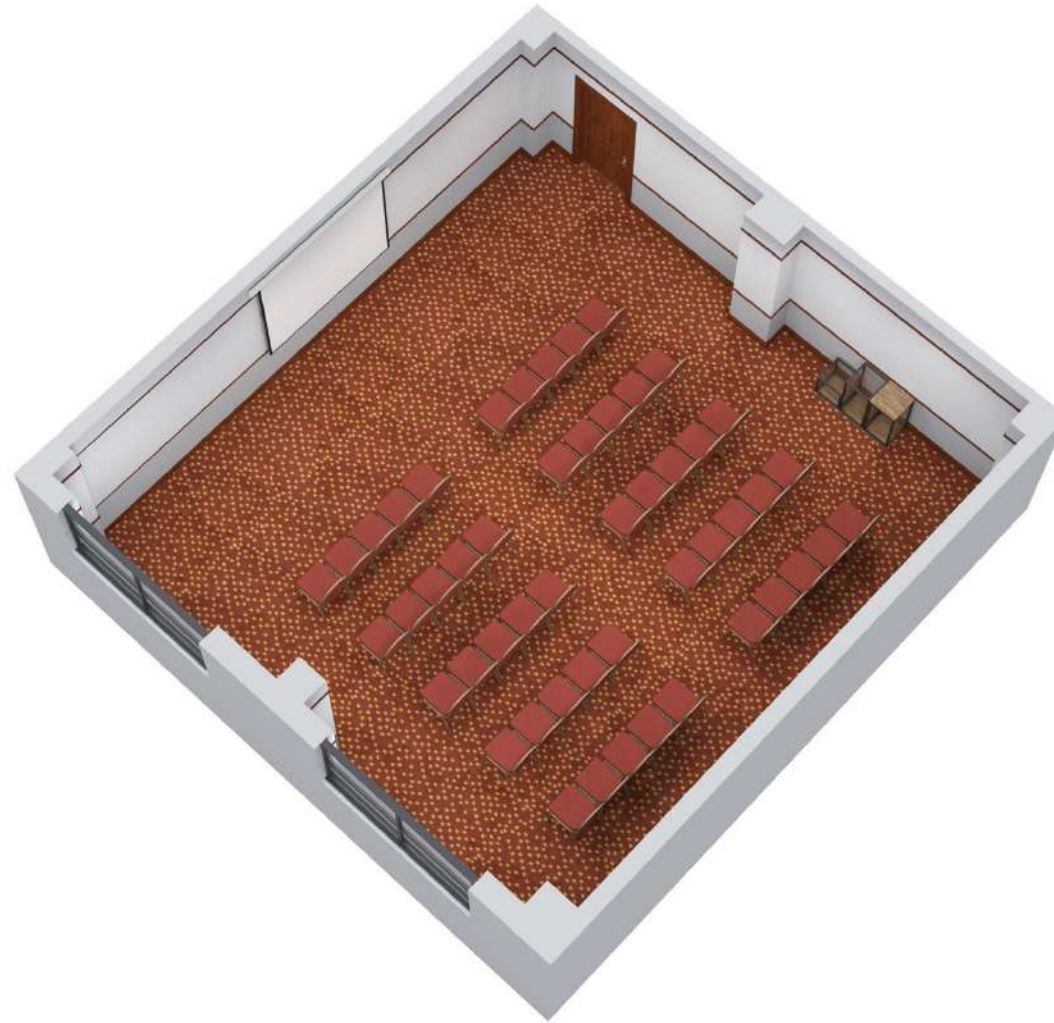

DIMENSIONS



50
THEATRE



32
CABARET



24
CLASSROOM



40
DINNER



24
USHAPE

The Lever Room is one of the larger spaces on the conference floor together with the Hornby Room. It benefits from extensive natural light



DIMENSIONS



50
THEATRE



32
CABARET



24
CLASSROOM



40
DINNER



24
USHAPE

Merchant Suite THEATRE

The Merchant Suite offers a range of configurations with multiple partitions. It benefits from extensive natural light and a private outdoor terrace

Merchant 1 - Capacity - 60
Merchant 2 - Capacity - 60
Merchant 3 - Capacity - 60

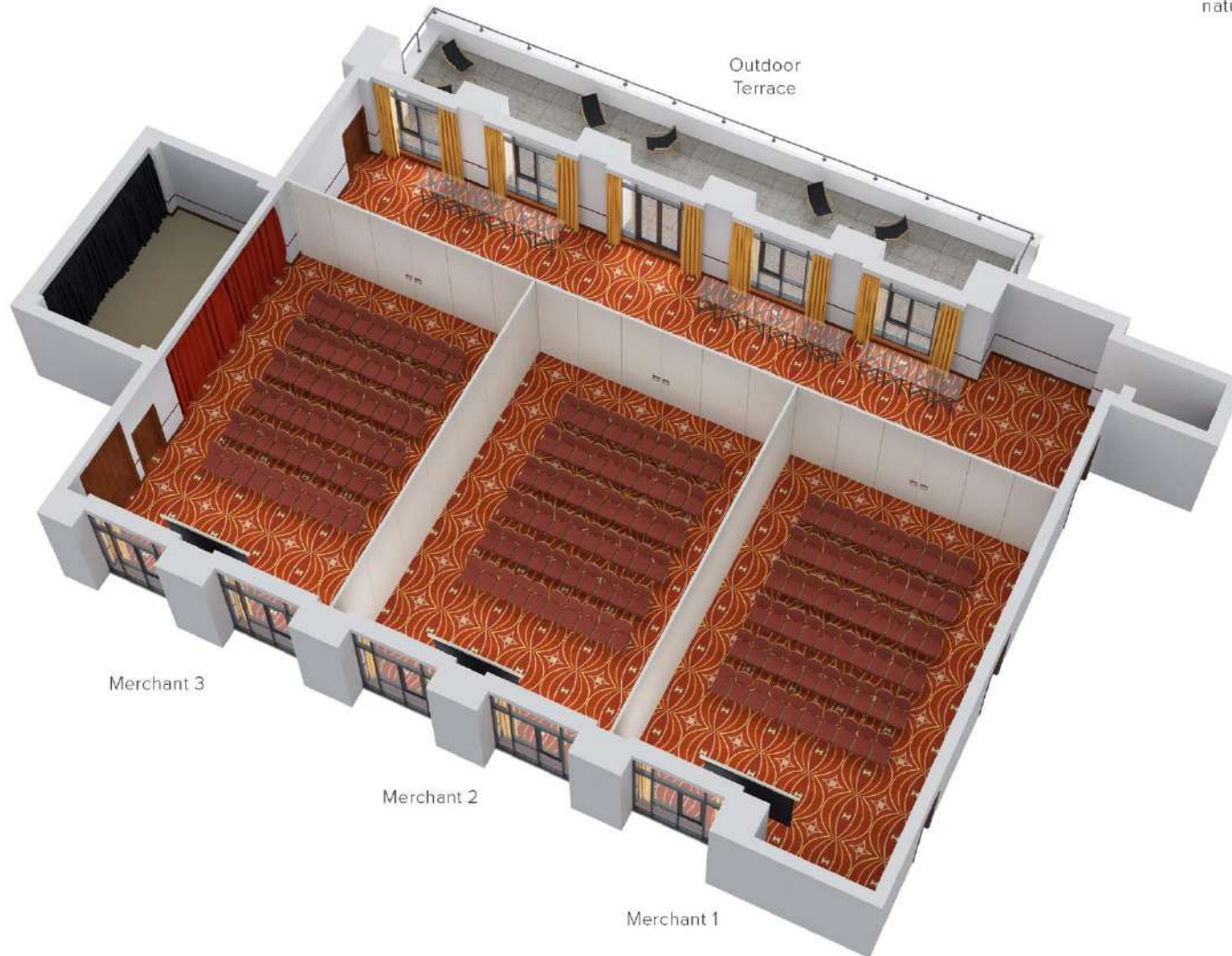

DIMENSIONS



60
THEATRE



40
CABARET



30
CLASSROOM



60
DINNER



30
USHAPE

The Merchant Suite offers a range of configurations with multiple partitions. It benefits from extensive natural light and a private outdoor terrace

Merchant 1 - Example Exhibition Setup

Merchant 2&3 - Theatre Setup

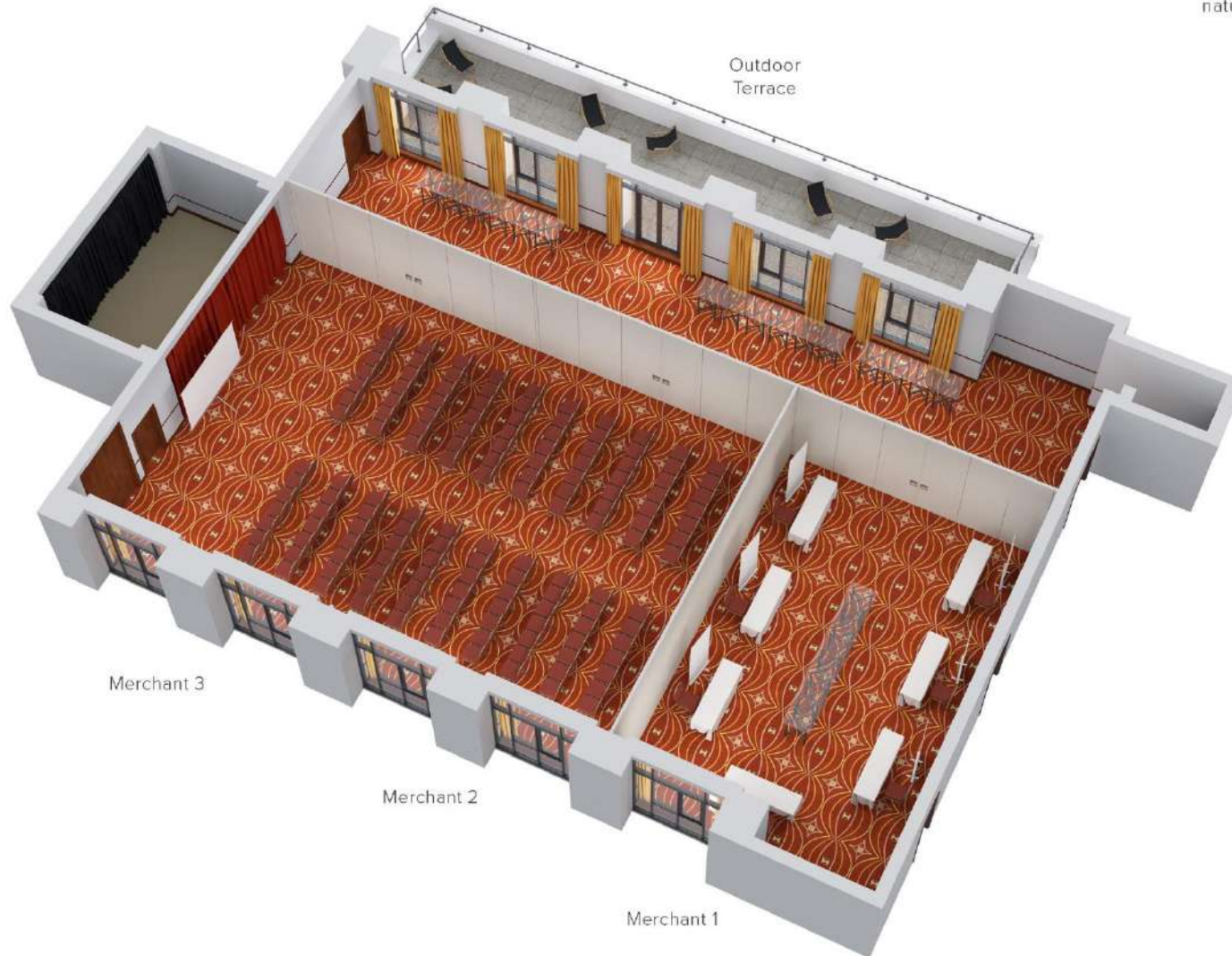

DIMENSIONS



140
THEATRE



80
CABARET



72
CLASSROOM



120
DINNER



40
USHAPE

Merchant Suite THEATRE

The Merchant Suite offers a range of configurations with multiple partitions. It benefits from extensive natural light and a private outdoor terrace

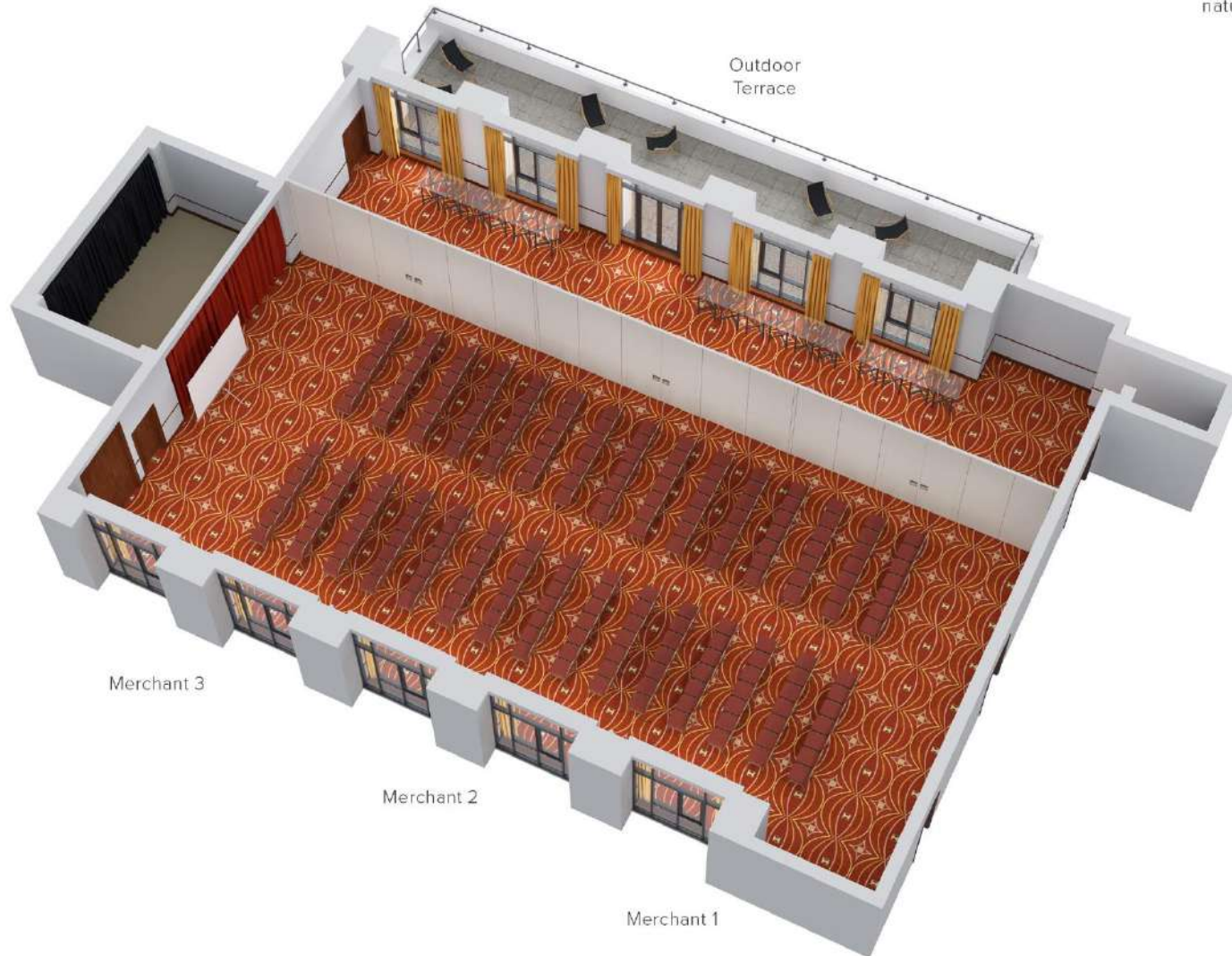

DIMENSIONS



210
THEATRE



144
CABARET



108
CLASSROOM



140
DINNER DANCE



180
DINNER

The Tate Room is the ideal space for a boardroom meeting upto 10 people. It benefits from extensive natural light

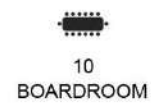
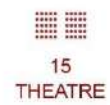
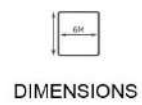

Walker Room THEATRE

The Walker Room is the ideal space for a boardroom meeting upto 16 people. It benefits from extensive natural light

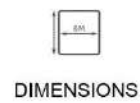
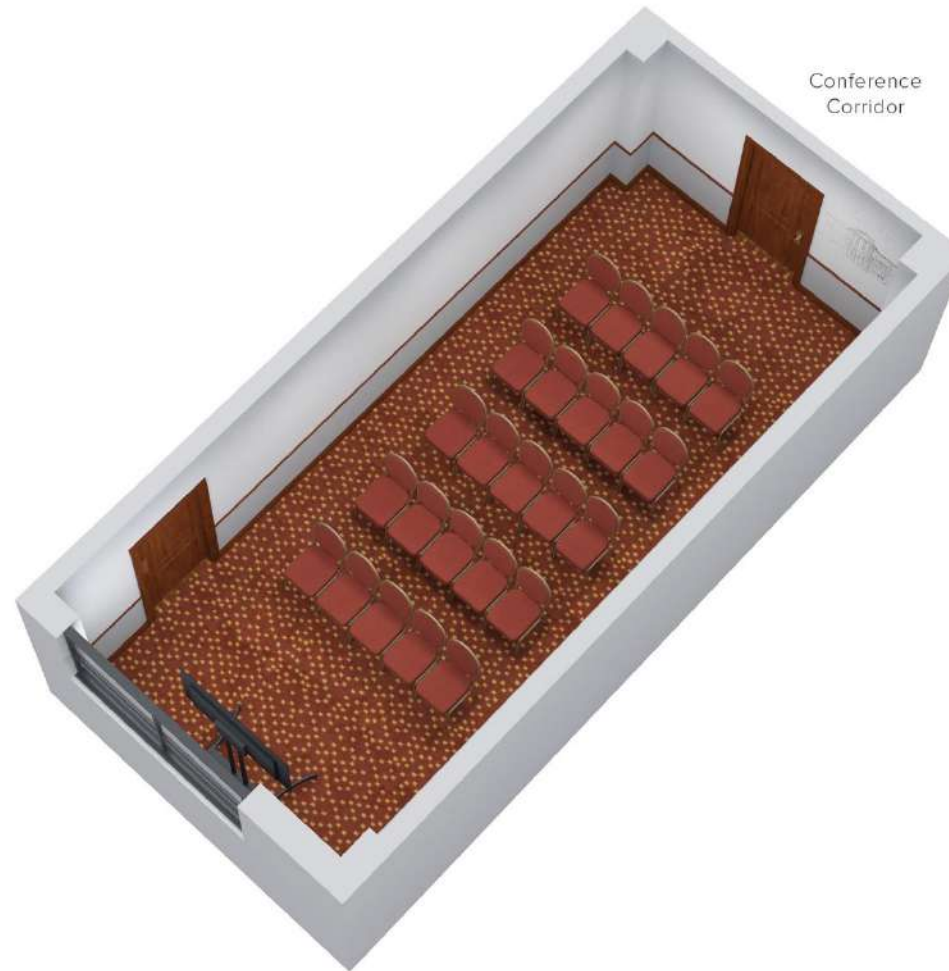

Victoria Room

BOARDROOM

The Victoria Room is one of our smaller spaces,
ideal for a boardroom or informal meeting.
It benefits from extensive natural light

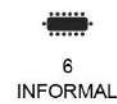
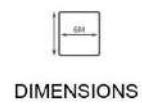

Olivier's Restaurant & Bar

LUNCH

Olivier's Restaurant & Bar offers a flexible space for a variety of events. It benefits from its own bar and extensive natural light



DIMENSIONS



LUNCH



WEDDING
BREAKFAST



WEDDING
RECEPTION



CHRISTMAS



EXHIBITION