



# Maximize Your Impact at The Westin Richmond

## IMPACT

At The Westin Richmond, we know that feeling good flows naturally from a relaxing and comfortable environment. Careful attention is paid to the most important elements of your stay to ensure each visit leaves you exceptionally well rested, well nourished and well cared for. When you enter The Westin Richmond, you will immediately notice how good it feels to be here.

## CONNECT

The Westin Richmond features over 17,000 square feet of sophisticated and versatile event space, thoughtfully designed to accommodate a range of meetings and social gatherings. From elegant ballrooms and flexible meeting rooms to a well-appointed executive boardroom, each venue is tailored to elevate every occasion. An enclosed courtyard adjacent to the indoor spaces provides a distinctive setting for outdoor events. Complementing the experience, our exceptional culinary team delivers inspired cuisine—whether for an intimate dinner or a grand celebration.

## REVITALIZE

The WestinWORKOUT fitness center is open 24 hours a day, offering weight machines and free weights, a heated indoor pool, and cardiovascular equipment facing personal flat-screen televisions.

## RECHARGE

Unwind in our spacious, light-filled guestrooms and suites. Each of our 250 accommodation spaces features our Heavenly® Bed and Heavenly® Bath, high-speed Internet access, refreshment center, work desk with ergonomic chair and other essential amenities for a fulfilling stay. Our spacious guestrooms and suites are welcoming, light-filled spaces.

Traditional King	380-418 sq ft
Traditional QQ/DD	380-418 sq ft
Club King	380-418 sq ft
Club QQ/DD	380-418 sq ft
King Suite	760 sq ft
Hospitality Suite	760 sq ft
WestinWORKOUT® Room	380-418 sq ft
<b>250 Total Rooms</b>	

## REFRESH

At The Westin Richmond, we believe that feeling good starts with getting the nourishment that is right for you. That is why we aim to provide nutritious options that contribute to your overall well-being. We ensure that dishes are sourced responsibly, crafted flexibly and created thoughtfully to accommodate individual dietary needs and preferences without compromising flavor, taste or satisfaction.

Redefine your dining experience at our in-house restaurant, Small Batch Local Kitchen, with a fresh, modern design that blends elegance with comfort, creating the perfect atmosphere for any occasion.

## EXPLORE

Ideally situated in Richmond's vibrant near West End, The Westin Richmond offers convenient access to both the dynamic West End and the historic downtown district. Guests are perfectly positioned to explore the cultural, culinary, and natural attractions that define Richmond's unique character. The hotel is also located just minutes from many of the city's prominent businesses and corporate headquarters, making it an exceptional destination for both business and leisure travelers.

## SEAMLESS SERVICE

Let us take care of the details with services such as the Concierge, business center, gift shop, ATM, Service Express, and complimentary self-parking.

## THE WESTIN RICHMOND

6631 West Broad Street  
Richmond, VA 23230  
USA

T +1 804.282.8444  
F +1 804.282.8445

[marriott.com/RICWI](http://marriott.com/RICWI)

# Floor Plans + Capacity Chart

## MAIN LEVEL

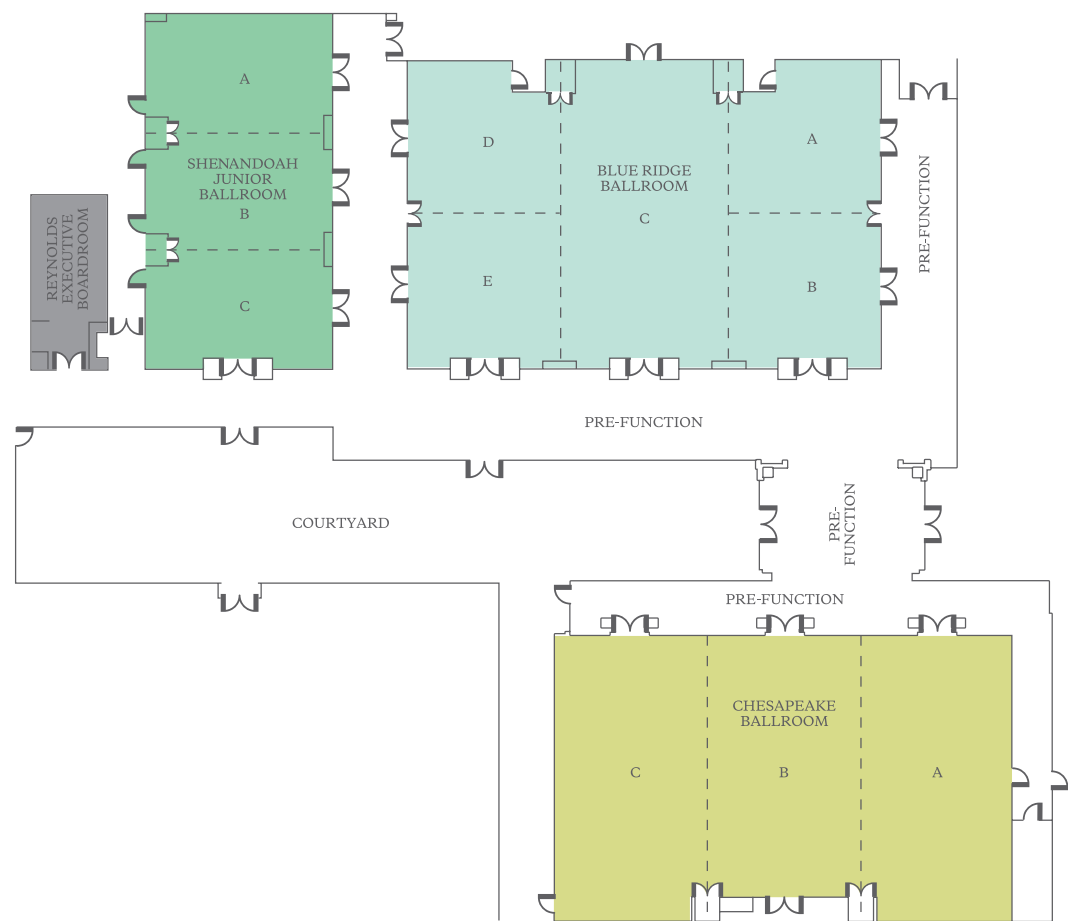

ROOM NAME	DIMENSIONS	TOTAL SQ. FEET	CEILING	BANQUET	THEATER	CONFERENCE	RECEPTION	CLASSROOM	U-SHAPE
MAIN LEVEL									
Blue Ridge Ballroom - Total	56' x 84'	4,387	15' - 10"	300	500	78	500	250	70
Salon A	27' x 27'	683	15' - 10"	50	80	15	65	35	20
Salon B	27' x 27'	712	15' - 10"	50	80	15	65	35	20
Salon AB	54' x 27'	1,395	15' - 10"	100	160	40	120	80	35
Salon C	56' x 30'	1,595	15' - 10"	120	180	40	180	100	40
Salon ABC	54' x 57'	2,990	15' - 10"	200	250	50	300	125	50
Salon D	27' x 27'	684	15' - 10"	50	80	15	65	35	20
Salon E	27' x 27'	713	15' - 10"	50	80	15	65	35	20
Salon DE	54' x 27'	1,397	15' - 10"	100	160	10	120	80	45
Salon CDE	54' x 57'	2,992	15' - 10"	250	320	50	300	150	60
Shenandoah Jr. Ballroom - Total	62' x 33'	1,989	17' - 0"	150	180	55	160	120	50
Salon A	21' x 32'	664	17' - 0"	40	60	20	50	30	20
Salon B	20' x 33'	668	17' - 0"	40	60	20	50	30	20
Salon C	21' x 32'	656	17' - 0"	40	60	20	50	30	20
Salon AB	41' x 33'	1,332	17' - 0"	80	100	30	100	70	35
Salon BC	41' x 33'	1,324	17' - 0"	80	100	30	100	70	35
Reynolds Executive Boardroom	30' x 13'	390	10' - 0"	-	-	10	-	-	-
Pre-Function	104' x 16' x 49' x 10' & 44' x 10'	3,420	17' - 0"	-	-	-	250	-	-
Chesapeake Ballroom - Total	56' x 90'	4,769	13' - 8"	320	500	80	500	250	70
Salon A	56' x 30'	1,625	13' - 8"	120	180	45	200	110	40
Salon B	51' x 30'	1,519	13' - 8"	120	150	35	200	110	35
Salon C	56' x 30'	1,625	13' - 8"	120	180	45	200	110	40
Salon AB	56' x 60'	3,143	13' - 8"	250	300	75	400	200	60
Salon BC	56' x 60'	3,143	13' - 8"	250	300	75	400	200	60
Chesapeake Pre-Function	93' x 9' & 40' x 27'	1,956	13' - 8"	-	-	-	200	-	-
Courtyard	130' x 45'	5,850	-	80	75	-	150	-	-