

One with nature. And success.



Escape to a meeting destination defined by its surroundings at Evergreen Marriott® Conference Resort. A state-of-the-art facility nestled in the delicate beauty of Stone Mountain Park—with 336 spacious, newly-renovated guest rooms and suites, and 50,000 square feet of flexible function space so you can spread out and relax. Breathe easy as our highly attentive staff customizes the perfect indoor or outdoor event. Indulge in a luxurious spa treatment. Re-energize with 36 holes of championship golf, hiking, biking, fishing and more. Top it off with outstanding cuisine at one of our fabulous restaurants. Let our 3,200-acre retreat set your attendees free in Marriott style.



ACCOMMODATIONS

- 5 floors
- 311 reinvigorated guest rooms
- 25 newly refreshed, spacious suites

DINING OPTIONS

- *Waterside Restaurant*, Indulge in delicious buffets in a casually elegant setting, creating a unique experience
- *Mountain Brew Cafe*, Enjoy light fare including breakfast items, salads and sandwiches, and a fresh cup of coffee from our "We Proudly Brew Starbucks®" coffee machine
- *Stonewall's Lounge*, Enjoy your favorite beverage, light fare and a game of billiards in a comfortable and relaxing environment

RECREATION

- Heated indoor pool
- Heated outdoor pool
- 24-hour fitness center
- The Spa at Evergreen
- Golf at Stonemont at Stone Mountain and Lakemont at Stone Mountain
- Biking/hiking trails
- Stone Mountain Park Attractions:
 - Lasershow Spectacular
 - SkyHike
 - Summit Skyride
 - Crossroads
 - The Great Barn
 - Scenic Railroad
 - Miniature Golf

PLACES TO SEE AND THINGS TO DO

- Stone Mountain Park
- Snow Mountain (seasonal)
- Georgia Aquarium
- Centennial Olympic Park
- CNN Center
- World of Coca-Cola
- Turner Field (Braves)

GUEST SERVICES

- Wireless Internet access throughout the hotel
- Complimentary WiFi in the lobby

MEETING FACILITIES

- 48 meeting rooms
- 40,000 square feet of indoor meeting space
- Largest meeting room is Evergreen Ballroom with maximum meeting space of 9,450 square feet and maximum seating capacity of 1,100
- Outdoor resort deck and lakeside pavilion

LOCATION

- 16 miles from downtown Atlanta and a million miles from ordinary
- Nestled in the delicate beauty of Stone Mountain Park
- 24 miles from Hartsfield-Jackson Atlanta International Airport

CAPACITY CHART

Meeting Room	DIMENSIONS		CAPACITY					
	WxLxH	Sq. Ft.	Theater	Schoolroom	Conference	U-Shape	Reception	Banquet
Evergreen Ballroom	75x126x14	9,450	1,100	580	70	70	1,000	820
Evergreen Salon A	25x39x14	975	70	55	36	32	100	80
Evergreen Salon B	25x39x14	975	70	55	36	32	100	80
Evergreen Salon C	25x39x14	975	70	55	36	32	100	80
Evergreen Salon D	70x49x14	3,430	350	198	50	80	400	240
Evergreen Salon E	25x39x14	975	70	55	36	32	100	80
Evergreen Salon F	25x39x14	975	70	55	36	32	100	80
Evergreen Salon G	25x39x14	975	70	55	36	32	100	80
Pre-Function Area 1	75x18x14	1,350	—	—	—	—	140	—
Pre-Function Area 2	40x37x14	1,480	—	—	—	—	160	—
Pre-Function Area 3	56x18x14	1,008	—	—	—	—	100	—
Stone Mountain Ballroom	107x56x17	5,992	600	440	—	—	800	550
Audubon	36x56x17	2,016	200	140	—	—	250	120
Summit	36x56x17	2,016	200	140	—	—	250	120
Lake	36x28x17	1,008	100	45	30	40	125	60
Woodland	36x28x17	1,008	100	45	30	40	125	60
Stone Mountain Ballroom Total Pre-Function Space	—	—	—	—	—	—	—	—
Audubon Pre-Function	29x31x12	899	—	—	—	—	—	—
Summit Pre-Function	37x18x12	666	—	—	—	—	—	—
Lake Pre-Function	15x30x12	450	—	—	—	—	—	—
Woodland Pre-Function	15x39x12	585	—	—	—	—	—	—
Laurel Amphitheatre	—	2,552	—	150	—	—	—	—
Amphitheatre Stage	—	180	—	—	—	—	—	—
Holly Meeting Room	22x26x10	572	34	28	20	24	50	40
Balsam Meeting Room	25x29x12	725	36	38	22	33	75	50
Cedar Boardroom	15x25x10	375	—	—	12	—	—	—
Barberry Meeting Room	17x30x10	510	36	30	22	22	40	32
Juniper Meeting Room	19x30x10	570	38	30	26	23	40	40
Rhododendron Meeting Room	29x48x12	1,392	100	68	44	45	100	80
Rhododendron A or B	29x24x12	696	46	30	20	24	50	40
Wintergreen Meeting Room	18x32x10	576	38	30	26	23	40	40
Magnolia Meeting Room	19x25x10	475	36	24	18	22	40	40
Dogwood Meeting Room	29x48x12	1,392	100	80	32	38	160	120
Dogwood A or B	29x24x12	696	50	36	14	24	60	50
Cherry Meeting Room	29x48x12	1,392	100	80	28	38	120	80
Pre-Function Area 4	20x50x10	1,000	—	—	—	—	—	—
Rotunda Meeting Room	50x50x14	2,500	160	110	30	46	225	160
Rotunda Pre-Function	39x20x10	780	—	—	—	—	—	—
Pre-Function Area 5	19x25x10	475	—	—	—	—	—	—
Willow Meeting Room	30x49x12	1,470	160	99	28	38	150	120
Maple Meeting Room	20x31x10	620	46	38	20	20	50	40
Birch Meeting Room	20x28x10	560	36	32	20	24	50	40
Poplar Meeting Room	22x33x10	726	60	48	26	33	75	50
Gardenia Meeting Room	20x31x10	620	36	32	20	24	50	40
Cypress, Camellia, Azalea, Jasmine, Heather, Hibiscus and Honeysuckle (Each)	15x20x10	300	20	15	14	14	25	16
Lakefront Pavilion	—	5,940	—	—	—	—	500	350
Resort Deck	—	—	—	—	—	—	400	300
Poolside	—	—	—	—	—	—	200	125

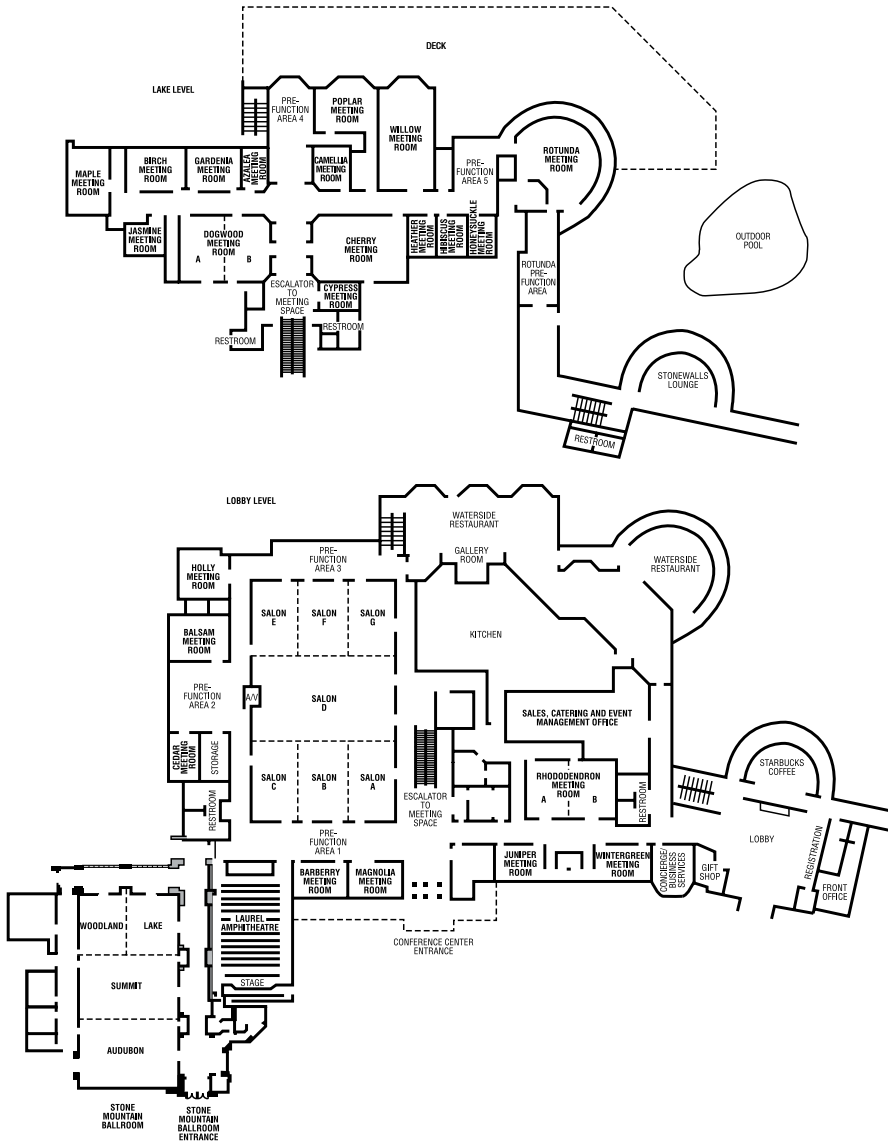

ATLEG © 2011 Marriott International, Inc.