

MEETING ROOMS	L X W X H	SQ. FT.	SCHOOLROOM	RECEPTION	THEATRE	CONFERENCE	USHAPE	HOLLOW SQ
<b>SECOND FLOOR</b>								
Stemmons Ballroom	80'x52'x12'	4564	250	350	300	72	68	104
Stemmons A	40'x52'x12	2282	125	175	150	40	50	64
Stemmons B	40'x52'x12	2282	125	175	150	40	50	64
Stemmons Foyer								
Victory	19'x39'x9'	741	36	75	60	28	27	30
Victory I	13'x19'x9'	247	8	10	15	10	-	-
Victory II	26'x18'x9'	468	24	45	25	16	19	19
Dealey	20'x22'x9'	440	24	35	35	20	20	24
Grand Ballroom	183'x87'x24'	15,921	1000	1500	1800	-	-	-
Salon A, B, C, F, G or H	45'X28'X24'	1260	72	125	100	30	43	48
Salon AB, BC, FG or GH	56'X45'X24'	2520	148	250	225	-	56	72
Salon AC, D, E or FH	84'X45'X24	3780	224	375	550	-	86	102
Salon AD, DE or EH	90'X84'X24	7560	500	1000	1000	-	116	152
Salon AE or DH	135'x84'x24'	11340	750	1200	1500	-	-	-
Foyer A, B or C	29'X18' X21'	553	-	-	-	-	-	-
Foyer F, G or H	31'X 10.6'X21'	310	-	-	-	-	-	-
Foyer D		1500	-	250	-	-	-	-
Foyer E		1500	-	250	-	-	-	-
Grand Foyer	35'X200'X21'	6580	-	1000	-	-	-	-
Grand Terrace (outdoor)	15.5'X 102'X 21	1560	-	-	-	-	-	-
<b>THIRD FLOOR</b>								
Knox	21'x28'x10'	588	24	35	30	20	20	24
Henderson (conf. table)	15'x18'x10'	270	-	-	-	12	-	-
Design	20'x40'x9'	800	36	50	65	28	24	28
Design I	14'x21'x9'	294	12	20	16	10	-	-
Design II	13'x19'x9'	247	12	20	16	16	12	15
Design III	13'x14'x9'	182	-	-	10	8	-	-
Design I & II	21'x27'x9'	567	24	55	32	20	20	24
Design II & III	16'x26'x9'	416	16	50	25	18	16	20
Turtle Creek	20'x25'x10'	500	24	35	30	20	22	28
University	21'x17x10'	357	16	35	20	16	15	18
Landmark Ballroom	88'x59'x12'	5192	300	600	550	80	80	112
Landmark A	44'x59'x12	2596	150	300	275	48	56	72
Landmark B	44'x59'x12	2596	150	300	275	48	56	72
Landmark Foyer		-	200	-	-	-	-	-
Landmark A Foyer		-	100	-	-	-	-	-
Landmark B Foyer		-	100	-	-	-	-	-
Mockingbird	34' X 26' X10'	934	40	70	60	30	30	38
Maple	28' X 26' X 10'	760	28	50	40	20	24	32
<b>FOURTH FLOOR</b>								
Uptown		1390	***Workspring Concept, Modular Furniture Setting***					
Highland	2538	-	200	-	-	-	-	-
Highland I	15 x 13 x 9	195	-	-	-	6	-	-
Highland II	26 x 18 x 9	468	32	30	30	16	20	24
Highland III	28 x 22 x 9	606	40	40	35	20	26	30
Highland IV	28 x 22 x 9	606	40	40	35	20	26	30
Highland V	26 x 18 x 9	468	32	30	30	16	20	24
Highland VI	15 x 13 x 9	195	-	-	-	6	-	-
Highland I,II	29 x 16 x 9	464	42	35	40	20	20	24
Highland I,II,III	73 x 18 x 9	1314	92	100	65	-	44	48
Highland I,II,III,IV	101 x 18 x 9	1818	-	135	-	-	78	80
Highland I,II,III,IV,V	121 x 18 x 9	2178	-	170	-	-	108	112
Highland II,III	54 x 20 x 9	1080	72	70	65	28	44	48
Highland II,III,IV	82 x 20 x 9	1640	68	110	100	-	78	80
Highland II,III,IV,V	108 x 22 x 9	2376	-	180	-	-	108	112
Highland II,III,IV,V,VI	121 x 20 x 9	2420	-	170	-	-	108	112
Highland III,IV	56 x 22 x 9	1232	80	80	70	28	54	60
Highland III,IV,V	82 x 20 x 9	1640	68	110	100	-	78	80
Highland III,IV,V,VI	67 x 20 x 9	1340	-	135	-	-	78	80
Highland IV,V	54 x 20 x 9	1080	72	70	65	28	44	48
Highland IV,V,VI	67 x 18 x 9	1206	92	100	65	-	44	48
Highland V,VI	29 x 16 x 9	464	42	35	40	20	20	24
City View	39' x 120'	6120	-	450	-	-	-	-
City View Terrace (Outdoor)	40'X127'	5080	-	-	-	-	-	-

4TH FLOOR

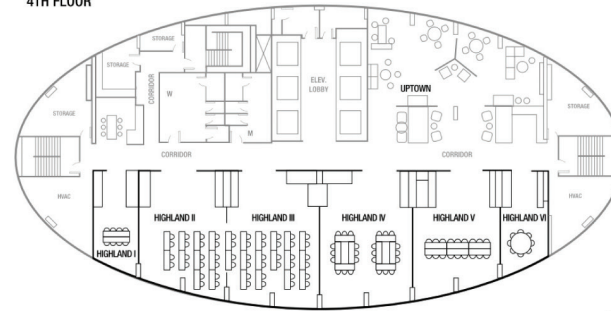

2ND FLOOR

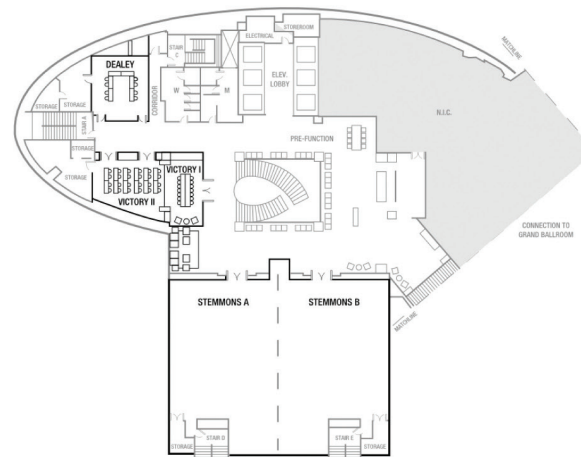

3RD FLOOR

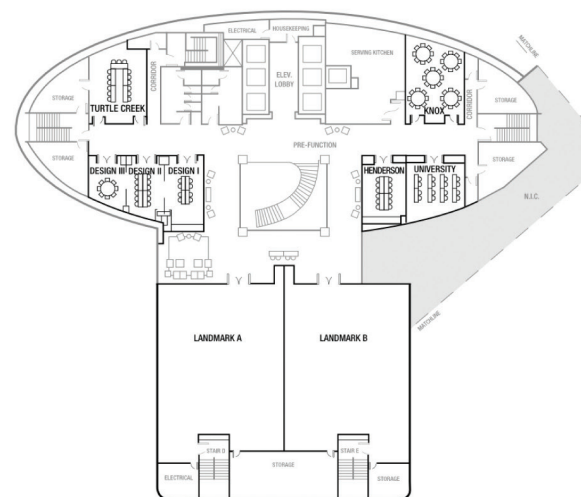

GRAND BALLROOM

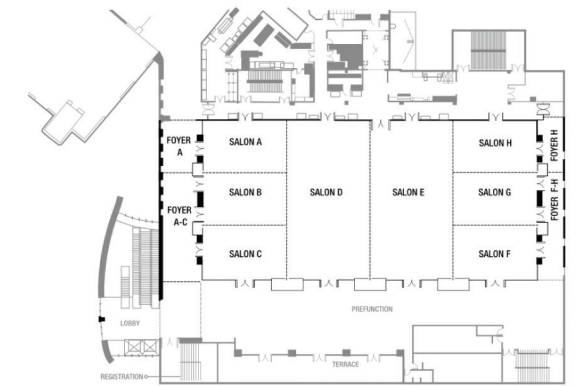

CITY VIEW BALLROOM & TERRACE

