

**DIMENSIONS**

**CAPACITY**

Meeting Room	L x W x H	Sq. Ft.	Theatre	School Room 3x6	School Room 2x6	Conf	U-Shape	Hollow Square	Reception	Crescents of 7	Meals Only Rounds of 12	Rounds of 12	Exhibits 6ft	Exhibits 8ft	Exhibits 8x10	Exhibits 10x10
<b>3RD FLOOR (MEETING SPACE)</b>																
Guest Office	*Stationary Set					12										
Nice	24'x24'x10'11"	576	50	36	24	22	20	26	50	28	48	36	8	8	6	6
Alsace	29'11"x20'x8'11"	586	40	26	16	22	18	24	50	21	36	36	7	7	6	6
Champagne	29'11"x24'x10'11"	720	60	36	24	26	24	35	70	35	48	48	8	8	6	6
Normandy A/B	29'11"x58'x9'6"	1715	160	100	64	50	50	56	200	70	168	144	15	15	14	14
Normandy A	29'11"x29'x9'6"	861	80	48	32	22	24	33	100	35	60	48	10	10	9	9
Normandy B	29'11"x29'x9'6"	854	70	42	30	22	24	27	100	35	48	36	10	10	8	8
Bordeaux	37'11"x22'x9'6"	836	80	57	38	28	28	34	100	49	84	72	10	10	9	8
Plaza Ballroom	68'x127'x14'	8,636	900	440	320	140	140	NA	1000	245	660	564	40	38	36	34
Plaza A	68'x45'x14'	3,060	240	120	96	48	56	70	350	84	216	192	17	17	16	15
Plaza B	68'x37'11"x14'	2,584	220	110	90	45	48	64	300	84	180	168	17	17	16	15
Plaza C	68'x43'11"x14'	2,992	240	120	96	48	56	70	350	84	216	192	17	17	16	15
Plaza AB	68'x83'x14'	5,644	485	260	175	220	90	106	600	161	396	360	21	21	20	19
Plaza BC	68'x81'11"x14'	5,576	485	260	175	220	90	106	600	161	396	360	21	21	20	19
Plaza Foyer									200				30	28	26	24
Plaza Terrace									100				30	28	26	24
<b>2ND FLOOR (MEETING SPACE)</b>																
Somerset	52'11"x45'11"x13'8"	2,367	160	120	80	40	45	58	250	70	156	144	19	19	17	16
Cambridge	93'11"x56'11"x10'	5,146	350	200	160	40	45	58	450	140	360	336	33	30	26	22
<b>2ND FLOOR (GUEST FLOOR)</b>																
Pearl Conference Room (2nd Fl)	*Stationary Set					12										
<b>1ST FLOOR (ATRIUM LEVEL)***</b>																
Atrium (\$500 to \$1200**)	10,000								600			**25 to 300				
<b>12TH FLOOR (PLAZA OF THE AMERICAS)***</b>																
12th Floor Pearl Conference (\$900)	62x30x10	1953			80	30	35	40	70							
12th Floor Pearl A(\$500)	22x30x10	682			28	14	24	28	20							
12th Floor Pearl B(\$700)	40x30x10	1271			52	30	35	42	60							
12th Floor Open Area	1300								80	60						
12th Floor Crockett Conference (\$800)	44x32x10	1408			56	30	35	40	60							
12th Floor Crockett A (\$500)	22x32x10	704			28	20	24	30	20							
12th Floor Crockett B (\$500)	22x32x10	704			28	20	24	30	20							

\*\*Reach out to property DSE for detailed rental and booking conditions for Atrium Space  
 \*\*Can set RDs in Atrium - see DOE for specifics  
 \*\*\*Auxiliary Space requires a request for availability  
 Email daldt.eventmanagement@marriott.com

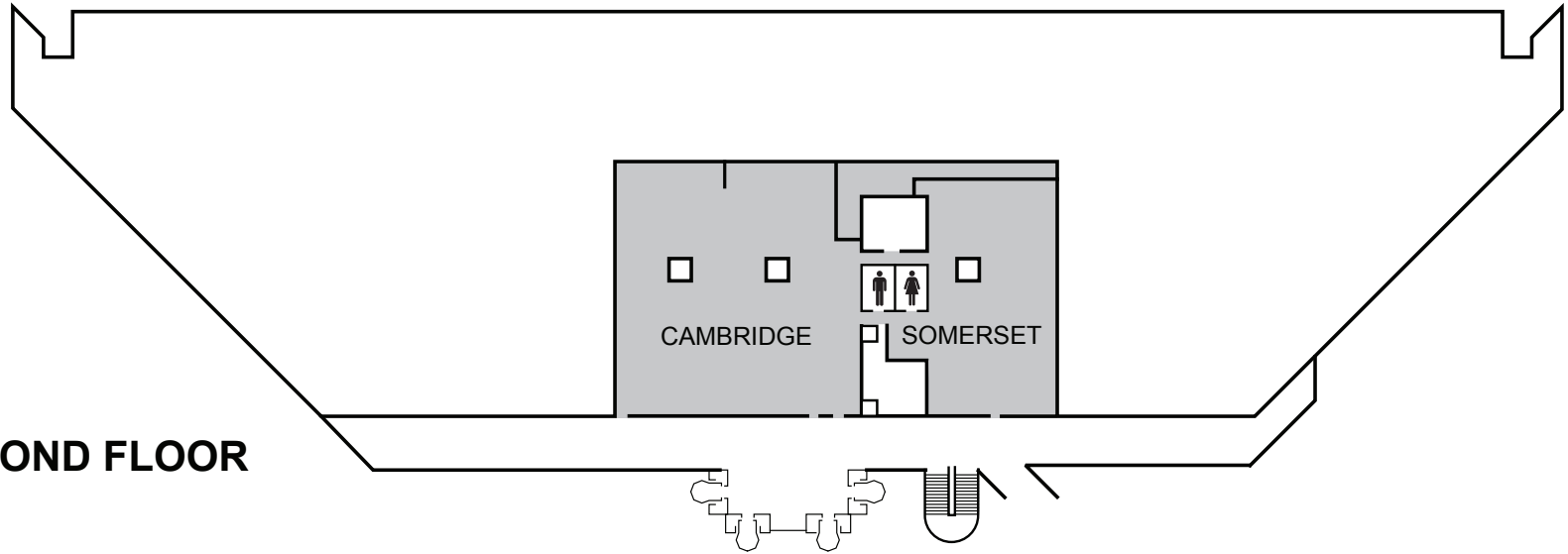

**SECOND FLOOR**

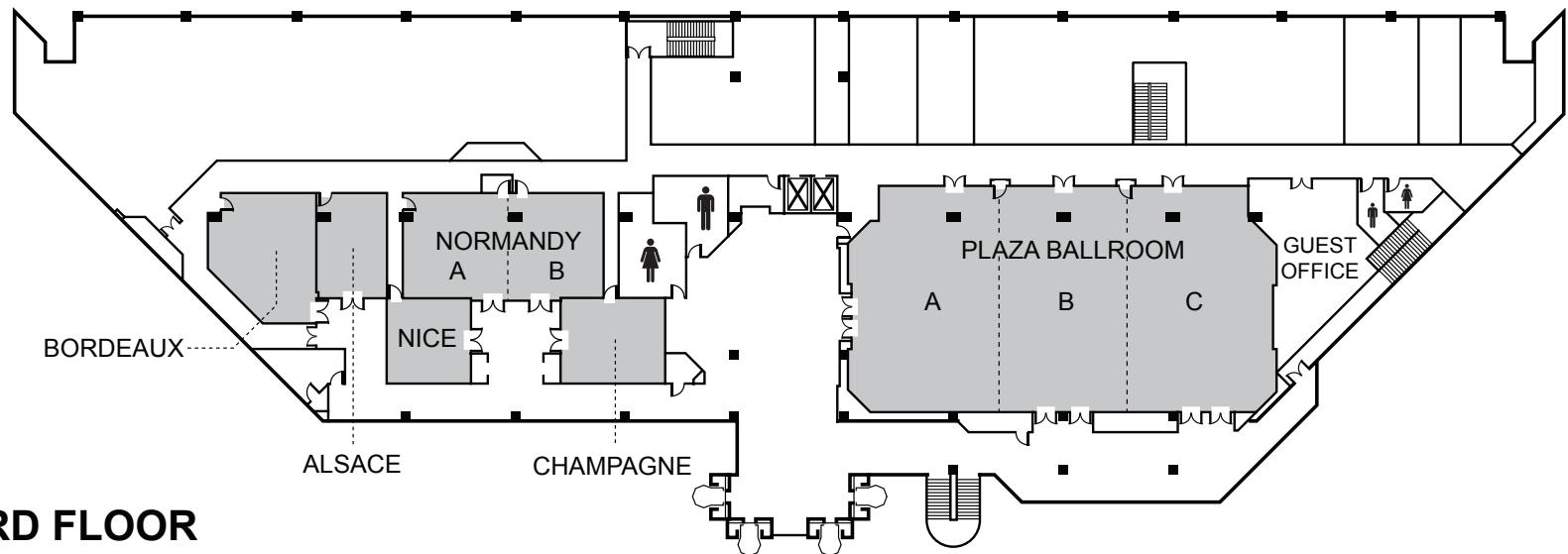

**THIRD FLOOR**