



**MARRIOTT RESORT
PHUKET
MERLIN BEACH**

INNOVATIVE BEACHSIDE MEETINGS

Phuket Marriott Resort & Spa, Merlin Beach – where meeting planners can host unique and dynamic events in a secluded beach getaway close to the enchanting, colorful life of Patong. From a gala of 600 guests to a more intimate meeting for 10, the resort offers creative culinary delights and cultural experiences.

LOCATION

Our Phuket resort is located near Patong, not far from the island's eclectic entertainment and nightlife area but near enough to enjoy the secluded white sand beach

GUEST SERVICES

Offering Mobile Check-In and Checkout • The Lounge provides exclusive space to work, recharge, connect and relax • Wireless high-speed Internet • On-site parking • Shuttle buses for a fee • Tour service • Guest laundry and dry-cleaning service • ATM

ACCOMMODATION

Committed to a smoke-free environment • 414 rooms and suites • Luxurious bedding with down comforters and cotton linens • Individual climate control • 48" LCD satellite TV

RESTAURANTS & LOUNGES

A variety of international and local options to choose from

- Merchant Kitchen, an all-day dining restaurant
- D.O.C.G., signature Italian cuisine
- Beach Grill, a casual beachside grill
- Thai Pantry, authentic Thai experiences
- Phuket Coffee Co., beachside coffee house
- The Lounge, handcrafted food and beverages
- Pool Bar, refreshing drinks at the lagoon pool
- Wellness, poolside juice bar
- The Rum Shack, beachfront bar serving cocktails

RECREATION & LEISURE

Three beautifully-appointed swimming pools • 24-hour fitness center • The Spa • Butterfly Sanctuary • House Reef • Dive Center • Muay Thai • Yoga • Fire Show • Kid's Club

ATTRACTIONS

- Phi Phi Island • James Bond Island • Khai Island
- Weekend Market Tours • Phuket Town Tours
- Chalong Temple • Promthep Cape • Big Buddha
- Jungceylon Shopping Center
- Central Festival Shopping Center

MEETING FACILITIES

7 meeting rooms • Merlin Grand Ballroom (573 sqm, 3 rooms) • Vanda Room (84 sqm) • 3 breakout rooms: Mokara 1 & 2 (64.6 sqm) and Farland (23.2 sqm) with daylight • Beach Lawn overlooking manicured grounds • All meeting spaces feature the latest technology



99 Muen-Ngoen Road, Tri-Trang Beach, Patong Phuket 83150 Thailand

T: +66.(0)76.335.300 | F: +66.(0)76.335.335

Marriott.com/HKTMB

PHUKET MARRIOTT RESORT & SPA, MERLIN BEACH

CHOOSE FLEXIBILITY FOR YOUR NEXT MEETING OR EVENT

Phuket Marriott Resort & Spa, Merlin Beach boasts a range of versatile and impressive event and function spaces. The Merlin Grand Ballroom and Vanda Boardroom provide flexible options for any type of meeting or event, and include three breakout areas filled with daylight. The beach lawn can cater to events of all sizes, from intimate dinners to large gala events. This unique area enhances the experience of every event to make it one your guests will not forget.

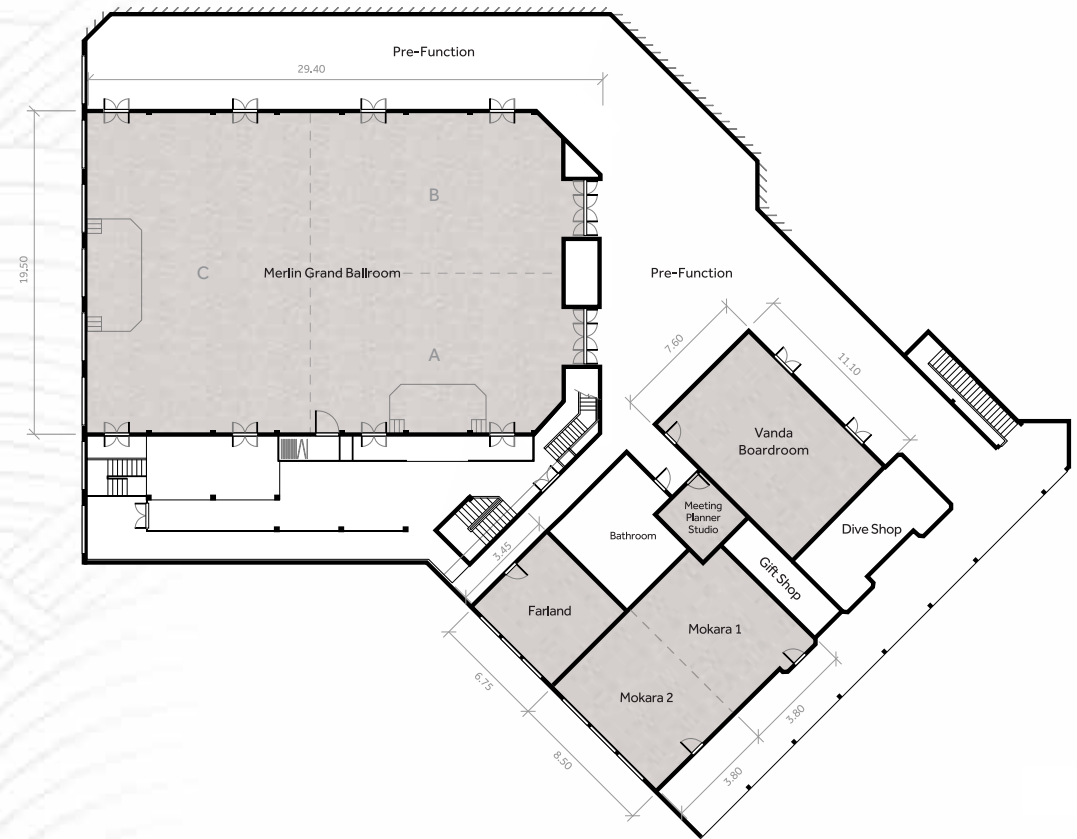

VENUE	L x W (metres)	Sq.m.	Theater	Boardroom	Classroom	U-Shape	Cocktail	Dining
Merlin Grand Ballroom	29.40 x 19.50	573	650	60-70	200-240	145	550	300-350
Merlin Grand Ballroom A	13.60 x 9.75	132.5	80	20-30	45-60	35-50	120	50-60
Merlin Grand Ballroom B	13.60 x 9.75	132.5	80	20-30	45-60	35-50	120	50-60
Merlin Grand Ballroom C	15.80 x 19.50	308	200	30-35	120-140	108	280	120-150
Merlin Grand Ballroom A & B	13.60 x 19.50	265	180	50-60	100-120	60-100	240	100-120
Vanda Boardroom	7.60 x 11.10	84	60	24	30-40	30-36	30-50	40-50
Mokara 1	8.50 x 3.80	32.3	30	20	15	20	30-40	20
Mokara 2	8.50 x 3.80	32.3	30	20	15	20	30-40	20
Mokara 1 & 2	8.50 x 7.60	64.6	60	-	30	20	60-80	40
Farland	6.75 x 3.45	23.2	16	10	9	-	10	-