

# Meeting Room Floor Plans



## Lobby Level

Room Name	Square Ft	Dimensions	Height	Banquet	Theatre	Reception	Classroom	U-Sape	H-Square	Brdm
Hennepin North <b>(1)</b>	1156	34' x 34'	10'9"	90	80	100	48	30	40	30
Hennepin South <b>(2)</b>	1768	52' x 34'	9'5"	120	120	180	96	44	56	40
Hennepin Ballroom <b>(1+2)</b>	2924	86' x 34'	9'5"	210	252	280	144	76	96	-
Peninsula <b>(3)</b>	1312	32' x 41'	9'1"	80	130	150	72	40	48	32



## Mezzanine Level

Room Name	Square Ft	Dimensions	Height	Banquet	Theatre	Reception	Classroom	U-Sape	H-Square	Brdm
Oakes Foyer <b>(5)</b>	2414	71' x 34'	11'	120	180	400	96	48	56	40
Oakes North West <b>(6)</b>	2160	36' x 60'	14'5"	150	180	350	120	45	54	52
Oakes North East <b>(7)</b>	2160	36' x 60'	14'5"	150	180	350	120	45	54	52
Oakes North <b>(6+7)</b>	4620	77' x 60'	14'5"	300	450	700	220	62	100	-
Oakes South <b>(8)</b>	3850	50' x 77'	14'5"	240	550	500	160	56	100	-
Oakes Ballroom <b>(5+6+7+8)</b>	8470	110' x 77'	14'5"	630	1000	1200	460	-	-	-
Stage <b>(9)</b>	693	21' x 33'	12'	-	-	-	-	-	-	-
Private Dining Room <b>(11)</b>	392	28' x 14'	8'	-	-	-	-	-	-	22

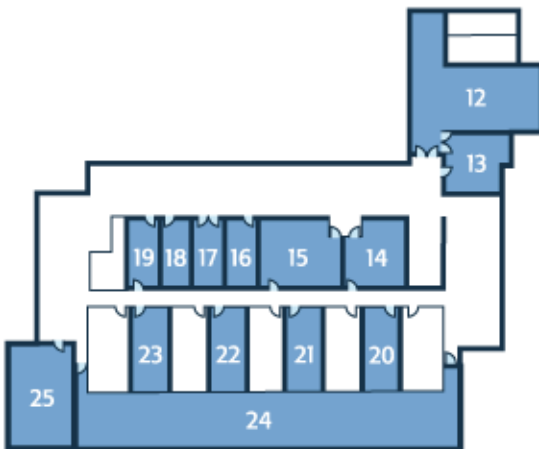

## Third Floor Level

Room Name	Square Ft	Dimensions	Height	Banquet	Theatre	Reception	Classroom	U-Sape	H-Square	Brdm
Salon A <b>(12)</b>	2040	34' x 60'	7'9"	150	150	220	96	48	60	40
Salon B <b>(13)</b>	480	16' x 30'	7'9"	30	40	50	30	24	30	22
Ontario <b>(14)</b>	576	18' x 32'	8'	30	42	50	24	24	30	24
Niagara <b>(15)</b>	768	32' x 24'	8'	50	60	60	42	30	36	30
Canadiana <b>(16)</b>	320	32' x 10'	8'	-	25	30	12	-	-	18
Executive Brdrm <b>(17)</b>	448	32' x 14'	8'			Maximum Capacity	12			
Oneida <b>(18)</b>	384	32' x 12'	8'	-	30	30	15	-	-	20
Maple <b>(19)</b>	352	11' x 32'	8'	-	30	30	15	-	-	20
Parlour Rooms <b>(20-23)</b>	252	21' x 12'	8'	-	16	20	-	-	-	8
Mount Carmel <b>(25)</b>	405	27' x 15'	8'	-	18	20	-	-	-	10