



ROME MARRIOTT PARK HOTEL

PRESENTATION



SUMMARY

1 Location

2 Rome Marriott Park Hotel & Conference Center Presentation

3 Meetings Imagined

4 Contact Details



MARRIOTT
ROME PARK HOTEL

LOCATION

PROPRIETARY & CONFIDENTIAL

LOCATION

Easy access to Fiumicino International Airport

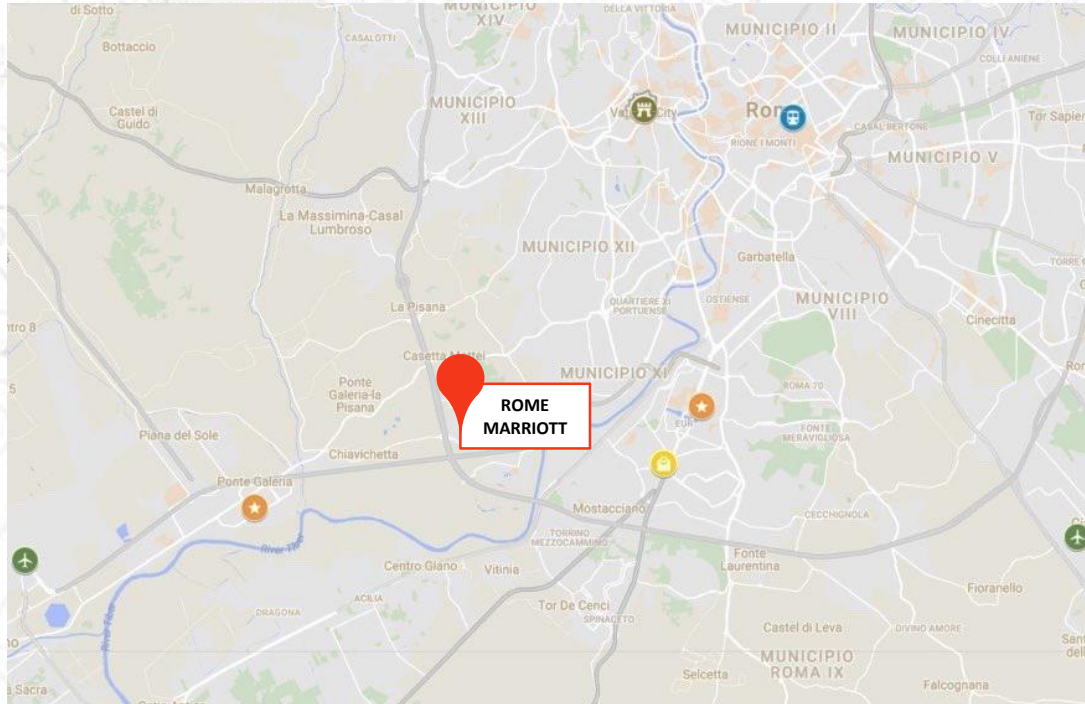

-  Historic Centre – 18 km
-  Shopping Centre Euroma2 – 11 km
-  La Nuvola Rome Convetion Centre – 13 km
-  Fiera Roma – 9 km
-  Rome Termini Train Station – 22,7 km
-  Rome Fiumicino Airport FCO – 15 km
-  Rome Ciampino Airport CIA – 21 km

LOCATION

Our well-placed hotel is only 10 miles from Fiumicino Airport and from world-renowned destinations, including Vatican City and the Colosseum.





MARRIOTT
ROME PARK HOTEL

ROME MARRIOTT PARK HOTEL & CONFERENCE CENTER PRESENTATION

PROPRIETARY & CONFIDENTIAL

ROOMS



482 DELUXE: 165 TWB (2 Single Beds) – 317 DBL (1 Queen Bed)

50 STUDIO King Beds

28 EXECUTIVE King Beds

24 JUNIOR SUITE King Beds

14 SUITE King Beds

3 PRESIDENTIAL SUITE King Beds

HOTEL FACILITIES



- Restaurant
- Executive Lounge
- Wine Bar
- Fitness Center
- Spa
- Outdoor swimming pool

CONFERENCE CENTER

- Among the biggest Conference Center Hotels in Europe
- 139,823 sq ft with flexible meeting space
- 40 meeting rooms for up to 2400 people





MARRIOTT
ROME PARK HOTEL

FLOOR PLANS

PROPRIETARY & CONFIDENTIAL

MAIN LOBBY LEVEL

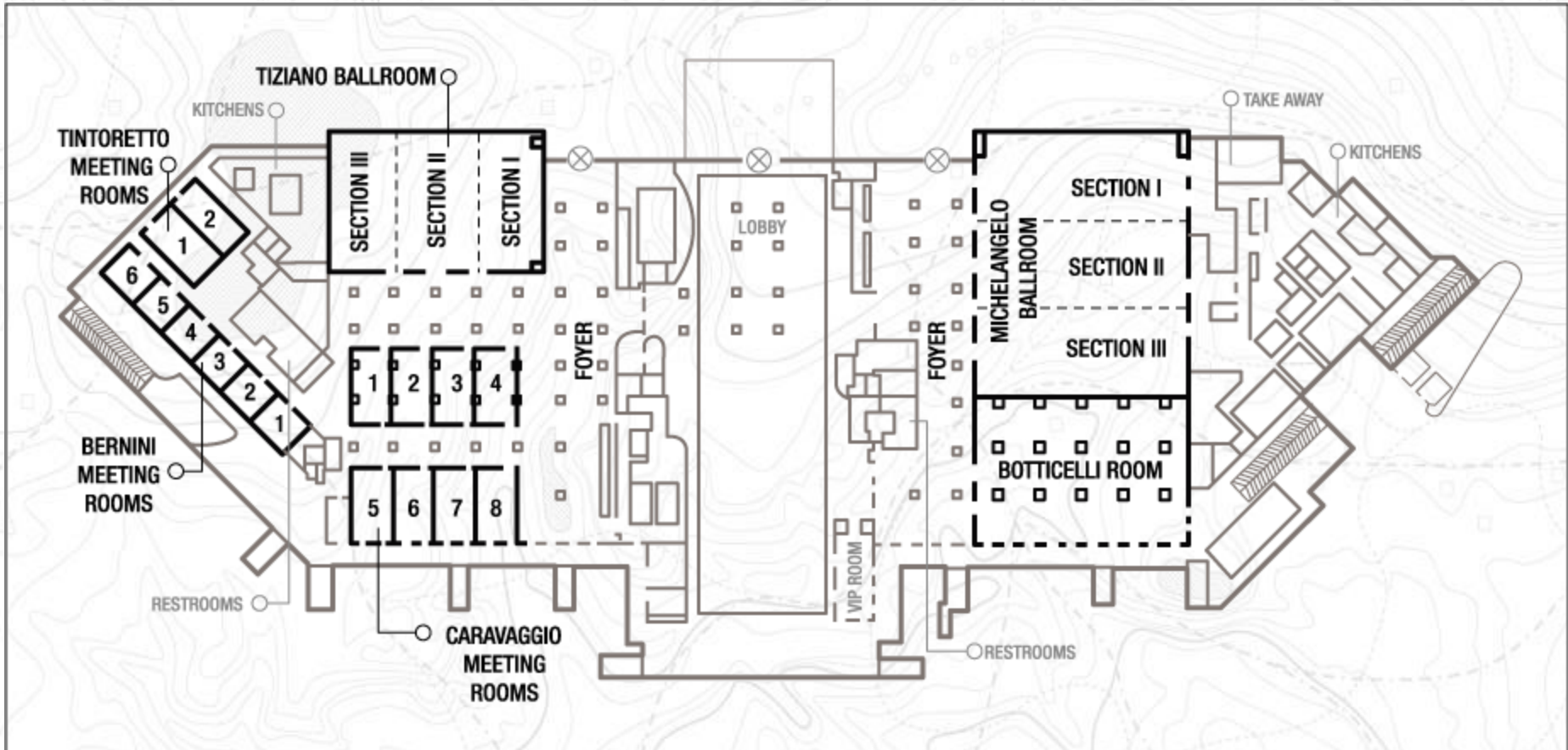

MAIN LOBBY LEVEL meeting room capacity

Name of the Room	Dimension in Feet					Meeting room capacity (number of people)*								
	LENGTH	WIDTH	MIN. HEIGHT	MAX. HEIGHT	SQ. FEET	Theatre	Classroom 2 pax	Classroom 3 pax	Rounds 6 pax	Rounds 8 pax	Boardroom	Hollow sq.	U-Shape	
Michelangelo Ballroom	whole	155	126	24 up to rail		19.640	2.400	600	1000	700	900	-	-	-
	half	126	770	24 up to rail		9.740	1.200	320	500	370	450	-	-	-
	third	126	515	24 up to rail		6.510	550	200	300	240	280	-	-	-
	1+2 or 2+3	126	104	24 up to rail		13.070	1.260	350	520	400	500	-	-	-
Botticelli		126	885	9,5 under cap	10,5	11.400	*	*	*	*	*	-	-	-
Michelangelo Foyer	Exhibition Area			9,7 on sides	10,8 on centre	10.764								
Gran Ballroom (Mich + Bott)		243	127	10,5 Botticelli	7,30 Mich.	31.000	2.800	930	1.400	1.000	1.300	-	-	-
Michelangelo Office		26	13			338	-	-	-	-	-	15	-	-
Private Room Brasserie		49	23	9,7	12,10 on centre	1.240	70	24	36	36	48	32	-	36
Tiziano Ballroom	whole	126	81	23,3 up to rail		10.171	1.000	320	480	330	440	-	-	-
	half	81	62	23,3 up to rail		5.059	550	160	240	160	220	-	-	-
	third (sec. 1-3)	81	38	23,3 up to rail		3.121	300	105	160	108	140	-	-	-
	third (sec. 2)	81	49	23,3 up to rail		3.982	340	180	180	180	180	-	-	-
Tiziano Foyer	Exhibition Area			10,0	10,8 on centre	15.069								
Tiziano Foyer + Carav.	Exhibition Area			10,0	10,8 on centre	26.910								
Bernini (6)		23	23	9,8		560	45	18	27	18	24	20	24	21
Tintoretto 1		43	23	10 on sides	10,8 on centre	947	75	30	45	30	40	32	36	30
Tintoretto 2		43	23	9,2 on sides	10,2 on centre	947	75	30	45	30	40	32	36	30
Tintoretto Foyer	Exhibition Area	31	28	8,9		840								
Caravaggio (8)		46	23	10	10,8 on centre	1.109	90	30	50	35	40	38	34	35

MAIN LOBBY LEVEL room capacity for catering

Name of the Room	Dimension in Feet	Room capacity for catering (number of people)*									
		LENGTH	WIDTH	MIN. HEIGHT	MAX. HEIGHT	SQ. FEET	Breakfast	Standing b.	Seated b.	Served (T*11)	Gala (T*10)
Michelangelo Ballroom	whole	155	126	24 up to rail		19.640	1.100	1300	850	1100 (100T)	1000 (100T)
	half**	126	770	24 up to rail		9.740	500	650	425	550 (50T)	500 (50T)
	third	126	515	24 up to rail		6.510	350	350	250	350 (32T)	320 (32T)
	1+2 or 2+3	126	104	24 up to rail		13.070	800	900	600	820 (75T)	750 (75T)
Botticelli		128	89	9,5 under cap	10,5	11.044	550	650	550	660 (60T)	600 (60T)
Michelangelo Foyer	Exhibition Area			9,7 on sides	10,8 on centre	10.764					
Gran Ballroom (Mich + Bott)		243	127	10,5 Botticelli	7,30 Mich.	31.000	1.200	2.000	1.200	1650 (150T)	1500 (150T)
Michelangelo Office		26	13			338					
Private Room Brasserie		49	23	9,8		1.240		80	50	77	70
Tiziano Ballroom	whole	126	81	23,3 up to rail		10.171	600	650	600	660 (60T)	600 (60T)
	half	81	62	23,3 up to rail		5.059	300	350	300	330 (30T)	300 (30T)
	third (sec. 1-3)	81	38	23,3 up to rail		3.121	144	170	144	190 (18T)	180 (18T)
	third (sec. 2)	81	49	23,3 up to rail		3.982	220	300	220	308 (28T)	280 (28T)
Tiziano Foyer	Exhibition Area			10	10,8 on centre	15.069		500			
Tiziano Foyer + Carav.	Exhibition Area			10	10,8 on centre	26.910	1.000	1.800	1000 (120T)	1320 (120T)	1200 (120T)
Bernini (6)		23	23	9,8		560					
Tintoretto 1		43	23	10 on sides	10,8 on centre	947					
Tintoretto 2		43	23	9,2 on sides	10,2 on centre	947					
Tintoretto Foyer	Exhibition Area	31	28	8,9		840					
Caravaggio (8)		46	23	10	10,8 on centre	1.109					

GARDEN LEVEL

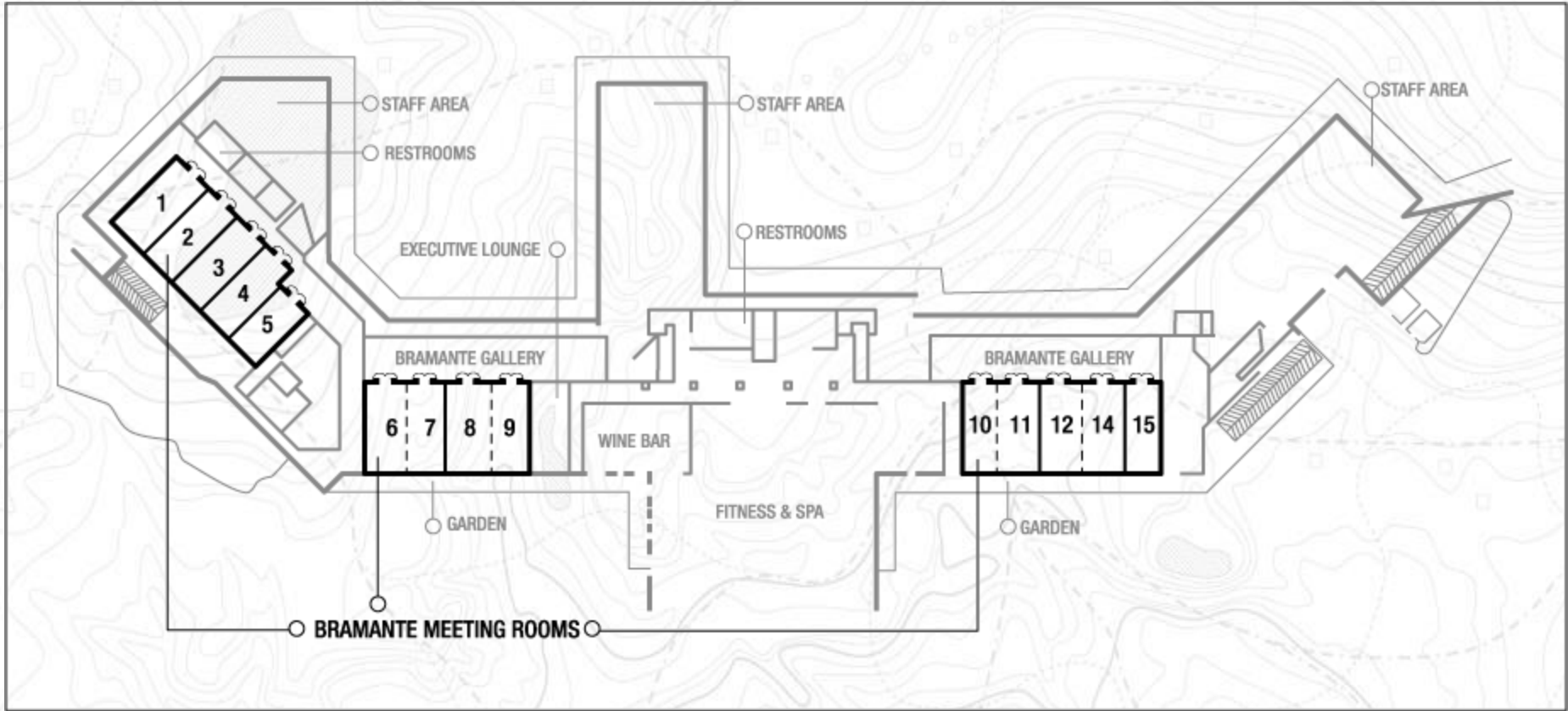

GARDEN LEVEL meeting room capacity

Name of the Room		Dimension in Feet					Meeting room capacity (number of people)*							
		LENGTH	WIDTH	MIN. HEIGHT	MAX. HEIGHT	SQ. FEET	Theatre	Classroom 2 pax	Classroom 3 pax	Rounds 6 pax	Rounds 8 pax	Boardroom	Hollow sq.	U-Shape
Bramante (1-4 e 6-15)		59	23			1.356	100	36	54	36	40	35	40	40
Bramante (1-9)				8,9		1.356	100	36	54	36	40	35	40	40
Bramante 5		46	23	8,9		1.023	90	28	45	30	40	26	30	30
Bramante (10-15)				9		1.356	100	36	54	36	40	35	40	40
Bramante Gallery (6-9)	Exhibition Area	138	26	8,5		3.488								
Bramante Gallery (10-15)	Exhibition Area	141	16	8,2		2.314								
Wine Bar		45	47	9		2.100	*	*	*	*	*	*	*	*
SPA Foyer	Exhibition Area	52	26	8,9	9,8	1.380								

GARDEN LEVEL room capacity for catering

Name of the Room		Dimension in Feet					Room capacity for catering (number of people)*					
		LENGTH	WIDTH	MIN. HEIGHT	MAX. HEIGHT	SQ. FEET	Breakfast	Standing b.	Seated b.	Served (T*11)	Gala (T*10)	
Bramante (1-4 e 6-15)		59	23			1.356						
Bramante (1-9)				8,9		1.356						
Bramante 5		46	23	8,9		1.023						
Bramante (10-15)				9		1.356						
Bramante Gallery (6-9)	Exhibition Area	138	26	8,5		3.488						
Bramante Gallery (10-15)	Exhibition Area	141	16	8,2		2.314						
Wine Bar		45,00	47,00	9		2.100		150	82 (7T)	110 (10T)	100 (10T)	
SPA Foyer	Exhibition Area	52,00	26,00	8,9	9,8	1.380						

6 FLOOR

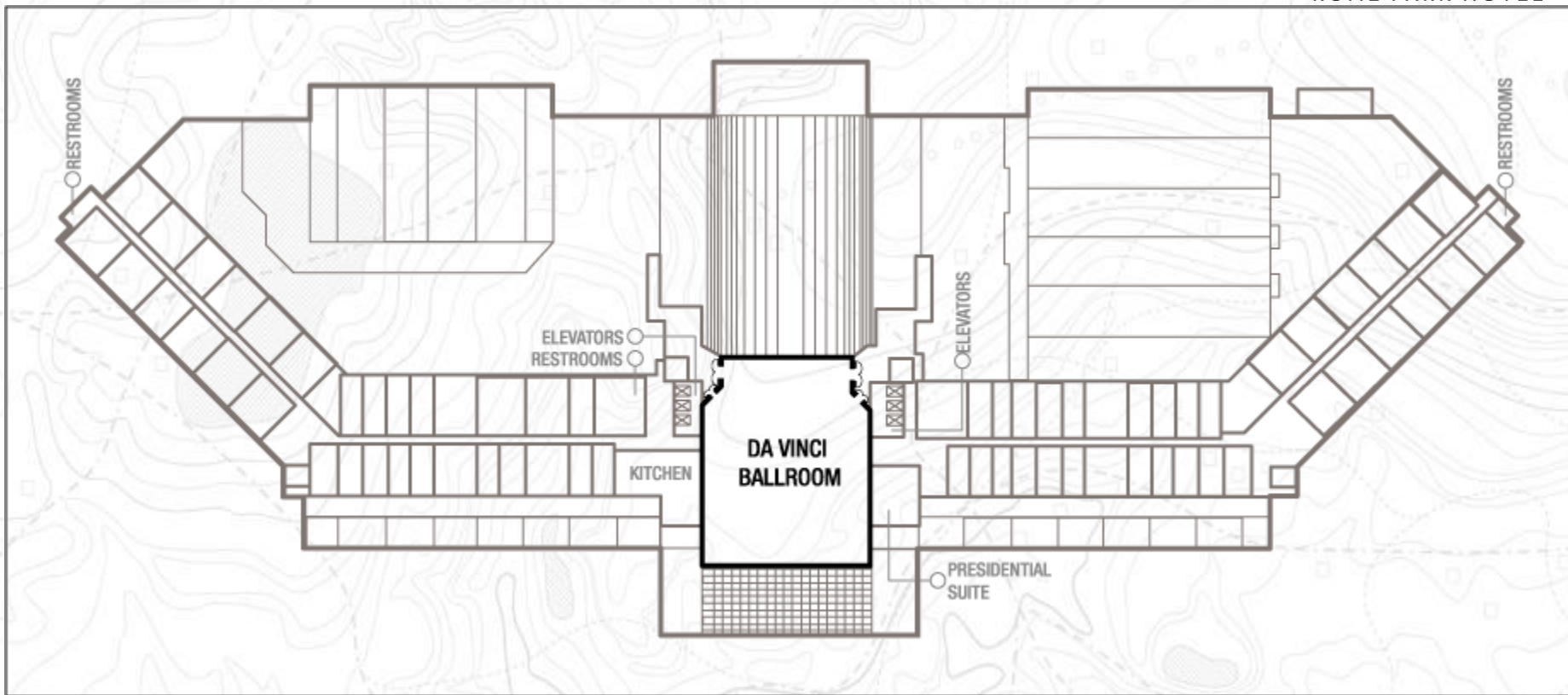

Name of the Room						Meeting room capacity (number of people)*							
	LENGTH	WIDTH	MIN. HEIGHT	MAX. HEIGHT	SQ. FEET	Theatre	Classroom 2 pax	Classroom 3 pax	Rounds 6 pax	Rounds 8 pax	Boardroom	Hollow sq.	U-Shape
Da Vinci Ballroom	102	89	12,6		8.869	1.000	360	540	360	440	-	-	-
Name of the Room						Room capacity for catering (number of people)*							
	LENGTH	WIDTH	MIN. HEIGHT	MAX. HEIGHT	SQ. FEET	Breakfast	Standing b.	Seated b.	Served (T*11)	Gala (T*10)			
Da Vinci Ballroom	102	89	12,6		8.869	550	700	550 (46T)	660 (60T)	600 (60T)			

meetings imagined

Every Meeting has a purpose

We partner with you to design experiences that **deliver impact** and **inspire your attendees**.

- Tips, insights and trends organized by purpose
- Inspirational gallery of hundreds of images to spark creativity
- Platform for on-line collaboration with Marriott event partners



 CELEBRATE

 DECIDE

 EDUCATE

 IDEATE

 NETWORK

 PRODUCE

 PROMOTE

CONTACT DETAILS



Phone: +39 06 65 88 27 10

Email: tamara.tersigni@marriotthotels.com

Via Tommaso Masala, 54
00148 Rome
Italy

www.romemarriottparkhotel.com