

Wedding Chinese set dinner 37 tables

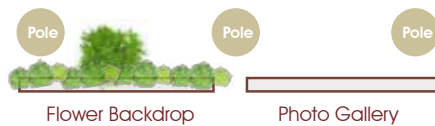

	AREA (m ²)	SIZE (m x m)	CEILING HEIGHT (m)
GRANDE BALLROOM	554	18.2 X 29.6	8 - 9

*The function set-up can be tailored to meet the guests' specific requirements.

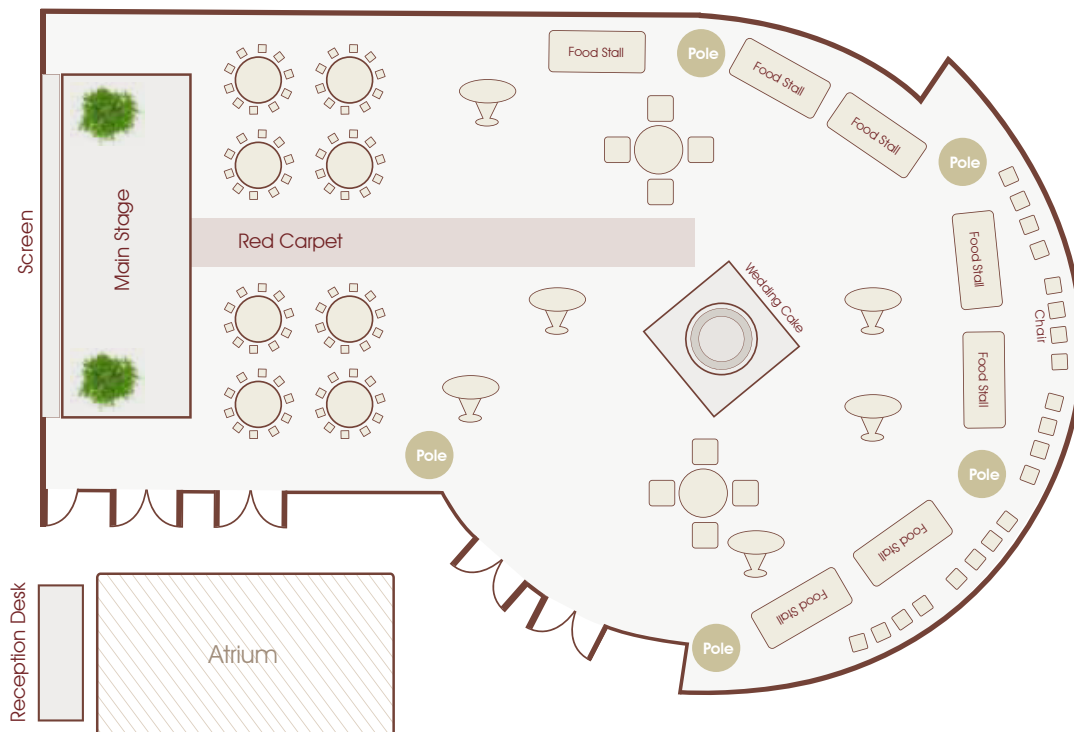

Wedding Cocktail

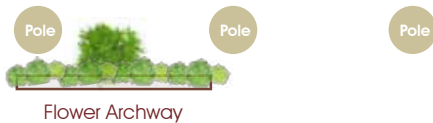

	AREA (m ²)	SIZE (m x m)	CEILING HEIGHT (m)
GRANDE BALLROOM	554	18.2 X 29.6	8 - 9

*The function set-up can be tailored to meet the guests' specific requirements.

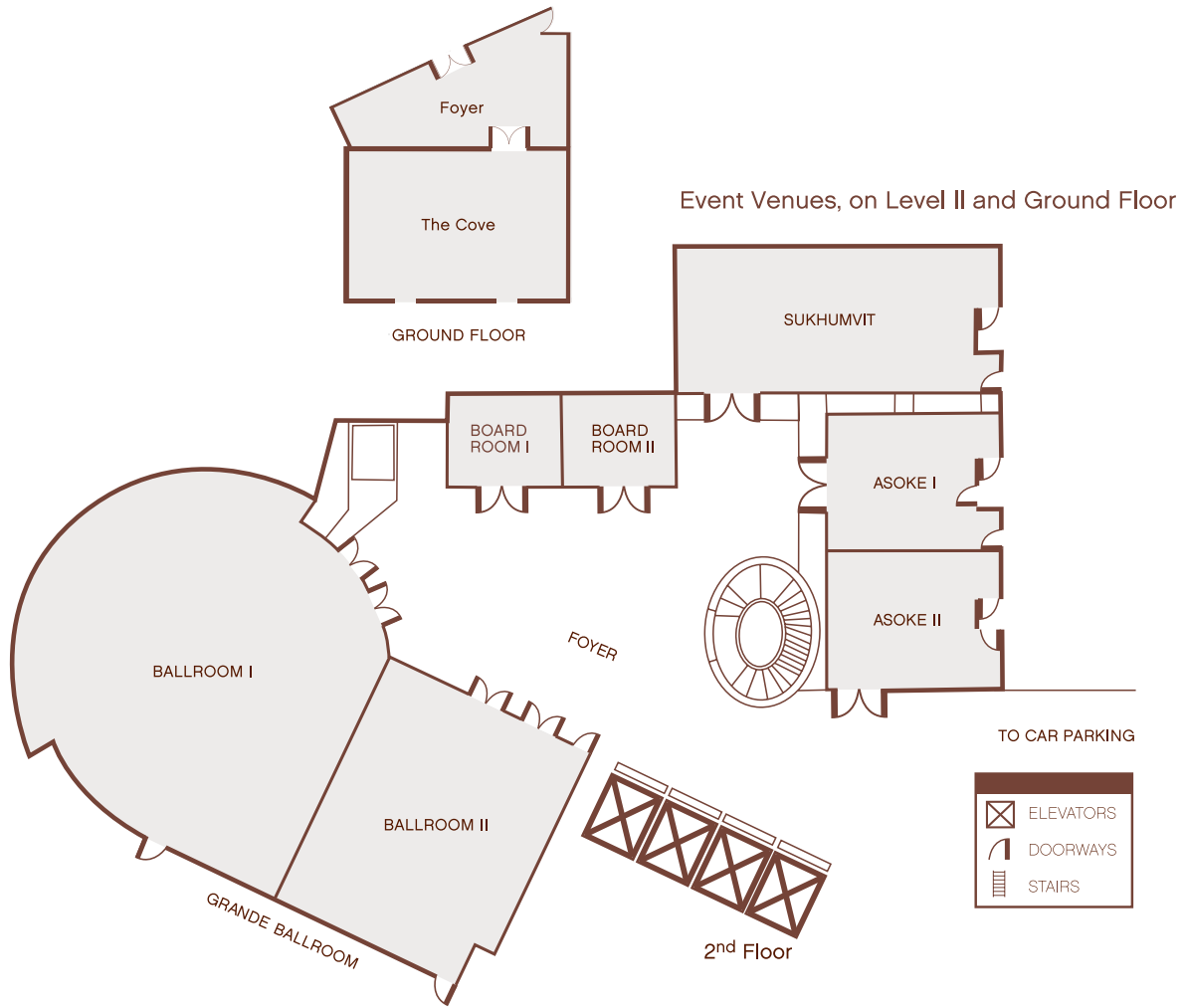

	AREA (m ²)	SIZE (m x m)	CEILING HEIGHT (m)	THEATRE	CLASSROOM	U-SHAPE	COCKTAIL	BANQUET	HOLLOW SQUARE/ BOARDROOM
GRANDE BALLROOM	554	18.2 X 29.6*	8 - 9	500	300	87	500	380	102
BALLROOM I	400	18.2 X 18.6*	9	260	150	51	320	250	66
BALLROOM II	154	11 X 14	8	120	72	33 / 39	130	80	42
SUKHUMVIT	144	8 X 18	4.75	120	72	39	130	80	48
GRANDE ASOKE	149	9.6 X 16	4.75	100	54	-	130	100	-
ASOKE I	77	8 X 9.6	4.75	50	33	24	50	50	30
ASOKE II	72	8 X 9	4.75	50	33	24	50	50	30
BOARDROOM I	28	5 X 5.6	4.75	-	-	-	-	-	12
BOARDROOM II	28	5 X 5.6	4.75	-	-	-	-	-	12
THE COVE	82	7.5 X 11	3.1	50	33	24	70	50	30

- *Plus 40 m²
- 240 parking spaces and valet service is provided
- With a direct link from the hotel's lobby to the Asok SkyTrain station and a few steps to Sukhumvit subway station