

BUSINESS UNUSUAL



© 2015 Renaissance Holdings, Inc.

Relaxed luxury and modern convenience await you at the Renaissance Charlotte SouthPark Hotel. We're dedicated to providing you everything you need for a successful meeting in Charlotte, NC.

R
RENAISSANCE[®]
CHARLOTTE SOUTHPARK HOTEL

THE PLACE TO MEET

11 meeting rooms • 7,880 square feet of total meeting space • Largest meeting room is Queen's Court ballroom with maximum meeting space of 2,925 square feet and maximum meeting capacity of 300 • High-speed Internet access • Wireless Internet access • Catering available • Audio visual services

THE ROYAL TREATMENT

Valet • Evening turndown service • Club Lounge • State-of-the-art health club • Individually climate controlled rooms • Open-air courtyard • Bell service • Indoor pool • Luxurious bedding • Dry sauna • In-room iron, ironing boards and hair dryer

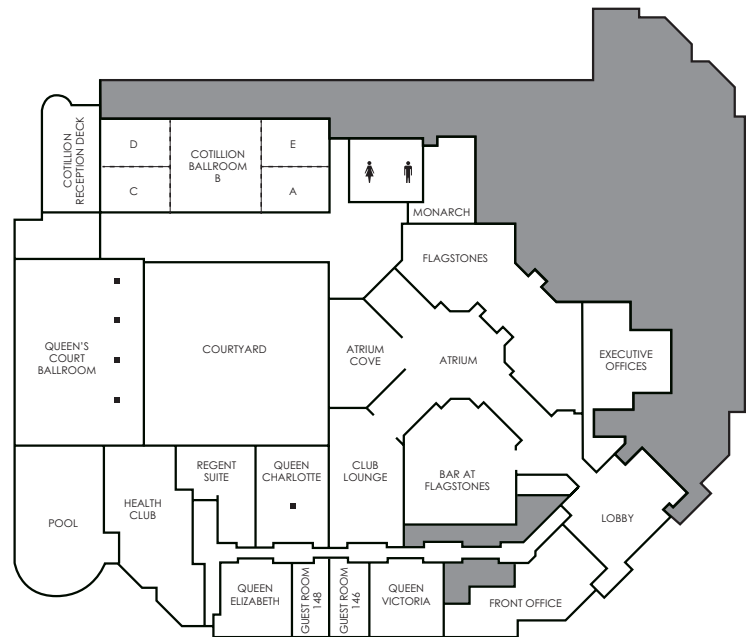

MEETING ROOM	LxWxH (Ft.)	Sq. Ft.	Theater	Schoolroom	Conference	U-Shape	Reception	Banquet
Cotillion Ballroom	79x33x10	2607	300	150			270	180
Salon A	26x16x10	429	40	21	14	15	50	24
Salon B	26x33x10	858	80	45	21	24	100	50
Salon C	26x16x10	429	40	21	14	15	50	24
Salon D	26x16x10	429	40	21	14	15	50	24
Salon E	26x16x10	429	40	21	14	15	50	24
Salon A & E	26x33x10	858	80	45	21	24	100	50
Salon C & D	26x33x10	858	80	45	21	24	100	50
Cotillion Foyer	66x19x11	1,254						
Queens Court Ballroom	65x45x10	2,925	270	150			300	180
Queen Charlotte	24x24x10	588	30	36	20	20	50	30
Queen Elizabeth	23x18x9	414	40	21	20	20	40	30
Queen Victoria	23x18x9	414	40	21	20	20	40	30
Monarch	19x28x10	532			11			
Outdoor Courtyard	64x64x6000	4,532					300	

WE ARE HERE

Located in the SouthPark area, directly across from SouthPark Mall (Nieman Marcus, Tiffany & Co, Nordstrom) • 9 miles from Charlotte Douglas International Airport • Located among prestigious shopping and dining including Philips Place and Piedmont Row • 6 miles from "Uptown" Charlotte and convenient to the Lynx Transit System • Convenient to local area attractions including Bank of America Stadium, Time Warner Cable Arena, US National Whitewater Center and Carowinds Amusement Park

ESSENTIALS

Committed to a smoke-free policy • 7 floors • 264 total rooms with 172 kings, 90 doubles • 2 one-bedroom suites: Large rooms with separate sleeping and living areas • Club lounge

HOUSE FLAVOR

Flagstones: 56, Breakfast, Lunch and Dinner • The Lobby Lounge: 50, Dinner

AT YOUR LEISURE

Complimentary self-parking • Dry cleaning • WiFi • In-room coffee • In-room refrigeration • HD 37" flat screen TV • Room service • In-room deposit boxes • Complimentary newspapers

LOCAL TREASURES

Time Warner Cable Arena (6.6 mi) • SouthPark Mall (.8 mi) • US National Whitewater Center (15.68 mi) • Carowinds Amusement Park (10.4 mi) • Bank of America Stadium (8.93 mi) • Charlotte Motor Speedway (31.4) • Discovery Place Museum (6.97 mi) • Historic South End (5.94 mi) • Charlotte Convention Center (6.39 mi) • Symphony Park (.5 mi)