

PASEO MEETING SPACE

Unique meeting and event spaces offer modern elegance, versatility, and functionality perfect for conferences, meetings or social celebrations up to 300 guests.

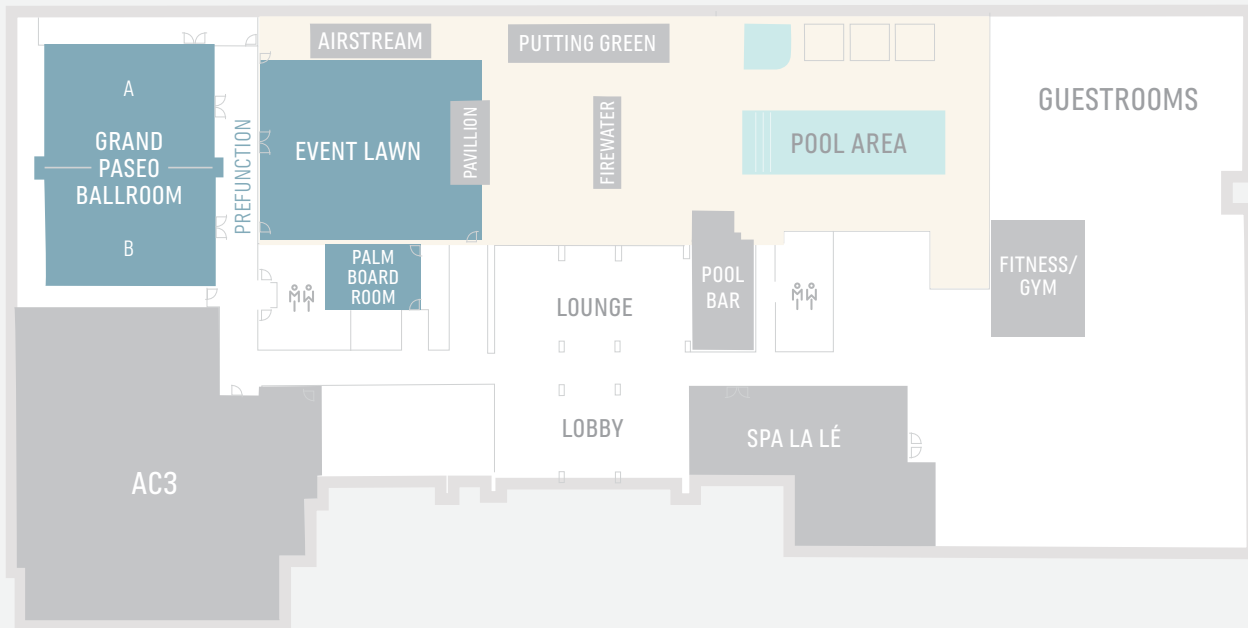

GRAND PASEO BALLROOM 3,200 square feet (can be divided into two 1,600 square foot venues) of elegant space with a neutral palette ideal for social celebrations and corporate gatherings

PALM BOARDROOM Sophisticated meeting space for 20 people with state-of-the-art tech

EVENT LAWN 2,000 square foot outdoor space showcasing a vintage 1950s Airstream Trailer, ideal for celebrating in the sun or under the stars

GRAND DESERT SUITE Specialty suite features an 8-person conference table perfect for private meetings

	sq ft	ceiling height	class-room	theater	banquet	reception	conference	u-shape
Grand Paseo Ballroom	3,200	12'	175	250	200	300	—	—
Breakout Paseo A	1600	12'	80	125	90	150	38	48
Breakout Paseo B	1600	12'	80	125	90	150	38	48
Event Lawn	2000	—	—	200	120	200	—	—
Pre-function Area	840	12'	—	—	—	—	—	—
The Palm Boardroom	475	12'	—	20	20	20	18	18

HOTEL PASEO



PREFUNCTION



GRAND BALLROOM



PALM BOARD ROOM WITH VIEW TO EVENT LAWN



GRAND BALLROOM