

## Kat Planı / Floor Plan

### 1.Kat / 1<sup>st</sup> Floor

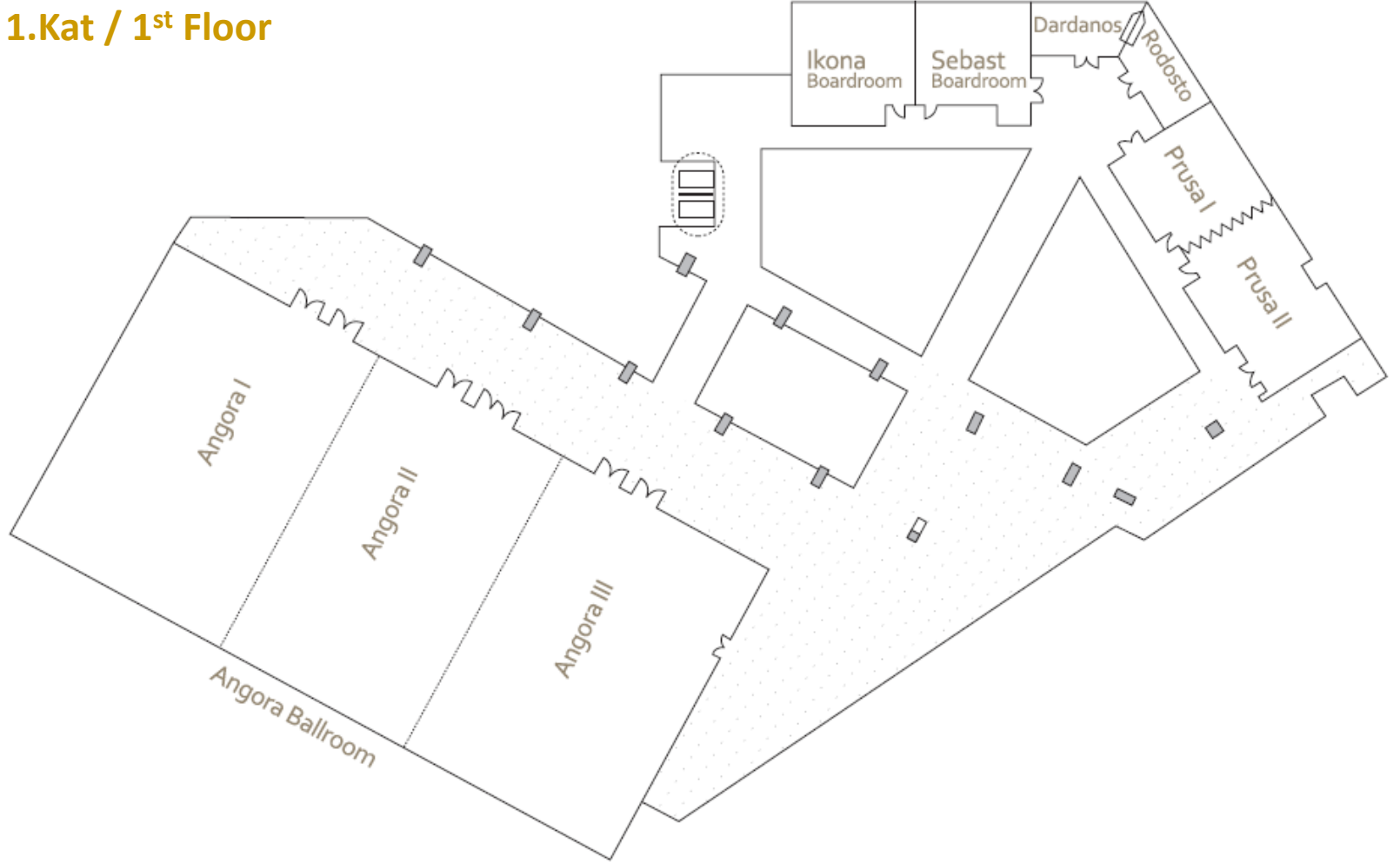



## 2.Kat / 2<sup>nd</sup> Floor

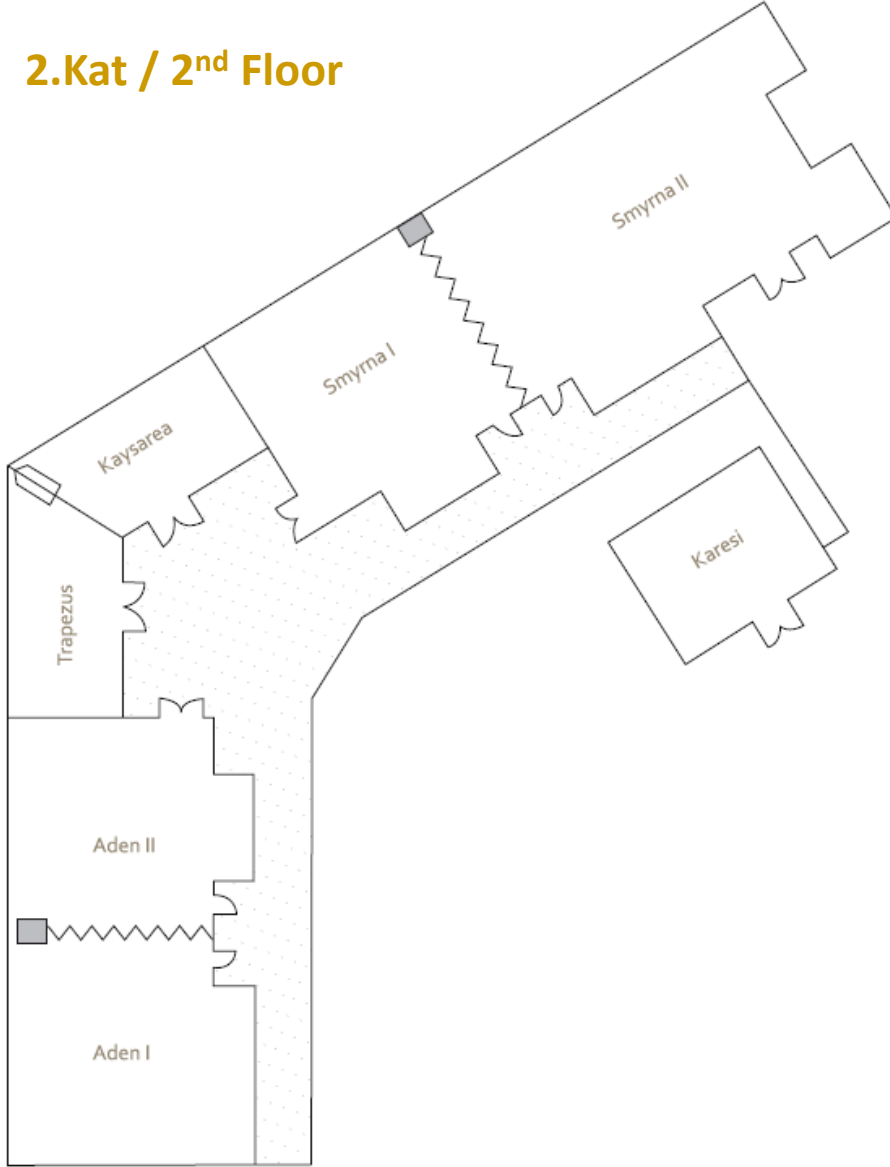

## 3.Kat / 3<sup>rd</sup> Floor

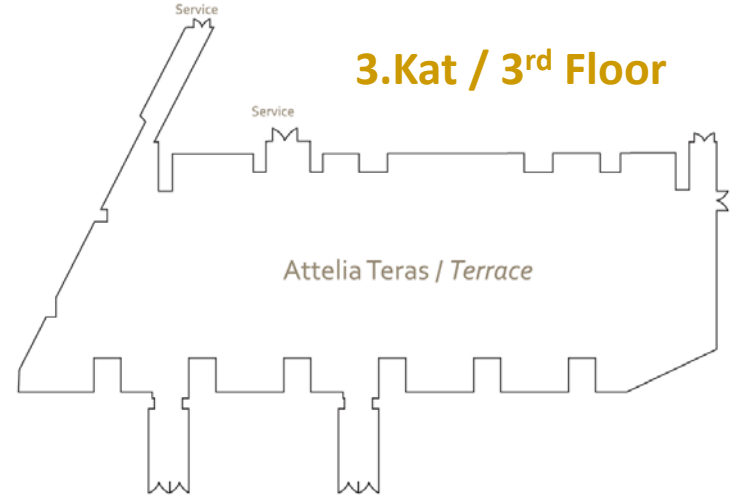

## -2.Kat / -2<sup>nd</sup> Floor

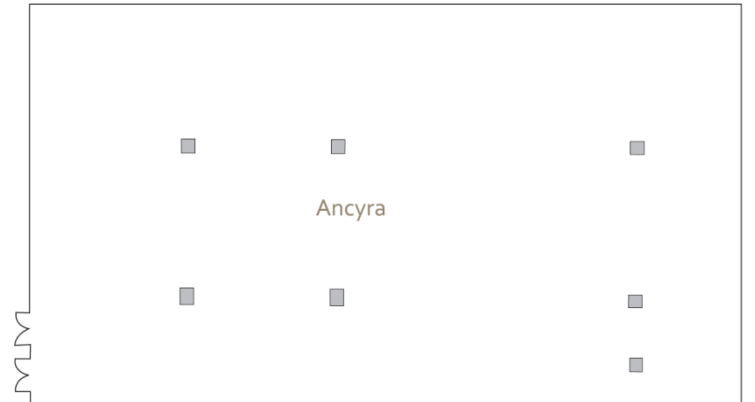

# Kapasite Tablosu / Capacity Chart

JW MARRIOTT.  
ANKARA



Kat Level	İsim Name	BxExY LxWxH	Alan (m <sup>2</sup> ) Area (sqm)	Tiyatro Theatre	Sınıf Classroom	Boardroom Boardroom	U-Şekli U-Shape	Ziyafet Banquet	Kokteyl Reception
<b>-2.kat / -2<sup>nd</sup> floor</b>									
-2	Ancyra	42x24x5	852	650	550	-	60	550	900
<b>1.kat / 1<sup>st</sup> floor</b>									
1	Angora Balo Salonu / Ballroom	26x53x6.3	1.378	1.500	750	-	-	1.254	1.700
1	Angora I	26x18x6.3	468	400	220	-	80	385	450
1	Angora II	26x17x6.3	442	380	200	-	80	363	430
1	Angora III	26x18x6.3	468	400	220	-	80	385	450
1	Angora I-II	26x35x6.3	910	780	420	-	120	737	880
1	Angora II-III	26x35x6.3	910	780	420	-	120	737	880
1	Angora Fuaye / Foyer		618	-	-	-	-	-	-
1	Angora Fuaye Ön / Foyer Front		282	-	-	-	-	-	-
1	Angora Fuaye Yan / Foyer Side		336	-	-	-	-	-	-
1	Ikona Boardroom	8x9x3.8	72	-	-	14	-	-	-
1	Sebast Boardroom	8x9x3.8	72	-	-	14	-	-	-
1	Rodosto	7.3x5.6x3.8	41	20	12	12	12	12	-
1	Dardanos	7.2x5.4x3.8	38	20	12	12	12	12	-
1	Prusa	18x8x3.8	147	120	78	44	43	99	120
1	Prusa I	8.4x8.1x3.8	68	50	36	18	22	33	50
1	Prusa II	9.7x8.1x3.8	79	65	48	26	28	49	70
1	Prusa Fuaye / Foyer	9x24x3.8	161	-	-	-	-	-	-



## Kapasite Tablosu / Capacity Chart

Kat Level	İsim Name	BxExY LxWxH	Alan (m <sup>2</sup> ) Area (sqm)	Tiyatro Theatre	Sınıf Classroom	Boardroom Boardroom	U-Şekli U-Shape	Ziyafet Banquet	Kokteyl Reception
<b>2.kat / 2<sup>nd</sup> floor</b>									
2	Trapezus	7.2x5.4x3.8	38	20	12	12	12	12	-
2	Kaysarea	7.2x5.4x3.8	38	20	12	12	12	12	-
2	Aden	18x8.5x3.8	153	126	84	44	45	99	130
2	Aden I	8.5x8.5x3.8	75	65	36	18	22	36	60
2	Aden II	9.5x8.5x3.8	78	65	36	18	24	40	70
2	Karesi	6.5x8x3.8	52	39	24	14	18	22	-
2	Smyrna	23x9.5x3.8	212	165	100	60	54	121	150
2	Smyrna I	9.5x8x3.8	76	65	36	18	24	44	40
2	Smyrna II	14.5x9.5x3.8	136	100	60	34	42	74	100
2	Smyrna Fuaye	5x15x3.8	70	-	-	-	-	-	-
<b>3.kat / 3<sup>rd</sup> floor</b>									
3	Attelia Terrace	44x67	1.530	-	-	-	-	880	2.000
3	Magnesia I	11x9x3	99	60	24	16	21	44	50
3	Magnesia II	6.7x6.2x3	49	33	18	12	17	22	30
3	Magnesia III	9.5x9x3	87	60	36	28	24	44	60
3	Magnesia IIII	8x9x3	72	56	30	22	21	44	50