

STAN HOWE CONFERENCE CENTER 6TH FLOOR

THE MERRILL HOTEL

TRIBUTE PORTFOLIO

119 W Mississippi Drive, Muscatine, Iowa 52761

563-263-2600 or Toll Free 833-261-2600

TheMerrill.com | info@themerrill.com



EXECUTIVE MEETING ROOMS 5TH FLOOR

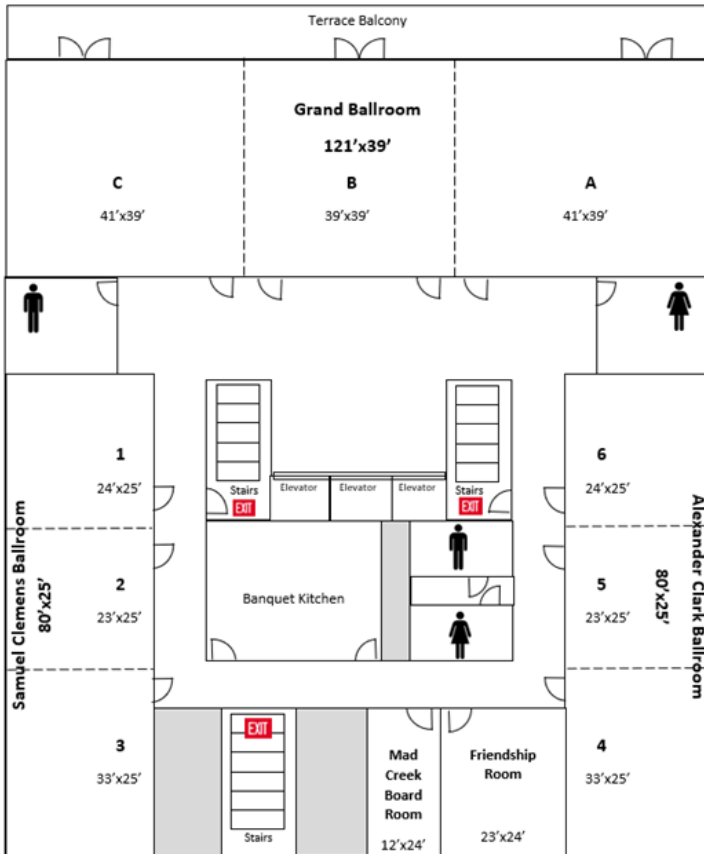
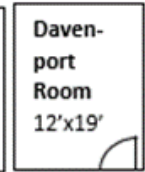
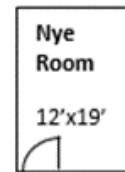
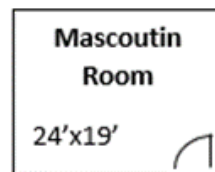

FUNCTION CAPACITIES

	Sq. Ft.	Room Size	Ceiling	Rounds of 10	Classroom	Theater	Conference	U-Shape	H-Square	Cocktail Reception
Grand Ballroom	4,719	121' x 39'	15'	360	280	248	150	–	–	525
Ballroom A	1,599	41' x 39'	15'	49	49	49	49	45	49	49
Ballroom B	1,521	39' x 39'	15'	110	90	150	50	45	50	165
Ballroom C	1,599	41' x 39'	15'	49	49	49	49	45	49	49
Clark Ballroom	2,000	80' x 25'	15'	150	120	200	65	55	65	225
Clark 4	825	33' x 25'	15'	49	49	49	25	25	25	49
Clark 5	575	23' x 25'	15'	45	35	49	20	15	20	49
Clark 6	600	24' x 25'	15'	45	35	49	20	15	20	49
Clemens Ballroom	2,000	80' x 25'	15'	150	120	200	65	55	65	225
Clemens 1	600	24' x 25'	15'	45	35	49	20	15	20	49
Clemens 2	575	23' x 25'	15'	45	35	49	20	15	20	49
Clemens 3	825	33' x 25'	15'	49	49	49	25	25	25	49
Friendship Room	552	23' x 24'	15'	40	30	35	15	10	15	60
Mad Creek Boardroom	288	12' x 24'	15'	–	–	–	10	–	–	–
Mascoutin Boardroom	456	24' x 19'	9'	–	–	–	15	–	–	–
Nye Boardroom	228	12' x 19'	9'	–	–	–	8	–	–	–
Davenport Boardroom	247	13' x 19'	9'	–	–	–	8	–	–	–