



MEETING SPACE

MEETING SERVICES

Our flexible meeting spaces make any meeting or social event a more memorable experience. We offer full-service catering with an award-winning culinary and event team on site.

GUESTROOM AMENITIES

Spacious rooms combine comfort and connectivity with high-speed Internet access and flat screen smart TVs. Stay focused at our smartly designed multifunctional desks that are complete with outlets, USB plugins, and an ergonomic chair. Enjoy deluxe amenities featuring Paul Mitchell products.

HOTEL FACILITIES & SERVICES

The open lobby features spaces for guests to socialize, work or relax. For quick, casual dining, The Bistro offers meals during breakfast and dinner. Our Media Pods, Business Center, and Quick Print Station keep guests up to speed and connected.

ATTRACTIONS

The hotel is within two miles of the following attractions: U.S. Bank Stadium, The Guthrie Theater, Mill City Museum, Mariucci Hockey Arena, TCF Bank Stadium, Weisman Art Museum, Northrop Auditorium, Target Center, Target Field, and Minneapolis Convention Center.

LOCATION

The Courtyard Minneapolis Downtown features the perfect location adjacent to downtown Minneapolis, U.S. Bank Stadium, and the University of Minnesota’s West Bank campus. Our hotel is also easily accessible from major highways I-94 and I-35W, and just eight miles from the Minneapolis St. Paul International Airport (MSP). Our complimentary shuttle services the U.S. Bank Stadium Light Rail Station, the University of Minnesota’s East and West Bank campuses, and many other nearby local partners.

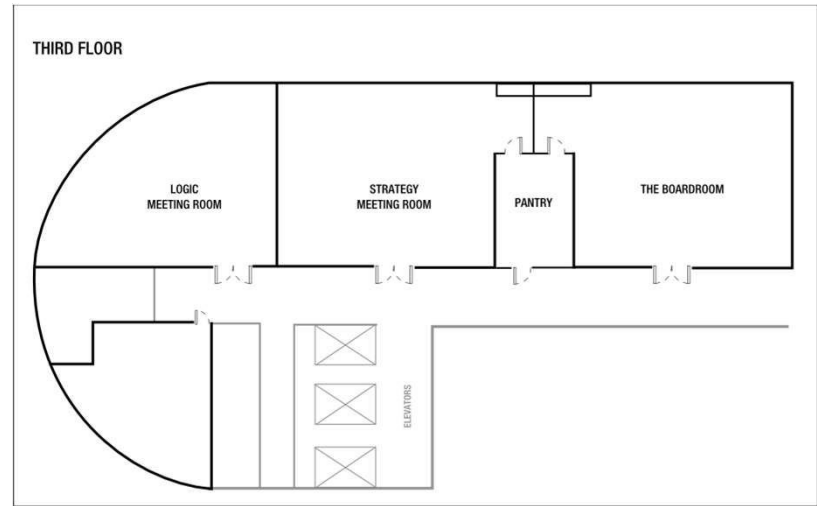
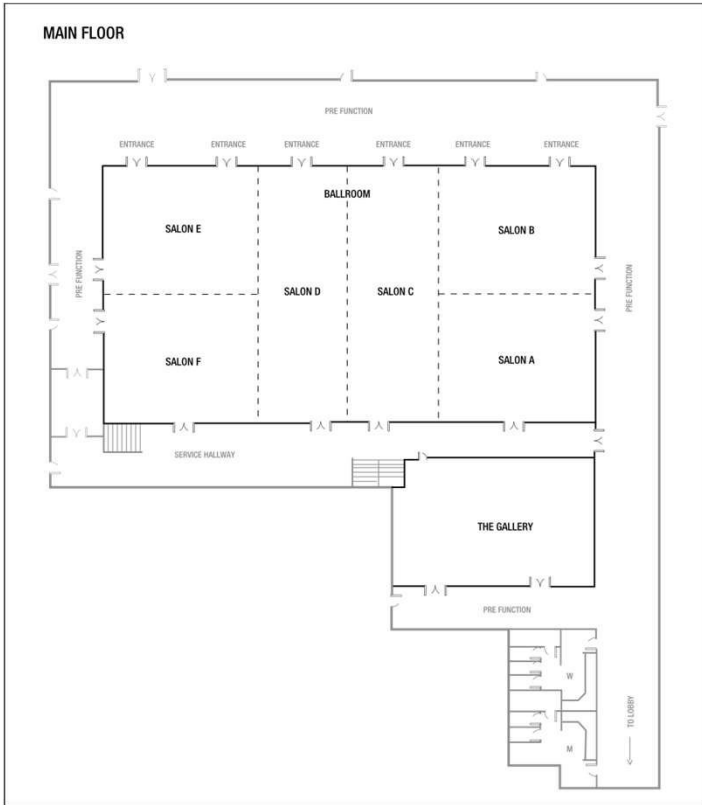

| | DIM. (L X W) | AREA(FT ²) | HEIGHT | BANQ. | THTR. | CONF. | REC. | CLASS | U-SHAPE | H SQ. | DINNER DANCE |
|---------------------|--------------|------------------------|--------|-------|-------|-------|------|-------|---------|-------|--------------|
| EAST TOWN BALLROOM | 100' x 52' | 5,200 | 14' | 500 | 662 | - | 700 | 348 | - | - | 354 |
| SALONS ABCD or CDEF | 66' x 52' | 3,432 | 14' | 320 | 438 | - | 500 | 222 | - | - | 202 |
| SALONS ABC or DEF | 50' x 52' | 2,600 | 14' | 250 | 336 | - | 350 | 156 | - | - | 162 |
| SALONS AB or EF | 34' x 52' | 1,768 | 14' | 150 | 216 | - | 200 | 102 | 54 | 66 | 98 |
| SALONS C & D | 32' x 52' | 1,664 | 14' | 150 | 216 | - | 200 | 102 | 54 | 66 | 98 |
| SALONS A, B, E, F | 34' x 26' | 884 | 14' | 80 | 105 | 30 | 100 | 48 | 33 | 42 | 42 |
| PRE FUNCTION | 120' x 16' | 1,920 | 14' | - | - | - | 250 | - | - | - | - |
| OUTDOOR COURTYARD | 74' x 32' | 2,368 | - | 80 | 130 | - | 100 | - | - | - | 58 |
| GALLERY | 39' x 26' | 1,014 | 8' | 80 | 100 | - | 80 | 63 | 42 | 48 | 50 |
| STRATEGY | 26' x 26' | 676 | 8' | 50 | 84 | 24 | 50 | 36 | 27 | 30 | - |
| BOARDROOM | 26' x 26' | 676 | 8' | - | - | 20 | - | - | - | - | - |
| LOGIC | 24' x 26' | 624 | 8' | 40 | 58 | 24 | 45 | 27 | 18 | 24 | - |