



WESTIN
HOTELS & RESORTS

A Revitalizing Urban Destination

Meetings and events are destined for success with our dedicated team of professionals ready to attend to every detail. With over 35,000 square feet of indoor and outdoor event space across 19 rooms, we offer countless ways to connect and collaborate in the heart of downtown San Diego.

**THE WESTIN SAN DIEGO
GASLAMP QUARTER**

910 Broadway Circle
San Diego, CA 92101
USA

T +1 619.239.2200
F +1 619.239.0509

westin.com/gaslampquarter



Revitalizing Rest

Rest and recharge at The Westin San Diego Gaslamp Quarter, featuring 450 spacious guest rooms and suites. Together with our thoughtful amenities and signature Westin services, let us help you rise above the rigors of travel and achieve optimal renewal.

All guest rooms and suites stay true to our commitment to help you achieve your best. In-Room features and amenities include The Heavenly® Bed and Heavenly® Bath, 48" Smart TV, work desk with ergonomic chair, electronic safe and Starbucks® Coffee.

Westin hotels offer guests a 100% smoke-free environment.

Productive Meetings

Innovate, create and connect at Westin hotels with everything you need for a productive session.

Clear thinking begins with Westin Clutter-Free Meetings, helping guests stay focused with spacious open rooms, essential amenities and invigorating SuperFoodsRx menu selections designed to fuel productivity. Streamlined stations offer brainstorming staples such as paper, pens and refreshing beverages.

Westin hotels offer a variety of intuitive tools to help you book meetings with ease including a free personalized website that allows attendees to book reservations and access essential documents via a custom URL. Designed with the meeting planner in mind, our personalized services ensure a unique experience for each invitee.

Dynamic Details

The hotel offers 19 individual meeting and breakout rooms, totaling more than 35,000 square feet of unique meeting and event space. The California Ballroom is ideal for social events or business meetings up to 900 people. For a truly distinct Southern California experience, the San Diego Ballroom adjoins the Garden Terrace, which is perfect for outdoor receptions and luncheons in San Diego's year-round warm climate.

Each venue is thoughtfully equipped with top-of-the-line amenities, comfortable seating, spacious conference tables, and a host of customized details to create a welcoming and refined environment that fully supports the success of your gathering. Modern technology is available, including both domestic and international video-conferencing capabilities, as well as wireless High Speed Internet Access. Our on-site Executive Meeting Specialist will be by your side ready to assist with the flawless execution of your event from the moment your group arrives.





Capacity Charts

ROOM NAME	TOTAL SQ. FEET	DIMENSIONS	CEILING	BANQUET	THEATER	RECEPTION	CONFERENCE	C/R 3X6	C/R 2X6	U-SHAPE	HOLLOW SQ.
LOBBY LEVEL											
LA JOLLA	1,240	40' X 31'	11'	80	112	120	28	72	47	35	42
DEL MAR	1,147	37' X 31'	10'5"	80	112	115	26	72	47	31	34
SOLANA	336	24' X 14'	11'	20	30	30	14	16	12	12	—
SECOND FLOOR											
CALIFORNIA BALLROOM	9,064	87' X 103'	16'	690	900	950	—	480	336	246	—
CALIFORNIA BALLROOM A	3,080	88' X 35'	16'	230	300	315	84	168	112	82	88
CALIFORNIA BALLROOM B	2,904	88' X 35'	16'	230	300	315	84	168	112	82	88
CALIFORNIA BALLROOM C	3,080	88' X 35'	16'	230	300	315	84	168	112	82	88
CALIFORNIA FOYER	—	—	12'	—	—	—	—	—	—	—	—
SIERRA	1,150	50' X 23'	10'	80	110	120	—	48	32	—	—
SIERRA A	575	25' X 23'	10'	40	60	60	20	27	18	18	24
SIERRA B	575	25' X 23'	10'	40	60	60	20	27	18	18	24
PLAZA	1,740	29' X 60'	10'	130	200	185	58	100	70	52	58
PLAZA A	580	29' X 20'	10'	50	66	60	20	32	22	24	30
PLAZA B	580	29' X 20'	10'	40	66	60	20	32	22	24	30
PLAZA C	580	29' X 20'	10'	40	66	60	20	32	22	24	30
PLAZA AB	1,160	29' X 40'	10'	90	132	120	38	66	44	40	46
PLAZA BC	1,160	29' X 40'	10'	80	132	120	38	66	44	40	46
PLAZA FOYER	897	23' X 39'	12'	—	—	—	—	—	—	—	—
PACIFICA BOARDROOM	700	21' X 30'	10'	—	—	—	20	—	—	16	—
IMPERIAL BOARDROOM	700	21' X 30'	10'	40	60	70	20	28	16	20	22
SANTA FE	1,128	24' X 47'	10'	80	144	115	40	72	48	46	50
SANTA FE FOYER	1,302	21' X 62'	12'	—	—	—	—	—	—	—	—
THIRD FLOOR											
CORONADO	842	25' X 34'	8'	50	80	85	28	40	28	30	36
CORONADO LOUNGE	400	26' X 22'	10'	—	—	—	—	—	—	—	—
HARBOR	1,200	25' X 48'	8'	80	120	125	48	60	40	40	46
HARBOR A	600	25' X 24'	8'	40	60	60	20	30	20	22	26
HARBOR B	600	25' X 24'	8'	40	60	60	20	30	20	22	26
HARBOR FOYER	800	16' X 50'	10'	—	—	—	—	—	—	—	—
HARBOR TERRACE	476	28' X 17'	—	80	—	150	—	—	—	—	—
BALBOA	716	25' X 28'	8'	48	60	70	20	30	20	22	26
BALBOA PASSAGE	447	26' X 16'	8'	—	—	30	3	—	—	—	—
POOL DECK	2,806	83' X 19'	19'	—	—	60	—	—	—	—	—
FOURTH FLOOR											
SD BALLROOM FOYER	330	27.5' X 12'	10'6"	—	—	—	3	—	—	—	—
SAN DIEGO BALLROOM	5,940	66' X 90'	18'	430	650	600	—	300	200	164	—
GARDEN TERRACE	5,778	54' X 107'	9'6"	350	—	600	—	—	—	—	—

Floor Plans

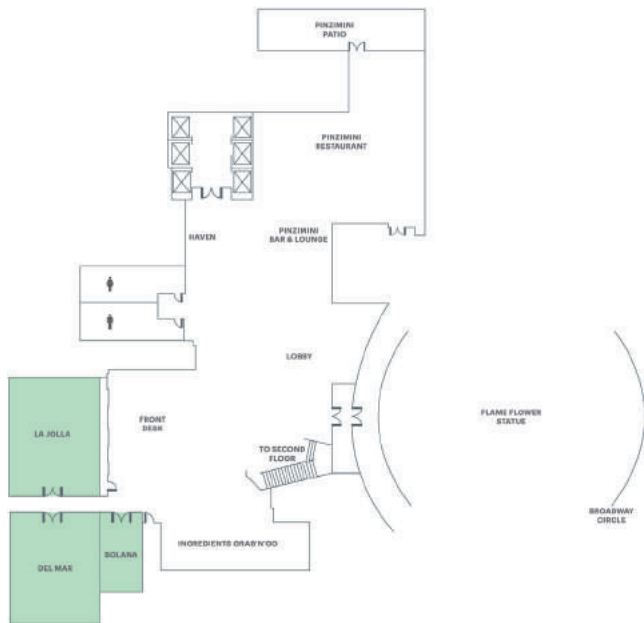

LOBBY LEVEL

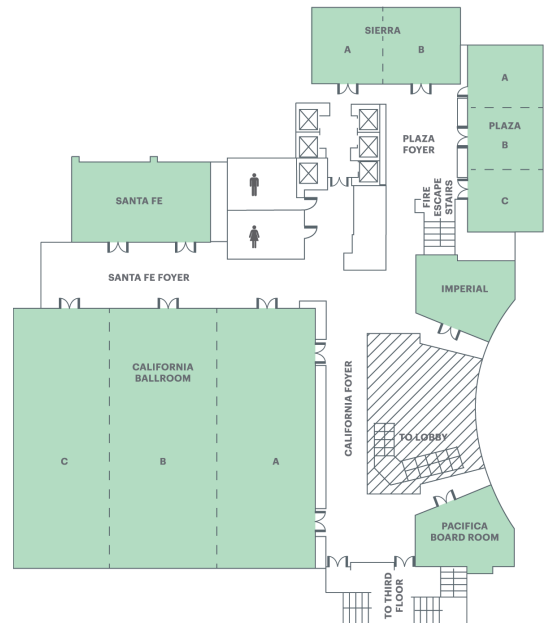

SECOND FLOOR

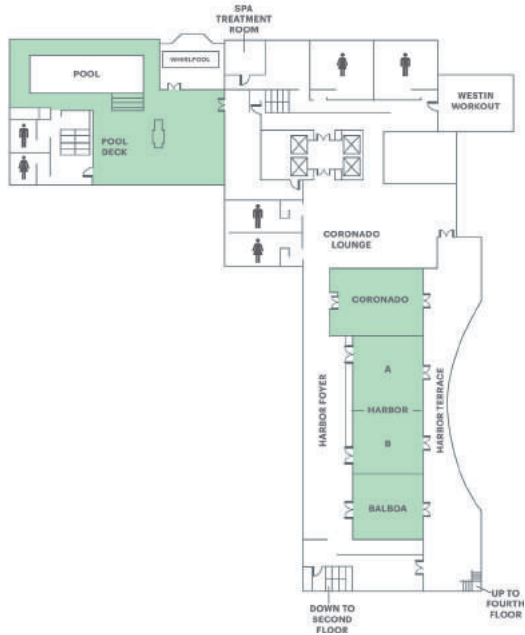

THIRD FLOOR

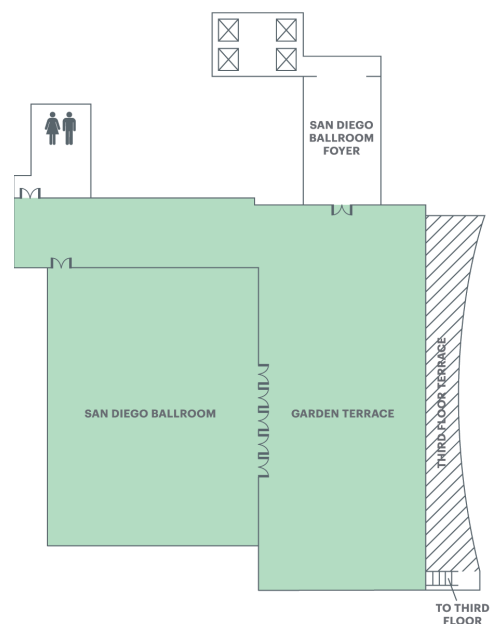

FOURTH FLOOR

Fulfilling Fitness

At Westin, we are committed to your well-being. The WestinWORKOUT® Fitness Studio is open 24 hours a day, offering access to state-of-the-art equipment in an invigorating environment. Energize the body with a refreshing swim in our outdoor pool or relax in the adjacent therapeutic whirlpool.

Take off on your own and explore your surroundings with our three-mile and five-mile RunWESTIN™ running routes or join a group run led by our RunWESTIN™ Hotel Running Concierge.

Pack light and stay fit with our New Balance® Gear Lending program. Shoes and athletic wear are available for use during your stay for a nominal fee.

Natural Nourishment

Pinzimini restaurant features Italian inspired cuisine in a warm and inviting ambiance. Take a seat on the patio to enjoy the fresh air, or watch the action from the open kitchen with a table indoors while dining on Tuscan-style entrees, salads, pastas and pizzas. Pinzimini Bar offers handcrafted cocktails, local San Diego beers and an extensive wine list, all of which pair perfectly with the lounge menu offerings.

Ingredients Grab 'N' Go offers quick and convenient options for breakfast and lunch along with Starbucks® Coffee and specialty beverages.

The City at Your Fingertips

Just steps away from the hotel, you will find yourself in the heart of the vibrant Gaslamp Quarter with more than 150 restaurants, shops, galleries and nightclubs. A short and scenic walk leads you to the San Diego Convention Center, Petco Park and the San Diego Bay. Premiere San Diego attractions including beaches, Balboa Park, the San Diego Zoo, and SeaWorld are only a short drive from our Downtown location. Whether you are just arriving or traveling to your next destination, the San Diego International Airport is a mere 2.5 miles away.

